

STATE OF ILLINOIS  
DEPARTMENT OF TRANSPORTATION

F.A.I. RTE.	SECTION	COUNTY	TOTAL SHEETS	SHEET NO.
270	60-1BDS-1, 60-BDS-2	MADISON	10	1
		ILLINOIS	CONTRACT NO. 76K69	

FOR INDEX OF SHEETS, SEE SHEET NO. 2

FAI 270 (I-270) ADT  
2020 = 52,600 (ESTIMATED)  
SU = 2.5% MU = 15.0%

FUNCTIONAL CLASSIFICATION:  
INTERSTATE

# PROPOSED HIGHWAY PLANS

FAI ROUTE 270 (I-270)  
SECTION 60-1BDS-1, 60-BDS-2  
PROJECT NHPP-8IHK(924)  
BRIDGE DECK SEAL  
MADISON COUNTY

C-98-328-18

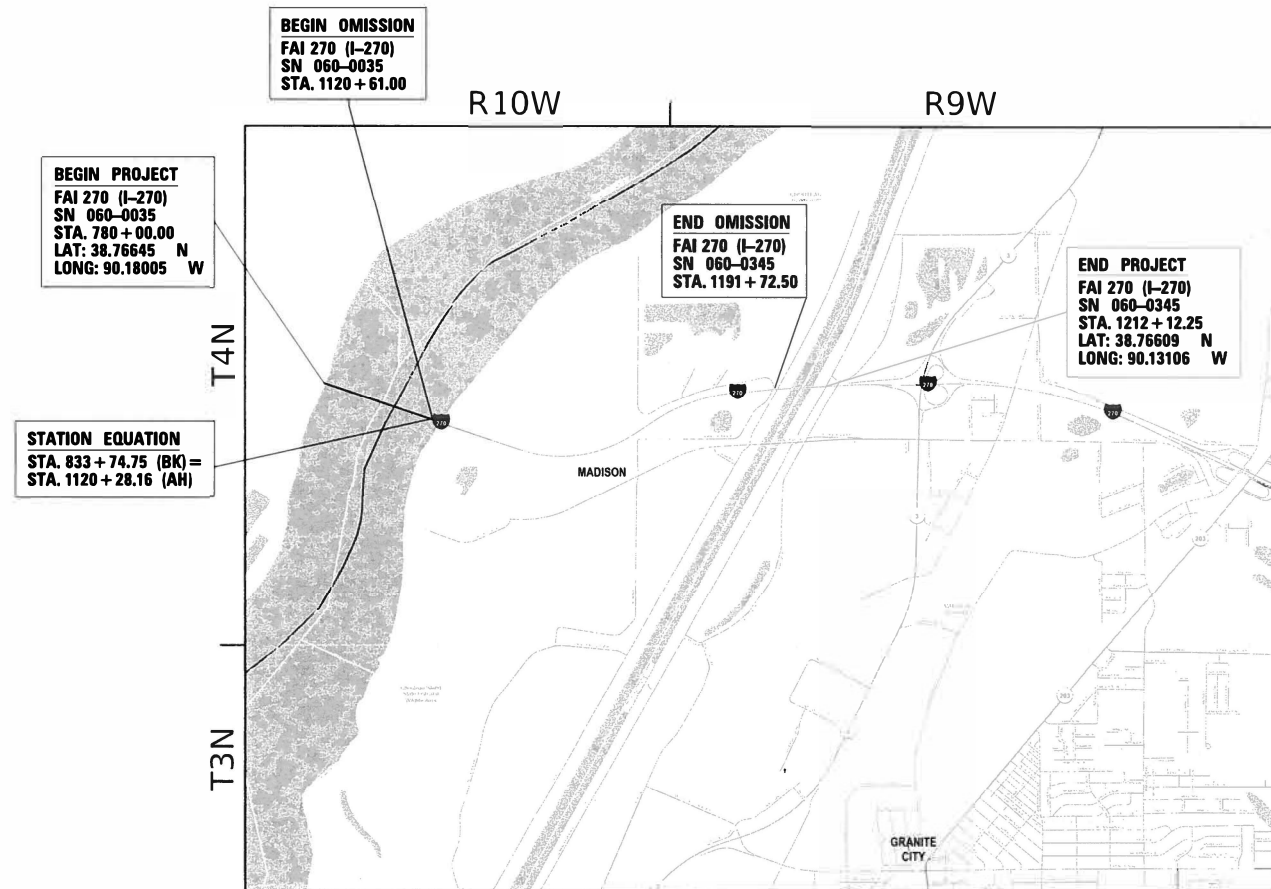

LOCATION MAP  
NOT TO SCALE

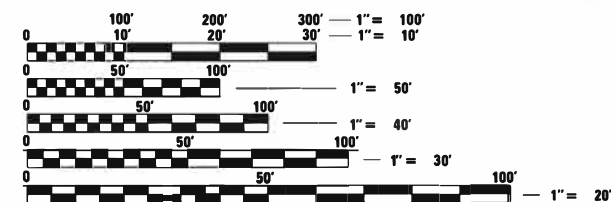

FULL SIZE PLANS HAVE BEEN PREPARED USING STANDARD ENGINEERING SCALES. REDUCED SIZED PLANS WILL NOT CONFORM TO STANDARD SCALES. IN MAKING MEASUREMENTS ON REDUCED PLANS, THE ABOVE SCALES MAY BE USED.

J.U.L.I.E.  
JOINT UTILITY LOCATION INFORMATION FOR EXCAVATION  
1-800-892-0123  
OR 811

PROJECT ENGINEER: HERVE GELIN (618) 346-3179  
PROJECT MANAGER: BRANDON HUMPHREYS (618) 346-3413

CONTRACT NO. 76K69

GROSS LENGTH = 14,562 FT. = 2.758 MILE  
NET LENGTH = 7,451 FT. = 1.411 MILE

STATE OF ILLINOIS  
DEPARTMENT OF TRANSPORTATION

SUBMITTED Dec 9 2020  
Keith Blatz  
REGIONAL ENGINEER

January 29, 2021  
Scott A. Elk  
ENGINEER OF DESIGN AND ENVIRONMENT

January 29, 2021  
James J. Gu  
DIRECTOR OF HIGHWAYS PROJECT IMPLEMENTATION 13

PRINTED BY THE AUTHORITY  
OF THE STATE OF ILLINOIS

## INDEX OF SHEETS

1. COVER SHEET
2. INDEX OF SHEETS, HIGHWAY STANDARDS, GENERAL NOTES, & COMMITMENTS
3. SUMMARY OF QUANTITIES

### - S.N. 060-0345

4. TYPICAL SECTIONS
5. SUGGESTED STAGES OF CONSTRUCTION
6. STRUCTURE PLAN SHEET

### - S.N. 060-0035

7. TYPICAL SECTIONS
8. SUGGESTED STAGES OF CONSTRUCTION
9. STRUCTURE PLAN SHEET

### - S.N. 060-0345 & 060-0035

10. CHANGEABLE MESSAGE SIGNS LOCATION SKETCH

## HIGHWAY STANDARDS

000001-08	STANDARD SYMBOLS, ABBREVIATIONS AND PATTERNS
001006	DECIMAL OF AN INCH AND OF A FOOT
701400-10	APPROACH TO LANE CLOSURE, FREEWAY/EXPRESSWAY
701401-12	LANE CLOSURE, FREEWAY/EXPRESSWAY
701411-09	LANE CLOSURE, MULTILANE, AT ENTRANCE OR EXIT RAMP, FOR SPEEDS > 45 MPH
701426-09	LANE CLOSURE, MULTILANE, INTERMITTENT OR MOVING OPER., FOR SPEEDS > 45 MPH
701428-01	TRAFFIC CONTROL SETUP AND REMOVAL FREEWAY/EXPRESSWAY
701901-08	TRAFFIC CONTROL DEVICES

## GENERAL NOTES

1. THE UTILITIES KNOWN TO HAVE FACILITIES WITHIN THE PROJECT AREA ARE AS FOLLOWS:

UTILITY	TYPE	JULIE MEMBER
- AT&T ILLINOIS 118 HILLSBORO AVENUE, P.O. BOX 407 EDWARDSVILLE, IL 62025-0407	COMMUNICATIONS	YES
- BUCKEYE PARTNERS L.P. -- WOOD RIVER PIPELINE 220 E. HAWTHORNE STREET HARTFORD, IL 62048	PIPELINE	YES
- CHARTER COMMUNICATIONS, INC. 101 NORTHWEST PLAZA SAINT ANN, MO 63074	CABLE TV	YES
- CITY OF EDWARDSVILLE 118 HILLSBORO AVENUE, P.O. BOX 407 EDWARDSVILLE, IL 62025-0407	WATER & SANITARY SEWER	YES
- EXPLORER PIPELINE COMPANY WOOD RIVER AREA OFFICE 1355 ROBBINS ROAD HARTFORD, IL 62048	PIPELINE	YES

2. NO SURVEY WAS PERFORMED FOR THIS PROJECT AND THE PLANS WERE CREATED USING MICROFILM AND FIELD MEASUREMENTS.
3. ADDITIONAL CHANGEABLE MESSAGE SIGNS SHALL BE PLACED OUTSIDE OF THE PROJECT LIMITS. SEE PLANS FOR PLACEMENT AND DURATION. THESE SIGNS WILL BE PAID FOR AS "CHANGEABLE MESSAGE SIGNS."
4. THE ILLINOIS DEPARTMENT OF TRANSPORTATION STRONGLY ENCOURAGES THE PRIME CONTRACTOR AND THEIR APPROVED SUB-CONTRACTORS TO HIRE MINORITY, WOMEN AND DISADVANTAGED INDIVIDUALS FROM ITS FEDERALLY FUNDED HIGHWAY CONSTRUCTION CAREERS TRAINING PROGRAM (HCCTP) TO HELP MEET WORKFORCE AND TRAINEE GOALS. THIS PROGRAM IS TRAINING MINORITIES, WOMEN AND DISADVANTAGED INDIVIDUALS IN HIGHWAY CONSTRUCTION-RELATED SKILLS, E.G. MATH FOR TRADES, JOB READINESS, TECHNICAL SKILLS COURSEWORK (CARPENTRY, CONCRETE FLATWORK, BLUEPRINT READING, SITE PLANS, SITE WORK, TOOLS USE, ETC.) AND OSHA 10 HOUR CERTIFICATION, TO PREPARE THEM FOR A CAREER IN HIGHWAY CONSTRUCTION TRADES. GRADUATES ARE WELL-TRAINED AND READY TO BECOME PRODUCTIVE ENTRY-LEVEL CONSTRUCTION WORKERS. CONTACT THE DISTRICT 8 EEO OFFICE AT 618-346-3360 OR THE HCCTP COORDINATOR AT 618-874-6528 TO LEARN MORE ABOUT THE PROGRAM AND FOR ASSISTANCE IN MEETING WORKFORCE AND TRAINEE GOALS.

## COMMITMENTS

NONE

MODEL: Default  
 FILE: \\hmc-pc1\pub\hmcroom\data\illinois.gov\PIWDOT\Documents\DOT\_Offices\District 8\Projects\060-0345\060-0035\CADDData\CAD\sheet\060-0345-0035-121-121-121.dgn

USER NAME = humphreysb	DESIGNED -	REVISED -
	DRAWN -	REVISED -
PLOT SCALE = 2,0000 ' / in.	CHECKED -	REVISED -
PLOT DATE = 12/10/2020	DATE -	REVISED -

**STATE OF ILLINOIS  
DEPARTMENT OF TRANSPORTATION**

**INDEX OF SHEETS, HIGHWAY STANDARDS,  
GENERAL NOTES, AND COMMITMENTS**

SCALE: NTS      SHEET 1    OF   1    SHEETS    STA.                    TO STA.

F.A.I. RTE.	SECTION	COUNTY	TOTAL SHEETS	SHEET NO.
270	60-1BDS-1, 60-BDS-2	MADISON	10	2
			CONTRACT NO. 76K69	
		ILLINOIS	FED. AID PROJECT	

CODE NO.	ITEM	UNIT	TOTAL QUANTITY	CONSTRUCTION CODE	
				90% FEDERAL 10% STATE	90% FEDERAL 10% STATE
				BRIDGE	BRIDGE
				0047	0047
				URBAN	URBAN
060-0345	060-0035				
67100100	MOBILIZATION	L SUM	1	0.5	0.5
70100205	TRAFFIC CONTROL AND PROTECTION, STANDARD 701401	EACH	2	1	1
70100420	TRAFFIC CONTROL AND PROTECTION, STANDARD 701411	EACH	4	2	2
70107025	CHANGEABLE MESSAGE SIGN	CAL DA	217	109	108
70200100	NIGHTTIME WORK ZONE LIGHTING	L SUM	1	0.5	0.5
X3000001	RRPM PROTECTION	EACH	376	104	272
Ø Z0076600	TRAINEES	hour	500	500	
X5870015	BRIDGE DECK CONCRETE SEALER	SQ FT	585370	207830	377540
Ø Z0076604	TRAINEES TRAINING PROGRAM GRADUATE	hour	500	500	

Ø 0042

REV. - MS

MODEL: Default  
FILE: Model: P:\pub\pamroom.dwg  
PROJECT: I:\Projects\DOT\Documents\DOT - Offices\District 8\Projects\DOT\7669\CADDData\CAD\Sheet\DOT7669-11-17-17.dwg

USER NAME = humphreysb	DESIGNED -	REVISED -	<b>STATE OF ILLINOIS DEPARTMENT OF TRANSPORTATION</b>	<b>SUMMARY OF QUANTITIES</b>			F.A.I. RTE.	SECTION	COUNTY	TOTAL SHEETS	SHEET NO.
DRAWN -	REVISIED -	270					60-1BDS-1, 60-BDS-2	MADISON	10	3	
PLOT SCALE = 2,0000 ' / in.	CHECKED -	REVISIED -		SCALE: NTS			CONTRACT NO. 76K69				
PLOT DATE = 12/10/2020	DATE -	REVISIED -		SHEET 1	OF 1	SHEETS	STA.	TO STA.	ILLINOIS	FED. AID PROJECT	

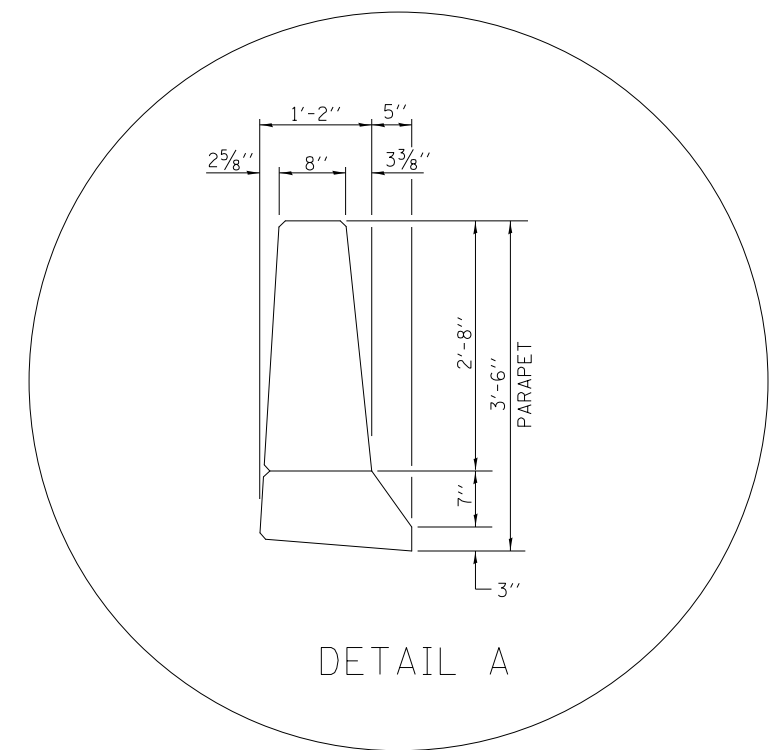
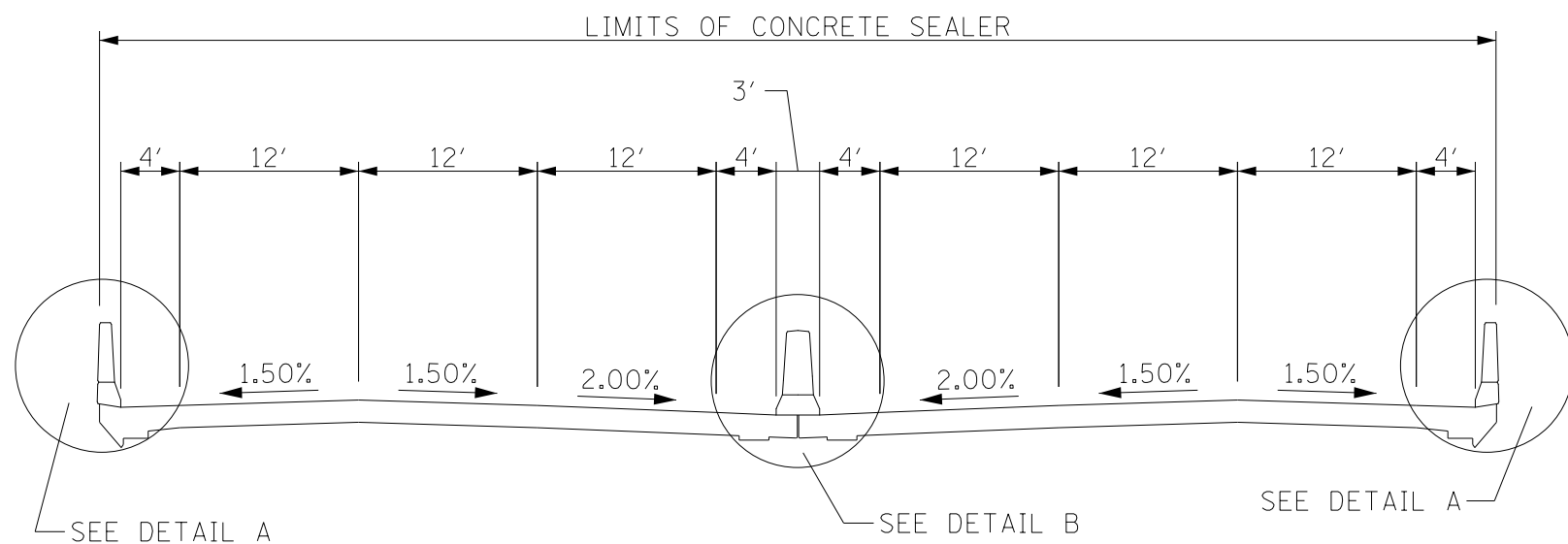

DETAIL A

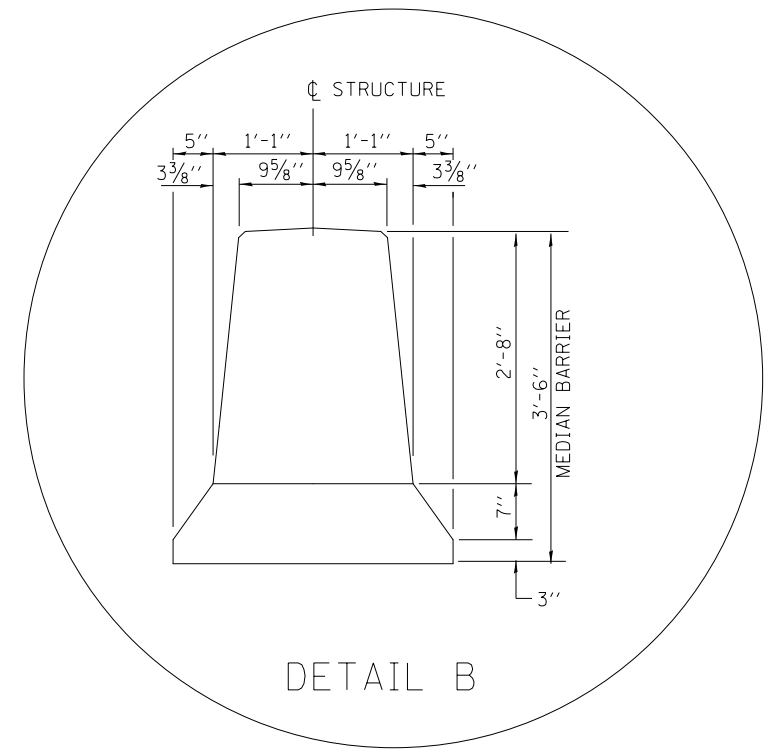

DETAIL B

**EXISTING TYPICAL SECTION**  
**S.N. 060-0345 (CHAIN OF ROCKS CANAL BRIDGE)**

STA. 1191+72.50 TO STA. 1212+12.25

MODEL: Default  
 FILE: h:\mfc\pic\uplanroom.dwg  
 PROJECT: 060-0345  
 SHEET: 10  
 DATE: 12/10/2020

USER NAME = humphreysb	DESIGNED -	REVISED -
DRAWN -	REVISIONS -	
PLOT SCALE = 2,000' / in.	CHECKED -	REVISED -
PLOT DATE = 12/10/2020	DATE -	REVISED -

**STATE OF ILLINOIS**  
**DEPARTMENT OF TRANSPORTATION**

**TYPICAL SECTION**  
**(SN 060-0345)**

SCALE: NTS SHEET 1 OF 1 SHEETS STA. TO STA.

F.A.I. RTE.	SECTION	COUNTY	TOTAL SHEETS	SHEET NO.
270	60-1BDS-1, 60-BDS-2	MADISON	10	4
CONTRACT NO. 76K69				
ILLINOIS FED. AID PROJECT				



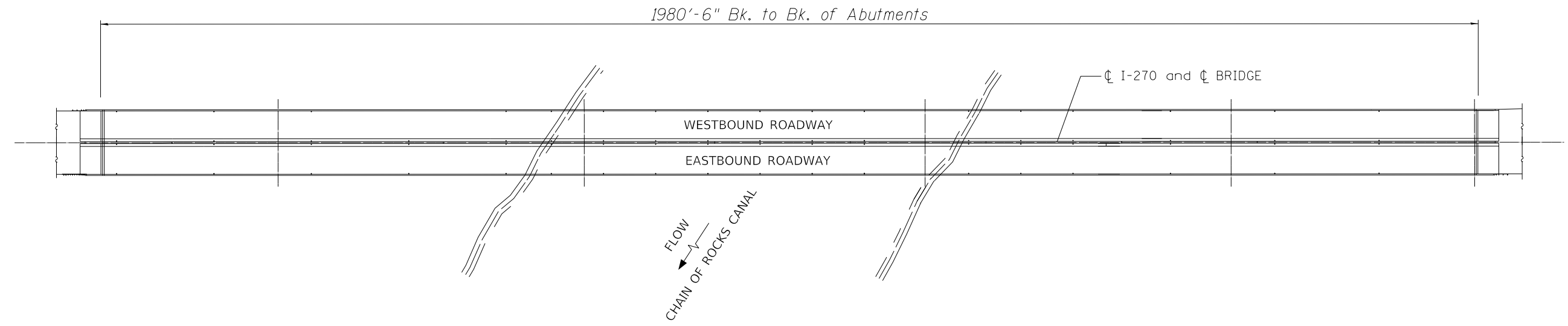

PLAN

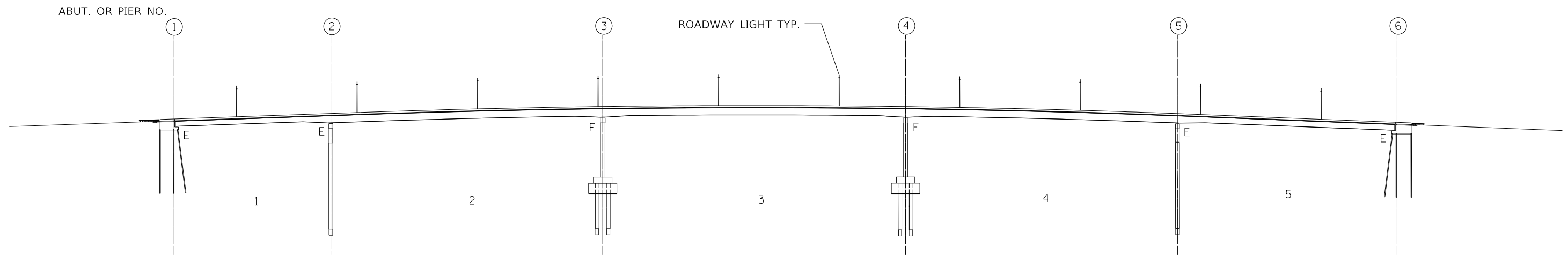

ELEVATION

GENERAL PLAN AND ELEVATION  
 I-270 OVER CHAIN OF ROCKS CANAL  
 FAI-270  
 MADISON COUNTY  
 STRUCTURE NO. 060-0345

MODEL: Default  
 FILE: Model1.dwg  
 PLOT: 12/10/2020 10:00:00 AM  
 PLOT SCALE: 2.0000' / in.  
 PLOT DATE: 12/10/2020

USER NAME = humphreysb	DESIGNED -	REVISED -
	DRAWN -	REVISED -
PLOT SCALE = 2.0000' / in.	CHECKED -	REVISED -
PLOT DATE = 12/10/2020	DATE -	REVISED -

**STATE OF ILLINOIS  
 DEPARTMENT OF TRANSPORTATION**

**STRUCTURE PLANS  
 (SN 060-0345)**

SCALE: NTS    SHEET 1    OF 1    SHEETS    STA.    TO STA.

F.A.I. RTE.	SECTION	COUNTY	TOTAL SHEETS	SHEET NO.
270	60-1BDS-1, 60-BDS-2	MADISON	10	6
CONTRACT NO. 76K69				
ILLINOIS FED. AID PROJECT				

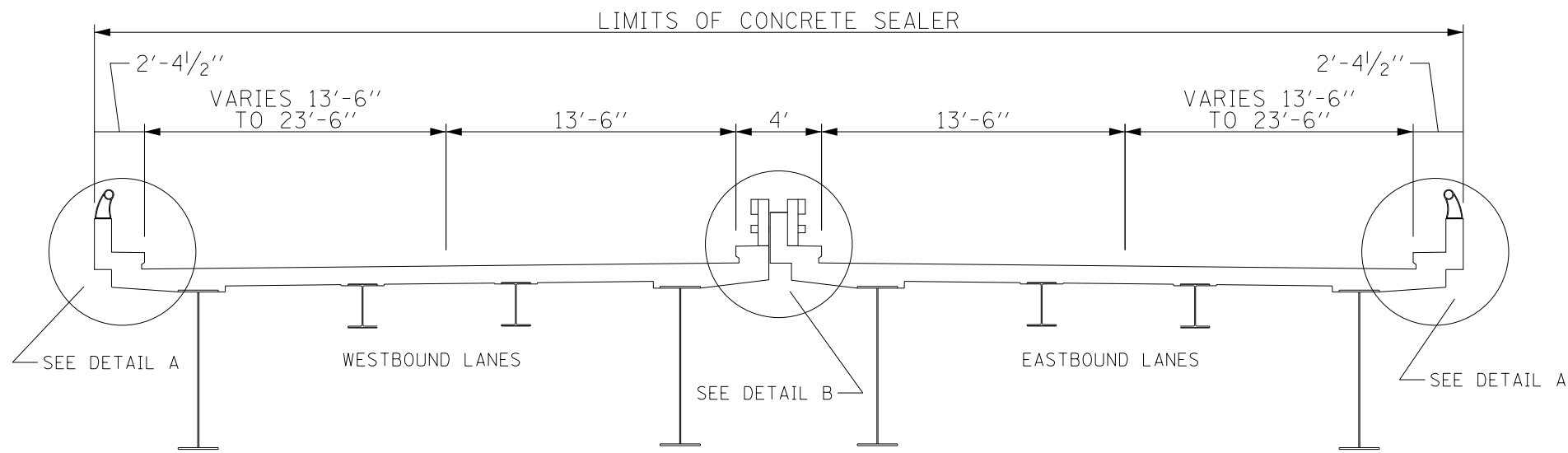

**EXISTING TYPICAL SECTION**  
**S.N. 060-0035 (MISSISSIPPI RIVER BRIDGE)**

STA. 780+00.00 TO STA. 786+50.00

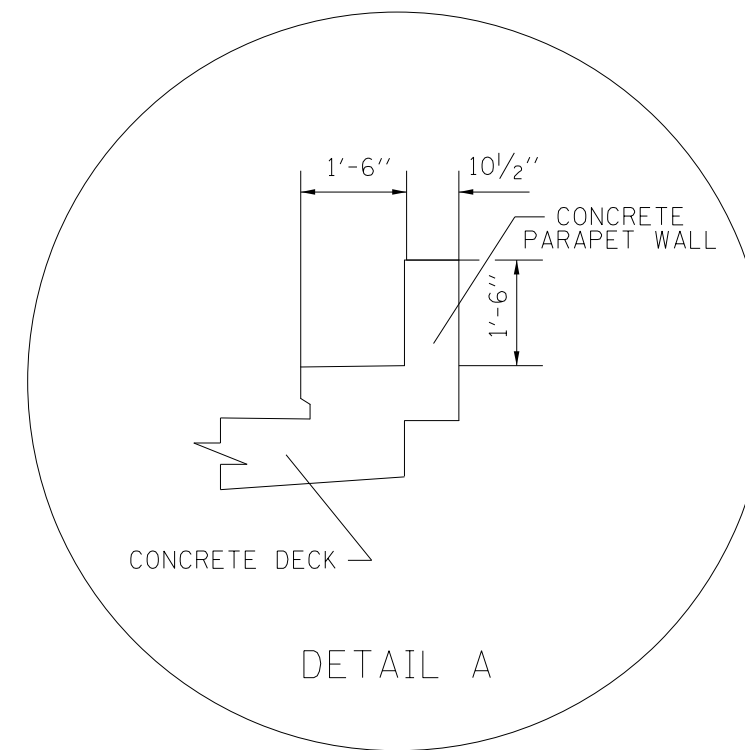

DETAIL A

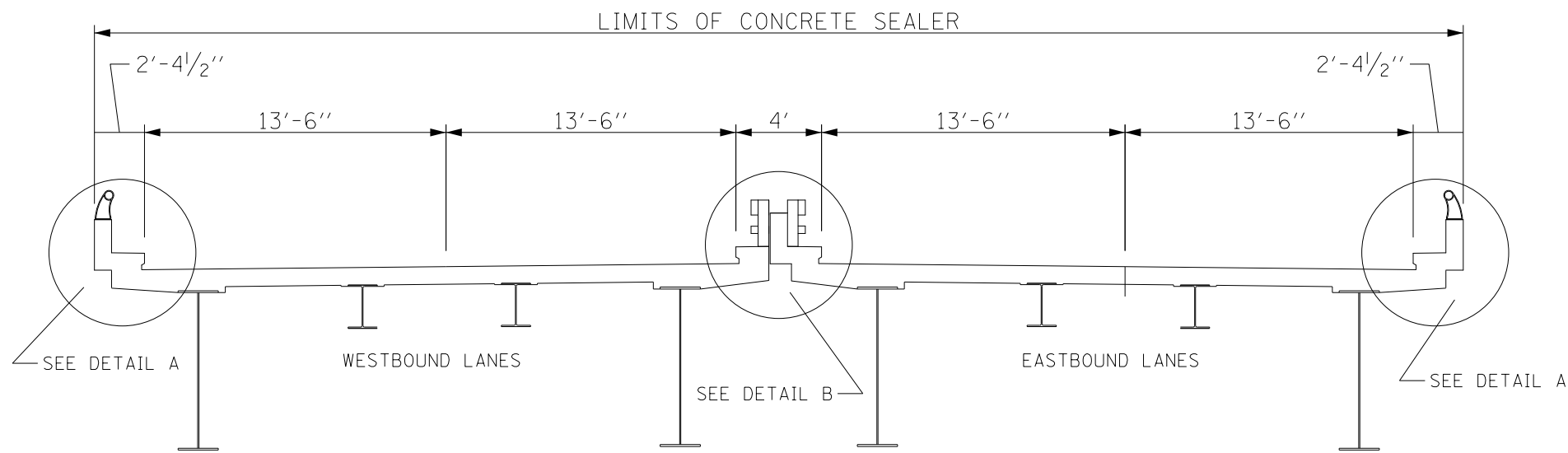

**EXISTING TYPICAL SECTION**  
**S.N. 060-0035 (MISSISSIPPI RIVER BRIDGE)**

STA. 786+50.00 TO STA. 1120+61.00  
 (STATION EQUATION: STA. 833+74.75 BK = STA. 1120+28.16 AH)

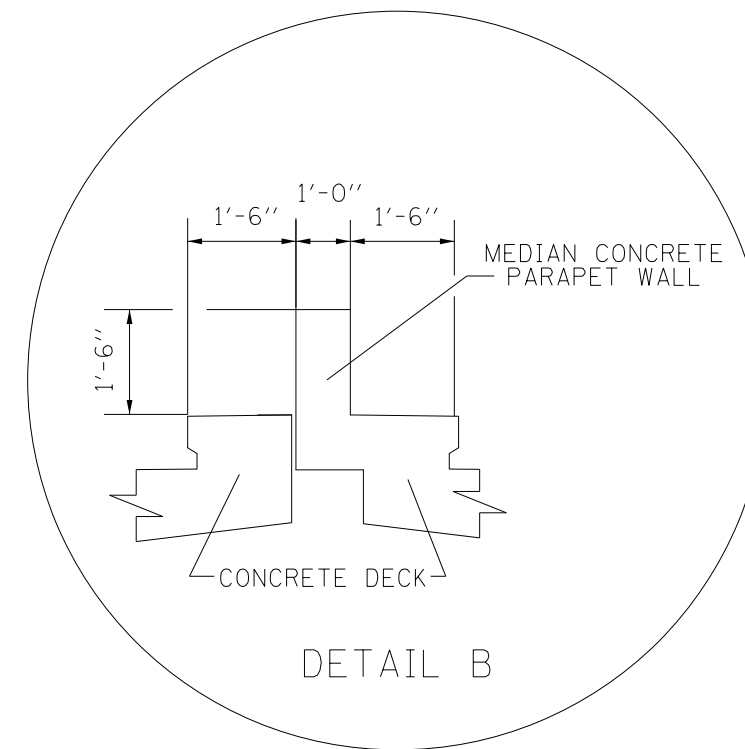

DETAIL B

MODEL: Default  
 FILE: Model: pic\uplanroom.dwg  
 PROJECT: 060-0035-1120+61.00-786+50.00  
 SHEET: 10 of 10  
 DATE: 12/10/2020

USER NAME = humphreysb	DESIGNED -	REVISED -
	DRAWN -	REVISED -
PLOT SCALE = 2,0000 ' / in.	CHECKED -	REVISED -
PLOT DATE = 12/10/2020	DATE -	REVISED -

**STATE OF ILLINOIS**  
**DEPARTMENT OF TRANSPORTATION**

**TYPICAL SECTION**  
**(SN 060-0035)**

SCALE: NTS SHEET 1 OF 1 SHEETS STA. TO STA.

F.A.I. RTE.	SECTION	COUNTY	TOTAL SHEETS	SHEET NO.
270	60-1BDS-1, 60-BDS-2	MADISON	10	7
ILLINOIS FED. AID PROJECT			CONTRACT NO. 76K69	

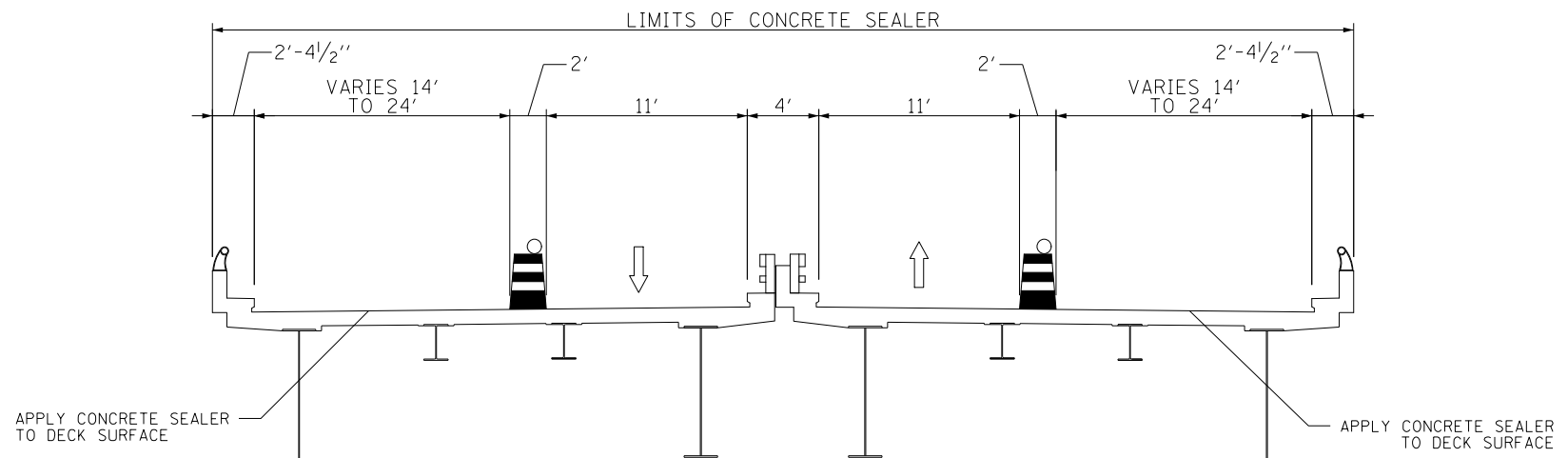

**STAGE 1**

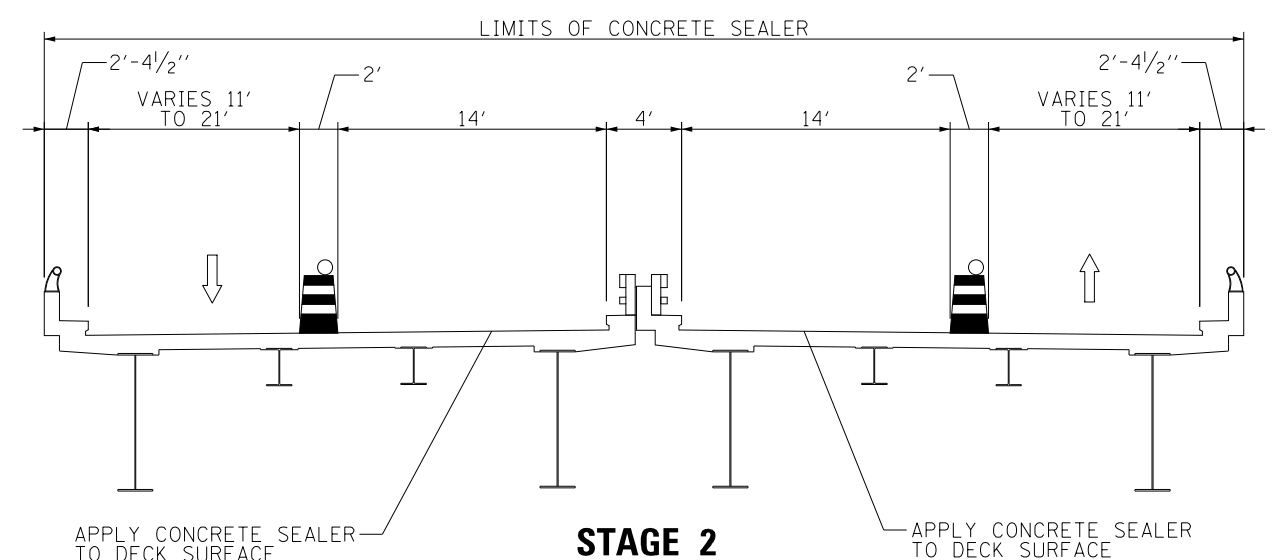

**STAGE 2**

**NOTES:**  
INDIVIDUAL LANE CLOSURE RESTRICTIONS ARE ALLOWED AS APPROVED BY THE ENGINEER.

**LANE CLOSURES SCHEDULE**

SUNDAY					MONDAY					TUESDAY					WEDNESDAY					THURSDAY					FRIDAY					SATURDAY																		
12A	3A	5A	9A	12P	3P	6P	9P	12A	3A	5A	9A	12P	3P	6P	9P	12A	3A	5A	9A	12P	3P	6P	9P	12A	3A	5A	9A	12P	3P	6P	9P	12A	3A	5A	9A	12P	3P	6P	9P	12A	3A	5A	9A	12P	3P	6P	9P	12A

**LEGEND**

	LANE CLOSURES ALLOWED		NO LANE CLOSURES ALLOWED
--	-----------------------	--	--------------------------

MODEL: Default  
 FILE: \\nrcs-pix\pub\room\da\illinois.gov\PIWIDOT\Documents\DOT\_Offices\District 8\Projects\0676669\CADDData\CAD\Sheets\0676669-511-1-1-1-1.dgn

USER NAME = humphreysb	DESIGNED -	REVISED -
	DRAWN -	REVISED -
PLOT SCALE = 2,0000' / in.	CHECKED -	REVISED -
PLOT DATE = 12/10/2020	DATE -	REVISED -

**STATE OF ILLINOIS  
DEPARTMENT OF TRANSPORTATION**

SUGGESTED STAGES OF CONSTRUCTION (SN 060-0035)			
SCALE: NTS	SHEET 1	OF 1 SHEETS	STA. TO STA.

F.A.I. RTE.	SECTION	COUNTY	TOTAL SHEETS	SHEET NO.
270	60-1BDS-1, 60-BDS-2	MADISON	10	8
ILLINOIS FED. AID PROJECT			CONTRACT NO. 76K69	





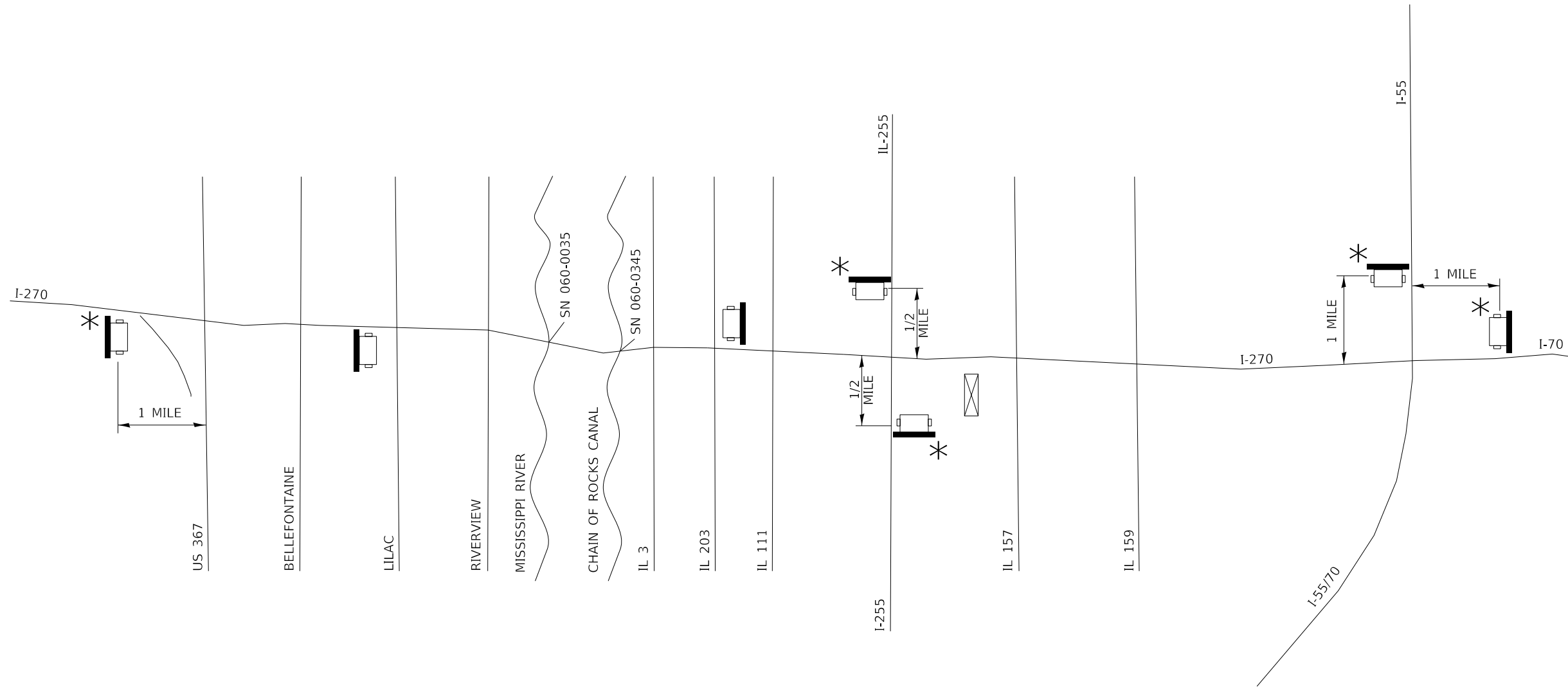
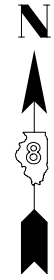

**LEGEND**

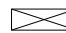
-  CHANGEABLE MESSAGE SIGN
-  DYNAMIC MESSAGE BOARD

**NOTES:**

- \* CHANGEABLE MESSAGE SIGNS INDICATED SHALL BE PLACED 2 WEEKS PRIOR TO ANY LANE CLOSURES.

MODEL: Default  
 FILE: \\nlsr-pix\plannerroom\dat\illinois.gov\PIVIDOT\Documents\IDOT\_Offices\District 8\Projects\IDOT7669\CADDData\CAD\sheet\IDOT7669-11-17-17\cal.dgn

USER NAME = humphreysb	DESIGNED -	REVISED -
	DRAWN -	REVISED -
PLOT SCALE = 2,0000' / in.	CHECKED -	REVISED -
PLOT DATE = 12/10/2020	DATE -	REVISED -

**STATE OF ILLINOIS  
DEPARTMENT OF TRANSPORTATION**

**CHANGEABLE MESSAGE SIGN LOCATION SKETCH  
(SN 060-0345 & SN 060-0035)**

SCALE: NTS      SHEET 1 OF 1 SHEETS      STA.      TO STA.

F.A.I. RTE.	SECTION	COUNTY	TOTAL SHEETS	SHEET NO.
270	60-1BDS-1, 60-BDS-2	MADISON	10	10
CONTRACT NO. 76K69				
		ILLINOIS	FED. AID PROJECT	