

F.A.P. RTE.	SECTION	COUNTY	TOTAL SHEETS	SHEET NO.
373	0707-608 HB-I-4	COOK	40	32
STA.	TO STA.			
FED. ROAD DIST. NO.	ILLINOIS	FED. AID PROJECT		

CONTRACT NO. 60C94

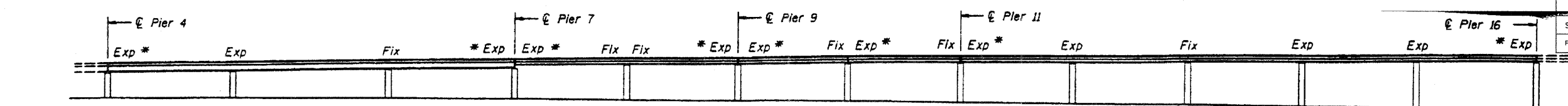

ELEVATION A-A

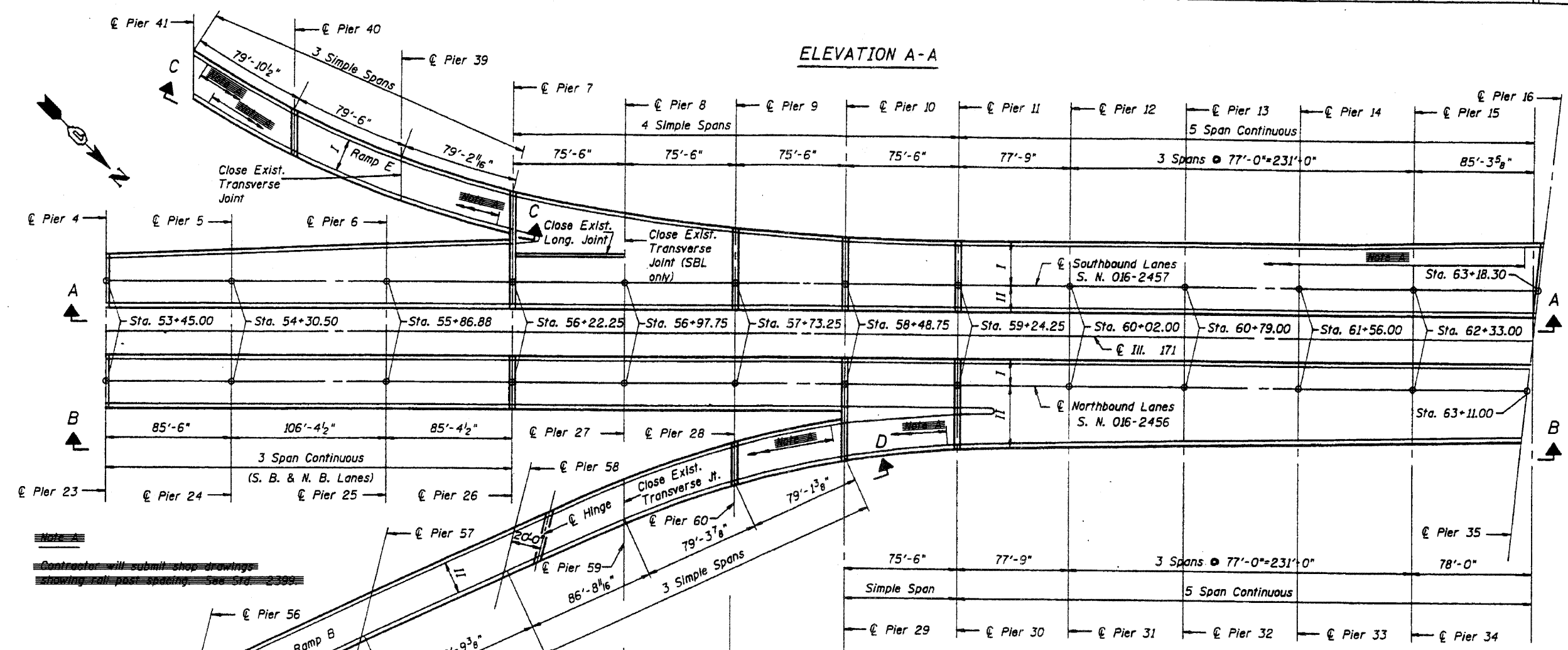

Note:
Contractor will submit shop drawings showing all post spacing. See Std. 2-399.

PLAN

Note: For Elevation C-C, Elevation D-D and Typical Deck Section, see sheet 2
* Indicates remove existing expansion bearing and replace with new Elastomeric Bearing.
I, II Indicates Stage I or Stage II Construction.

FOR INFORMATION ONLY

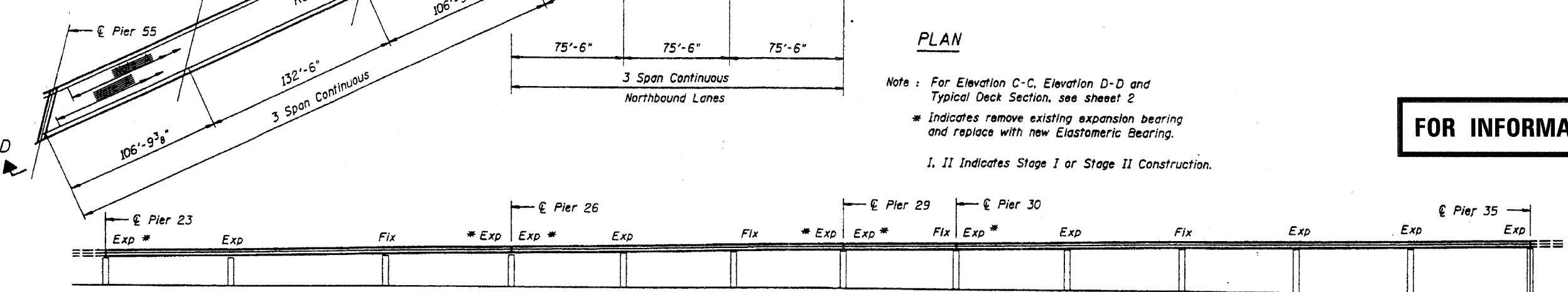

ILLINOIS DEPARTMENT OF TRANSPORTATION
GENERAL PLAN & ELEVATION
IL. RTE. 171
OVER
CHICAGO SANITARY AND SHIP CANAL
F.A.P. RTE. 373 SECTION: 0707-608 HB-I-4
COOK COUNTY STATION 58+29.83
S.N. 016-2457 & S.N. 016-2456
SCALE: NONE DRAWN BY: D.L./F.M.
DATE: DECEMBER 8, 2008 CHECKED BY: B.N.S./J.C.N.
CHRISTIAN-ROGE & ASSOC., INC.
CHICAGO ILLINOIS

REVISIONS	
NAME	DATE