

CONSTRUCTION NOTES:
 ① RE-STRIPE EXISTING THERMOPLASTIC PAVEMENT MARKING STOP LINE WITH HIGH VISIBILITY THERMOPLASTIC PAVEMENT MARKING STOP LINE 24" (TYP.)

RESTORATION OF WORK AREA RESTORATION OF THE TRAFFIC SIGNAL WORK AREA SHALL BE INCIDENTAL TO THE RELATED PAY ITEM SUCH AS FOUNDATION, CONDUIT, HANDHOLE, TRENCH AND BACKFILL, ETC., AND NO EXTRA COMPENSATION SHALL BE ALLOWED. ALL ROADWAY SURFACES SUCH AS SHOULDERS, MEDIAN, SIDEWALKS, PAVEMENT, ETC. SHALL BE REPLACED IN KIND. ALL DAMAGE TO MOWED LAWNS SHALL BE REPLACED WITH AN APPROVED SOD, AND ALL DAMAGE TO UNMOWED FIELDS SHALL BE SEEDED IN ACCORDANCE WITH STANDARD SPECIFICATIONS 252 AND 250 RESPECTIVELY.

TRAFFIC SIGNAL LEGEND

- | | | | |
|--|--|----------|--|
| CONTROLLER | | EXISTING | |
| RAILROAD CONTROL CABINET | | EXISTING | |
| SERVICE INSTALLATION, (P) POLE OR (G) GROUND MOUNTED | | EXISTING | |
| SIGNAL HEAD | | EXISTING | |
| SIGNAL HEAD WITH BACKPLATE | | EXISTING | |
| SIGNAL HEAD, PEDESTRIAN | | EXISTING | |
| SIGNAL POST | | EXISTING | |
| MAST ARM ASSEMBLY AND POLE, STEEL | | EXISTING | |
| MAST ARM ASSEMBLY AND POLE, ALUMINIUM | | EXISTING | |
| COMMON TRENCH | | EXISTING | |
| UNIT DUCT | | EXISTING | |
| HANDHOLE | | EXISTING | |
| HEAVY DUTY HANDHOLE | | EXISTING | |
| DOUBLE HANDHOLE | | EXISTING | |
| G.S.CONDUIT IN TRENCH OR PUSHED | | EXISTING | |
| CAST IRON JUNCTION BOX | | EXISTING | |
| SIGNAL HEAD OPTICALLY PROGRAMMED | | EXISTING | |
| CONDUIT SPLICE | | EXISTING | |
| WOOD POLE | | EXISTING | |
| RACEWAY FOR MAGNETIC DETECTOR, TYPE I OR TYPE II | | EXISTING | |
| VEHICLE DETECTOR, NON COMPENSATED MAGNETIC TYPE | | EXISTING | |
| RAILROAD CONTROL CABINET | | EXISTING | |
| ILLUMINATED SIGN, FIBER OPTIC "NO LEFT TURN" | | EXISTING | |
| ILLUMINATED SIGN, FIBER OPTIC "NO RIGHT TURN" | | EXISTING | |
| TELEPHONE CONNECTION | | EXISTING | |
| PEDESTRIAN PUSHBUTTON DETECTOR | | EXISTING | |
| DETECTOR LOOP, TYPE I | | EXISTING | |
| PREFORMED DETECTOR LOOP | | EXISTING | |
| VIDEO DETECTOR | | EXISTING | |
| CLOSED CIRCUIT TV | | EXISTING | |
| EMERGENCY VEHICLE SYSTEM DETECTOR | | EXISTING | |
| CONFIRMATION BEACON | | EXISTING | |
| UNINTERRUPTABLE POWER SUPPLY | | EXISTING | |
| PEDESTRIAN SIGNAL HEAD WITH COUNTDOWN TIMER | | EXISTING | |

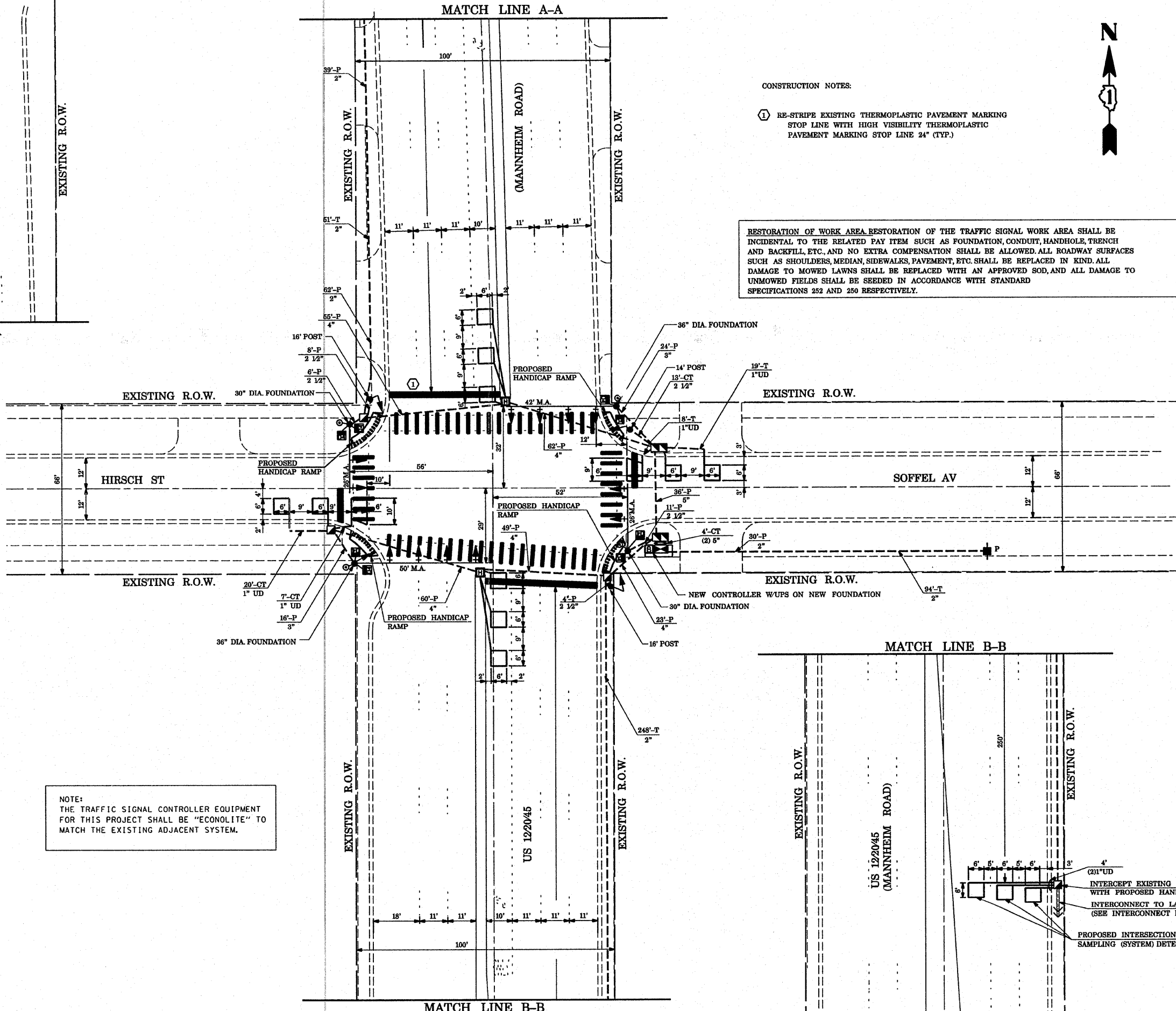

NOTE:
 THE TRAFFIC SIGNAL CONTROLLER EQUIPMENT FOR THIS PROJECT SHALL BE "ECONOLITE" TO MATCH THE EXISTING ADJACENT SYSTEM.

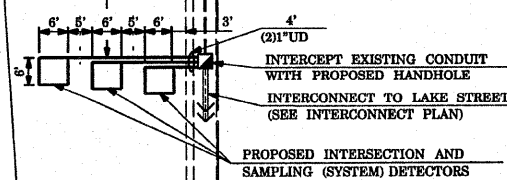

FILE NAME =	USER NAME = kanthaphixaybc	DESIGNED - N.B.	REVISED -	STATE OF ILLINOIS DEPARTMENT OF TRANSPORTATION	PROPOSED TRAFFIC SIGNAL PLAN US 12/20/45 (MANNHEIM RD) AT HIRSCH ST (SOFFEL AV)	F.A.P. RTE.	SECTION	COUNTY	TOTAL SHEETS	SHEET NO.	
ca\projects\traffic\070027\us12_20_45.dgn		DRAWN - N.B.	REVISED -			330	2008-006 TS	COOK	104	48	
PLOT SCALE = 40,0000' / IN.		CHECKED - D.B.	REVISED -			SCALE: 1" = 20'		SHEET NO. OF SHEETS STA. TO STA.		CONTRACT NO. 60E31	
PLOT DATE = 10/10/2008		DATE - 09/04/2008	REVISED -			FED. ROAD DIST. NO.		ILLINOIS FED. AID PROJECT			