

DECK PLAN

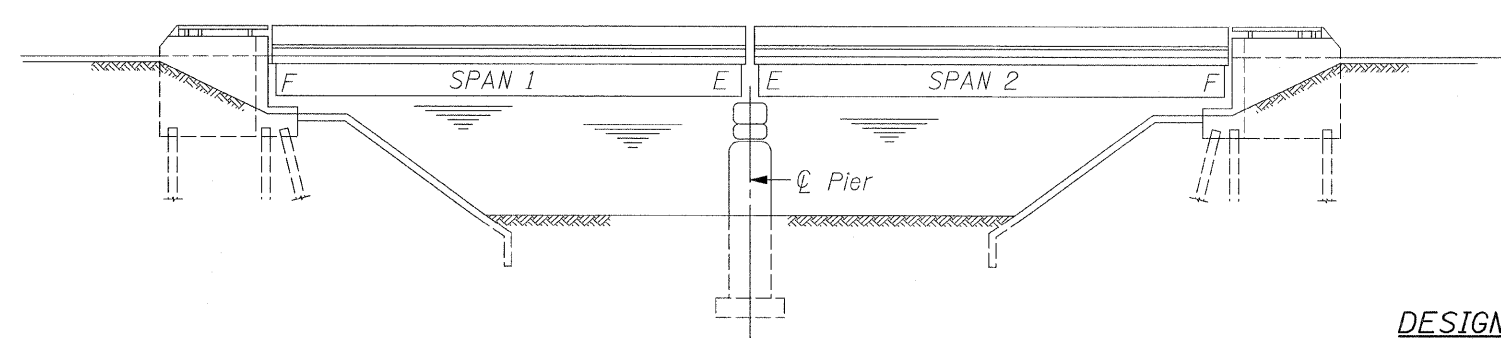

ELEVATION

**DESIGN STRESSES
FIELD UNITS**

$f'_c = 3,500 \text{ psi}$
 $f_y = 60,000 \text{ psi (Reinforcement)}$

**LOCATION OF
STRUCTURE**

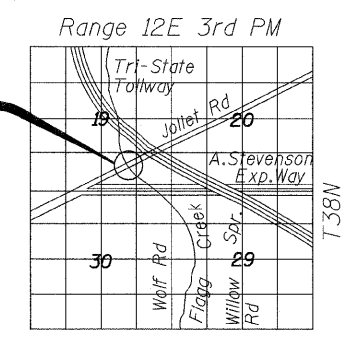

LOCATION SKETCH

GENERAL NOTES:

Plan Dimensions and Details Relative to Existing Plans are Subject to Nominal Construction Variations. The Contractor Shall Field Verify Existing Dimensions and Details Affecting New Construction and Make Necessary Approved Adjustments Prior to Construction or Ordering of Materials. Such Variations Shall not be Cause for Additional Compensation for a Change in the Scope of Work, However, the Contractor will be Paid for the Quantity Actually Furnished at the Unit Price Bid for the Work.

Existing Reinforcement Bars Extending into the Removal Areas Shall be Cleaned, Straightened and Incorporated into the New Construction. Any Reinforcement Bars that are Damaged During Concrete Removal Shall be Replaced with an Approved Bar Splicer or Anchorage System.

Areas of Deck Repairs Shown are Estimated. The Engineer Shall Show Actual Locations of deck Repairs on As-Built Plans.

The Contractor Shall use Extreme Care During Concrete Removal so as not to Damage the Existing P.P.C. I-Beam. Any Damage Done to the P.P.C. I-Beam is to be Repaired at the Contractor's Expense.

Reinforcement Bars Shall Conform to the Requirements of A.S.T.M. A-706, Grade 60. See Special Provisions.

Reinforcement Bars Designated (E) Shall be Epoxy Coated.

TOTAL BILL OF MATERIAL

ITEM	UNIT	QUANTITY
Deck Slab Repair (Full Depth, Type II)	Sq. Yd.	36
Deck Slab Repair (Partial)	Sq. Yd.	61
Silicone Joint Sealer, 1 ³ / ₄ "	Foot	238
Reinforcement Bars, Epoxy Coated	Pound	4,830
Concrete Removal	Cu. Yd.	15.0
Concrete Superstructure	Cu. Yd.	15.2
Protective Coat	Sq. Yd.	41
Structural Repair of Concrete (Depth Equal to or Less Than 5 In.)	Sq. Ft.	60
Structural Repair of Concrete (Depth Greater Than 5 In.)	Sq. Ft.	24
Temporary Shoring and Cribbing	Each	1
Polymer Concrete	Cu. Ft.	1



BHADRESH N. SHAH
 LICENSED STRUCTURAL ENGINEER
 STATE OF ILLINOIS LIC. No. 081-004476
 EXPIRES: 11-30-10



CHRISTIAN-ROGE & ASSOCIATES, INC.
 ENGINEERS / PLANNERS / SURVEYORS
 211 W. WACKER DRIVE CHICAGO, IL 60606
 PHONE: (312)372-2023 FAX: (312)372-5274

FILE NAME = plan_elevation.dgn	USER NAME = 100T	DESIGNED - B.N.S./J.C.N.	REVISED -
	PLOT SCALE = 50.0000' / IN.	DRAWN - F.M.	REVISED -
	PLOT DATE = 12/30/2008	CHECKED - B.N.S./J.C.N.	REVISED -
		DATE - DECEMBER, 2008	REVISED -

**STATE OF ILLINOIS
DEPARTMENT OF TRANSPORTATION**

**GENERAL PLAN & ELEVATION
JOLIET ROAD OVER FLAGG CREEK**
 S.N. 016-0393

F.A.U. RTE. 3562	SECTION 430 Y-1 BR	COUNTY COOK	TOTAL SHEETS 15	SHEET NO. 7
SCALE: SHEET NO. S1 OF S5 SHEETS STA. TO STA.			CONTRACT NO. 60E60	
FED. ROAD DIST. NO. ILLINOIS FED. AID PROJECT				