

DATE _____
 SURVEYED _____
 ALIGNED _____
 RT. OF WAY CHECKED _____
 PLOTTED _____
 FILE NAME _____

PLAN
 NO. _____

DATE _____
 SURVEYED _____
 GRADES CHECKED _____
 STRUCTURE NOTATION CHECKED _____

BY _____

DATE _____
 SURVEYED _____
 GRADES CHECKED _____
 STRUCTURE NOTATION CHECKED _____

NO. _____

DATE _____
 SURVEYED _____
 GRADES CHECKED _____
 STRUCTURE NOTATION CHECKED _____

NO. _____

CHRISTOPHER B. BURKE ENGINEERING LTD.
 9575 West Higgins Road, Suite 600
 Chicago, Illinois 60638
 (847) 823-9500

CONSTRUCTION NOTES:

1. THE EXISTING TRAFFIC SIGNALS SHALL REMAIN OPERATIONAL DURING INSTALLATION OF THE NEW TRAFFIC SIGNAL EQUIPMENT.
2. REMOVAL OF EXISTING TRAFFIC SIGNAL EQUIPMENT SHALL BE COMPLETED UPON ACTIVATION OF PROPOSED TRAFFIC SIGNAL.
3. RELOCATE EXISTING LIGHT DETECTORS AND CONFIRMATION BEACONS TO THE NEW MAST ARMS.
4. RELOCATE EXISTING LIGHT DETECTOR AMPLIFIER TO NEW CONTROLLER CABINET.
5. RELOCATE EXISTING MAILBOX IN THE NORTHWEST CORNER. CONTACT MIDLOTHIAN USPS POSTMASTER AT (708) 385-7900 TO DETERMINE FINAL LOCATION.

- EXISTING EQUIPMENT TO BE REMOVED LEGEND**
- "E" EXISTING SIGNAL HEAD TO BE REMOVED
 - "E" EXISTING SERVICE INSTALLATION TO BE REMOVED
 - "E" EXISTING SIGNAL POST AND FOUNDATION TO BE REMOVED
 - "E" EXISTING ALUMINUM MAST ARM POLE AND FOUNDATION TO BE REMOVED
 - "E" EXISTING CONTROLLER AND FOUNDATION TO BE REMOVED
 - "E" EXISTING HANDHOLE TO BE REMOVED
 - "E" EXISTING PEDESTRIAN SIGNAL HEAD TO BE REMOVED
 - "E" EXISTING PEDESTRIAN PUSHBUTTON TO BE REMOVED
 - "E" EMERGENCY VEHICLE LIGHT DETECTOR TO BE REMOVED
 - "E" CONFIRMATION BEACON TO BE REMOVED
 - "E" EXISTING HEAVY-DUTY HANDHOLE TO BE REMOVED
 - "E" EXISTING STEEL MAST ARM POLE AND FOUNDATION TO BE REMOVED
 - "R" RELOCATE
 - "A" ABANDON

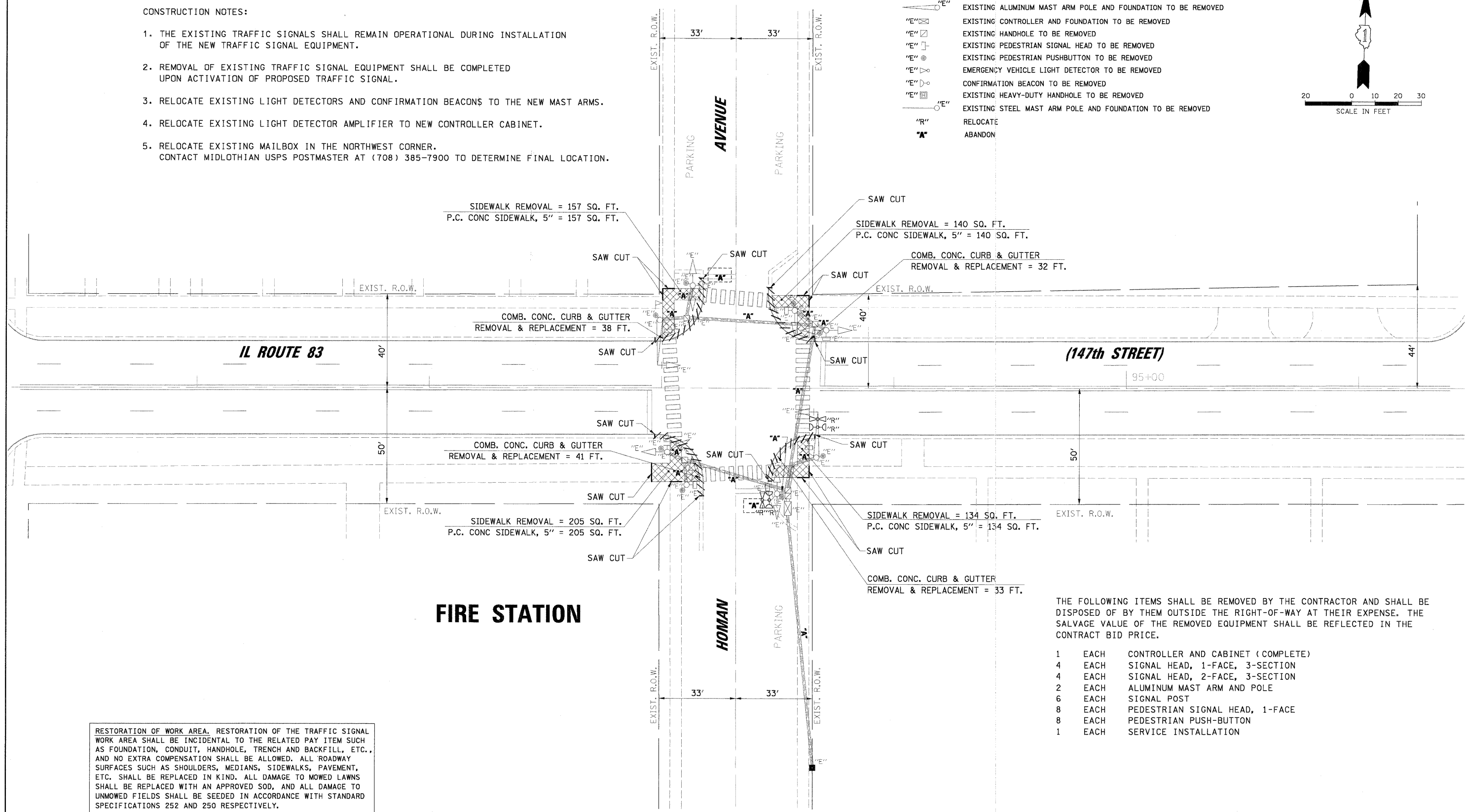
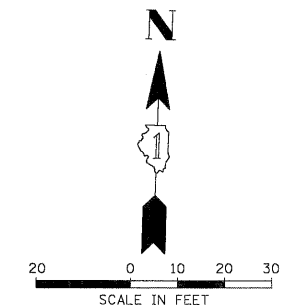

RESTORATION OF WORK AREA. RESTORATION OF THE TRAFFIC SIGNAL WORK AREA SHALL BE INCIDENTAL TO THE RELATED PAY ITEM SUCH AS FOUNDATION, CONDUIT, HANDHOLE, TRENCH AND BACKFILL, ETC., AND NO EXTRA COMPENSATION SHALL BE ALLOWED. ALL ROADWAY SURFACES SUCH AS SHOULDERS, MEDIANS, SIDEWALKS, PAVEMENT, ETC. SHALL BE REPLACED IN KIND. ALL DAMAGE TO MOWED LAWNS SHALL BE REPLACED WITH AN APPROVED SOD, AND ALL DAMAGE TO UNMOWED FIELDS SHALL BE SEEDED IN ACCORDANCE WITH STANDARD SPECIFICATIONS 252 AND 250 RESPECTIVELY.

THE FOLLOWING ITEMS SHALL BE REMOVED BY THE CONTRACTOR AND SHALL BE DISPOSED OF BY THEM OUTSIDE THE RIGHT-OF-WAY AT THEIR EXPENSE. THE SALVAGE VALUE OF THE REMOVED EQUIPMENT SHALL BE REFLECTED IN THE CONTRACT BID PRICE.

- | | | |
|---|------|-----------------------------------|
| 1 | EACH | CONTROLLER AND CABINET (COMPLETE) |
| 4 | EACH | SIGNAL HEAD, 1-FACE, 3-SECTION |
| 4 | EACH | SIGNAL HEAD, 2-FACE, 3-SECTION |
| 2 | EACH | ALUMINUM MAST ARM AND POLE |
| 6 | EACH | SIGNAL POST |
| 8 | EACH | PEDESTRIAN SIGNAL HEAD, 1-FACE |
| 8 | EACH | PEDESTRIAN PUSH-BUTTON |
| 1 | EACH | SERVICE INSTALLATION |