

CONSTRUCTION NOTES:

1. THE EXISTING TRAFFIC SIGNALS SHALL REMAIN OPERATIONAL DURING INSTALLATION OF THE NEW TRAFFIC SIGNAL EQUIPMENT.
2. REMOVAL OF EXISTING TRAFFIC SIGNAL EQUIPMENT SHALL BE COMPLETED UPON ACTIVATION OF PROPOSED TRAFFIC SIGNAL.
3. RELOCATE EXISTING LIGHT DETECTORS AND CONFIRMATION BEACONS TO THE NEW MAST ARMS.
4. RELOCATE EXISTING LIGHT DETECTOR AMPLIFIER TO NEW CONTROLLER CABINET.

EXISTING EQUIPMENT TO BE REMOVED LEGEND

- "E" EXISTING SIGNAL HEAD TO BE REMOVED
- "E" EXISTING SERVICE INSTALLATION TO BE REMOVED
- "E" EXISTING SIGNAL POST AND FOUNDATION TO BE REMOVED
- "E" EXISTING ALUMINUM MAST ARM POLE AND FOUNDATION TO BE REMOVED
- "E" EXISTING CONTROLLER AND FOUNDATION TO BE REMOVED
- "E" EXISTING HANDHOLE TO BE REMOVED
- "E" EXISTING PEDESTRIAN SIGNAL HEAD TO BE REMOVED
- "E" EXISTING PEDESTRIAN PUSHBUTTON TO BE REMOVED
- "E" EMERGENCY VEHICLE LIGHT DETECTOR TO BE REMOVED
- "E" CONFIRMATION BEACON TO BE REMOVED
- "E" EXISTING HEAVY-DUTY HANDHOLE TO BE REMOVED
- "E" EXISTING STEEL MAST ARM POLE AND FOUNDATION TO BE REMOVED
- "R" RELOCATE
- "A" ABANDON

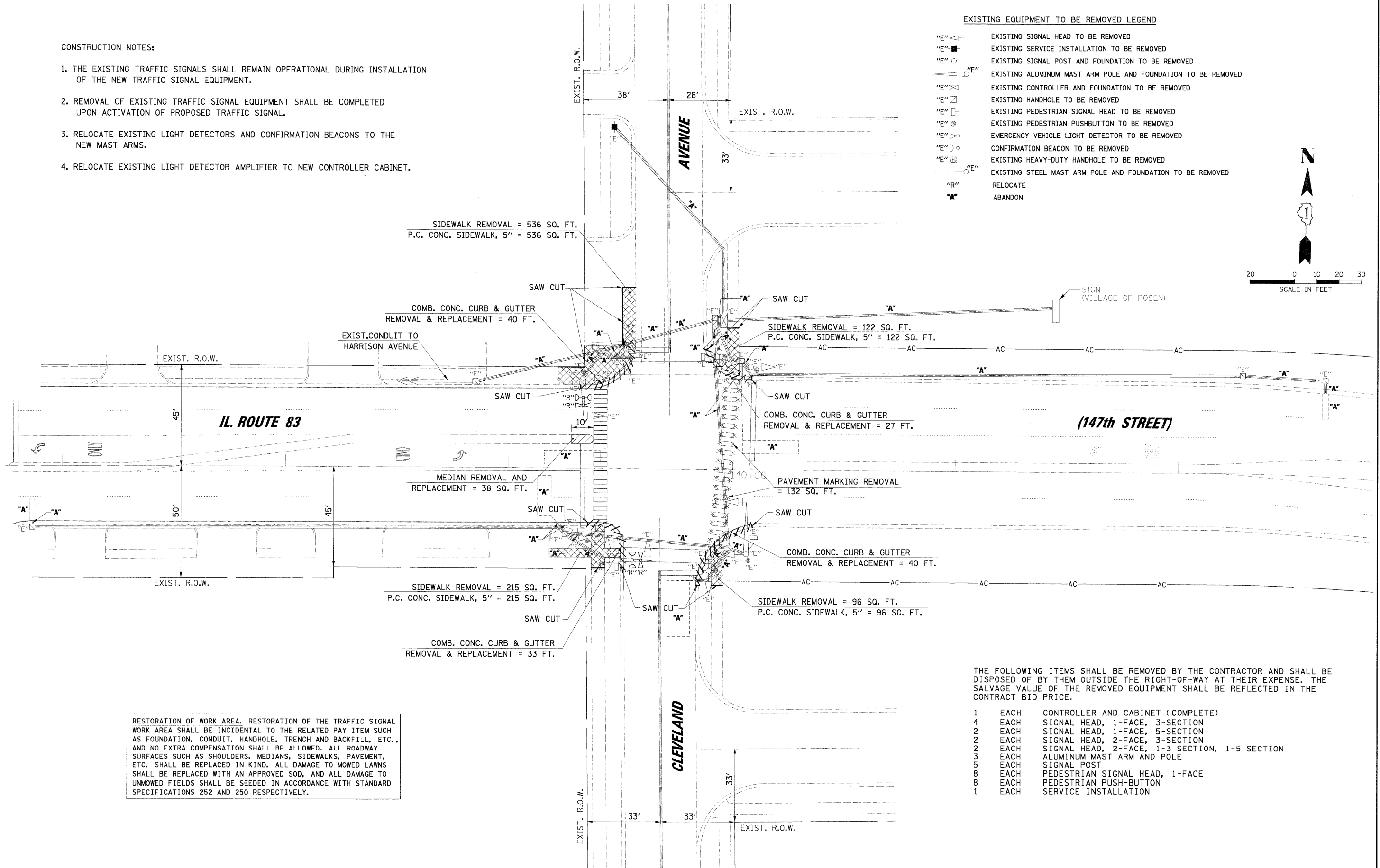
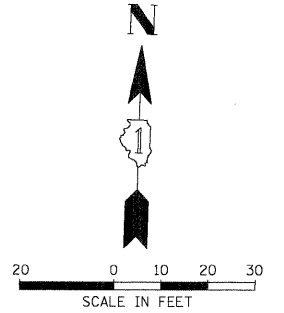

RESTORATION OF WORK AREA. RESTORATION OF THE TRAFFIC SIGNAL WORK AREA SHALL BE INCIDENTAL TO THE RELATED PAY ITEM SUCH AS FOUNDATION, CONDUIT, HANDHOLE, TRENCH AND BACKFILL, ETC., AND NO EXTRA COMPENSATION SHALL BE ALLOWED. ALL ROADWAY SURFACES SUCH AS SHOULDERS, MEDIANS, SIDEWALKS, PAVEMENT, ETC. SHALL BE REPLACED IN KIND. ALL DAMAGE TO MOWED LAWNS SHALL BE REPLACED WITH AN APPROVED SOD, AND ALL DAMAGE TO UNMOWED FIELDS SHALL BE SEEDED IN ACCORDANCE WITH STANDARD SPECIFICATIONS 252 AND 250 RESPECTIVELY.

THE FOLLOWING ITEMS SHALL BE REMOVED BY THE CONTRACTOR AND SHALL BE DISPOSED OF BY THEM OUTSIDE THE RIGHT-OF-WAY AT THEIR EXPENSE. THE SALVAGE VALUE OF THE REMOVED EQUIPMENT SHALL BE REFLECTED IN THE CONTRACT BID PRICE.

- 1 EACH CONTROLLER AND CABINET (COMPLETE)
- 4 EACH SIGNAL HEAD, 1-FACE, 3-SECTION
- 2 EACH SIGNAL HEAD, 1-FACE, 5-SECTION
- 2 EACH SIGNAL HEAD, 2-FACE, 3-SECTION
- 2 EACH SIGNAL HEAD, 2-FACE, 1-3 SECTION, 1-5 SECTION
- 3 EACH ALUMINUM MAST ARM AND POLE
- 5 EACH SIGNAL POST
- 8 EACH PEDESTRIAN SIGNAL HEAD, 1-FACE
- 8 EACH PEDESTRIAN PUSH-BUTTON
- 1 EACH SERVICE INSTALLATION

DATE	DATE
BY	BY
PROJECT	PROJECT
NOTE BOOK	NOTE BOOK
NO.	NO.
STRUCTURE	STRUCTURE
NOTATIONS	NOTATIONS
CRK/G	CRK/G

CHRISTOPHER B. BURKE ENGINEERING LTD.
 3575 West Higgins Road, Suite 600
 Rosemont, Illinois 60018
 (847) 825-0500