

PROFILE  
 DATE: \_\_\_\_\_  
 BY: \_\_\_\_\_  
 CHECKED: \_\_\_\_\_  
 GRADES: \_\_\_\_\_  
 STRUCTURE: \_\_\_\_\_  
 NOTES: \_\_\_\_\_  
 NO. \_\_\_\_\_

PLAN  
 DATE: \_\_\_\_\_  
 SURVEYED: \_\_\_\_\_  
 ALIGNED: \_\_\_\_\_  
 CHECKED: \_\_\_\_\_  
 BY: \_\_\_\_\_  
 NO. \_\_\_\_\_

**CHRISTOPHER B. BURKE ENGINEERING LTD.**  
 3515 West Higgins Road, Suite 600  
 Chicago, Illinois 60638  
 (847) 823-0500

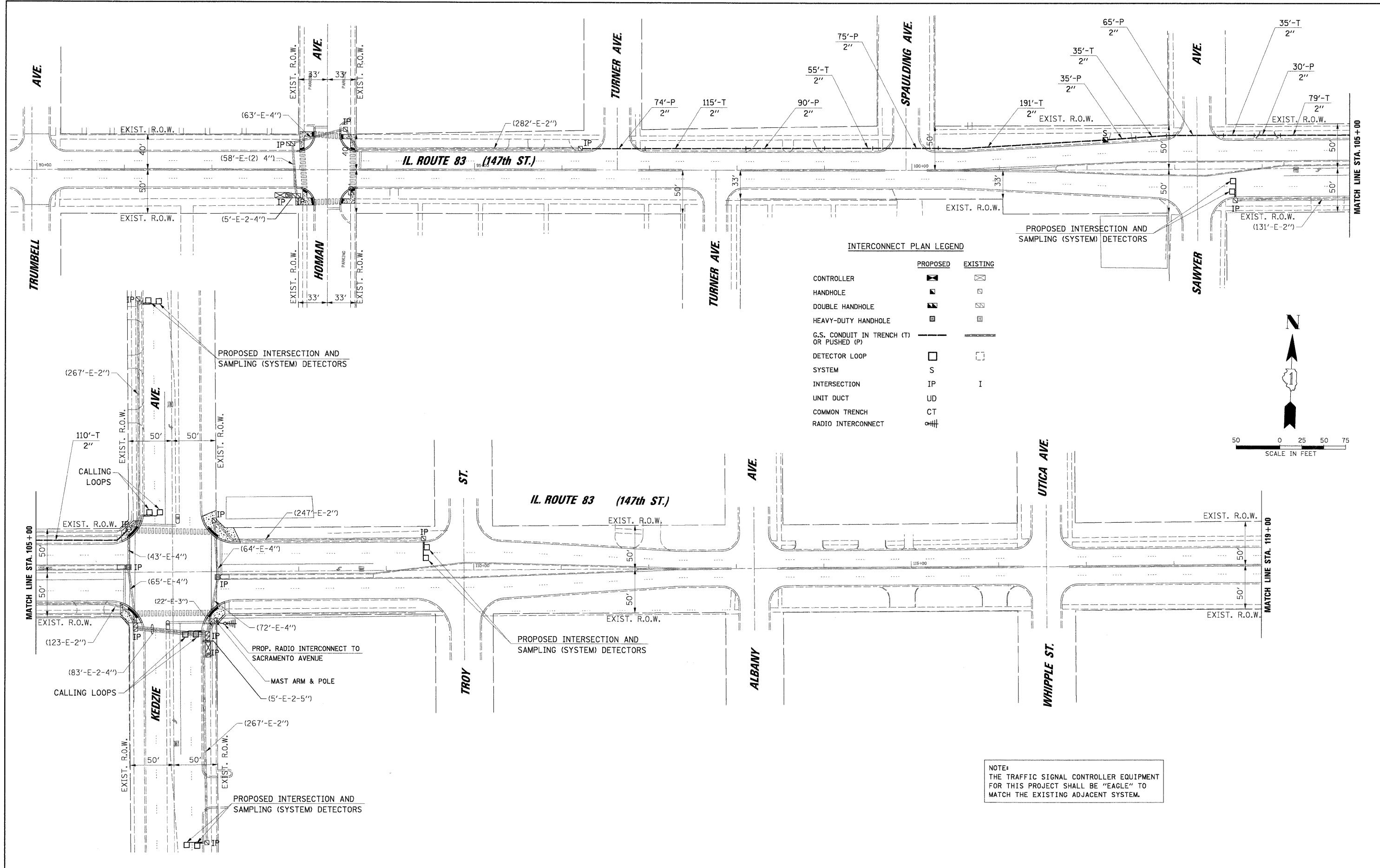

**INTERCONNECT PLAN LEGEND**

	PROPOSED	EXISTING
CONTROLLER	☒	☑
HANDHOLE	◼	◻
DOUBLE HANDHOLE	◼◼	◻◻
HEAVY-DUTY HANDHOLE	◼	◼
G.S. CONDUIT IN TRENCH (T) OR PUSHED (P)	—	—
DETECTOR LOOP	◻	◻
SYSTEM	S	I
INTERSECTION	IP	I
UNIT DUCT	UD	
COMMON TRENCH	CT	
RADIO INTERCONNECT	⊕	

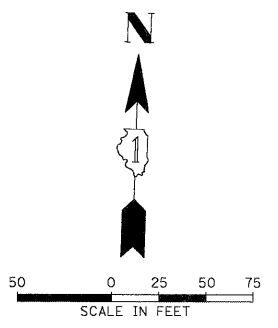

**NOTE:**  
 THE TRAFFIC SIGNAL CONTROLLER EQUIPMENT FOR THIS PROJECT SHALL BE "EAGLE" TO MATCH THE EXISTING ADJACENT SYSTEM.

FILE NAME = N:\dot\080804\TASK 0 - IL B3\Traffic\INTL	USER NAME = FPACIONE IL83.dgn	DESIGNED - ABR	REVISED -	<b>STATE OF ILLINOIS DEPARTMENT OF TRANSPORTATION</b>	<b>INTERCONNECT PLAN IL. ROUTE 83 (147th STREET) FROM HOMAN AVENUE TO EAST OF I-57 RAMPS</b>	F.A.U. RTE. 1602	SECTION 2008-054 TS	COUNTY COOK	TOTAL SHEETS 40	SHEET NO. 28		
	PLOT SCALE = 50'	CHECKED - MJT	REVISED -			SCALE: 1"= 50'	SHEET NO. OF SHEETS STA. TO STA.	CONTRACT NO. 60F06				
	PLOT DATE = 11/24/2008	DATE -	REVISED -			ILLINOIS FED. AID PROJECT						