

PROFILE SURVEYED: _____ DATE: _____
 GRADES CHECKED: _____
 PLAN NO. _____
 NOTE BOOK NO. _____
 STRUCTURE NOTATION CHRG. _____
 SURVEYED: _____ DATE: _____
 GRADES CHECKED: _____
 PLAN NO. _____
 NOTE BOOK NO. _____
 STRUCTURE NOTATION CHRG. _____

CHRISTOPHER B. BURKE ENGINEERING LTD.
 9575 West Higgins Road, Suite 600
 Chicago, Illinois 60618
 (847) 823-0500

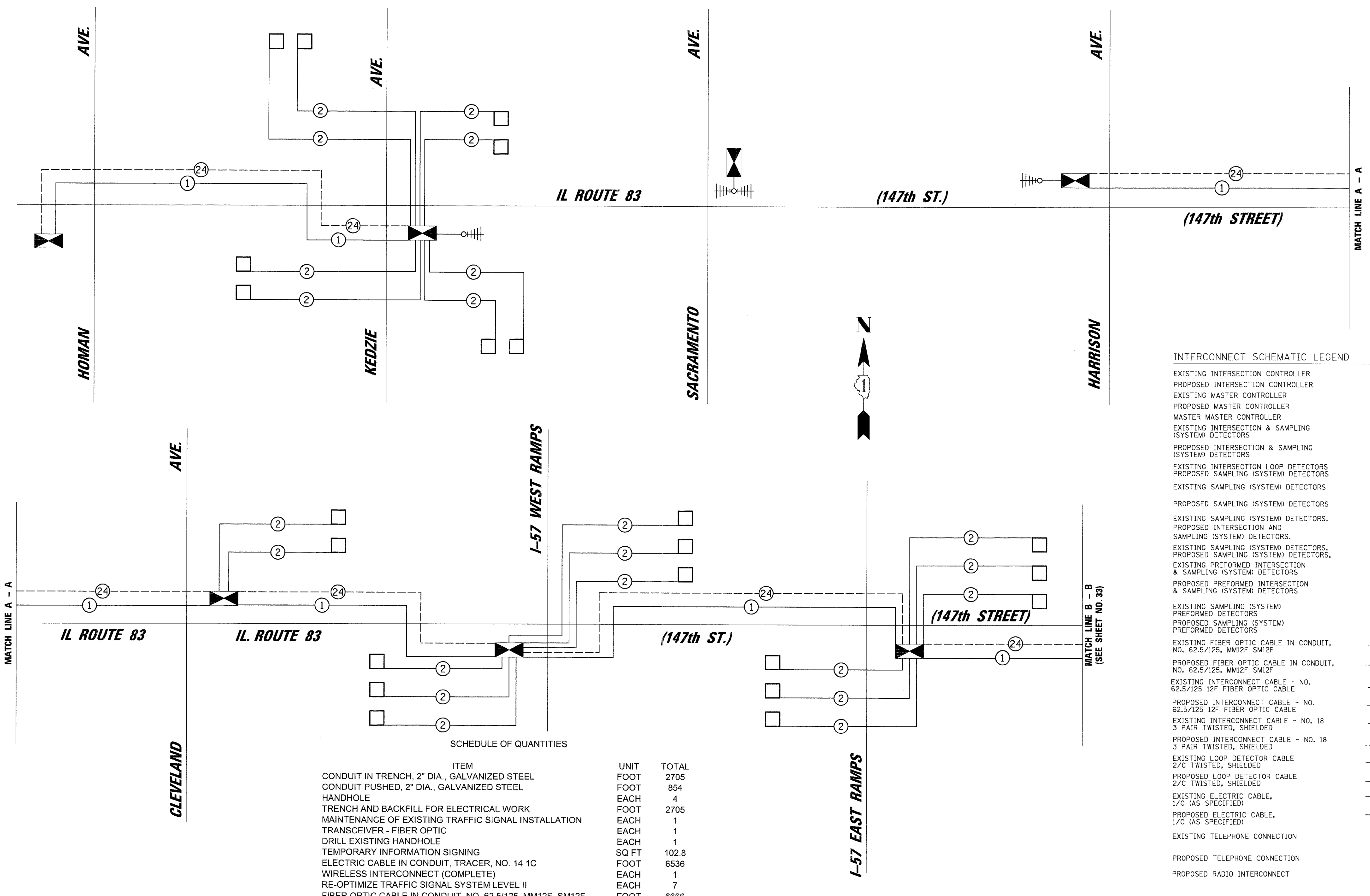

INTERCONNECT SCHEMATIC LEGEND

EXISTING INTERSECTION CONTROLLER	
PROPOSED INTERSECTION CONTROLLER	
EXISTING MASTER CONTROLLER	
PROPOSED MASTER CONTROLLER	
MASTER MASTER CONTROLLER	
EXISTING INTERSECTION & SAMPLING (SYSTEM) DETECTORS	
PROPOSED INTERSECTION & SAMPLING (SYSTEM) DETECTORS	
EXISTING INTERSECTION LOOP DETECTORS	
PROPOSED SAMPLING (SYSTEM) DETECTORS	
EXISTING SAMPLING (SYSTEM) DETECTORS	
PROPOSED SAMPLING (SYSTEM) DETECTORS	
EXISTING SAMPLING (SYSTEM) DETECTORS, PROPOSED INTERSECTION AND SAMPLING (SYSTEM) DETECTORS.	
EXISTING SAMPLING (SYSTEM) DETECTORS, PROPOSED SAMPLING (SYSTEM) DETECTORS.	
EXISTING PREFORMED INTERSECTION & SAMPLING (SYSTEM) DETECTORS	
PROPOSED PREFORMED INTERSECTION & SAMPLING (SYSTEM) DETECTORS	
EXISTING SAMPLING (SYSTEM) PREFORMED DETECTORS	
PROPOSED SAMPLING (SYSTEM) PREFORMED DETECTORS	
EXISTING FIBER OPTIC CABLE IN CONDUIT, NO. 62.5/125, MM12F SM12F	
PROPOSED FIBER OPTIC CABLE IN CONDUIT, NO. 62.5/125, MM12F SM12F	
EXISTING INTERCONNECT CABLE - NO. 62.5/125 12F FIBER OPTIC CABLE	
PROPOSED INTERCONNECT CABLE - NO. 62.5/125 12F FIBER OPTIC CABLE	
EXISTING INTERCONNECT CABLE - NO. 18 3 PAIR TWISTED, SHIELDED	
PROPOSED INTERCONNECT CABLE - NO. 18 3 PAIR TWISTED, SHIELDED	
EXISTING LOOP DETECTOR CABLE 2/C TWISTED, SHIELDED	
PROPOSED LOOP DETECTOR CABLE 2/C TWISTED, SHIELDED	
EXISTING ELECTRIC CABLE, 1/C (AS SPECIFIED)	
PROPOSED ELECTRIC CABLE, 1/C (AS SPECIFIED)	
EXISTING TELEPHONE CONNECTION	
PROPOSED TELEPHONE CONNECTION	
PROPOSED RADIO INTERCONNECT	