

STATE OF ILLINOIS DEPARTMENT OF TRANSPORTATION

INDEX OF STRUCTURAL SHEETS

SHT. NO.	DESCRIPTION
15	GENERAL PLAN, ELEVATION AND INDEX
16	HEADWALL DETAILS
17	WINGWALL DETAILS

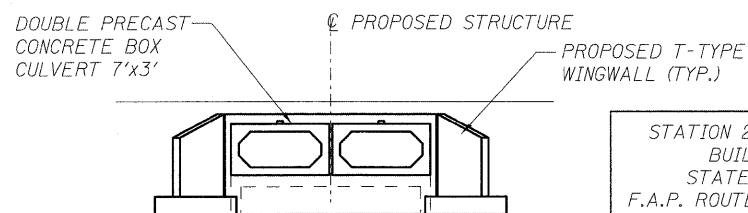

STATION 267+59 (PROJECT)
BUILT 200 BY
STATE OF ILLINOIS
F.A.P. ROUTE 349 SEC. 15 T-1
LOADING HS20
STR. NO. 099-0508

NAME PLATE
See Std. 515001

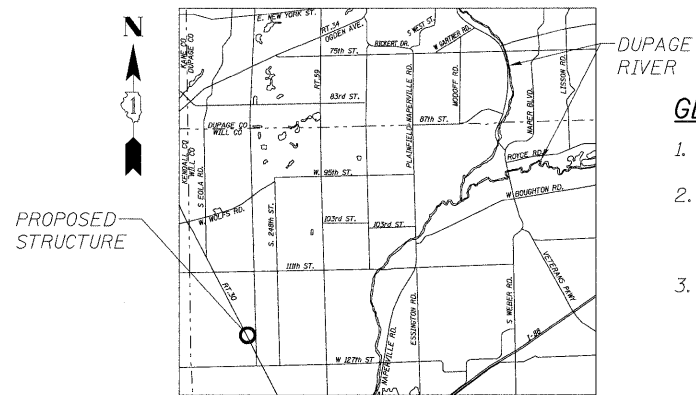

LOCATION SKETCH

GENERAL NOTES

1. EXISTING STRUCTURE: NOT SALVAGEABLE. THE NEW STRUCTURE NUMBER IS 099-0508.
2. THE PROPOSED PRECAST CONCRETE BOX CULVERT SHALL BE DESIGNED BY THE CONTRACTOR ACCORDING TO THE REQUIREMENTS OF AASHTO M273. COST IS INCLUDED IN PRECAST CONCRETE BOX CULVERT 7'x3' ITEM.
3. FLOW OF THE CREEK UNDER US ROUTE 30 IS TO BE MAINTAINED AT ALL TIMES DURING CONSTRUCTION BY PLACE A TEMPORARY STREAM DIVERSION AT THE UPSTREAM END OF THE BOX CULVERT/ WINGWALLS AND TEMPORARILY PUMPING OR OTHERWISE CONVEYING THE STREAM FLOW THROUGH THE WORK ZONE. THE DESIGN AND CONSTRUCTION OF THE TEMPORARY DIVERSION SHALL BE THE CONTRACTOR'S RESPONSIBILITY, AND THE COST SHALL BE INCLUDED IN CONCRETE BOX CULVERTS ITEM. THE TEMPORARY STREAM DIVERSION PLAN TO BE USED BY THE CONTRACTOR SHALL BE SUBMITTED TO THE ENGINEER FOR APPROVAL PRIOR TO COMMENCING WORK.
4. ALL CONSTRUCTION JOINTS SHALL BE BONDED.
5. THE INFORMATION SHOWN IN THESE PLANS CONCERNING THE TYPE AND LOCATION OF UTILITIES IS NOT GUARANTEED TO BE ACCURATE OR ALL-INCLUSIVE. THE CONTRACTOR IS RESPONSIBLE FOR MAKING HIS OWN DETERMINATION AS TO THE EXISTENCE, TYPE, SIZE AND LOCATION OF ALL UNDERGROUND AND OVERHEAD UTILITIES AS MAY BE NECESSARY TO AVOID CONFLICT WITH CONSTRUCTION OPERATIONS AND/OR DAMAGE TO THE UTILITY.
6. THE CONTRACTOR IS TO PROTECT AND MAINTAIN ALL EXISTING UTILITIES. THIS WORK WILL NOT BE PAID FOR SEPARATELY, BUT SHALL BE CONSIDERED INCIDENTAL TO PRECAST CONCRETE BOX CULVERT 7'x3'.
7. THE CONTRACTOR IS TO PROTECT AND MAINTAIN ALL TREES WITHIN AND ADJACENT TO THE WORK ZONE FOR THIS PROJECT. THIS WORK WILL NOT BE PAID FOR SEPARATELY, BUT SHALL BE CONSIDERED INCIDENTAL TO PRECAST CONCRETE BOX CULVERT 6'x6'.
8. REINFORCEMENT BARS SHALL CONFORM TO THE REQUIREMENTS OF ASTM A 706 GR 60 (IL MODIFIED). SEE SPECIAL PROVISIONS.
9. REINFORCEMENT BARS DESIGNATED (E) SHALL BE EPOXY COATED.
10. THE CONTRACTOR SHALL SUBMIT A PLAN AND SCHEDULE OF CONSTRUCTION ACTIVITIES TO THE ENGINEER FOR APPROVAL BEFORE STARTING ANY WORK FOR THIS PROJECT.
11. AS-BUILT/ACTUAL DETAILS OF EXISTING BOX CULVERT AND WINGWALLS ARE NOT AVAILABLE. THE CONTRACTOR SHALL FIELD VERIFY ACTUAL EXISTING STRUCTURE TO BE REMOVED.
12. THE COST 6" OF CA 7 UNDER CULVERT SHALL BE INCLUDED IN THE PRECAST CONCRETE BOX CULVERT 7'x3' ITEM.

DOWNSTREAM END ELEVATION

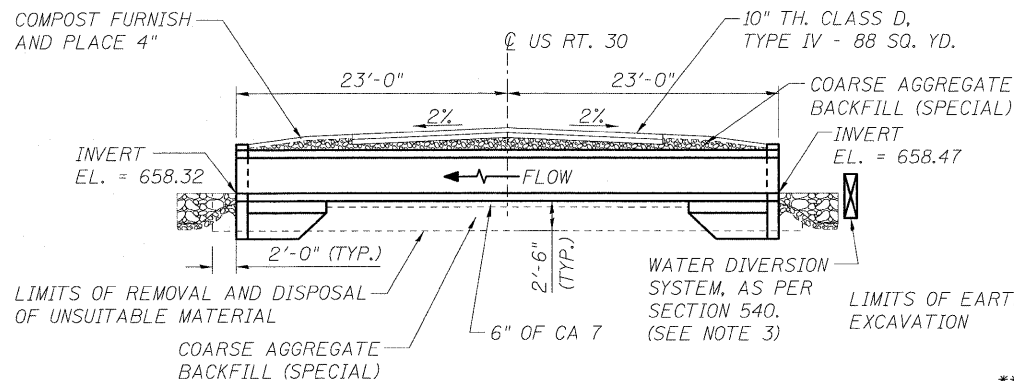

**LONGITUDINAL SECTION
AT CULVERT, LOOKING NORTH**

**SECTION THROUGH
PRECAST BARREL**

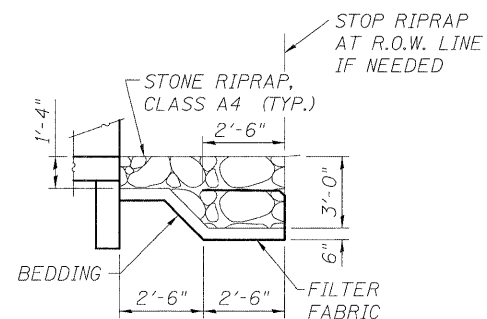

SECTION THRU RIPRAP

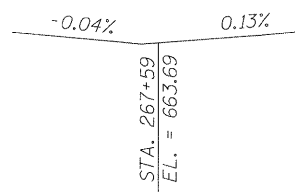

**PROFILE GRADE
(ALONG CULVERT ROADWAY)**

DESIGN LOADING

HS20-44 AND ALTERNATE MILITARY LOADING AND ALLOWANCE FOR 50 P.S.F. FUTURE WEARING SURFACE

DESIGN SPECIFICATIONS

AMERICAN ASSOCIATION OF STATE HIGHWAY AND TRANSPORTATION OFFICIALS (AASHTO) STANDARD SPECIFICATIONS FOR HIGHWAY BRIDGES, 2002

DESIGN STRESSES

FIELD UNITS	PRECAST UNITS
$f'_c = 3,500$ psi	$f'_c = 5,000$ psi
$f_y = 60,000$ psi (REINFORCEMENT)	$f_y = 65,000$ psi (WWF)
	$f_y = 60,000$ psi (REINFORCEMENT)

SEISMIC DATA

Seismic Performance Zone (SPZ) = 1
Horizontal Bedrock Acceleration Coefficient (A) = 3.5%g
Site Coefficient (S) = 1.0

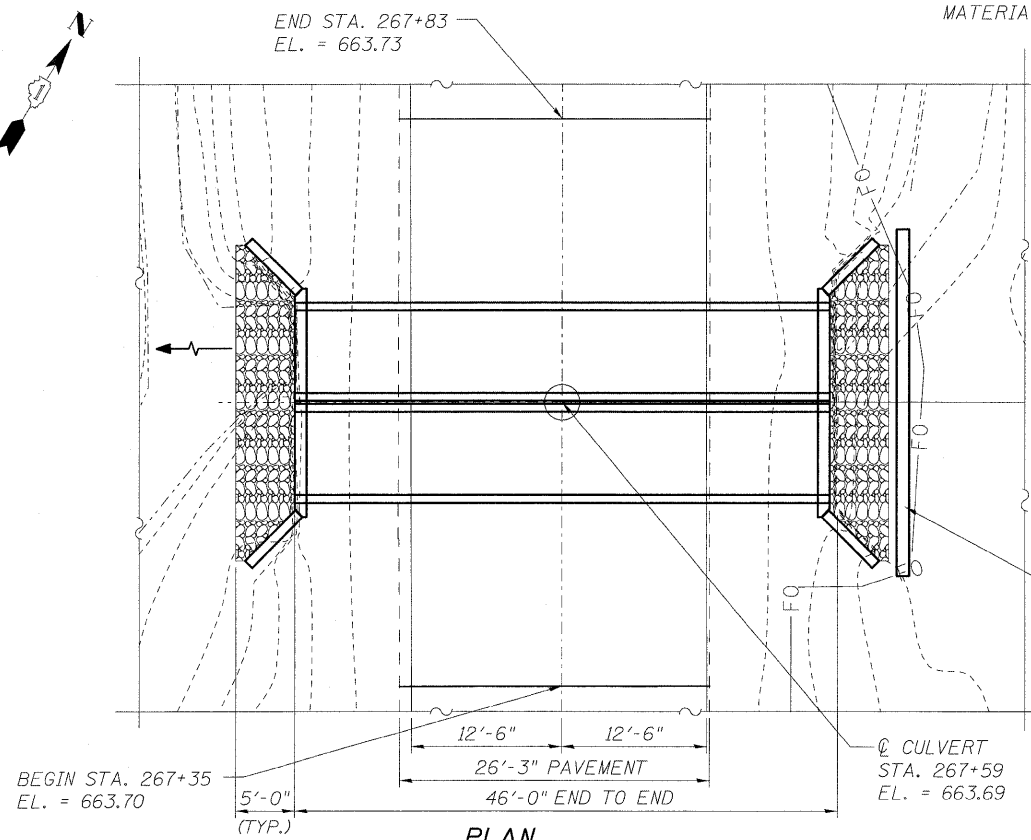

PLAN

DESIGNED - WHE	REVISED -
DRAWN - ST	REVISED -
CHECKED - WHE	REVISED -
DATE - 01/21/2009	REVISED -

F.A.P. RTE.	SECTION	COUNTY	TOTAL SHEETS	SHEET NO.
349	15 T-1	WILL	20	15
D-91-215-09			CONTRACT NO. 60F69	
ILLINOIS FED. AID PROJECT				