

PLAN	DATE
BY	
DESIGNED	
DRAWN	
CHECKED	
NOTED	
NO.	
FILE NAME	

PROFILE	DATE
BY	
DESIGNED	
DRAWN	
CHECKED	
NOTED	
NO.	
FILE NAME	

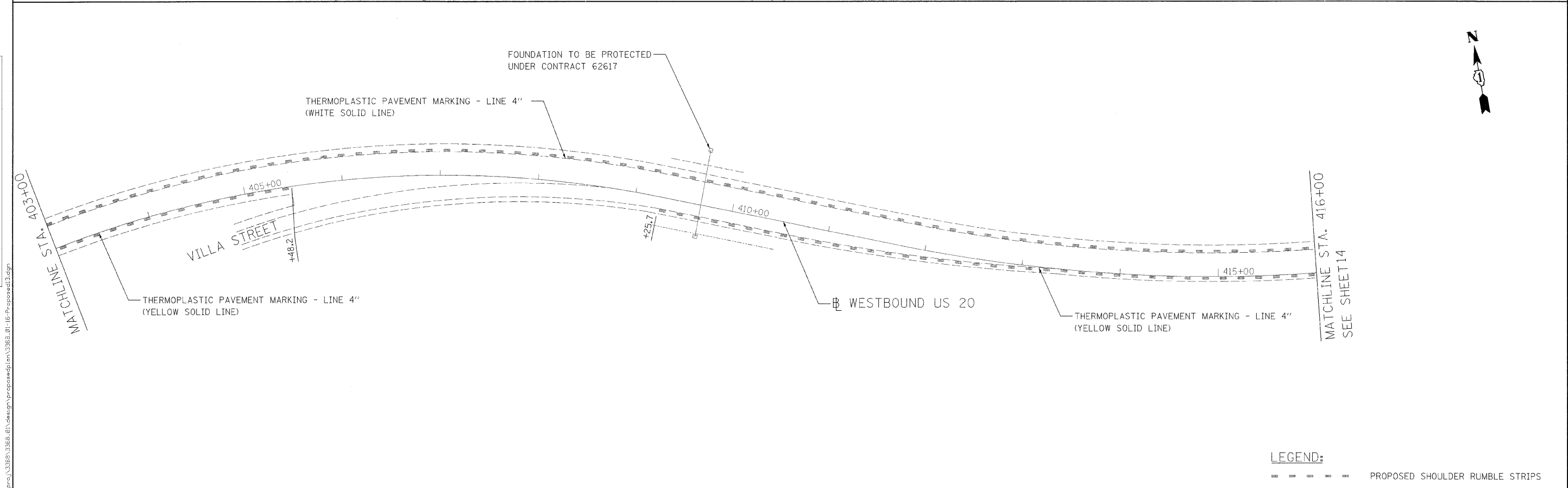
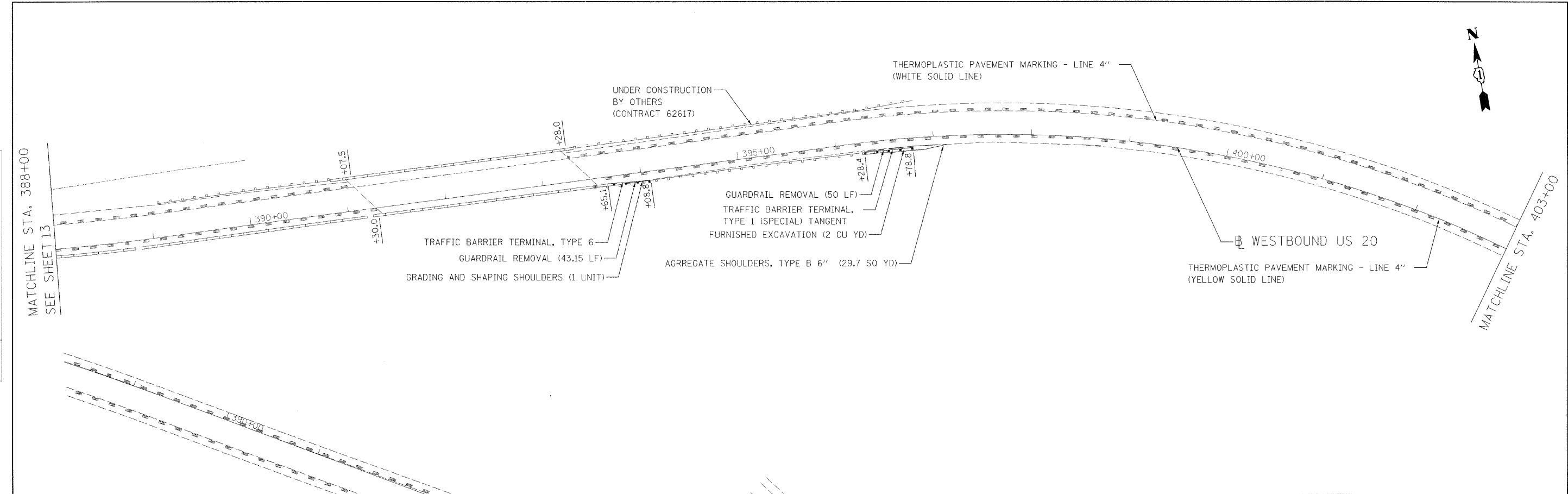

LEGEND:  
 --- PROPOSED SHOULDER RUMBLE STRIPS

**Ciorba Group, Inc.**  
 CONSULTING ENGINEERS  
 5507 North Cumberland Avenue, Suite 402  
 Chicago, Illinois 60666  
 Tel. 773.775.4009 Fax 773.775.4014

USER NAME = mreedy	DESIGNED - DD	REVISED -
PLOT SCALE = 50.0000' / 1"	DRAWN - DD	REVISED -
PLOT DATE = 12/23/2008	CHECKED - MJL	REVISED -
	DATE - 12/23/2008	REVISED -

**STATE OF ILLINOIS  
 DEPARTMENT OF TRANSPORTATION**

**FAP 345 /US 20 (LAKE ST.)  
 WELD ROAD TO BLUFF CITY BLVD/SHALES PARKWAY  
 ROADWAY PLAN**

SCALE: SHEET NO. OF SHEETS STA. TO STA.

F.A.P. RTE. 345	SECTION 2008-073 GRR	COUNTY COOK/KANE	TOTAL SHEETS 20	SHEET NO. 16
FED. ROAD DIST. NO.		ILLINOIS FED. AID PROJECT		

FILE NAME = c:\prow\3366\3366\_01\design\proposed\plan\3366\_01\_16\_Proposed3.dgn