

CONTRACT NO.		TOTAL SHEETS		SHEET NO.	
F.A.P. RTE.	SECTION	COUNTY	20	18	
345	2008-073 GRR	COOK/KANE			
STA.		TO STA.			
FED. ROAD DIST. NO.	ILLINOIS	FED. AID PROJECT			

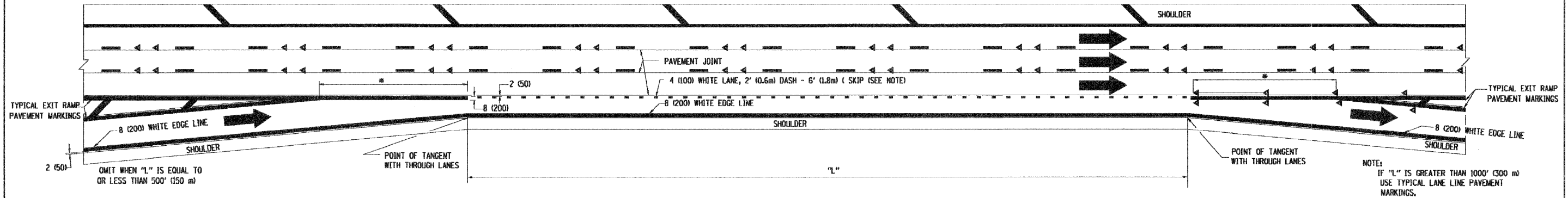

**TYPICAL ENTRANCE/EXIT RAMP COMBINATION PAVEMENT MARKINGS**

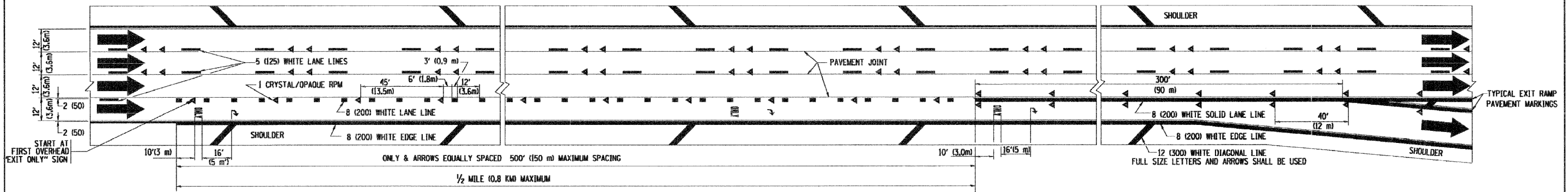

**TYPICAL EXIT ONLY LANE PAVEMENT MARKINGS**

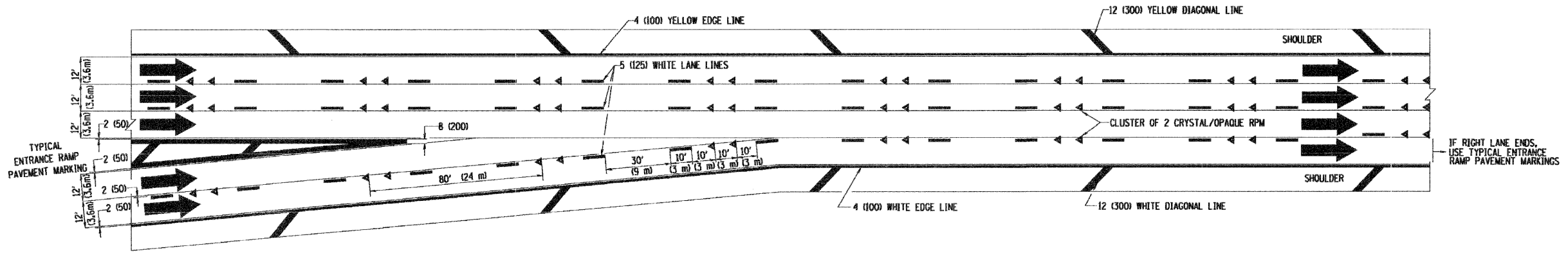

**TYPICAL TWO LANE ENTRANCE RAMP PAVEMENT MARKINGS**

PLOT DATE = 3/6/2007  
 FILE NAME = K:\GIS\2008\102.dgn  
 PLOT SCALE = 0.8000 / 1" = 100'  
 USER NAME = bshard

REVISIONS	
NAME	DATE
DWS	1/90
DWS	5/91
SPB	1/07

ILLINOIS DEPARTMENT OF TRANSPORTATION  
**MULTI-LANE FREEWAY  
 PAVEMENT MARKING  
 DETAILS**  
 SCALE: NONE  
 DRAWN BY C.A.D.D.  
 CHECKED BY  
 TC12 SHEET 2 OF 2