

PLAN	DESIGNED	DATE
	DRAWN	
	CHECKED	
	IN CHARGE	
	PROJECT	
	NO.	

PROFILE	DESIGNED	DATE
	DRAWN	
	CHECKED	
	IN CHARGE	
	PROJECT	
	NO.	

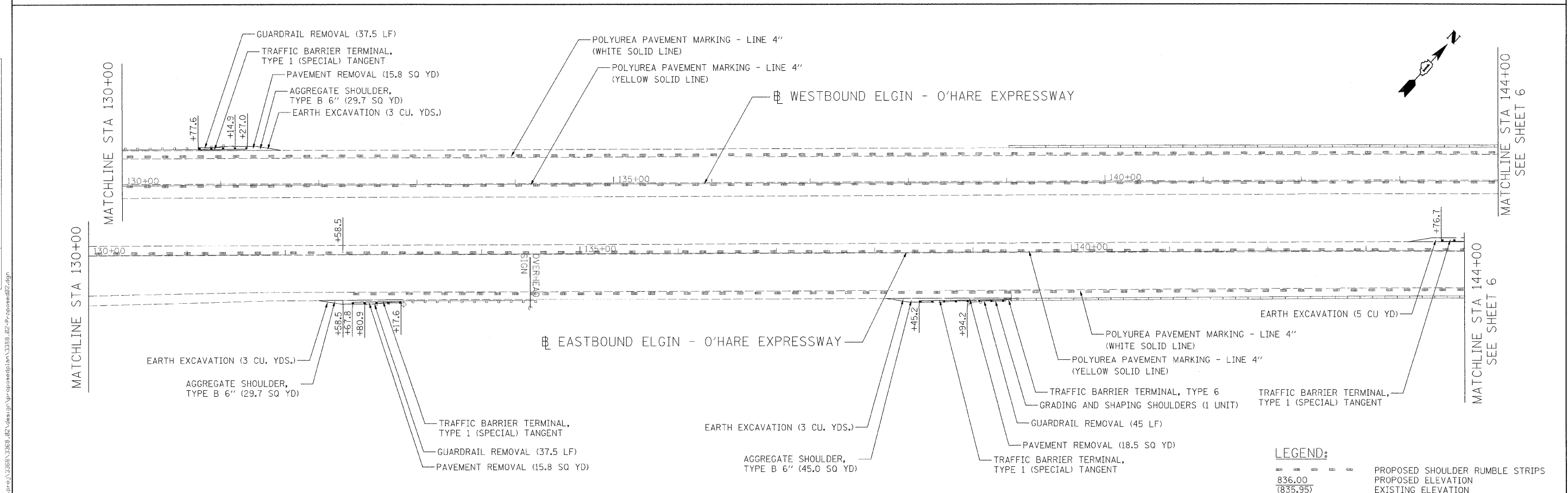
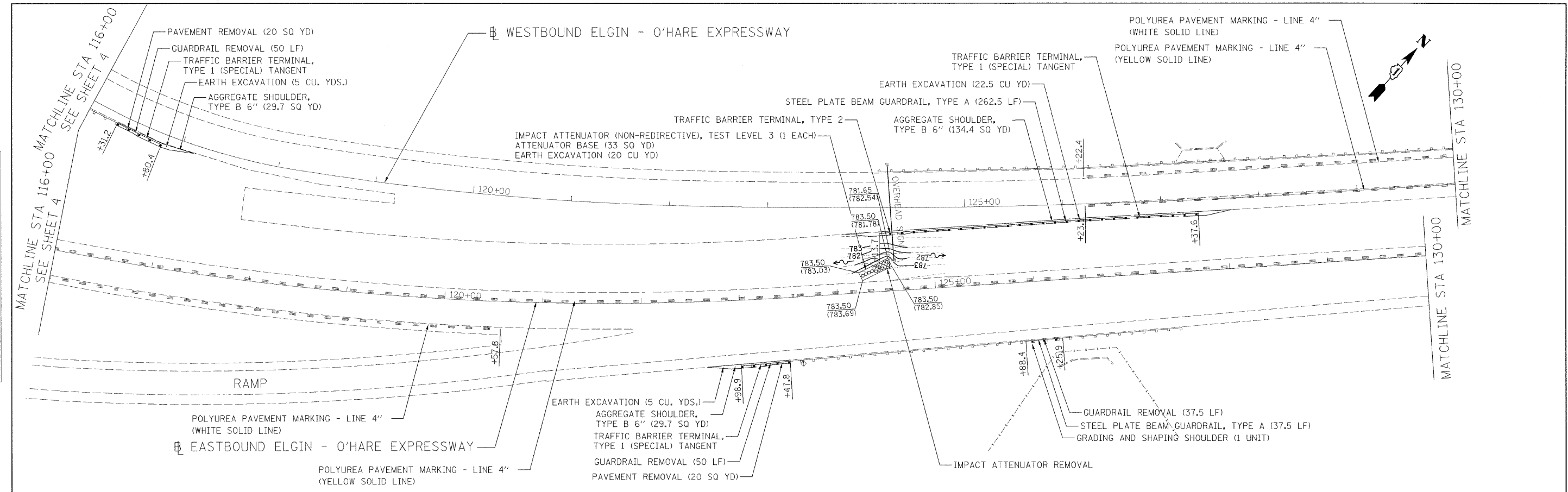

LEGEND:

836.00	PROPOSED SHOULDER RUMBLE STRIPS
(835.95)	PROPOSED ELEVATION
	EXISTING ELEVATION

Ciorba Group, Inc.
 CONSULTING ENGINEERS
 5507 North Cumberland Avenue, Suite 202
 Chicago, Illinois 60656
 Tel. 773.775.4009 Fax 773.775.4014

USER NAME = mready	DESIGNED - NT	REVISED -
PLOT SCALE = 50.0000' / 1"	DRAWN - NT	REVISED -
PLOT DATE = 12/23/2008	CHECKED - WBL	REVISED -
	DATE - 12/23/2008	REVISED -

**STATE OF ILLINOIS
 DEPARTMENT OF TRANSPORTATION**

**FAP 345 / ELGIN O'HARE EXPRESSWAY
 US 20 (LAKE ST.) TO I-290
 ROADWAY PLAN**

SCALE: SHEET NO. OF SHEETS STA. TO STA.

F.A.P. RTE. 345	SECTION 2008-076 I	COUNTY COOK/DUPAGE	TOTAL SHEETS 19	SHEET NO. 5
FED. ROAD DIST. NO. ILLINOIS FED. AID PROJECT			CONTRACT NO. 60F77	