

F.A.P. RTE.	SECTION	COUNTY	TOTAL SHEETS	SHEET NO.
345	2008-076 I	COOK/DUPAGE	19	18
STA.	TO STA.			
FED. ROAD DIST. NO.	ILLINOIS	FED. AID PROJECT		

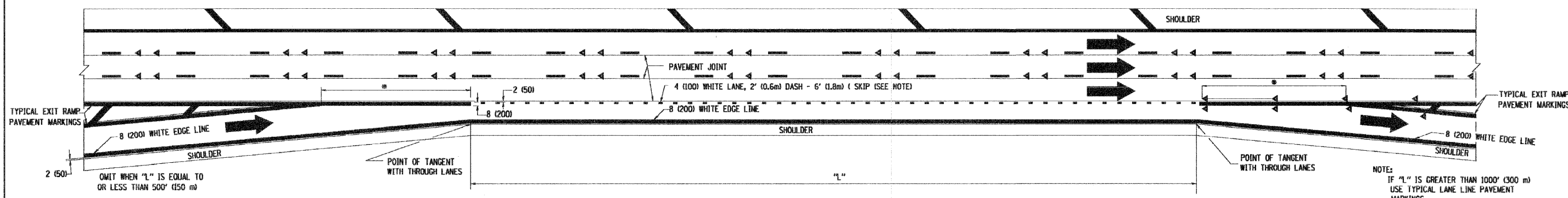

TYPICAL ENTRANCE/EXIT RAMP COMBINATION PAVEMENT MARKINGS

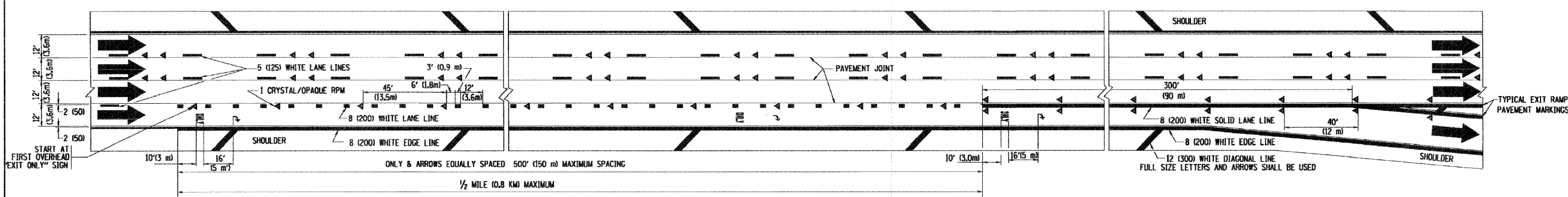

TYPICAL EXIT ONLY LANE PAVEMENT MARKINGS

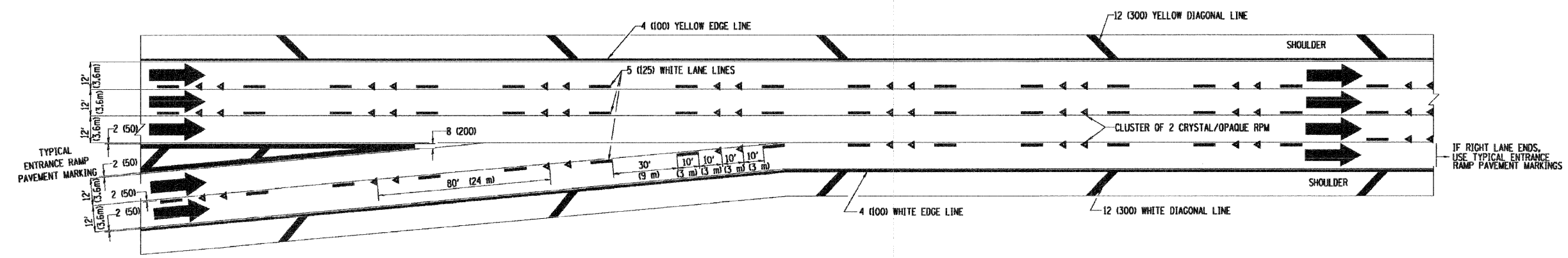

TYPICAL TWO LANE ENTRANCE RAMP PAVEMENT MARKINGS

REVISIONS	
NAME	DATE
DWS	1/90
DWS	5/91
SPB	1/07

ILLINOIS DEPARTMENT OF TRANSPORTATION
 MULTI-LANE FREEWAY
 PAVEMENT MARKING
 DETAILS

SCALE: NONE
 DRAWN BY C.A.D.D.
 CHECKED BY

DATE: 5/15/2007
 FILE: I:\Projects\12.dgn
 PLOT SCALE: 0.25" = 1'-0"
 USER: NAME * board