

F.A.P. RTE.	SECTION	COUNTY	TOTAL SHEETS	SHEET NO.
345	2008-076 I	COOK/DUPAGE	19	1
FED. ROAD DIST. NO.	ILLINOIS CONTRACT NO.	60F77		

STATE OF ILLINOIS
DEPARTMENT OF TRANSPORTATION
DIVISION OF HIGHWAYS

**PROPOSED
HIGHWAY PLANS**

F.A.P. 345 (ELGIN O'HARE EXPY.)
SECTION 2008-076 I
US 20 (LAKE STREET) TO I-290
GUARDRAIL, SHOULDER RUMBLE STRIPS
PROJECT: HSIP-0345(051)
COOK AND DUPAGE COUNTIES
C-91-228-09

FOR INDEX OF SHEETS, SEE SHEET NO. 2

THIS IMPROVEMENT IS LOCATED
WITHIN THE VILLAGES OF SCHAUMBURG,
HANOVER PARK, AND ITASCA

TRAFFIC DATA

2005 ADT - 87,000
POSTED SPEED LIMIT - 55 MPH

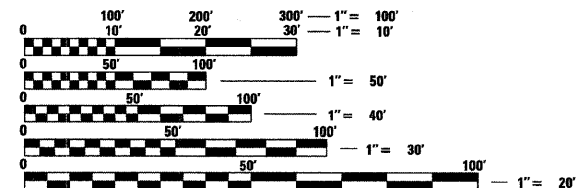

FULL SIZE PLANS HAVE BEEN PREPARED USING STANDARD
ENGINEERING SCALES. REDUCED SIZED PLANS WILL NOT
CONFORM TO STANDARD SCALES. IN MAKING MEASUREMENTS
ON REDUCED PLANS, THE ABOVE SCALES MAY BE USED.

J.U.L.I.E.
JOINT UTILITY LOCATION INFORMATION FOR EXCAVATION
1-800-892-0123
OR 811

BEGIN PROJECT
STA. 104 + 46.59

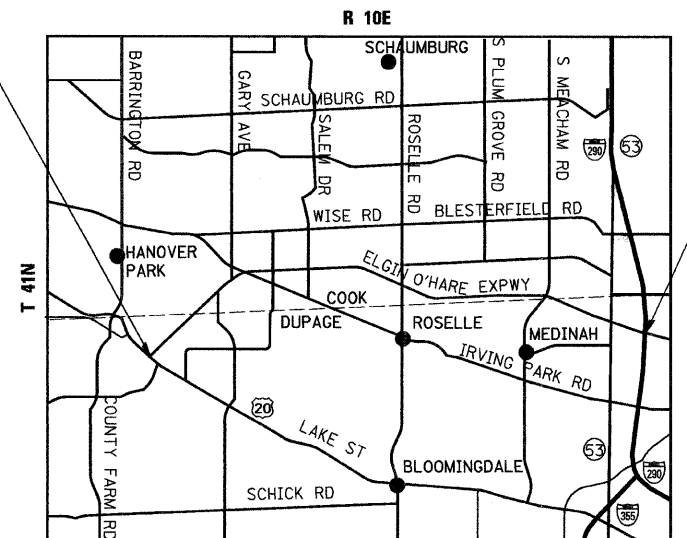

SCHAUMBURG AND BLOOMINGDALE TOWNSHIPS
LOCATION MAP
1" = 5000'
GROSS AND NET LENGTH OF PROJECT = 32,372 FT = 6.13 MI.

END PROJECT
STA. 428 + 18.80



DISTRICT 1 DESIGN PLAN PREPARATION ENGINEER: K. ENG (847)705-4247

Ciorba Group, Inc.
DESIGN FIRM
REGISTRATION NUMBER
184-001016
CONSULTING ENGINEERS
SUITE 402, 5507 NORTH CUMBERLAND AVE
CHICAGO, ILLINOIS 60656 :: (773) 775-4009

MATTHEW J. LEHAN
082-057155
LICENSED
PROFESSIONAL
ENGINEER
OF
ILLINOIS
DATE: 12/17/2008
SEAL EXPIRES: 11/30/2009

STATE OF ILLINOIS
DEPARTMENT OF TRANSPORTATION
DIVISION OF HIGHWAYS
SUBMITTED DECEMBER 18, 2008
Diana M. O'Keefe
DEPUTY DIRECTOR OF HIGHWAYS, REGION ENGINEER
January 30, 2009
Charlie J. Ingersoll
ENGINEER OF DESIGN AND ENVIRONMENT
January 30, 2009
Christine M. Reed
DIRECTOR OF HIGHWAYS, CHIEF ENGINEER

**PRINTED BY THE AUTHORITY
OF THE STATE OF ILLINOIS**

CONTRACT NO. 60F77

INDEX OF SHEETS

SHEET NO DESCRIPTION

- 1 TITLE SHEET
- 2 INDEX OF SHEETS, STATE STANDARDS & GENERAL NOTES
- 3 SUMMARY OF QUANTITIES
- 4-16 ROADWAY PLANS
- 17-18 MULTI-LANE FREEWAY PAVEMENT MARKING DETAILS (TC-12)
- 19 TRAFFIC CONTROL DETAILS FOR FREEWAY SHOULDER CLOSURES AND PARTIAL RAMP CLOSURES (TC-17)

STATE STANDARDS

- 000001-05 STANDARD SYMBOLS, ABBREVIATIONS, AND PATTERNS
- 630001-08 STEEL PLATE BEAM GUARDRAIL
- 630301-05 SHOULDER WIDENING FOR TYPE 1 (SPECIAL) GUARDRAIL TERMINALS
- 631011-05 TRAFFIC BARRIER TERMINAL, TYPE 2
- 631031-07 TRAFFIC BARRIER TERMINAL, TYPE 6
- 635006-03 REFLECTOR AND TERMINAL MARKER PLACEMENT
- 635011-02 REFLECTOR MARKER AND MOUNTING DETAILS
- 642001-01 SHOULDER RUMBLE STRIPS
- 667101-01 PERMANENT SURVEY MARKERS
- 701400-03 APPROACH TO LANE CLOSURE, FREEWAY/EXPRESSWAY
- 701406-05 LANE CLOSURE, FREEWAY/EXPRESSWAY, DAY OPERATIONS ONLY
- 701901-01 TRAFFIC CONTROL DEVICES

GENERAL NOTES

1. BEFORE STARTING ANY EXCAVATION, THE CONTRACTOR SHALL CALL "JULIE" AT 800-892-0123 OR 811 FOR FIELD LOCATIONS OF BURIED ELECTRIC, TELEPHONE, AND GAS FACILITIES. (48 HOUR NOTIFICATIONS IS REQUIRED)
2. THE CONTRACTOR SHALL COORDINATE CONSTRUCTION ACTIVITIES WITH UTILITY COMPANIES AND THE VILLAGES OF SCHAUMBURG, HANOVER PARK, AND ITASCA.
3. THE CONTRACTOR WILL NOT BE ALLOWED TO SET UP A YARD OR FIELD OFFICE ON STATE PROPERTY WITHOUT WRITTEN PERMISSION FROM THE DEPARTMENT.
4. BARRICADES: THE CONTRACTOR SHALL PROVIDE AND INSTALL TWO (2) WEIGHTED SANDBAGS ON EACH TYPE I OR TYPE II BARRICADE USED - ONE (1) WEIGHTED SANDBAG ACROSS EACH BOTTOM RAIL.
5. THE CONTRACTOR SHALL CONTACT THE DISTRICT ONE ARTERIAL TRAFFIC CONTROL SUPERVISOR AT (847) 705-4470 A MINIMUM OF 72 HOURS PRIOR TO BEGINNING WORK.
6. THE CONTRACTOR SHALL DISPOSE OF ALL CUTTINGS AND SWEEP THE SHOULDER CLEAN PRIOR TO OPENING THE TRAFFIC LANE AND SHOULDER TO TRAFFIC. ALL DISPOSAL AND SWEEPING WILL NOT BE PAID FOR SEPARATELY BUT SHALL BE INCLUDED IN THE COST OF SHOULDER RUMBLE STRIPS.
7. THE CONTRACTOR SHALL RESTRIPE THE EDGE LINES AND SHOULDER DIAGONALS UPON COMPLETION OF THE MILLING OF THE RUMBLE STRIPS. THIS WORK WILL BE PAID FOR AT THE CONTRACT UNIT PRICE FOR POLYUREA PAVEMENT MARKING - LINE 4" AND LINE 12".
8. ALL EXISTING SHOULDERS ARE PCC SHOULDERS EXCEPT FROM STA. 146+83 TO STA. 147+83 AND STA. 402+30 TO STA. 424+13 EASTBOUND ELGIN-O'HARE EXPRESSWAY.

FILE NAME = N:\PROJ\3968\3968_02\Design\Proposed\Plan\3368_02-07-General Notes.dgn

CC Ciorba Group, Inc.
 CONSULTING ENGINEERS
 5507 North Cumberland Avenue, Suite 402
 Chicago, Illinois 60656
 Tel. 773.775.4009 Fax 773.775.4014

USER NAME = mready	DESIGNED - RJR	REVISED -
	DRAWN - RJR	REVISED -
PLOT SCALE = 1:8000 "/ IN.	CHECKED - WBL	REVISED -
PLOT DATE = 12/23/2008	DATE - 12/23/2008	REVISED -

**STATE OF ILLINOIS
 DEPARTMENT OF TRANSPORTATION**

**FAP 345 / ELGIN O'HARE EXPRESSWAY
 US 20 (LAKE STREET) TO I-290
 INDEX OF SHEETS, STATE STANDARDS & GENERAL NOTES**

F.A.P. RTE.	SECTION	COUNTY	TOTAL SHEETS	SHEET NO.
345	2008-076 I	COOK/DUPAGE	19	2
CONTRACT NO. 60F77				
FED. ROAD DIST. NO. - [ILLINOIS] FED. AID PROJECT				

SUMMARY OF QUANTITIES			URBAN TOTAL QUANTITY 90% FED. 10% STATE	CONSTRUCTION TYPE CODE	
CODE NO.	DESCRIPTION	UNIT		COOK COUNTY SFTY-2A	DUPAGE COUNTY SFTY-2A
20200100	EARTH EXCAVATION	CU YD	575	150	425
20201006	GRADING AND SHAPING SHOULDERS	UNIT	75	15	60
21101615	TOPSOIL FURNISH AND PLACE, 4"	SQ YD	580	130	450
25000200	SEEDING, CLASS 2A	ACRE	0.2	0.1	0.1
25000400	NITROGEN FERTILIZER NUTRIENT	POUND	20	10	10
25000500	PHOSPHORUS FERTILIZER NUTRIENT	POUND	20	10	10
25000600	POTASSIUM FERTILIZER NUTRIENT	POUND	20	10	10
25100630	EROSION CONTROL BLANKET	SQ YD	520	130	390
44000100	PAVEMENT REMOVAL	SQ YD	1,450	400	1,050
48101500	AGGREGATE SHOULDERS, TYPE B 6"	SQ YD	3,700	1,300	2,400
63000000	STEEL PLATE BEAM GUARD RAIL, TYPE A	FOOT	6,625	1,950	4,675
63100045	TRAFFIC BARRIER TERMINAL, TYPE 2	EACH	6	3	3
63100085	TRAFFIC BARRIER TERMINAL, TYPE 6	EACH	18	4	14
63100167	TRAFFIC BARRIER TERMINAL, TYPE 1 (SPECIAL) TANGENT	EACH	40	18	22
63200310	GUARDRAIL REMOVAL	FOOT	4,000	1,150	2,850
* 64200105	SHOULDER RUMBLE STRIP	FOOT	94,650	22,350	72,300
67000400	ENGINEER'S FIELD OFFICE, TYPE A	CAL MO	3	1	2
67100100	MOBILIZATION	L SUM	1	0.5	0.5
* 78008210	POLYUREA PAVEMENT MARKING TYPE I - LINE 4"	FOOT	94,550	22,450	72,100
* 78008250	POLYUREA PAVEMENT MARKING TYPE I - LINE 12"	FOOT	3,425	1,225	2,200
78200410	GUARDRAIL MARKERS, TYPE A	EACH	130	50	80
78201000	TERMINAL MARKER - DIRECT APPLIED	EACH	40	18	22
X7011015	TRAFFIC CONTROL AND PROTECTION (EXPRESSWAYS)	L SUM	1	0.5	0.5
X7015005	CHANGEABLE MESSAGE SIGN	CAL DA	150	75	75
Z0002005	ATTENUATOR BASE	SQ YD	561	66	495
Z0029999	IMPACT ATTENUATOR REMOVAL	EACH	1	1	0
Z0030030	IMPACT ATTENUATORS (FULLY REDIRECTIVE, NARROW), TEST LEVEL 3	EACH	2	2	0
Z0030150	IMPACT ATTENUATORS (NON-REDIRECTIVE), TEST LEVEL 3	EACH	17	2	15
Z0049800	RELOCATE EXISTING SURVEY MARKERS	EACH	1	0	1

* DENOTES SPECIALTY ITEM

FILE NAME = \\NA\PROJ\3368\3368_02\Design\ProposedPlan\3368_02-05-00.dgn



Ciorba Group, Inc.
CONSULTING ENGINEERS
5507 North Cumberland Avenue, Suite 402
Chicago, Illinois 60656
Tel. 773.775.4009 Fax 773.775.4014

USER NAME = mreedy	DESIGNED - RJR	REVISED -
	DRAWN - RJR	REVISED -
PLOT SCALE = 1:8000' / IN.	CHECKED - WBL	REVISED -
PLOT DATE = 12/23/2008	DATE - 12/23/2008	REVISED -

**STATE OF ILLINOIS
DEPARTMENT OF TRANSPORTATION**

FAP 345 / ELGIN O'HARE EXPRESSWAY US 20 (LAKE STREET) TO I-290 SUMMARY OF QUANTITIES			
SCALE:	SHEET NO.	OF SHEETS	STA. TO STA.

Rev.

F.A.P. RTE.	SECTION	COUNTY	TOTAL SHEETS	SHEET NO.
345	2008-076 I	COOK/DUPAGE	19	3
FED. ROAD DIST. NO. - [ILLINOIS] FED. AID PROJECT				CONTRACT NO. 60F77



PLAN	DATE
BY	
REVISIONS	
NO. DESCRIPTION	
DATE	
BY	
DATE	

PROFILE	DATE
BY	
REVISIONS	
NO. DESCRIPTION	
DATE	
BY	
DATE	

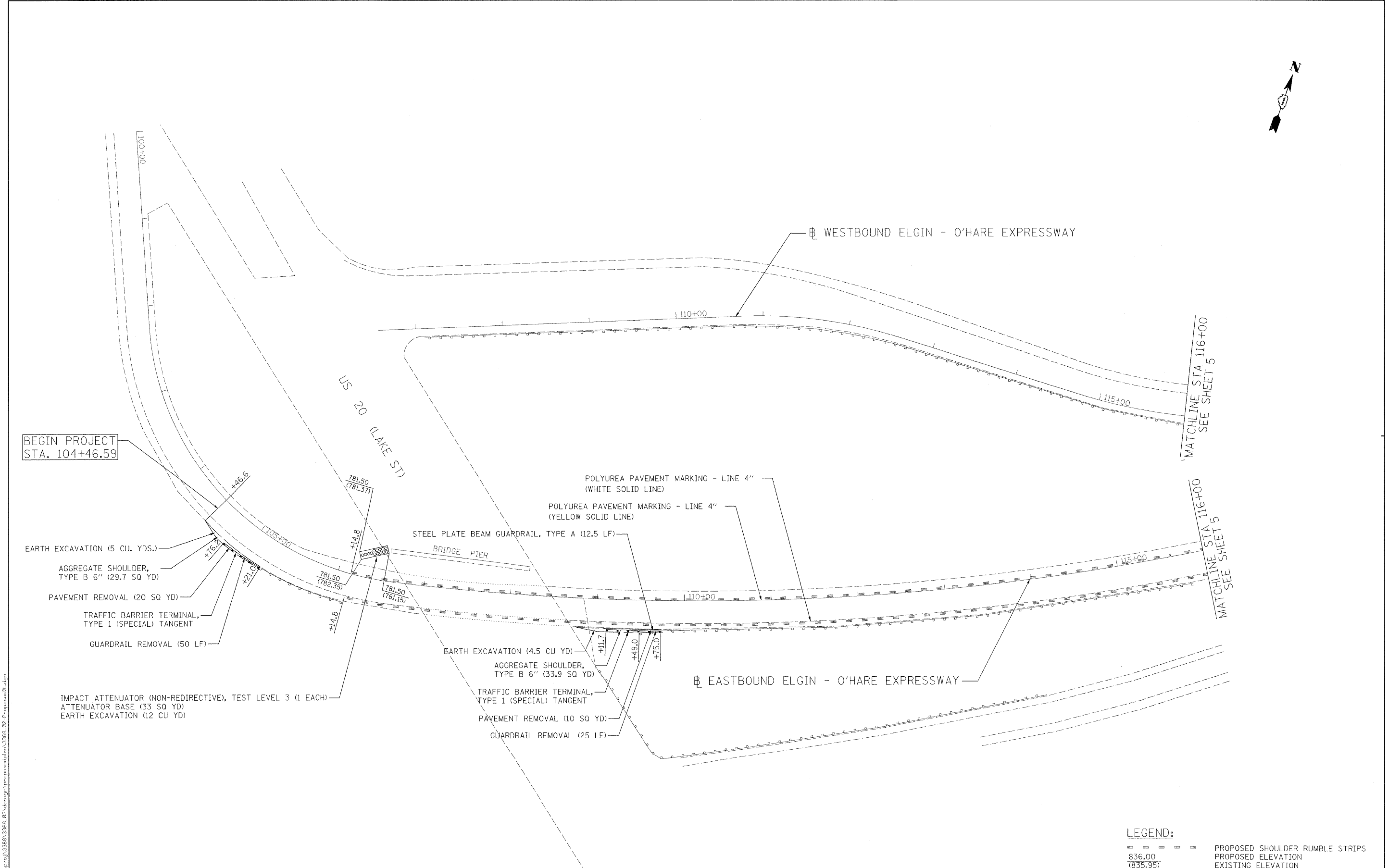

BEGIN PROJECT STA. 104+46.59

- EARTH EXCAVATION (5 CU. YDS.)
- AGGREGATE SHOULDER, TYPE B 6" (29.7 SQ YD)
- PAVEMENT REMOVAL (20 SQ YD)
- TRAFFIC BARRIER TERMINAL, TYPE 1 (SPECIAL) TANGENT
- GUARDRAIL REMOVAL (50 LF)
- IMPACT ATTENUATOR (NON-REDIRECTIVE), TEST LEVEL 3 (1 EACH)
- ATTENUATOR BASE (33 SQ YD)
- EARTH EXCAVATION (12 CU YD)

- EARTH EXCAVATION (4.5 CU YD)
- AGGREGATE SHOULDER, TYPE B 6" (33.9 SQ YD)
- TRAFFIC BARRIER TERMINAL, TYPE 1 (SPECIAL) TANGENT
- PAVEMENT REMOVAL (10 SQ YD)
- GUARDRAIL REMOVAL (25 LF)

POLYUREA PAVEMENT MARKING - LINE 4" (WHITE SOLID LINE)
 POLYUREA PAVEMENT MARKING - LINE 4" (YELLOW SOLID LINE)

LEGEND:

--- --- ---	PROPOSED SHOULDER RUMBLE STRIPS
836.00	PROPOSED ELEVATION
(835.95)	EXISTING ELEVATION

FILE NAME: s:\proj\33668\33668_02\design\proposals\33668_02-F\propose.dgn

Ciorba Group, Inc.
 CONSULTING ENGINEERS
 5507 North Cumberland Avenue, Suite 402
 Chicago, Illinois 60656
 Tel. 773.775.4008 Fax 773.775.4014

USER NAME = mready	DESIGNED - NT	REVISED -
PLOT SCALE = 50.0000' / IN.	DRAWN - NT	REVISED -
PLOT DATE = 12/23/2008	CHECKED - WBL	REVISED -
DATE = 12/23/2008	DATE = 12/23/2008	REVISED -

**STATE OF ILLINOIS
 DEPARTMENT OF TRANSPORTATION**

**FAP 345 / ELGIN O'HARE EXPRESSWAY
 US 20 (LAKE ST.) TO I-290
 ROADWAY PLAN**

F.A.P. RTE. 345	SECTION 2008-076 I	COUNTY COOK/DUPAGE	TOTAL SHEETS 19	SHEET NO. 4
SCALE: SHEET NO. OF SHEETS STA. TO STA.		CONTRACT NO. 60F77		
FED. ROAD DIST. NO. ILLINOIS FED. AID PROJECT				

PLAN	DESIGNED	DATE
	BY	
	CHECKED	
	IN CHARGE	
	DATE	
	PROJECT	
	NO.	

PROFILE	DESIGNED	DATE
	BY	
	CHECKED	
	IN CHARGE	
	DATE	
	PROJECT	
	NO.	

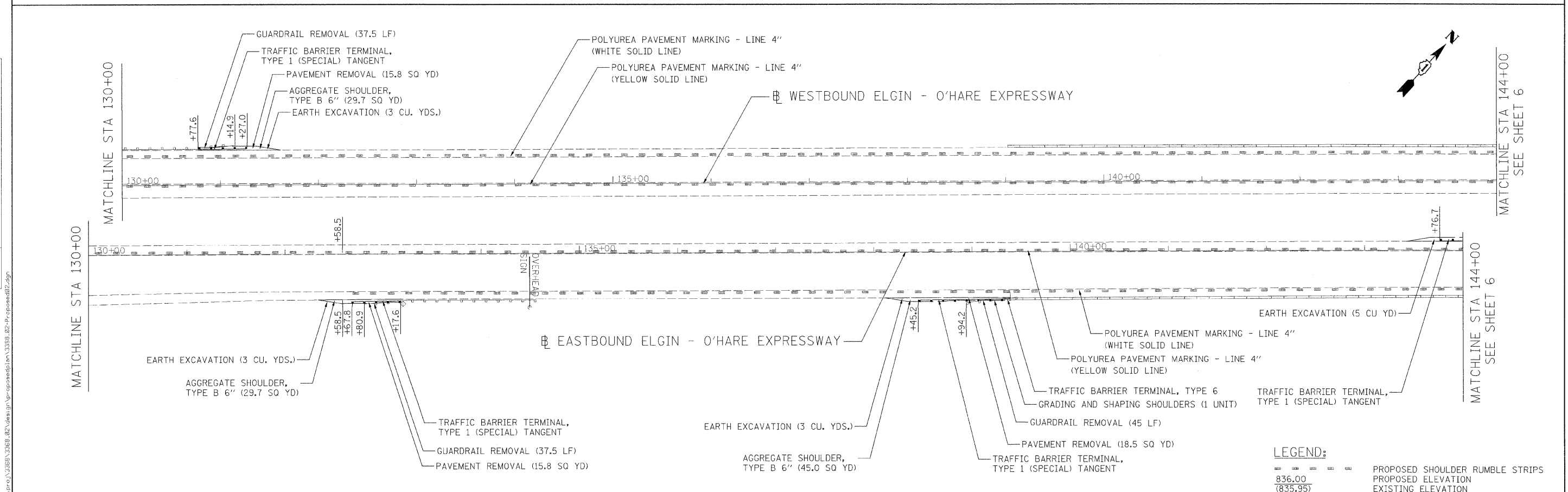
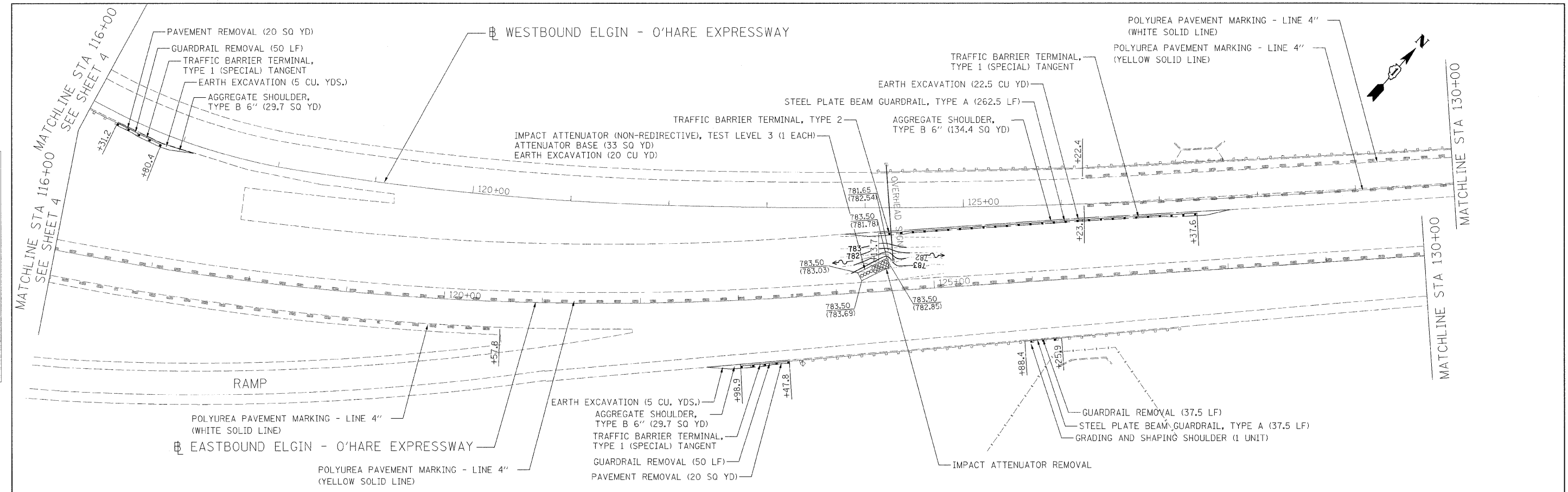

LEGEND:

=====	PROPOSED SHOULDER RUMBLE STRIPS
836.00	PROPOSED ELEVATION
(835.95)	EXISTING ELEVATION

Ciorba Group, Inc.
CONSULTING ENGINEERS
5507 North Cumberland Avenue, Suite 202
Chicago, Illinois 60656
Tel. 773.775.4009 Fax 773.775.4014

USER NAME = mready	DESIGNED - NT	REVISED -
PLOT SCALE = 50.0000' / 1"	DRAWN - NT	REVISED -
PLOT DATE = 12/23/2008	CHECKED - WBL	REVISED -
	DATE - 12/23/2008	REVISED -

**STATE OF ILLINOIS
DEPARTMENT OF TRANSPORTATION**

**FAP 345 / ELGIN O'HARE EXPRESSWAY
US 20 (LAKE ST.) TO I-290
ROADWAY PLAN**

SCALE: SHEET NO. OF SHEETS STA. TO STA.

F.A.P. RTE. 345	SECTION 2008-076 I	COUNTY COOK/DUPAGE	TOTAL SHEETS 19	SHEET NO. 5
FED. ROAD DIST. NO. ILLINOIS FED. AID PROJECT			CONTRACT NO. 60F77	

PLAN	BY:	DATE:
DRAWN		
CHECKED		
IN CHARGE		
NO.		
DATE		
BY		
DATE		

PROFILE	BY:	DATE:
DRAWN		
CHECKED		
IN CHARGE		
NO.		
DATE		
BY		
DATE		

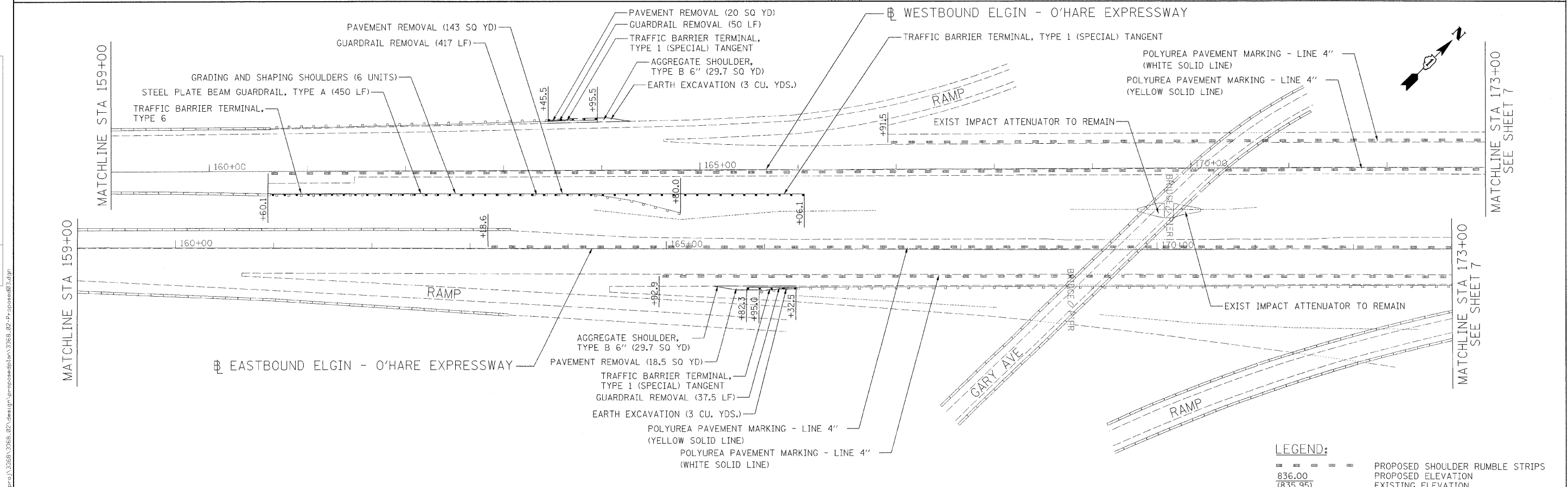
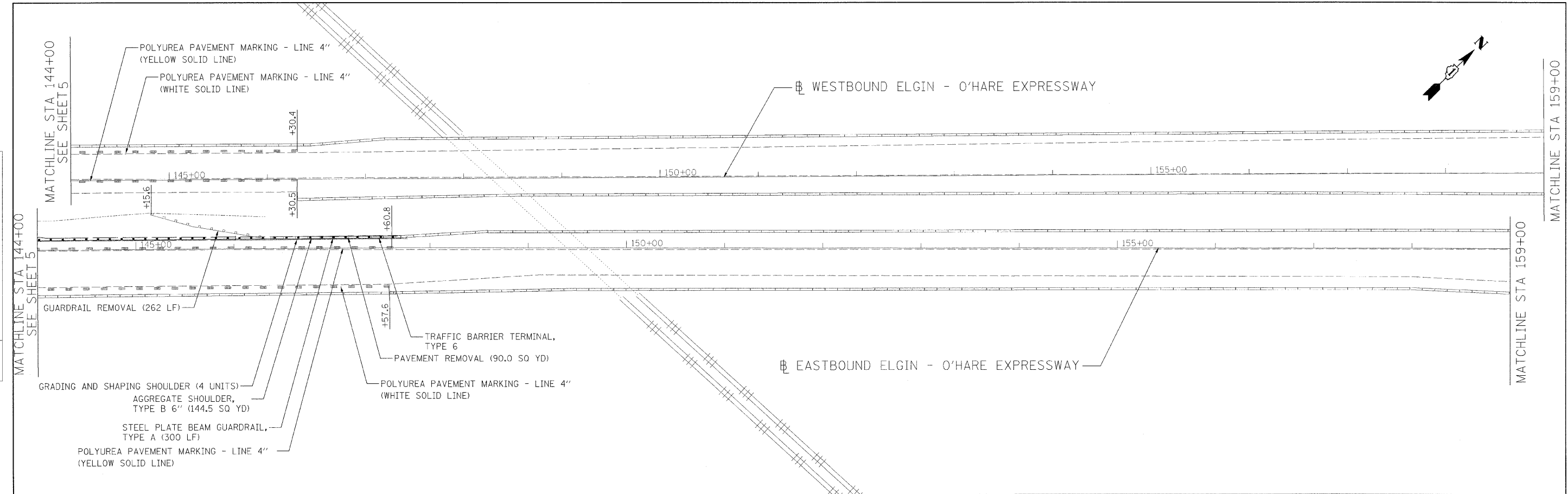

LEGEND:	
—	PROPOSED SHOULDER RUMBLE STRIPS
836.00	PROPOSED ELEVATION
(835.95)	EXISTING ELEVATION

FILE NAME: z:\proj\33586\33586_02\design\proposeshplan\33586_02-proposesh02.dgn

Ciorba Group, Inc.
CONSULTING ENGINEERS
5507 North Cumberland Avenue, Suite 402
Chicago, Illinois 60656
Tel. 773.775.4009 Fax 773.775.4014

USER NAME = mrcady	DESIGNED - NT	REVISED -
PLLOT SCALE = 90.00000 ' / IN.	DRAWN - NT	REVISED -
PLLOT DATE = 12/23/2009	CHECKED - WBL	REVISED -
DATE = 12/23/2009	DATE = 12/23/2009	REVISED -

**STATE OF ILLINOIS
DEPARTMENT OF TRANSPORTATION**

**FAP 345 / ELGIN O'HARE EXPRESSWAY
US 20 (LAKE ST.) TO I-290
ROADWAY PLAN**

SCALE: SHEET NO. OF SHEETS STA. TO STA.

F.A.P. RTE. 345	SECTION 2008-076 I	COUNTY COOK/DUPAGE	TOTAL SHEETS 19	SHEET NO. 6
FED. ROAD DIST. NO. [ILLINOIS] FED. AID PROJECT				CONTRACT NO. 60F77

PLAN	DATE
BY	
REVISIONS	
NO. DESCRIPTION	
1. DATE	
2. BY	
3. DESCRIPTION	
4. DATE	
5. BY	
6. DESCRIPTION	
7. DATE	
8. BY	
9. DESCRIPTION	
10. DATE	
11. BY	
12. DESCRIPTION	
13. DATE	
14. BY	
15. DESCRIPTION	
16. DATE	
17. BY	
18. DESCRIPTION	
19. DATE	
20. BY	
21. DESCRIPTION	
22. DATE	
23. BY	
24. DESCRIPTION	
25. DATE	
26. BY	
27. DESCRIPTION	
28. DATE	
29. BY	
30. DESCRIPTION	

PROFILE	DATE
BY	
REVISIONS	
NO. DESCRIPTION	
1. DATE	
2. BY	
3. DESCRIPTION	
4. DATE	
5. BY	
6. DESCRIPTION	
7. DATE	
8. BY	
9. DESCRIPTION	
10. DATE	
11. BY	
12. DESCRIPTION	
13. DATE	
14. BY	
15. DESCRIPTION	
16. DATE	
17. BY	
18. DESCRIPTION	
19. DATE	
20. BY	
21. DESCRIPTION	
22. DATE	
23. BY	
24. DESCRIPTION	
25. DATE	
26. BY	
27. DESCRIPTION	
28. DATE	
29. BY	
30. DESCRIPTION	

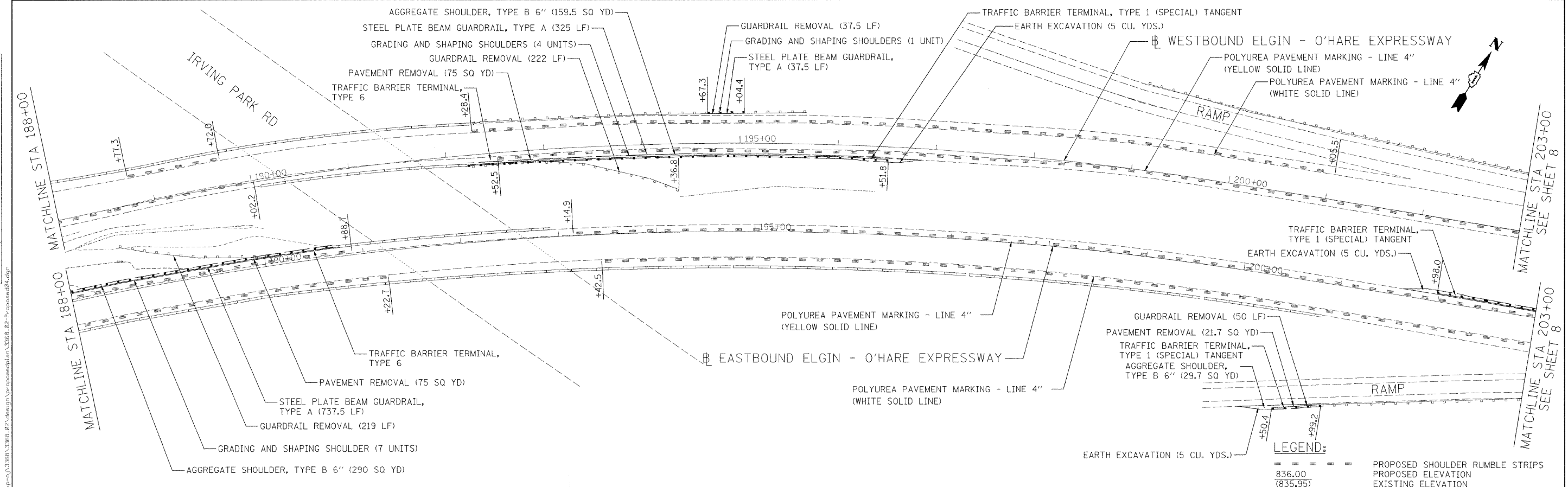
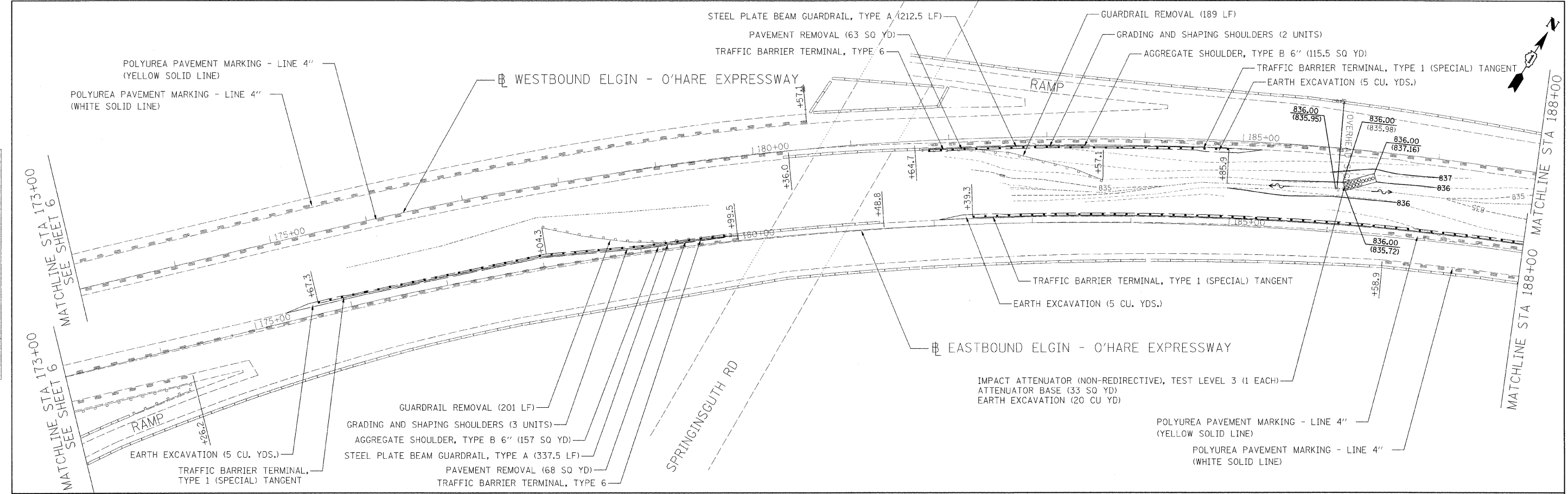

Ciorba Group, Inc. CONSULTING ENGINEERS 5507 North Cumberland Avenue, Suite 402 Chicago, Illinois 60656 Tel. 773.775.4009 Fax 773.775.4014	USER NAME = mready DESIGNED - NT DRAWN - NT CHECKED - WBL DATE - 12/23/2008	REVISED - REVISED - REVISED - REVISED -	STATE OF ILLINOIS DEPARTMENT OF TRANSPORTATION	FAP 345 / ELGIN O'HARE EXPRESSWAY US 20 (LAKE ST.) TO I-290 ROADWAY PLAN	F.A.P. RTE. 345 SECTION 2008-076 I COUNTY COOK/DUPAGE TOTAL SHEETS 19 SHEET NO. 7 CONTRACT NO. 60F77
	PLOT SCALE = 50.0000' / 1" IN. PLOT DATE = 12/23/2008	SCALE: SHEET NO. OF SHEETS STA. TO STA.	FED. ROAD DIST. NO. ILLINOIS FED. AID PROJECT		

PLAN	SUBMITTED	DATE
NOTE BOOK	PLOTTED	
NO.	CHECKED	
	BY	
	DATE	
	FILE NAME	
	DATE	

PROFILE	SUBMITTED	DATE
NOTE BOOK	PLOTTED	
NO.	CHECKED	
	BY	
	DATE	
	FILE NAME	
	DATE	

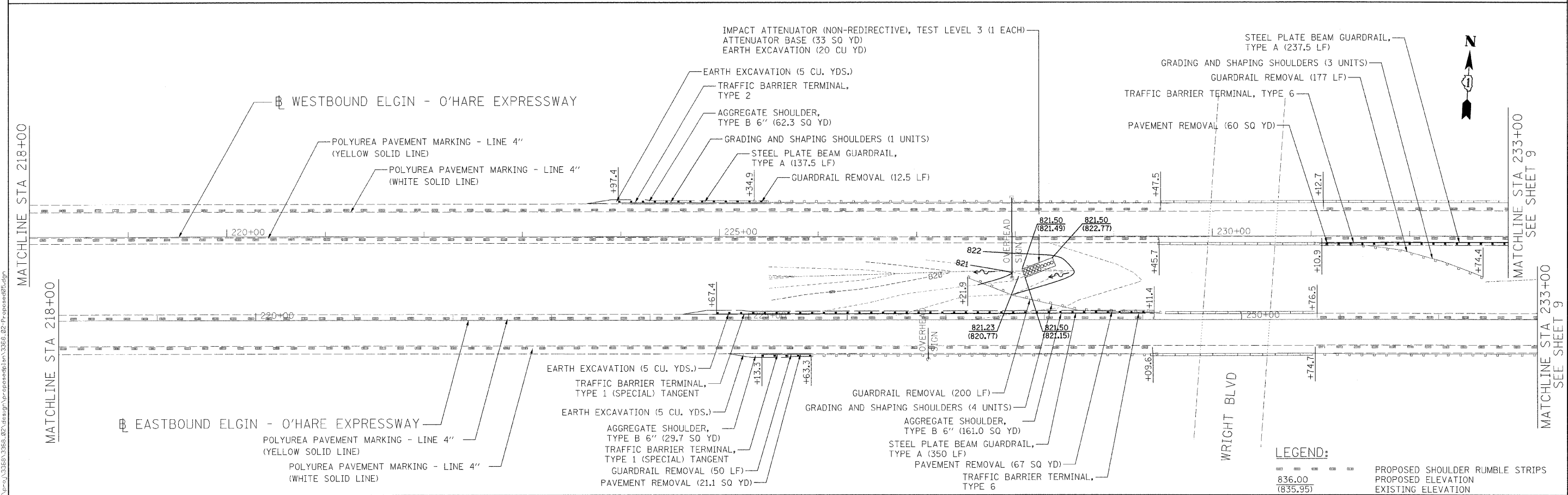
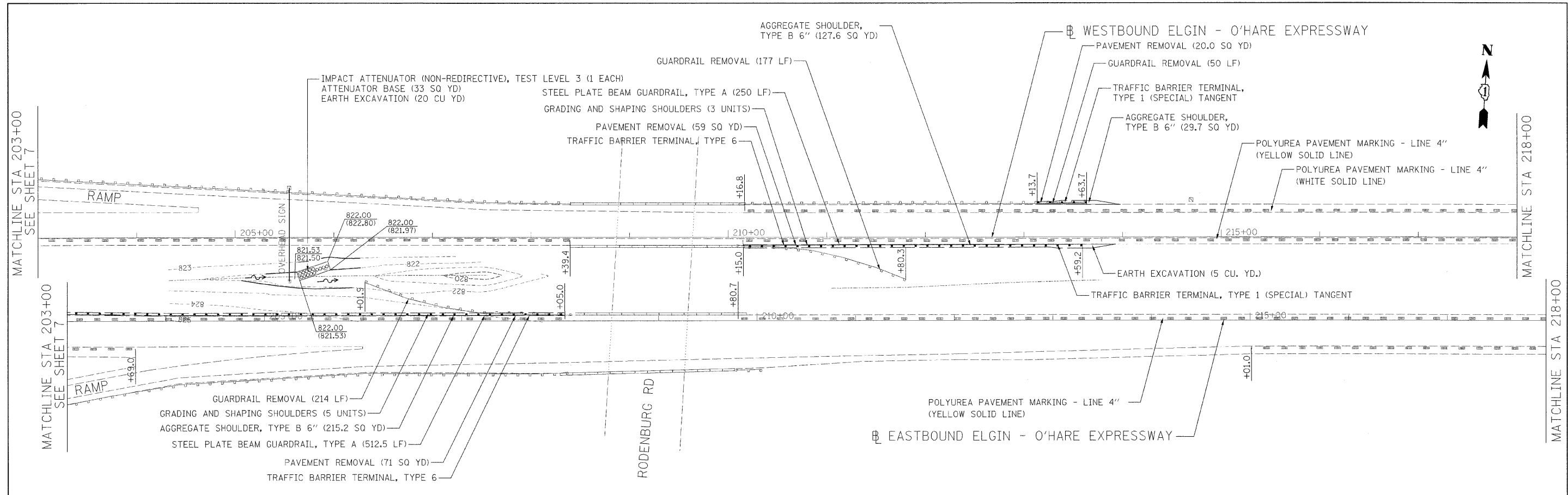

LEGEND:

=====	PROPOSED SHOULDER RUMBLE STRIPS
836.00	PROPOSED ELEVATION
(835.95)	EXISTING ELEVATION

Ciorba Group, Inc.
CONSULTING ENGINEERS
5507 North Cumberland Avenue, Suite 402
Chicago, Illinois 60660
Tel. 773.775.4009 Fax 773.775.4014

USER NAME = mraody	DESIGNED - NT	REVISED -
PLLOT SCALE = 50.0000' / IN.	DRAWN - NT	REVISED -
PLLOT DATE = 12/23/2008	CHECKED - WBL	REVISED -
DATE - 12/23/2008	DATE - 12/23/2008	REVISED -

**STATE OF ILLINOIS
DEPARTMENT OF TRANSPORTATION**

**FAP 345 / ELGIN O'HARE EXPRESSWAY
US 20 (LAKE ST.) TO I-290
ROADWAY PLAN**

SCALE: SHEET NO. OF SHEETS STA. TO STA.

F.A.P. RTE. 345	SECTION 2008-076 I	COUNTY COOK/DUPAGE	TOTAL SHEETS 19	SHEET NO. 8
FED. ROAD DIST. NO. ILLINOIS FED. AID PROJECT		CONTRACT NO. 60F77		

PLAN	SUBMITTED	DATE
NOTE BOOK	PLOTTED	BY
NO.	CHECKED	
	AT OFFICE	
	WAY CHECKED	
	STRUCTURE	NOTATRS CHKD
	NO.	DAUD FILE NAME

PROFILE	SUBMITTED	DATE
NOTE BOOK	PLOTTED	BY
NO.	CHECKED	
	AT OFFICE	
	WAY CHECKED	
	STRUCTURE	NOTATRS CHKD
	NO.	DAUD FILE NAME

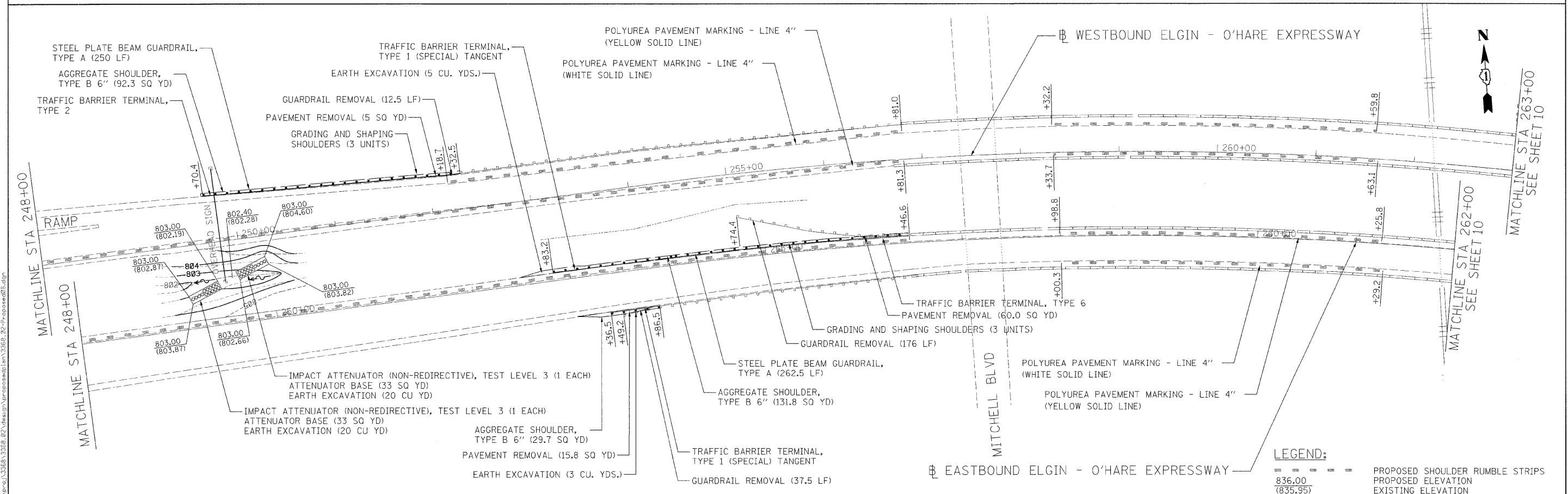
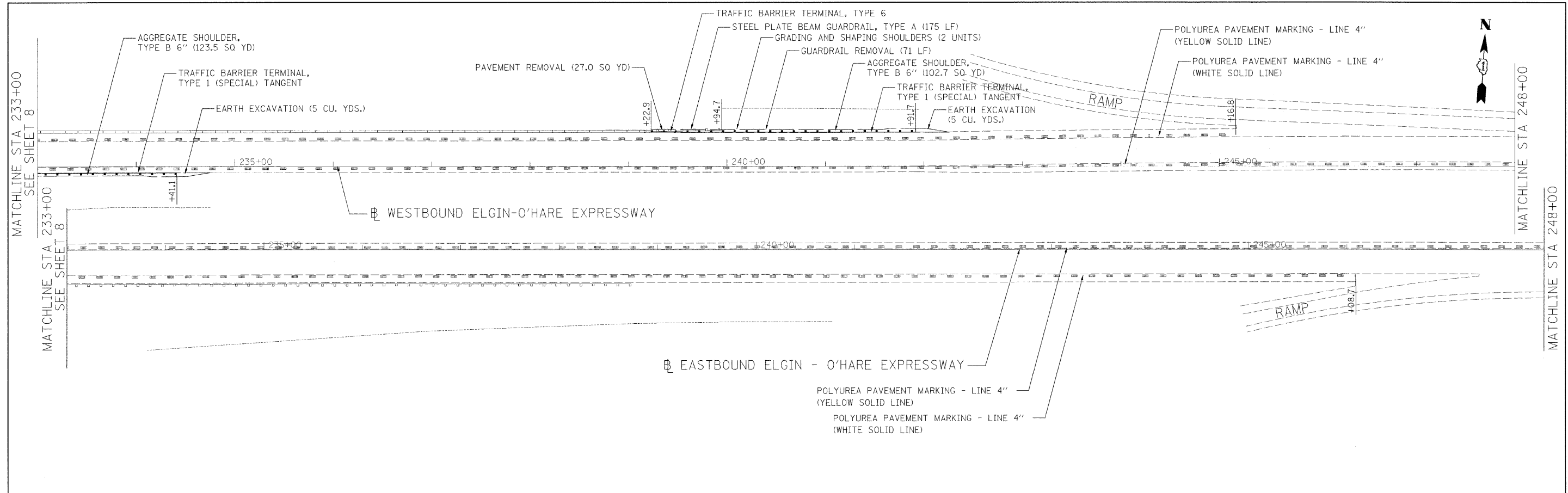

LEGEND:

---	PROPOSED SHOULDER RUMBLE STRIPS
836.00	PROPOSED ELEVATION
(835.95)	EXISTING ELEVATION

Ciorba Group, Inc.
CONSULTING ENGINEERS
5507 North Cumberland Avenue, Suite 402
Chicago, Illinois 60666
Tel. 773.775.4009 Fax 773.775.4014

USER NAME = mrcody	DESIGNED = NT	REVISED =
PLOT SCALE = 50.0000' / IN.	DRAWN = NT	REVISED =
PLOT DATE = 12/23/2008	CHECKED = WBL	REVISED =
	DATE = 12/23/2008	REVISED =

**STATE OF ILLINOIS
DEPARTMENT OF TRANSPORTATION**

**FAP 345 /ELGIN O'HARE EXPRESSWAY
US 20 (LAKE ST.) TO I-290
ROADWAY PLAN**

SCALE:	SHEET NO.	OF SHEETS	STA.	TO STA.
--------	-----------	-----------	------	---------

F.A.P. RTE. 345	SECTION 2008-076 1	COUNTY COOK/DUPAGE	TOTAL SHEETS 19	SHEET NO. 9
FED. ROAD DIST. NO. ILLINOIS FED. AID PROJECT			CONTRACT NO. 60F77	

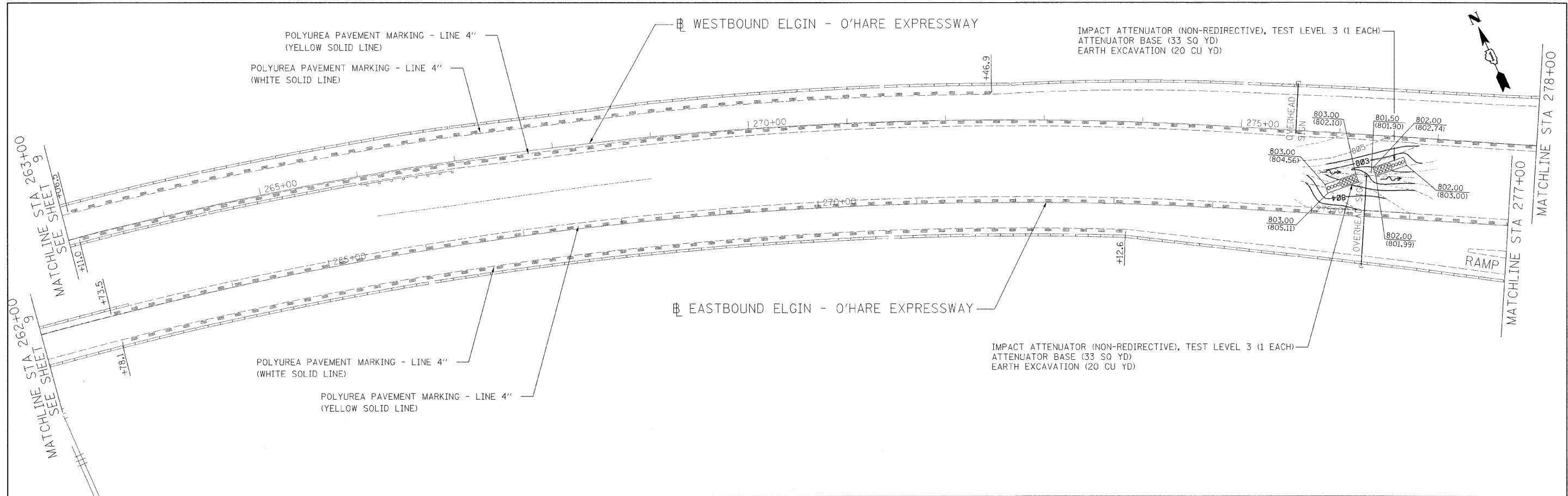

PLAN	SURVEYED	DATE
	PLOTTED	BY
	CHECKED	
	NOTED	
	NO. _____	
	DATE _____	
	FILE NAME _____	

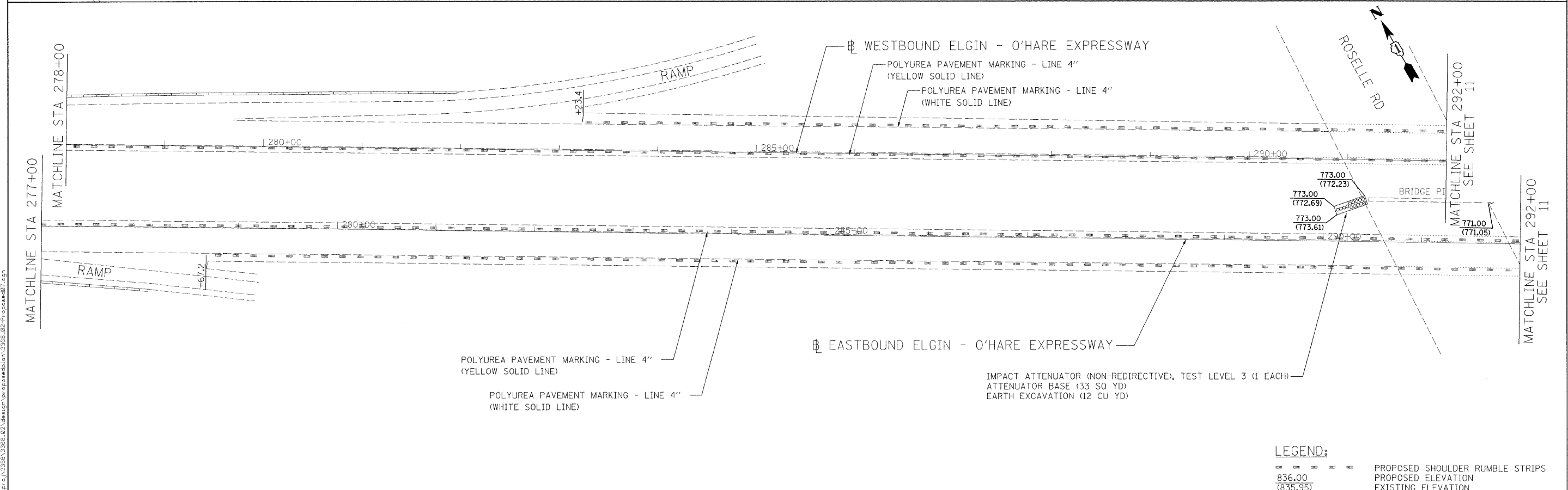

PROFILE	SURVEYED	DATE
	PLOTTED	BY
	CHECKED	
	NOTED	
	NO. _____	
	DATE _____	
	FILE NAME _____	

LEGEND:

---	PROPOSED SHOULDER RUMBLE STRIPS
836.00 (835.95)	PROPOSED ELEVATION
---	EXISTING ELEVATION

Ciorba Group, Inc.
 CONSULTING ENGINEERS
 5507 North Cumberland Avenue, Suite 402
 Chicago, Illinois 60656
 Tel. 773.775.4009 Fax 773.775.4014

USER NAME = mready	DESIGNED - NT	REVISED -
PLOT SCALE = 50.0000' / IN.	DRAWN - NT	REVISED -
PLOT DATE = 12/23/2008	CHECKED - WBL	REVISED -
	DATE - 12/23/2008	REVISED -

**STATE OF ILLINOIS
 DEPARTMENT OF TRANSPORTATION**

**FAP 345 / ELGIN O'HARE EXPRESSWAY
 US 20 (LAKE ST.) TO I-290
 ROADWAY PLAN**

SCALE: SHEET NO. OF SHEETS STA. TO STA.

F.A.P. RTE. 345	SECTION 2008-076 I	COUNTY COOK/DUPAGE	TOTAL SHEETS 19	SHEET NO. 10
FED. ROAD DIST. NO. ILLINOIS FED. AID PROJECT		CONTRACT NO. 60F77		

PLAN	REVISIONS	DATE
NO. 1	BY	
NO. 2	BY	
NO. 3	BY	
NO. 4	BY	
NO. 5	BY	
NO. 6	BY	
NO. 7	BY	
NO. 8	BY	
NO. 9	BY	
NO. 10	BY	

PROFILE	DATE
NO. 1	
NO. 2	
NO. 3	
NO. 4	
NO. 5	
NO. 6	
NO. 7	
NO. 8	
NO. 9	
NO. 10	

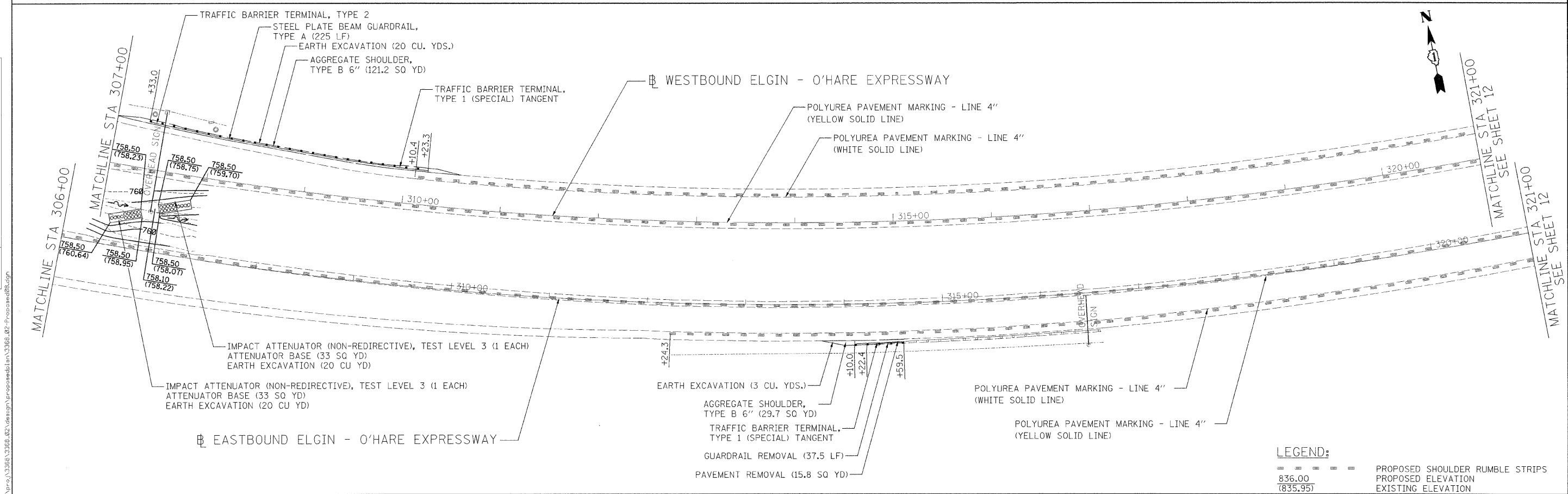
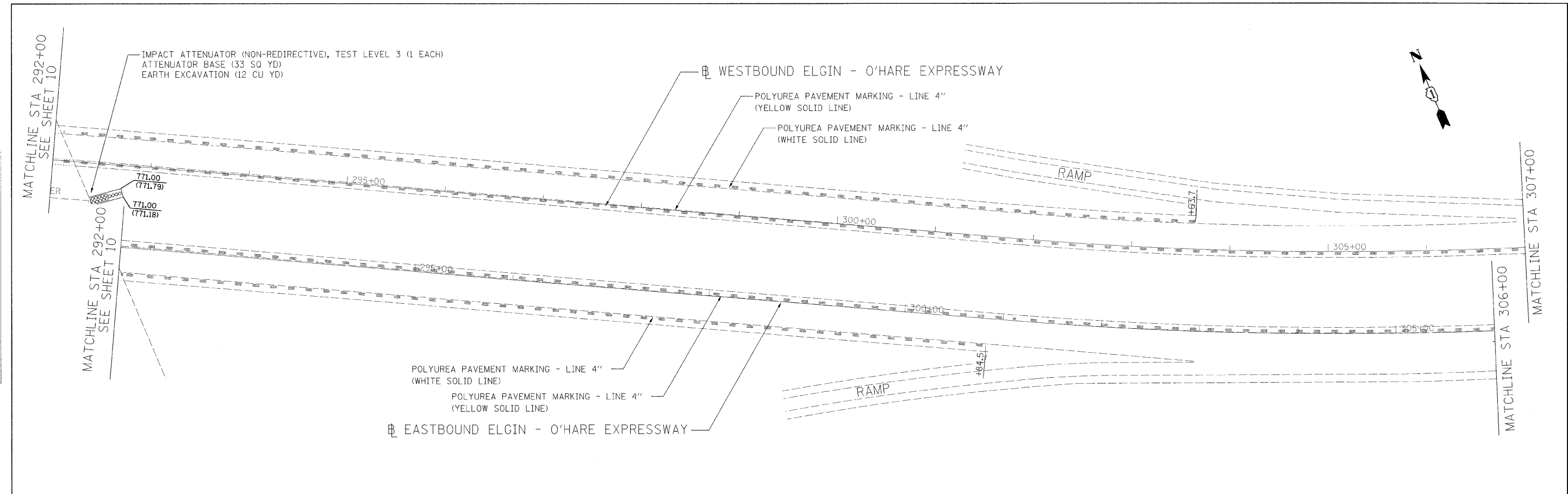

LEGEND:

=====	PROPOSED SHOULDER RUMBLE STRIPS
836.00	PROPOSED ELEVATION
(835.95)	EXISTING ELEVATION

Ciorba Group, Inc.
 CONSULTING ENGINEERS
 5507 North Cumberland Avenue, Suite 402
 Chicago, Illinois 60656
 Tel. 773.775.4009 Fax 773.775.4014

USER NAME = mrandy	DESIGNED - NT	REVISED -
PILOT SCALE = 50.2000' / IN.	DRAWN - NT	REVISED -
PILOT DATE = 12/23/2008	CHECKED - WBL	REVISED -
DATE - 12/23/2008	DATE - 12/23/2008	REVISED -

**STATE OF ILLINOIS
 DEPARTMENT OF TRANSPORTATION**

**FAP 345 / ELGIN O'HARE EXPRESSWAY
 US 20 (LAKE ST.) TO I-290
 ROADWAY PLAN**

SCALE: SHEET NO. OF SHEETS STA. TO STA.

F.A.P. RTE. 345	SECTION 2008-076 I	COUNTY COOK/DUPAGE	TOTAL SHEETS 19	SHEET NO. 11
FED. ROAD DIST. NO. ILLINOIS FED. AID PROJECT			CONTRACT NO. 60F77	

PLAN	SUBMITTED	DATE
	BY	
	NOTED	
	CHECKED	
	ALIGNED	
	PAID FILE NAME	
	NO.	

PROFILE	SUBMITTED	DATE
	BY	
	NOTED	
	CHECKED	
	ALIGNED	
	PAID FILE NAME	
	NO.	

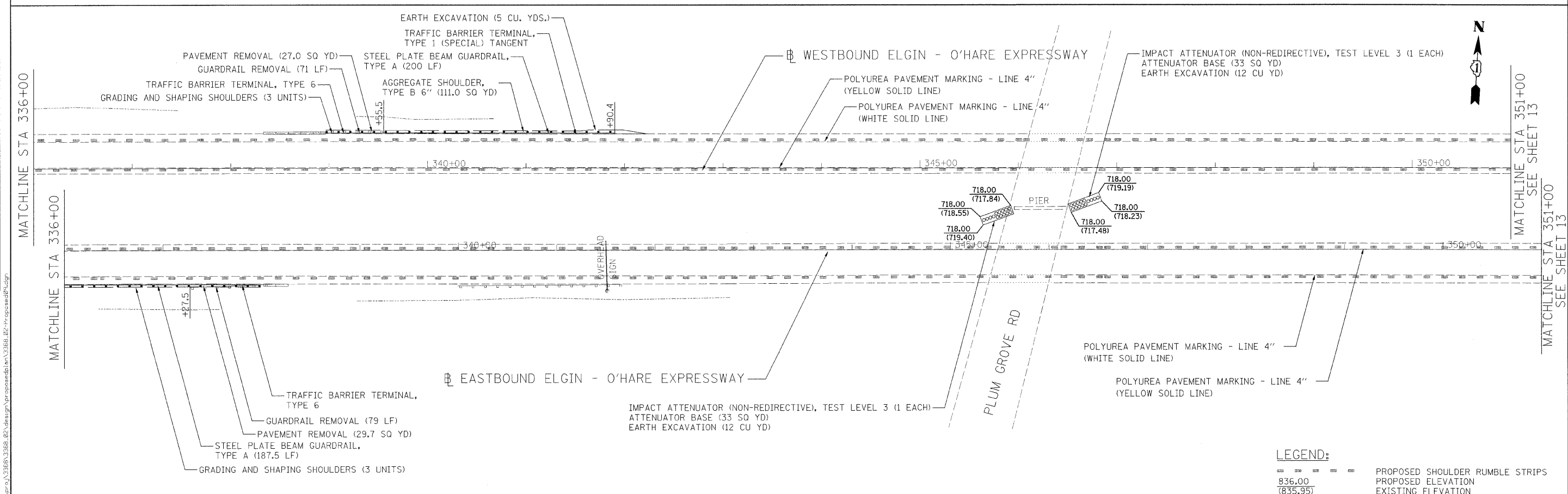
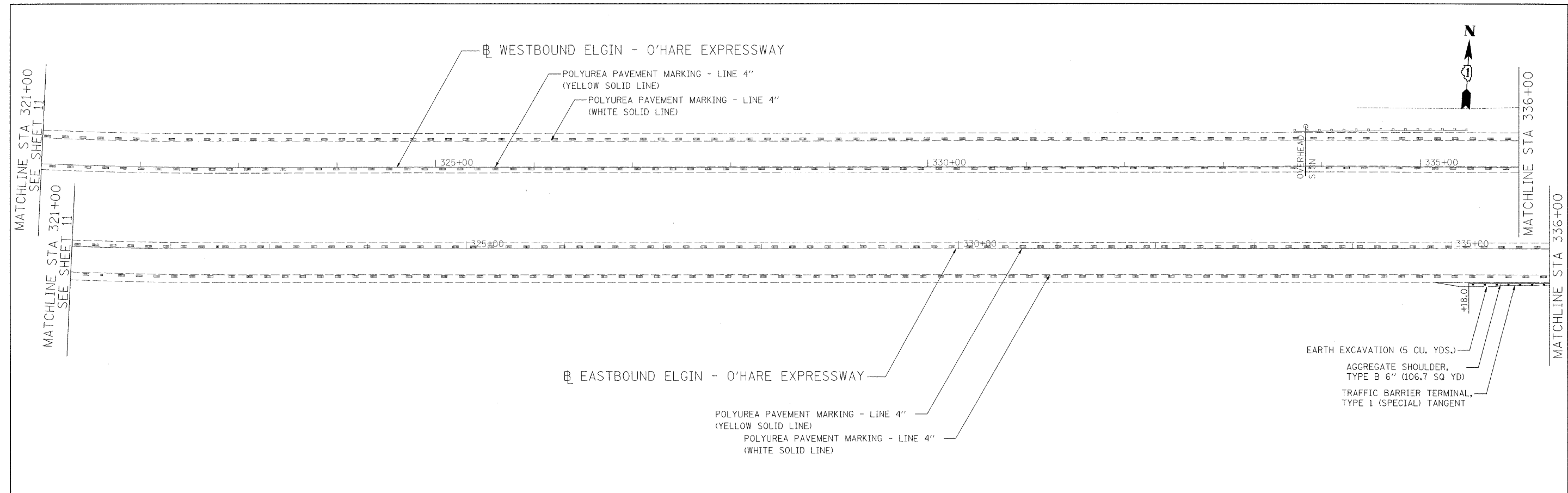

LEGEND:

=====	PROPOSED SHOULDER RUMBLE STRIPS
836.00	PROPOSED ELEVATION
(835.95)	EXISTING ELEVATION

Ciorba Group, Inc.
 CONSULTING ENGINEERS
 5507 North Cumberland Avenue, Suite 402
 Chicago, Illinois 60656
 Tel. 773.775.4009 Fax 773.775.4014

USER NAME = mready	DESIGNED - NT	REVISED -
PLOT SCALE = E0.0000' / IN.	DRAWN - NT	REVISED -
PLOT DATE = 12/23/2008	CHECKED - WBL	REVISED -
DATE = 12/23/2008	DATE = 12/23/2008	REVISED -

STATE OF ILLINOIS
DEPARTMENT OF TRANSPORTATION

FAP 345 / ELGIN O'HARE EXPRESSWAY
US 20 (LAKE ST.) TO I-290
ROADWAY PLAN

SCALE: SHEET NO. OF SHEETS STA. TO STA.

F.A.P. RTE. 345	SECTION 2008-076 I	COUNTY COOK/DUPAGE	TOTAL SHEETS 19	SHEET NO. 12
FED. ROAD DIST. NO. ILLINOIS FED. AID PROJECT		CONTRACT NO. 60F77		

PLAN	REVISIONS	DATE
	NOTED	
	ALIGNED	
	CHECKED	
	DATE	
	BY	
	NO.	
	FILE NAME	

PROFILE	REVISIONS	DATE
	NOTED	
	ALIGNED	
	CHECKED	
	DATE	
	BY	
	NO.	
	FILE NAME	

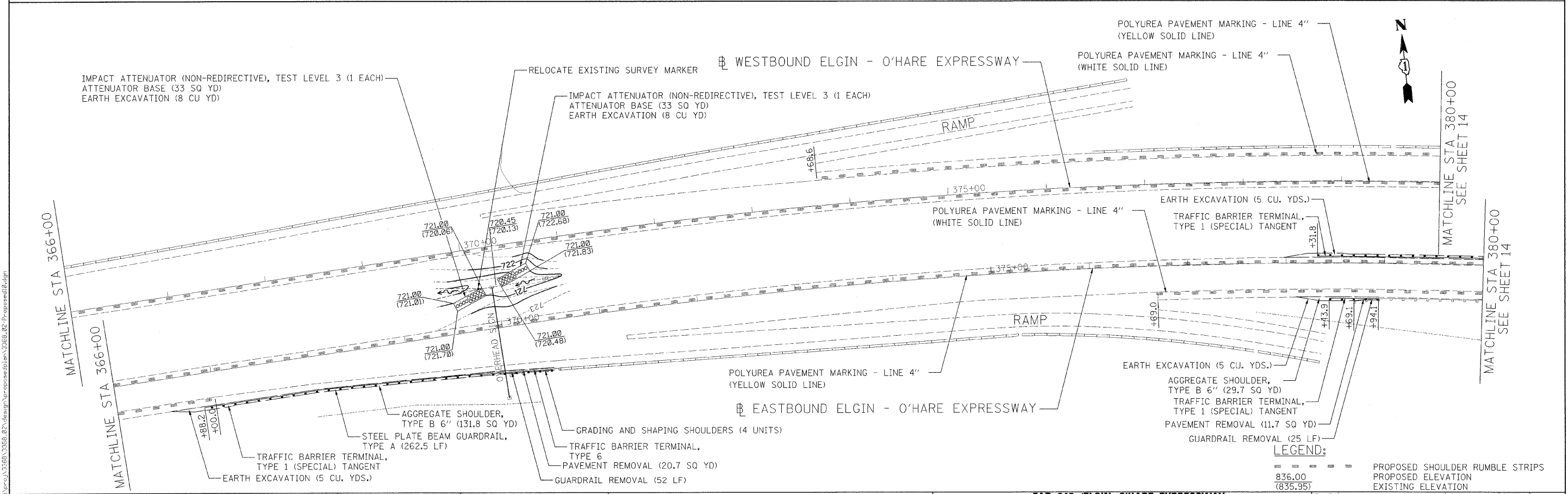
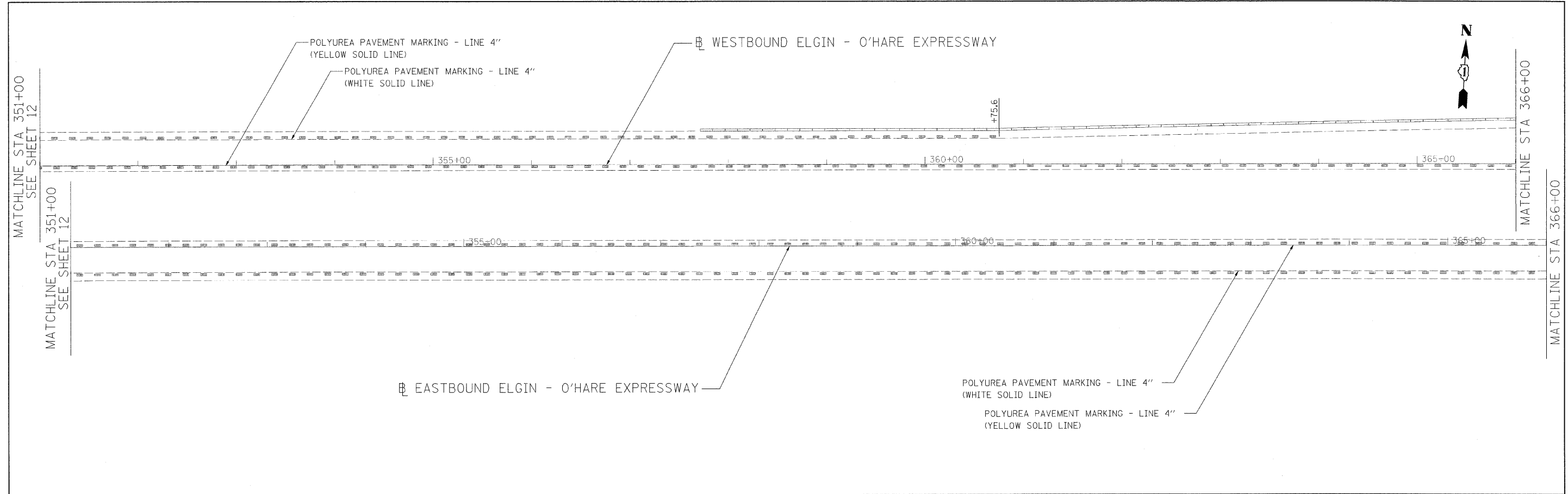

Ciorba Group, Inc.
CONSULTING ENGINEERS
6507 North Cumberland Avenue, Suite 402
Chicago, Illinois 60656
Tel 773.775.4009 Fax 773.775.4014

USER NAME = mready	DESIGNED - NT	REVISED -
PLOT SCALE = 50.0000' / IN.	DRAWN - NT	REVISED -
PLOT DATE = 12/23/2008	CHECKED - WBL	REVISED -
DATE = 12/23/2008	REVISIONS	REVISED -

**STATE OF ILLINOIS
DEPARTMENT OF TRANSPORTATION**

**FAP 345 / ELGIN O'HARE EXPRESSWAY
US 20 (LAKE ST.) TO I-290
ROADWAY PLAN**

SCALE: SHEET NO. OF SHEETS STA. TO STA.

F.A.P. RTE. 345	SECTION 2008-076 I	COUNTY COOK/DUPAGE	TOTAL SHEETS 19	SHEET NO. 13
FED. ROAD DIST. NO. ILLINOIS FED. AID PROJECT		CONTRACT NO. 60F77		

FILE NAME = I:\projects\345\345.dwg; Design\proposals\plan\345.dwg; Proposed\12.dwg

PLAN	DATE
BY	
DESIGNED	
DRAWN	
CHECKED	
REVISIONS	
NO.	
DATE	
BY	
DESCRIPTION	

PROFILE	DATE
BY	
DESIGNED	
DRAWN	
CHECKED	
REVISIONS	
NO.	
DATE	
BY	
DESCRIPTION	

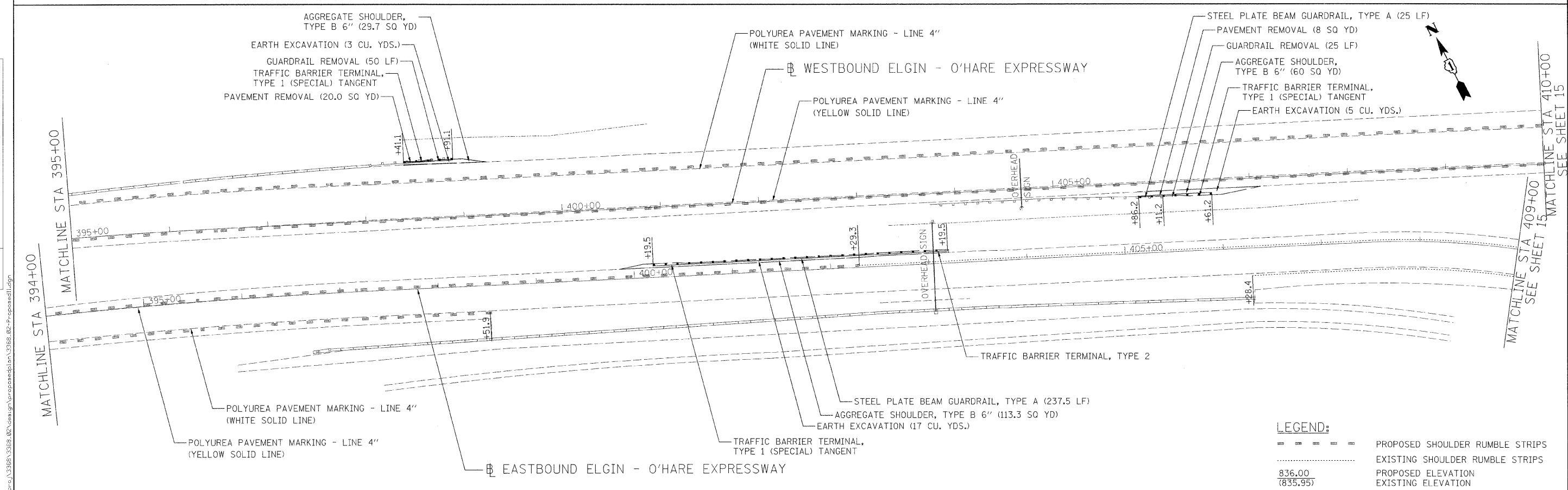
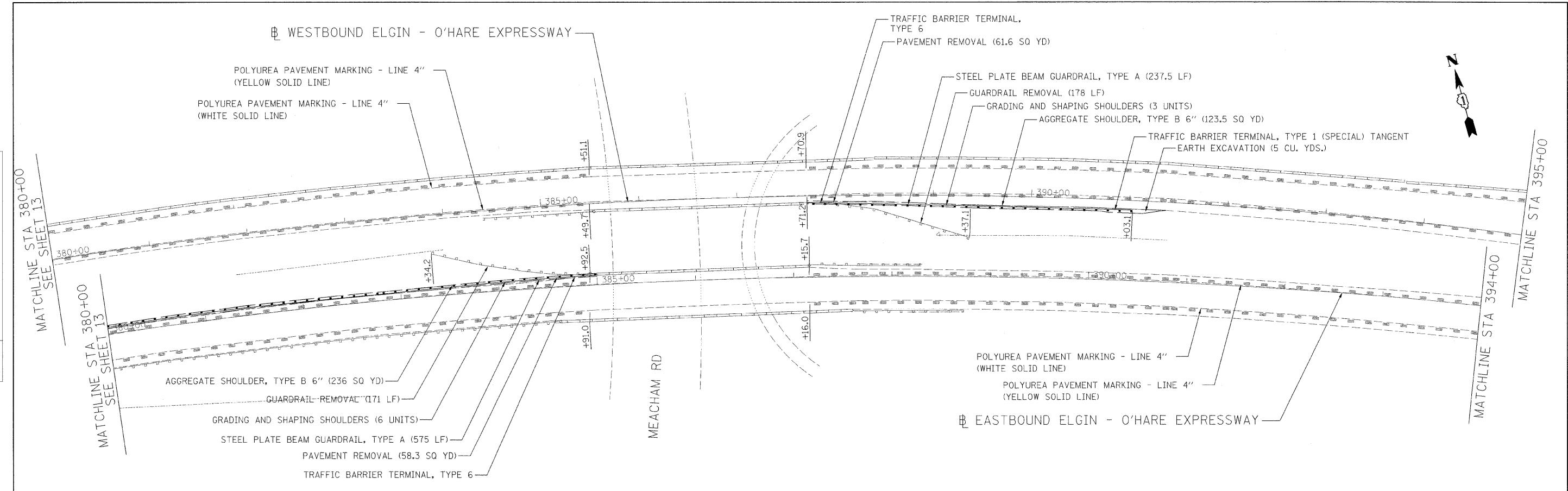

LEGEND:

-----	PROPOSED SHOULDER RUMBLE STRIPS
-----	EXISTING SHOULDER RUMBLE STRIPS
836.00	PROPOSED ELEVATION
(835.95)	EXISTING ELEVATION

FILE NAME: c:\projects\3386133861\33861_02\elgin\road\elgin_road.dwg, 12/23/2009, 12:23:09 PM, 12/23/2009, 12:23:09 PM, 12/23/2009, 12:23:09 PM

Ciorba Group, Inc.
 CONSULTING ENGINEERS
 5507 North Cumberland Avenue, Suite 402
 Chicago, Illinois 60656
 Tel. 773.775.4009 Fax 773.775.4014

USER NAME = mready	DESIGNED - NT	REVISED -
PLOT SCALE = 50.0000' / IN.	DRAWN - NT	REVISED -
PLOT DATE = 12/23/2009	CHECKED - WBL	REVISED -
DATE = 12/23/2009	DATE = 12/23/2009	REVISED -

**STATE OF ILLINOIS
 DEPARTMENT OF TRANSPORTATION**

**FAP 345 / ELGIN O'HARE EXPRESSWAY
 US 20 (LAKE ST.) TO I-290
 ROADWAY PLAN**

SCALE: SHEET NO. OF SHEETS STA. TO STA.

F.A.P. RTE. 345	SECTION 2008-076 I	COUNTY COOK/DUPAGE	TOTAL SHEETS 19	SHEET NO. 14
FED. ROAD DIST. NO. ILLINOIS FED. AID PROJECT			CONTRACT NO. 60F77	

PLAN	SURVEYED	DATE
	PLOTTED	BY
	GRADES CHECKED	
	STRUCTURE NOTATIONS CHECKED	
	NO.	
	DATE	

PROFILE	SURVEYED	DATE
	PLOTTED	BY
	GRADES CHECKED	
	STRUCTURE NOTATIONS CHECKED	
	NO.	
	DATE	

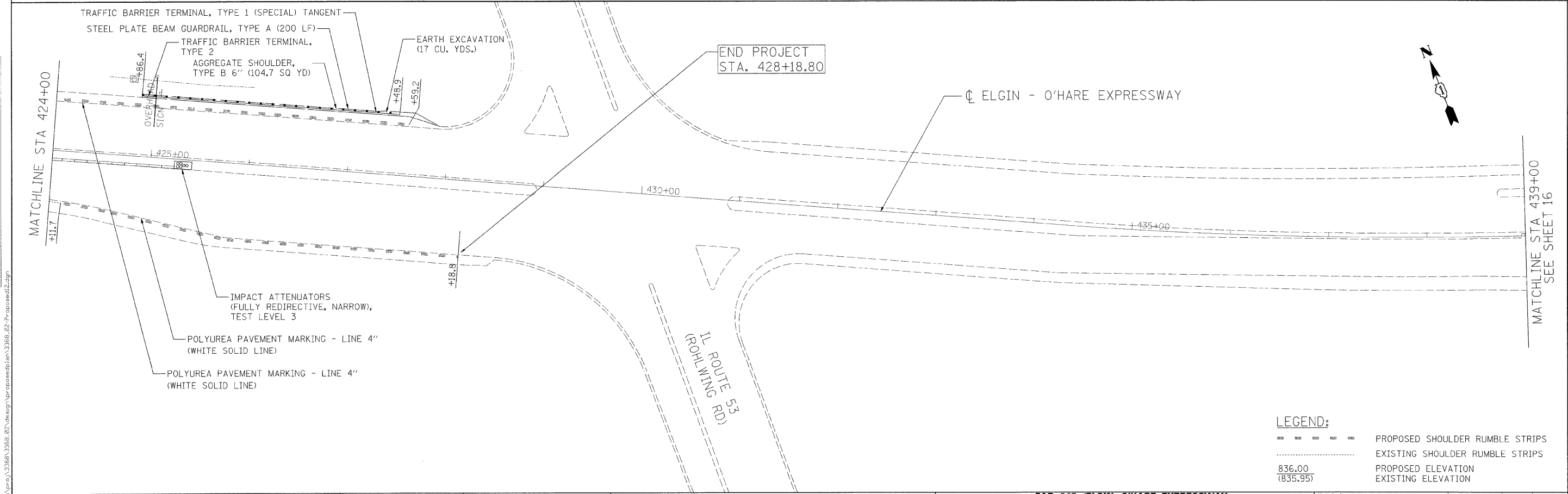
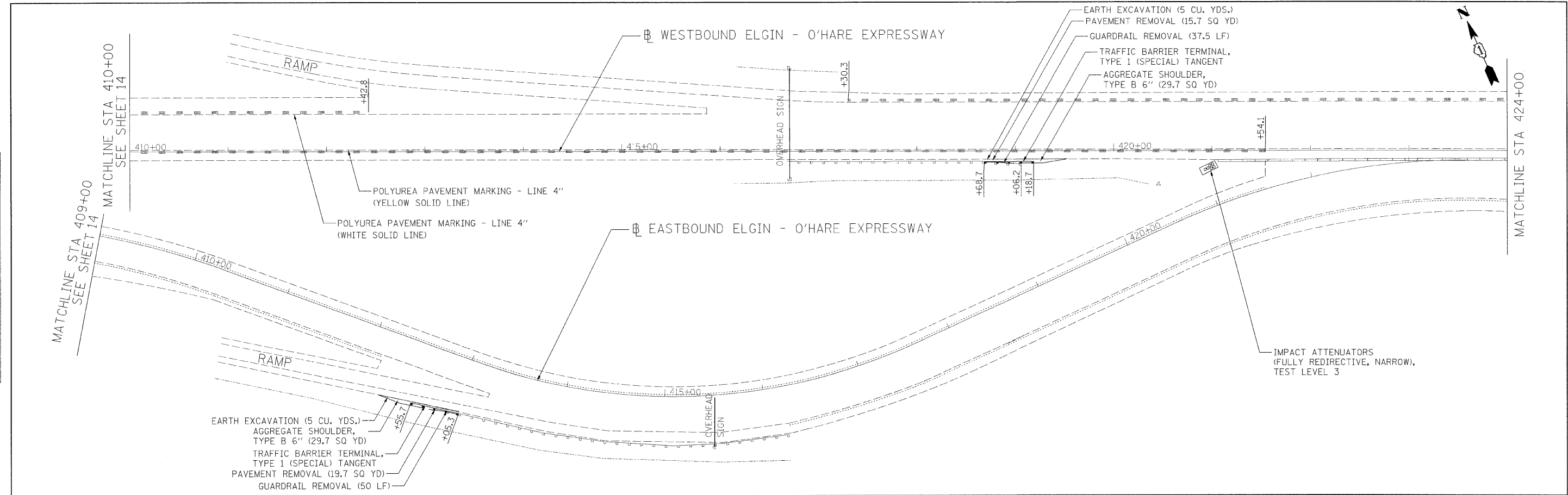

LEGEND:

---	PROPOSED SHOULDER RUMBLE STRIPS
.....	EXISTING SHOULDER RUMBLE STRIPS
836.00	PROPOSED ELEVATION
(835.95)	EXISTING ELEVATION

Ciorba Group, Inc.
 CONSULTING ENGINEERS
 5507 North Cumberland Avenue, Suite 402
 Chicago, Illinois 60656
 Tel. 773.775.4009 Fax 773.775.4014

USER NAME = mready	DESIGNED - NT	REVISED -
PLOT SCALE = 50.0000' / IN.	DRAWN - NT	REVISED -
PLOT DATE = 12/23/2008	CHECKED - WBL	REVISED -
	DATE - 12/23/2008	REVISED -

**STATE OF ILLINOIS
DEPARTMENT OF TRANSPORTATION**

FAP 345 / ELGIN O'HARE EXPRESSWAY			
US 20 (LAKE ST.) TO I-290			
ROADWAY PLAN			
SCALE:	SHEET NO.	OF SHEETS	STA. TO STA.

F.A.P. RTE. 345	SECTION 2008-076 I	COUNTY COOK/DUPAGE	TOTAL SHEETS 19	SHEET NO. 15
FED. ROAD DIST. NO. ILLINOIS FED. AID PROJECT			CONTRACT NO. 60F77	

PLAN	SUBMITTED	BY	DATE
	PLOTTED		
	GRADES CHECKED		
	STRUCTURE NOTATIONS CHKD		
	NOTE BOOK NO.		
	FILE NAME		

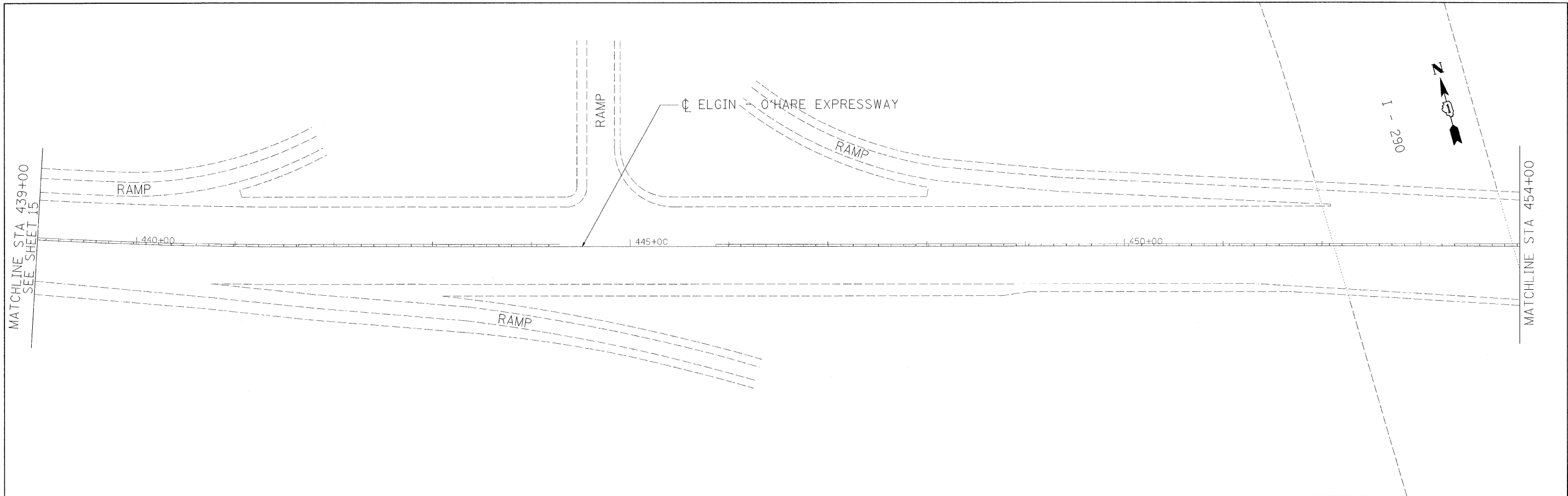

PROFILE	SUBMITTED	BY	DATE
	PLOTTED		
	GRADES CHECKED		
	STRUCTURE NOTATIONS CHKD		
	NOTE BOOK NO.		
	FILE NAME		

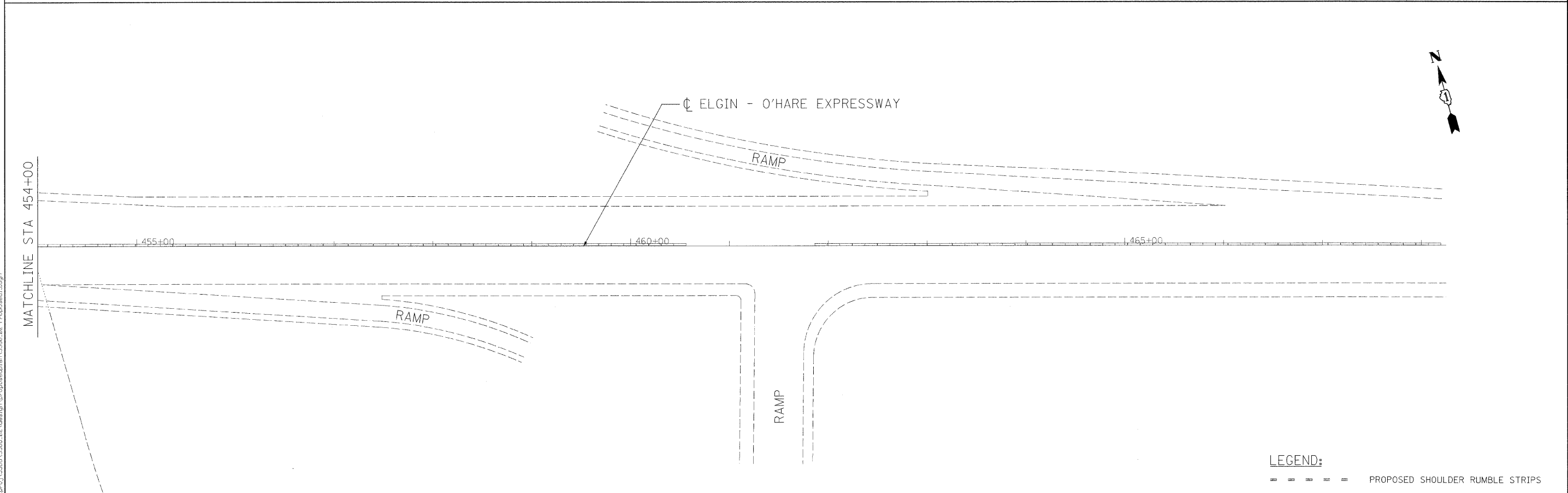

LEGEND:
 - - - - - PROPOSED SHOULDER RUMBLE STRIPS

FILE NAME: E:\Work\3266\3266.dgn

Ciorba Group, Inc.
 CONSULTING ENGINEERS
 5507 North Cumberland Avenue, Suite 402
 Chicago, Illinois 60656
 Tel. 773.775.4008 Fax 773.775.4014

USER NAME = mreed	DESIGNED - DD	REVISED -
PLOT SCALE = 50.0000' / IN.	DRAWN - DD	REVISED -
PLOT DATE = 12/23/2008	CHECKED - MJL	REVISED -
	DATE - 12/23/2008	REVISED -

**STATE OF ILLINOIS
 DEPARTMENT OF TRANSPORTATION**

**FAP 345 / US 20 (LAKE ST.)
 WELD ROAD TO BLUFF CITY BLVD/SHALES PARKWAY
 ROADWAY PLAN**

F.A.P. RTE. 345	SECTION 2008-076 I	COUNTY COOK/DUPAGE	TOTAL SHEETS 19	SHEET NO. 16
FED. ROAD DIST. NO. ILLINOIS FED. AID PROJECT			CONTRACT NO. 60F77	

SCALE: SHEET NO. OF SHEETS STA. TO STA.

F.A.P. RTE.	SECTION	COUNTY	TOTAL SHEETS	SHEET NO.
345	2008-076 I	COOK/DUPAGE	19	17
STA.		TO STA.		
FED. ROAD DIST. NO.		ILLINOIS FED. AID PROJECT		

THE DIAGONAL LINES SHALL BE SPACED AT 40' (12 m) C-C ACROSS ALL STRUCTURES WHICH ARE 500' (150 m) OR LESS IN LENGTH
 THE DIAGONAL LINES ARE NOT REQUIRED ON SHOULDERS WHICH ARE 6' (1.8 m) OR LESS IN WIDTH

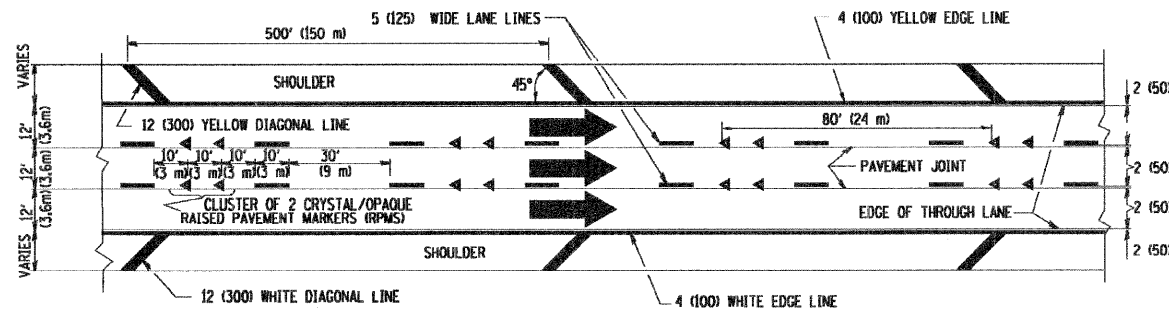

TYPICAL EDGE LINES & LANE LINES

NOTES:

1. THERMO PLASTIC PAVEMENT MARKING LINE SHALL BE USED FOR THE EDGE LINES, GORE LINES, AND DIAGONAL LINES ON BITUMINOUS PAVEMENT ONLY.
2. PREFORMED PLASTIC TYPE B PAVEMENT MARKING LINE SHALL BE USED FOR ALL LANE LINES ON BITUMINOUS PAVEMENT
3. POLYUREA PAVEMENT MARKING SHALL BE USED FOR ALL MARKINGS ON PCC

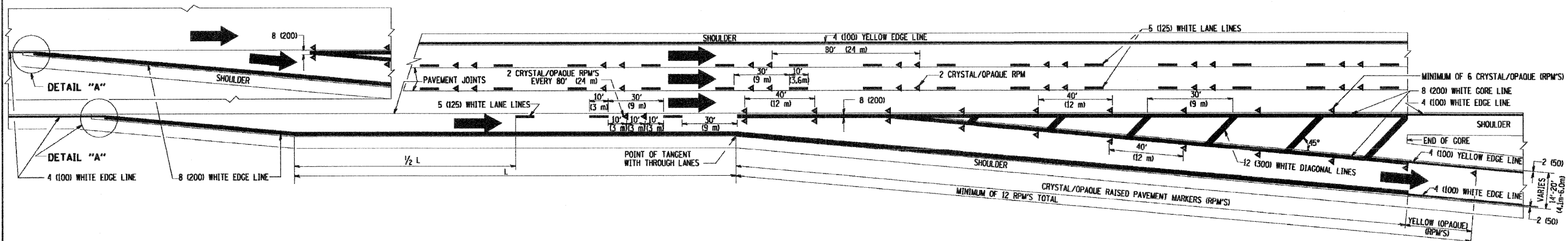
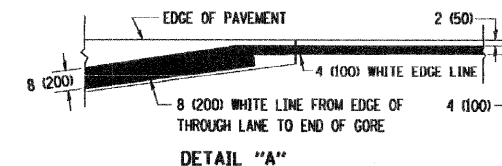

TYPICAL EXIT RAMP PAVEMENT MARKINGS

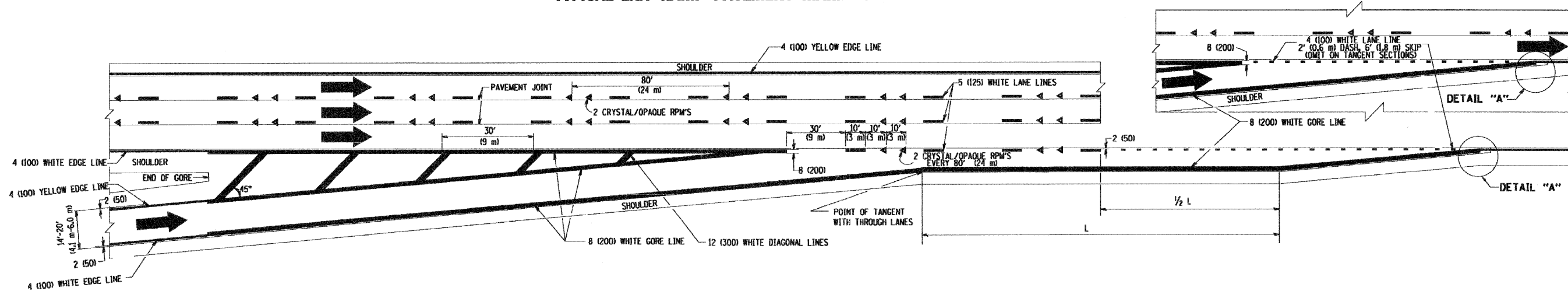

TYPICAL ENTRANCE RAMP PAVEMENT MARKINGS

REVISIONS	
NAME	DATE
DWS	1/90
DWS	5/91
AH	3/96
DWS	7/96
JAF	2/06
SPB	1/07

ILLINOIS DEPARTMENT OF TRANSPORTATION

MULTI-LANE FREEWAY PAVEMENT MARKING DETAILS

SCALE: NONE

DRAWN BY C.A.D.D.

CHECKED BY

F.A.P. RTE.	SECTION	COUNTY	TOTAL SHEETS	SHEET NO.
345	2008-076 I	COOK/DUPAGE	19	18
STA.	TO STA.			
FED. ROAD DIST. NO.	ILLINOIS	FED. AID PROJECT		

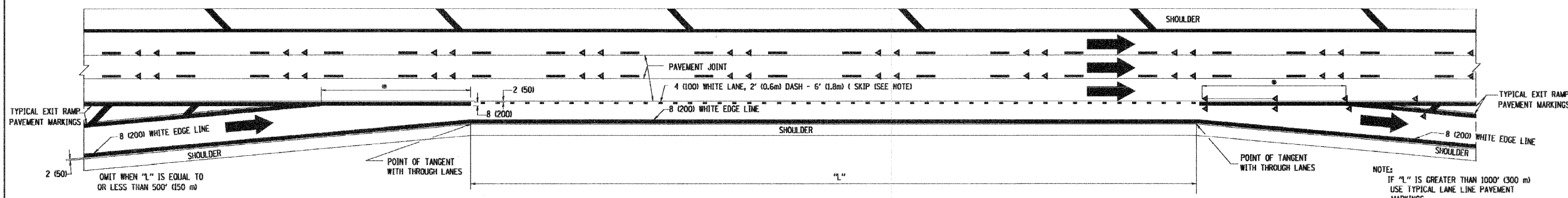

TYPICAL ENTRANCE/EXIT RAMP COMBINATION PAVEMENT MARKINGS

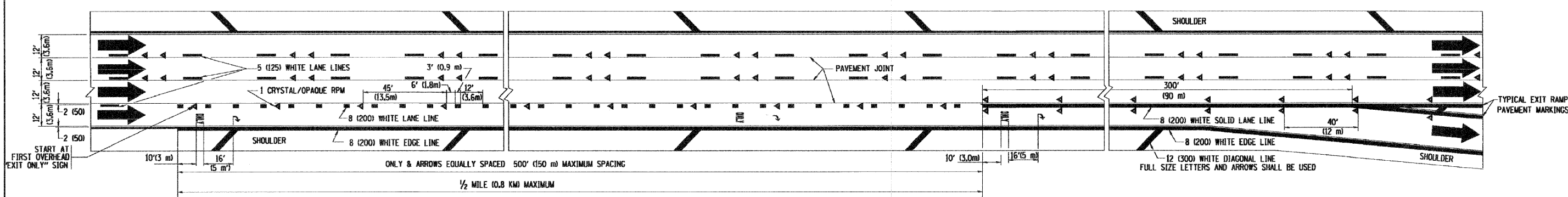

TYPICAL EXIT ONLY LANE PAVEMENT MARKINGS

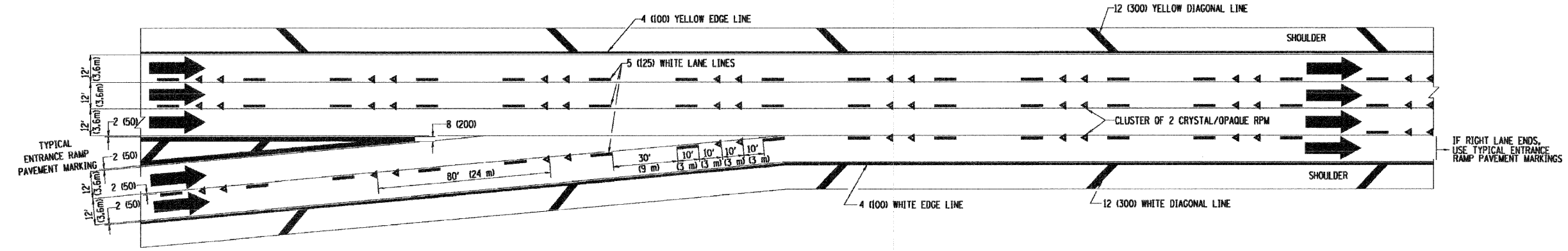

TYPICAL TWO LANE ENTRANCE RAMP PAVEMENT MARKINGS

REVISIONS	
NAME	DATE
DWS	1/90
DWS	5/91
SPB	1/07

ILLINOIS DEPARTMENT OF TRANSPORTATION

MULTI-LANE FREEWAY PAVEMENT MARKING DETAILS

SCALE: NONE

DRAWN BY C.A.D.D.
CHECKED BY

DATE: 5/15/2007
 FILE: I:\Projects\12-07\12-07.dgn
 PLOT SCALE: 0.25" = 1'-0"
 USER: NAME: [blank]

PARTIAL RAMP CLOSURE DETAILS

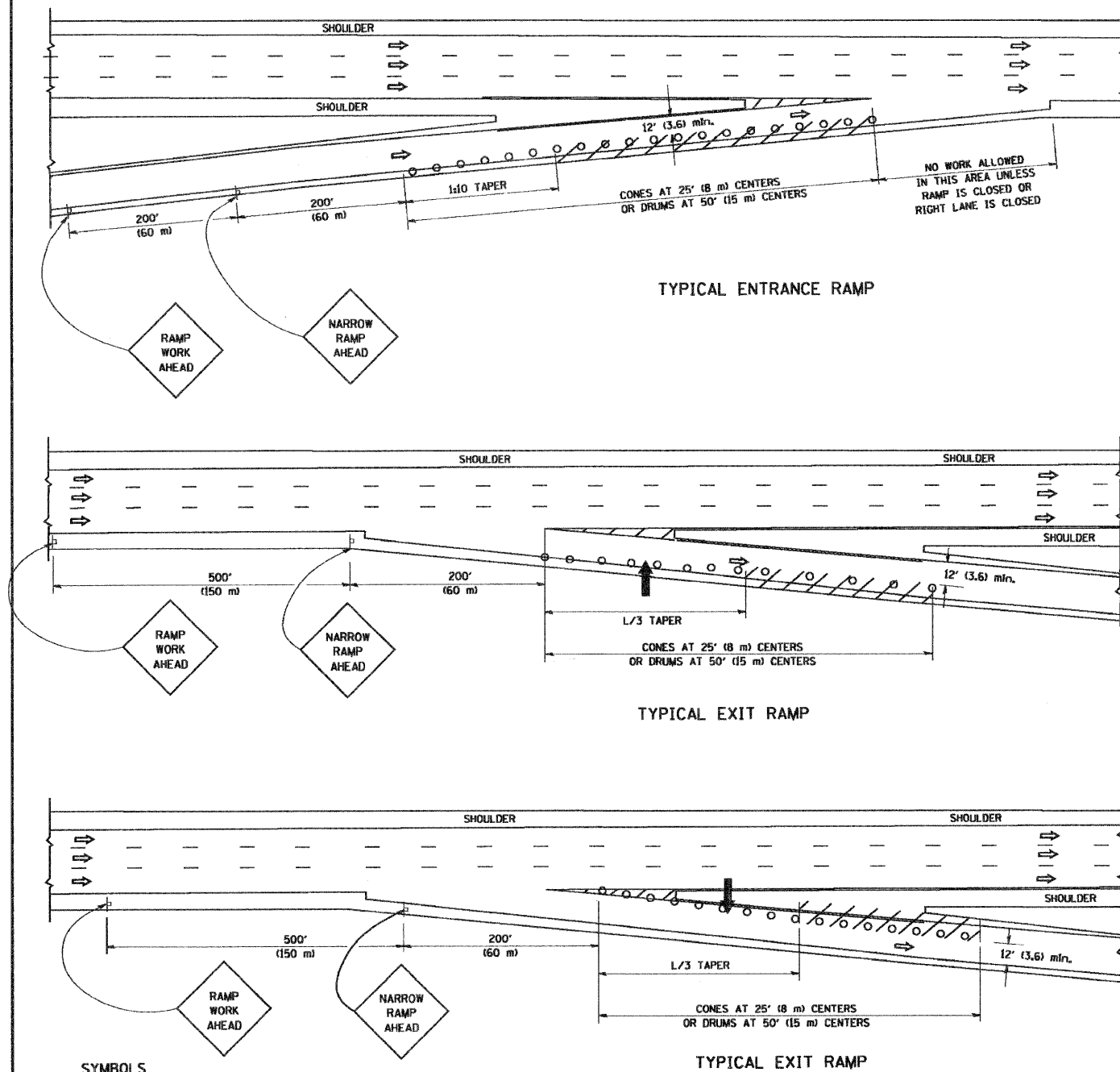

SYMBOLS

- ARROWBOARD
- WORK AREA
- SIGN ON PORTABLE OR PERMANENT SUPPORT
- FLAGGER WITH CONTROL SIGN
- TYPE II BARRICADE, DRUM OR VERTICAL BARRICADE WITH STEADY BURN MONO-DIRECTIONAL LIGHT
- CONE, DRUM OR BARRICADE

GENERAL NOTES

1. THE "L" DISTANCE EQUALS:

SPEED LIMIT	FORMULAS
45 mph (80 km/h) OR GREATER:	METRIC ENGLISH
	$L = 0.65(WNS)$ $L = (WNS)$
	$W =$ WIDTH OF OFFSET IN FEET (METERS)
	$S =$ NORMAL POSTED SPEED MPH (KM/H)
2. PLASTIC DRUMS WITH HIGH PERFORMANCE REFLECTIVE SHEETING AND STEADY BURNING LIGHTS ARE REQUIRED FOR ALL NIGHTIME CLOSURES.
3. ALL SIGNS SHALL BE POST MOUNTED IF THE CLOSURE TIME EXCEEDS FOUR DAYS.
4. FLASHING LIGHTS SHALL BE USED DURING THE HOURS OF DARKNESS AND SHALL BE INSTALLED ABOVE THE FIRST TWO SETS OF SIGNS.

SHOULDER CLOSURE DETAILS

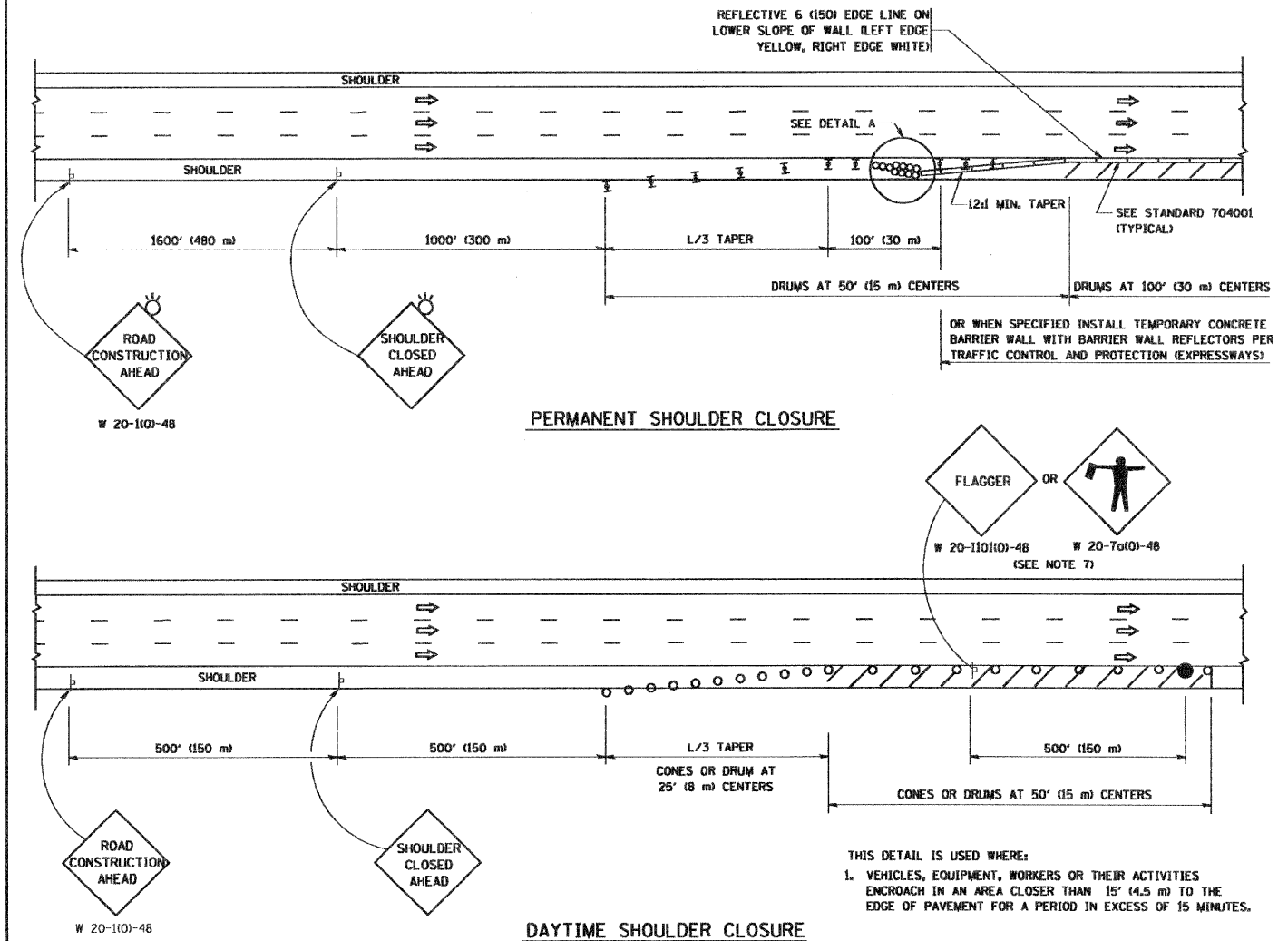

THIS DETAIL IS USED WHERE:
 1. VEHICLES, EQUIPMENT, WORKERS OR THEIR ACTIVITIES ENCRANCH IN AN AREA CLOSER THAN 15' (4.5 m) TO THE EDGE OF PAVEMENT FOR A PERIOD IN EXCESS OF 15 MINUTES.

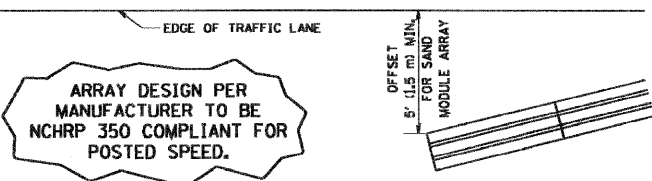

**DETAIL "A"
IMPACT ATTENUATOR, TEMPORARY
(SEE NOTE 5)**

ALL DIMENSIONS ARE IN INCHES (MILLIMETERS) UNLESS OTHERWISE SHOWN.

5. THE IMPACT ATTENUATOR, TEMPORARY IS NOT REQUIRED WHEN THE TEMPORARY CONCRETE BARRIER WALL IS PROTECTED BY OR IS TIED INTO THE EXISTING GUARDRAIL. IF OFFSET IS LESS THAN 5 FEET USE "TRAFFIC BARRIER TERMINAL, TYPE III, TEMPORARY" DEVICE TO MEET NCHRP350 FOR POSTED SPEED.
6. AUTHORIZATION FROM THE DISTRICT'S BUREAU OF TRAFFIC IS REQUIRED FOR ALL FREEWAY CLOSURES.
7. THE FLAGGER AND FLAGGER SIGN ARE REQUIRED AT THE ABOVE WORK SITES WHEN:
 - a. FOUR OR MORE WORK VEHICLES ENTER THE TRAFFIC LANES IN A ONE HOUR PERIOD.
 - b. THE WORK AVTIVITY REQUIRES FREQUENT ENCRACHMENT INTO THE LANE OPEN TO TRAFFIC.
 THE FLAGGER SHALL BE STATIONED APPROXIMATELY 100' (30 m) TO 200' (60 m) IN ADVANCE OF THE WORKERS.

FILE NAME = W:\data\td\22x34\to17.dgn	USER NAME = goglienobt	DESIGNED - J.A.F. 12-02	REVISED - J.A.F. 12-02	STATE OF ILLINOIS DEPARTMENT OF TRANSPORTATION	TRAFFIC CONTROL DETAILS FOR FREEWAY SHOULDER CLOSURES AND PARTIAL RAMP CLOSURES	F.A.P. RTE. 345	SECTION 2008-076 I	COUNTY COOK/DUPAGE	TOTAL SHEETS 19	SHEET NO. 19
PLOT SCALE = 50.0000' / IN.	PLOT DATE = 1/4/2008	DRAWN - D.W.S.	REVISD - 04-03		SCALE: NONE	SHEET NO. 1 OF 1 SHEETS	STA. TO STA.	CONTRACT NO. 60F77		
		CHECKED - J.A.F. 12-06	REVISD - J.A.F. 12-06					FED. ROAD DIST. NO. 1 ILLINOIS FED. AID PROJECT		
		DATE - 11-96	REVISD - S.P.B. 01-07							