

PROFILE SURVEYED BY DATE  
 GRADES CHECKED  
 B.M. NOTED  
 STRUCTURE NOTATIONS OK'D  
 PLAN SURVEYED BY DATE  
 NOTE BOOK NO.  
 ALIGNMENT CHECKED  
 RT. OF WAY CHECKED  
 JOB FILE NAME

CHRISTOPHER B. BURKE ENGINEERING LTD.  
 3575 West Higgins Road, Suite 600  
 Rosemead, Illinois 60018  
 (617) 825-0500

N:\dot\0808\Task G-P IL 50\Task N - IL 50 & CtsSvDr.dgn

TRAFFIC SIGNAL LEGEND

- | PROPOSED | EXISTING |
|----------|----------|
|          |          |
|          |          |
|          |          |
|          |          |
|          |          |
|          |          |
|          |          |
|          |          |
|          |          |
|          |          |
|          |          |
|          |          |
|          |          |
|          |          |
|          |          |
|          |          |
|          |          |
|          |          |
|          |          |
|          |          |
|          |          |
|          |          |
|          |          |
|          |          |
|          |          |
|          |          |
|          |          |
|          |          |
|          |          |
|          |          |

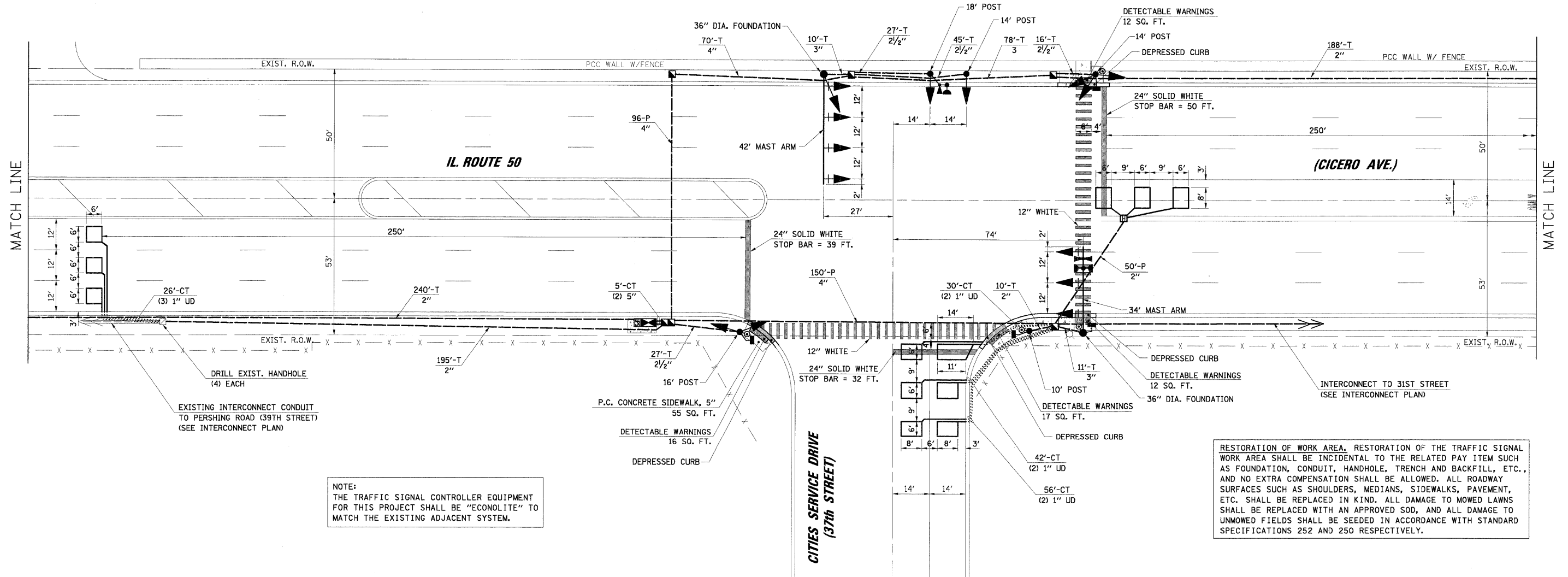
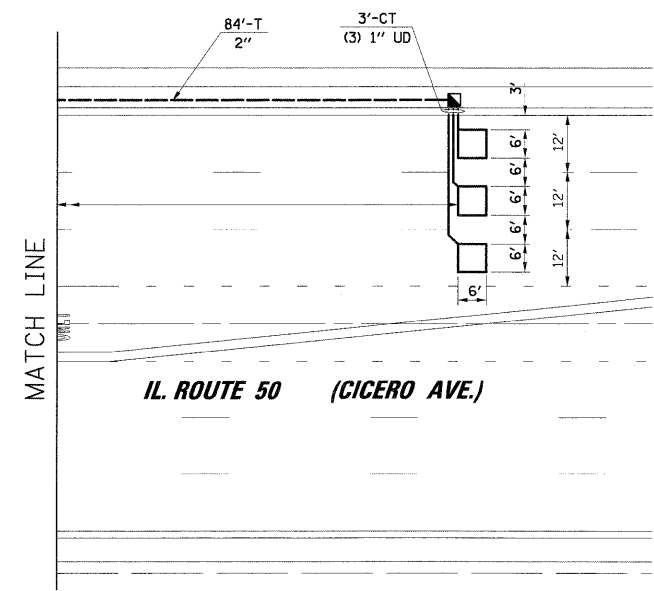
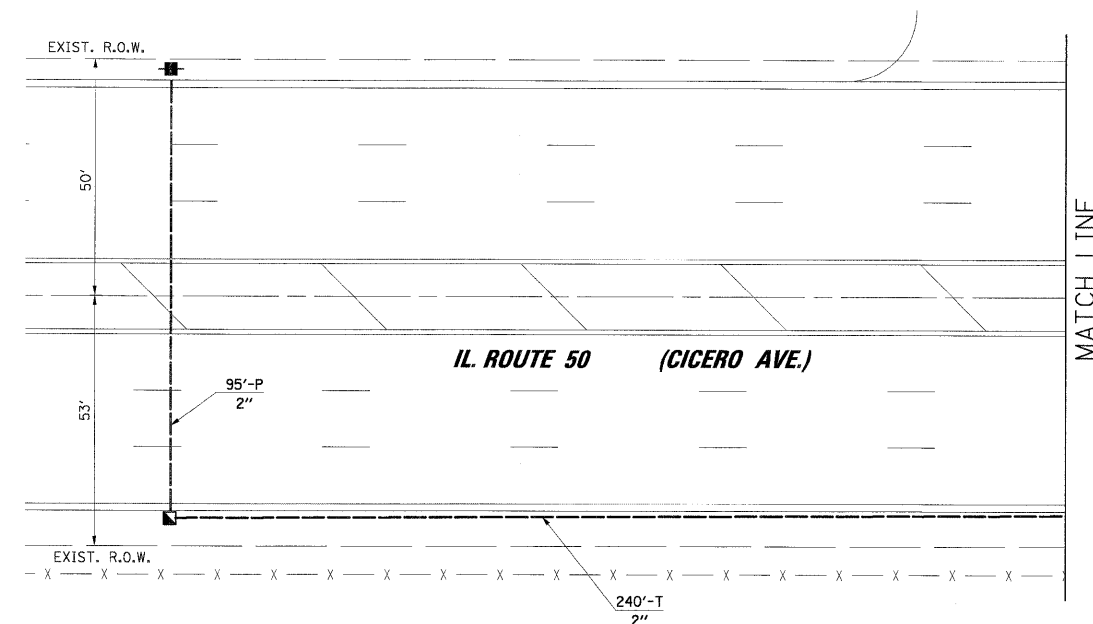
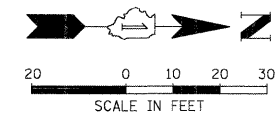

NOTE:  
THE TRAFFIC SIGNAL CONTROLLER EQUIPMENT FOR THIS PROJECT SHALL BE "ECONOLITE" TO MATCH THE EXISTING ADJACENT SYSTEM.

RESTORATION OF WORK AREA. RESTORATION OF THE TRAFFIC SIGNAL WORK AREA SHALL BE INCIDENTAL TO THE RELATED PAY ITEM SUCH AS FOUNDATION, CONDUIT, HANDHOLE, TRENCH AND BACKFILL, ETC., AND NO EXTRA COMPENSATION SHALL BE ALLOWED. ALL ROADWAY SURFACES SUCH AS SHOULDERS, MEDIANS, SIDEWALKS, PAVEMENT, ETC. SHALL BE REPLACED IN KIND. ALL DAMAGE TO MOWED LAWNS SHALL BE REPLACED WITH AN APPROVED SOD, AND ALL DAMAGE TO UNMOWED FIELDS SHALL BE SEEDING IN ACCORDANCE WITH STANDARD SPECIFICATIONS 252 AND 250 RESPECTIVELY.

FILE NAME = N:\dot\0808\Task G-P IL 50\Task N - IL 50 & CtsSvDr.dgn	USER NAME = FPACIONE	DESIGNED - ABR	REVISED -	<b>STATE OF ILLINOIS DEPARTMENT OF TRANSPORTATION</b>	<b>TRAFFIC SIGNAL MODERNIZATION PLAN</b>			F.A.P. RTE. 350	SECTION 2008-080-I	COUNTY COOK	TOTAL SHEETS 76	SHEET NO. 10
	PLOT SCALE = 20'	DRAWN - FPB	REVISED -		IL. ROUTE 50 (CICERO AVE.) AND CITIES SERVICE DRIVE / 37th STREET CICERO, ILLINOIS			CONTRACT NO. 60F82				
	PLOT DATE = 12/10/2008	CHECKED - MJT	REVISED -		SCALE: 1" = 20'			SHEET NO. OF SHEETS STA. TO STA.				
		DATE -	REVISED -		FED. ROAD DIST. NO.			ILLINOIS FED. AID PROJECT				