

PROFILE
 CHECKED BY: _____
 GRADES CHECKED BY: _____
 STRUCTURE NOTATIONS CHECKED BY: _____
 DATE: _____
 BY: _____
 SURVEYED BY: _____
 ALIGNED BY: _____
 RT. OF WAY CHECKED BY: _____
 DATE: _____
 FILE NAME: _____

CHRISTOPHER B. BURKE ENGINEERING LTD.
 3515 West Higgins Road, Suite 600
 Chicago, Illinois 60638
 (847) 823-0600

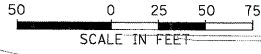
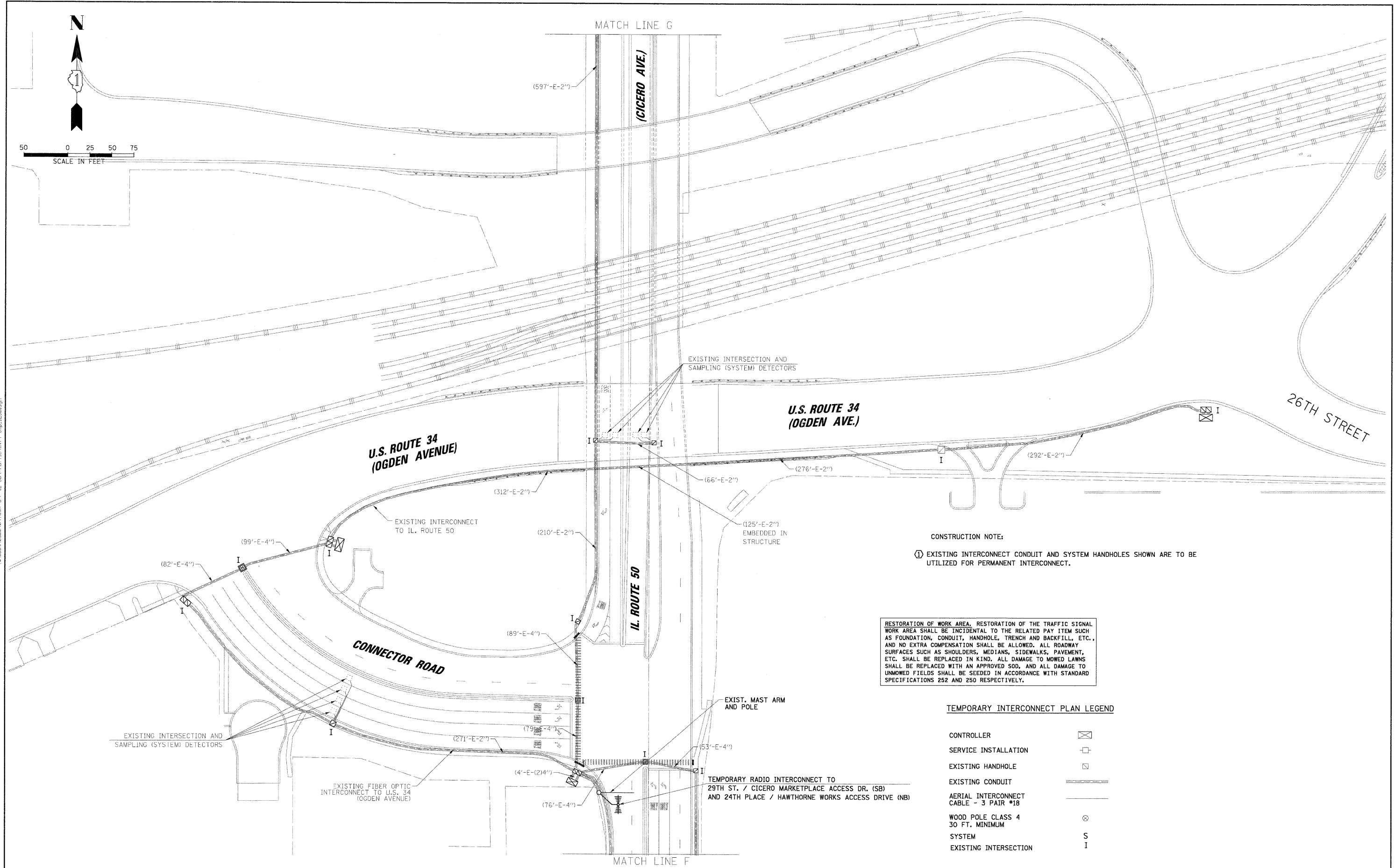

CONSTRUCTION NOTE:
 ① EXISTING INTERCONNECT CONDUIT AND SYSTEM HANDHOLES SHOWN ARE TO BE UTILIZED FOR PERMANENT INTERCONNECT.

RESTORATION OF WORK AREA. RESTORATION OF THE TRAFFIC SIGNAL WORK AREA SHALL BE INCIDENTAL TO THE RELATED PAY ITEM SUCH AS FOUNDATION, CONDUIT, HANDHOLE, TRENCH AND BACKFILL, ETC., AND NO EXTRA COMPENSATION SHALL BE ALLOWED. ALL ROADWAY SURFACES SUCH AS SHOULDERS, MEDIANS, SIDEWALKS, PAVEMENT, ETC. SHALL BE REPLACED IN KIND. ALL DAMAGE TO MOWED LAWNS SHALL BE REPLACED WITH AN APPROVED SOD, AND ALL DAMAGE TO UNMOWED FIELDS SHALL BE SEEDING IN ACCORDANCE WITH STANDARD SPECIFICATIONS 252 AND 250 RESPECTIVELY.

TEMPORARY INTERCONNECT PLAN LEGEND

- CONTROLLER ☒
- SERVICE INSTALLATION ☐
- EXISTING HANDHOLE ☑
- EXISTING CONDUIT ══
- AERIAL INTERCONNECT CABLE - 3 PAIR #18 ---
- WOOD POLE CLASS 4 30 FT. MINIMUM ⊗
- SYSTEM S
- EXISTING INTERSECTION I

FILE NAME =	USER NAME = FPACTIONE	DESIGNED - ABR	REVISED -	STATE OF ILLINOIS DEPARTMENT OF TRANSPORTATION	TEMPORARY INTERCONNECT PLAN IL. ROUTE 50 (CICERO AVE.) FROM 39th ST. (PERSHING RD.) TO ROOSEVELT RD., CICERO, ILLINOIS	F.A.P. RTE. 350	SECTION 2008-080-I	COUNTY COOK	TOTAL SHEETS 76	SHEET NO. 55		
N:\dot\080840\Task C-P IL 50\Traffic\INT4	tnp_IL50.dgn	DRAWN - FPB	REVISED -			SCALE: 1"= 50'	SHEET NO. OF SHEETS STA. TO STA.	FED. ROAD DIST. NO.	ILLINOIS FED. AID PROJECT	CONTRACT NO. 60F82		
	PLOT SCALE = 50'	CHECKED - MJT	REVISED -									
	PLOT DATE = 12/10/2008	DATE -	REVISED -									