

PROFILE SURVEYED BY DATE
 GRADES CHECKED BY DATE
 STRUCTURE NOTATION CHKD BY DATE
 NOTE BOOK NO.

PLAN SURVEYED BY DATE
 NOTE BOOK NO.
 ALIGNMENT CHECKED BY DATE
 RT. OF WAY CHECKED BY DATE
 ROAD FILE NAME

CHRISTOPHER B. BURKE ENGINEERING LTD.
 3575 West Higgins Road, Suite 600
 Chicago, Illinois 60638
 (847) 823-0500

N:\dot\080840\Task G-P IL 50\Traffic\INT-IL-IL-50.dgn

INTERCONNECT PLAN LEGEND

	PROPOSED	EXISTING
CONTROLLER		
HANDHOLE		
DOUBLE HANDHOLE		
HEAVY-DUTY HANDHOLE		
G.S. CONDUIT IN TRENCH (T) OR PUSHED (P)		
DETECTOR LOOP SYSTEM		
INTERSECTION	IP	I
UNIT DUCT	UD	
COMMON TRENCH	CT	

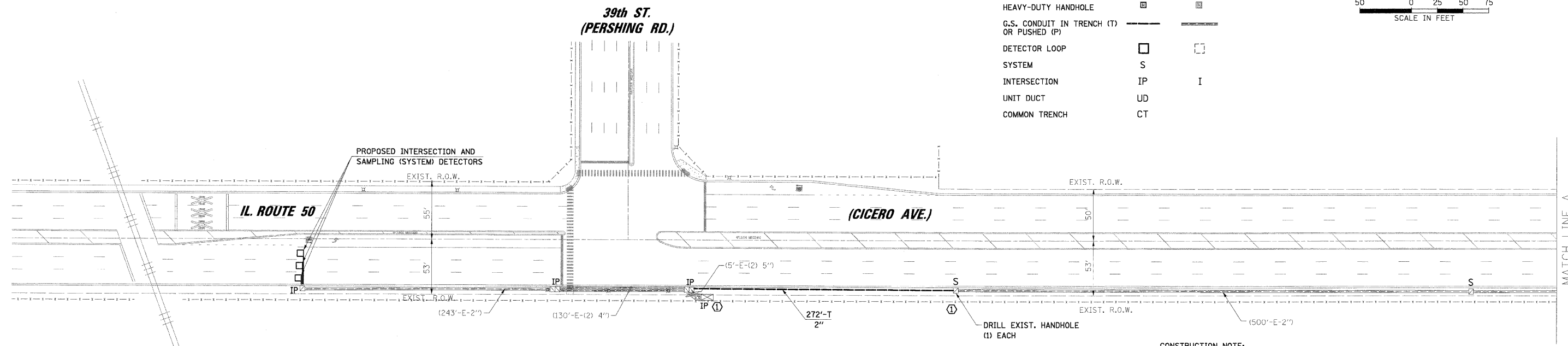
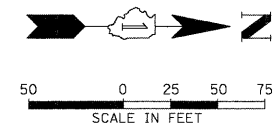

CONSTRUCTION NOTE:

① DISCONNECT FIBER AND TRACER CABLES FROM 39TH STREET AND CITIES SERVICE DRIVE, AND PULL BACK, COIL AND STORE CABLES IN CONDUITS AND HANDHOLES WHICH ARE TO REMAIN. REINSTALL CABLES IN NEW CONDUITS, HANDHOLES AND CONTROLLER CABINETS.

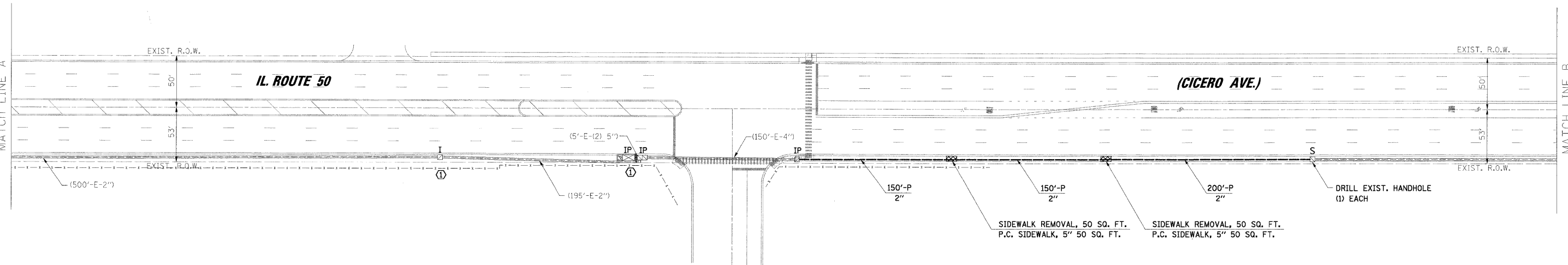

RESTORATION OF WORK AREA. RESTORATION OF THE TRAFFIC SIGNAL WORK AREA SHALL BE INCIDENTAL TO THE RELATED PAY ITEM SUCH AS FOUNDATION, CONDUIT, HANDHOLE, TRENCH AND BACKFILL, ETC., AND NO EXTRA COMPENSATION SHALL BE ALLOWED. ALL ROADWAY SURFACES SUCH AS SHOULDERS, MEDIANS, SIDEWALKS, PAVEMENT, ETC. SHALL BE REPLACED IN KIND. ALL DAMAGE TO MOWED LAWNS SHALL BE REPLACED WITH AN APPROVED SOD, AND ALL DAMAGE TO UNMOWED FIELDS SHALL BE SEEDED IN ACCORDANCE WITH STANDARD SPECIFICATIONS 252 AND 250 RESPECTIVELY.

CITIES SERVICE DRIVE (37th STREET)

FILE NAME = N:\dot\080840\Task G-P IL 50\Traffic\INT-IL-IL-50.dgn	USER NAME = FPACIDNE	DESIGNED - ABR	REVISED -	STATE OF ILLINOIS DEPARTMENT OF TRANSPORTATION	INTERCONNECT PLAN				F.A.P. RTE. 350	SECTION 2008-080-I	COUNTY COOK	TOTAL SHEETS 76	SHEET NO. 60	
	PLOT SCALE = 50'	DRAWN - FPB	REVISED -		IL. ROUTE 50 (CICCERO AVE.) FROM 39th ST. (PERSHING RD.) TO ROOSEVELT RD. CICCERO, ILLINOIS				CONTRACT NO. 60F82					
	PLOT DATE = 12/10/2008	CHECKED - MJT	REVISED -		SCALE: 1"= 50'				SHEET NO.	OF SHEETS	STA.	TO STA.	FED. ROAD DIST. NO. ILLINOIS FED. AID PROJECT	
		DATE -	REVISED -		RESTORATION OF WORK AREA. RESTORATION OF THE TRAFFIC SIGNAL WORK AREA SHALL BE INCIDENTAL TO THE RELATED PAY ITEM SUCH AS FOUNDATION, CONDUIT, HANDHOLE, TRENCH AND BACKFILL, ETC., AND NO EXTRA COMPENSATION SHALL BE ALLOWED. ALL ROADWAY SURFACES SUCH AS SHOULDERS, MEDIANS, SIDEWALKS, PAVEMENT, ETC. SHALL BE REPLACED IN KIND. ALL DAMAGE TO MOWED LAWNS SHALL BE REPLACED WITH AN APPROVED SOD, AND ALL DAMAGE TO UNMOWED FIELDS SHALL BE SEEDED IN ACCORDANCE WITH STANDARD SPECIFICATIONS 252 AND 250 RESPECTIVELY.									