

CONTRACT NO. 62514				
F.A.P. RTE.	SECTION	COUNTY	TOTAL SHEETS	SHEET NO.
333	2002-101N	LAKE	75	30
STA.		TO STA.		
FED. ROAD DIST. NO.		ILLINOIS FED. AID PROJECT		

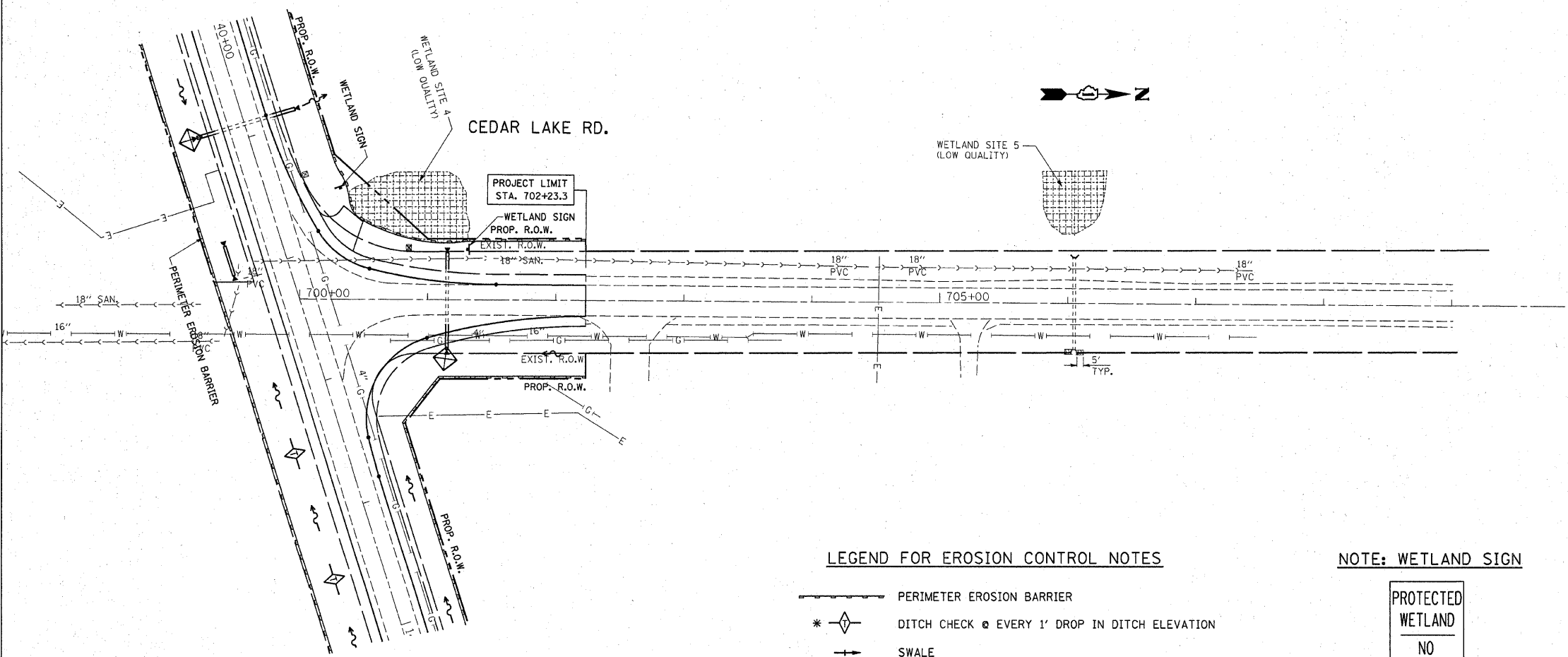
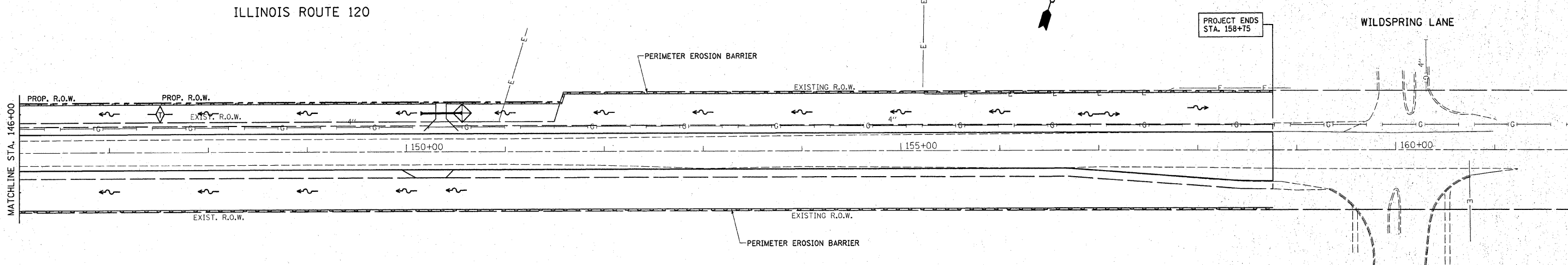

NOTES:

1. TEMPORARY EROSION CONTROL SEEDING TO BE PROVIDED AT ALL ERODIBLE BARE EARTH AREAS, REFER TO SPECIAL PROVISION.
2. NPDES PERMIT IS REQUIRED FOR THE PROJECT.
3. THE CONTRACTORS SHALL PROVIDE & MAINTAIN INLET PROTECTION AT ALL PROPOSED DRAINAGE STRUCTURES AND AT OTHER LOCATIONS DIRECTED BY THE ENGINEER AND/OR SHOWN ON THE PLANS. INLET PROTECTION SHALL BE PLACED IMMEDIATELY AFTER THE AREA INVOLVED HAS BEEN DISTURBED.
4. ALL EROSION CONTROL MEASURES SHALL BE IN ACCORDANCE WITH THE REQUIREMENTS OF THE STANDARD SPECIFICATION AND THE APPLICABLE STATE STANDARDS SPECIFICATION AND OF THE APPLICABLE STATE STANDARDS FOR THE ENTIRE DURATION OF THE CONTRACT OR UNTIL SUCH A TIME AS DIRECTED BY THE ENGINEER.
5. AT ANY AREA WHERE THERE IS NO PROPOSED GRADING, THE EXISTING GROUND COVER SHALL REMAIN.
6. "WETLANDS" SIGN SHALL BE ATTACHED TO THE PERIMETER EROSION BARRIER POST AT EACH WETLAND. SIGNS ARE AVAILABLE FROM THE ROADSIDE DEVELOPMENT UNIT.

LEGEND FOR EROSION CONTROL NOTES

- PERIMETER EROSION BARRIER
- DITCH CHECK @ EVERY 1' DROP IN DITCH ELEVATION
- SWALE
- DITCH
- INLET PROTECTION (COMBINATION OF DITCH CHECK, SILT FENCE TRAP BASIN, EROSION CONTROL BLANKET AND SEEDING)

NOTE: WETLAND SIGN



REVISIONS	
NAME	DATE

ILLINOIS DEPARTMENT OF TRANSPORTATION
**IL. ROUTE 120
 @ CEDAR LAKE RD.
 EROSION CONTROL PLAN**
 SCALE: VERT. 1"=50'
 HORIZ. 1"=50'
 DATE 1/23/2009
 DRAWN BY
 CHECKED BY

PLOT DATE = 1/23/2009
 FILE NAME = c:\pwworkspace\p124\124109-ehc-erocn-bl.dgn
 PLOT SCALE = 48,9999 / IN.
 USER NAME = mjdjg