

*REF-pmk01
*REF-pmk02

CONTRACT NO. 62514

F.A.P. RTE.	SECTION	COUNTY	TOTAL SHEETS	SHEET NO.
333	2002-101N	LAKE	75	39

STA.	TO STA.

FED. ROAD DIST. NO. ILLINOIS FED. AID PROJECT

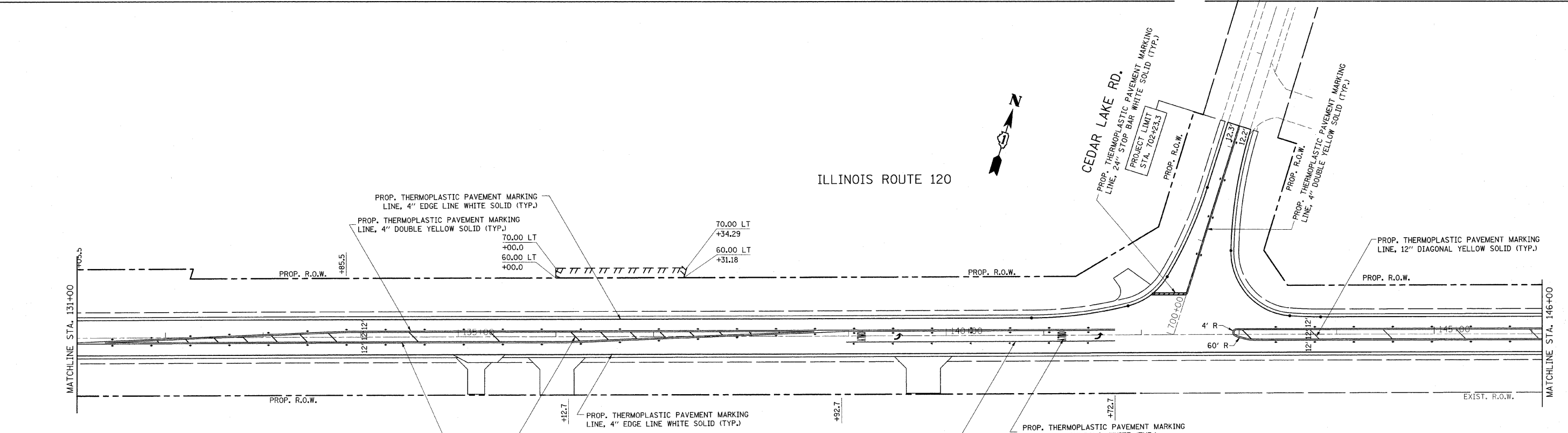
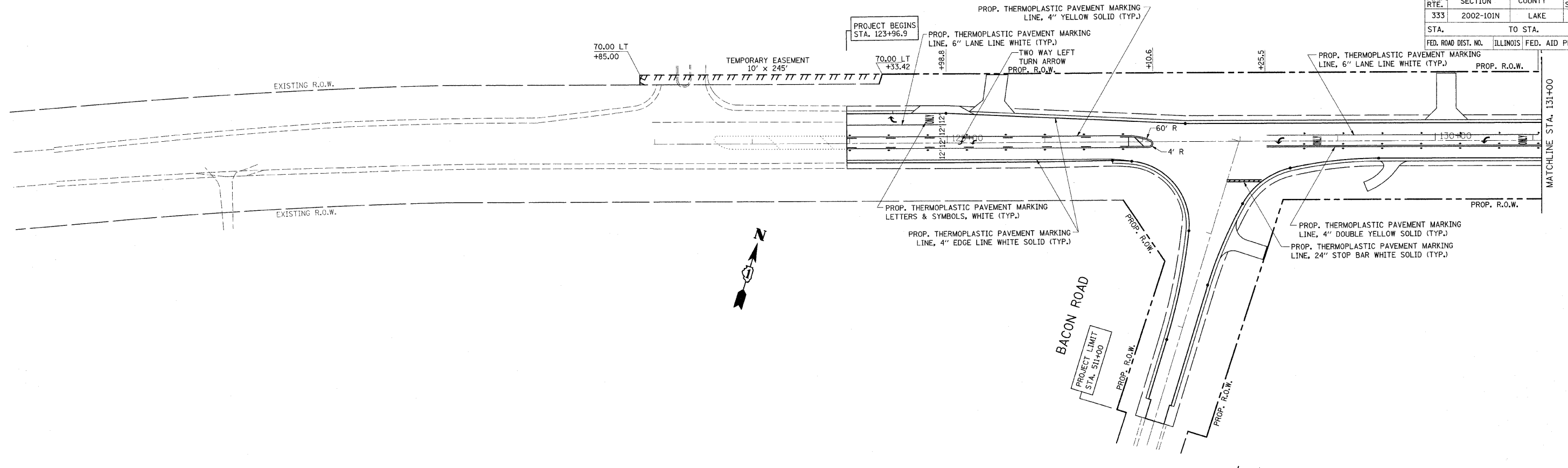

PLOT DATE = 12/17/2008
 FILE NAME = c:\pwworkspace\p1\10701\11\1111111111\1111111111.dgn
 PLOT SCALE = 1/8" = 1'-0"
 USER NAME = jlrchrd

NOTE:
RAISED REFLECTIVE PAVEMENT MARKERS ARE TO BE PLACED THROUGHOUT THE IMPROVEMENT LIMITS.

REVISIONS	
NAME	DATE

ILLINOIS DEPARTMENT OF TRANSPORTATION
**IL. ROUTE 120
@ CEDAR LAKE RD.
PAVEMENT MARKING PLAN**

SCALE: VERT. 1"=50'
HORIZ. 1"=50'
DATE 12/17/2008
DRAWN BY
CHECKED BY