

STAGE 1

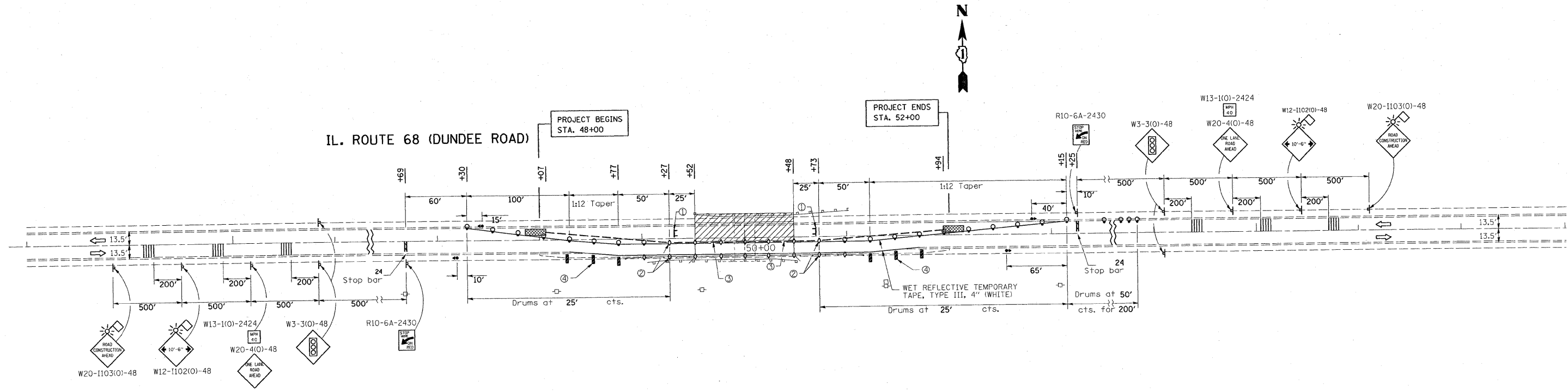

STAGE 2

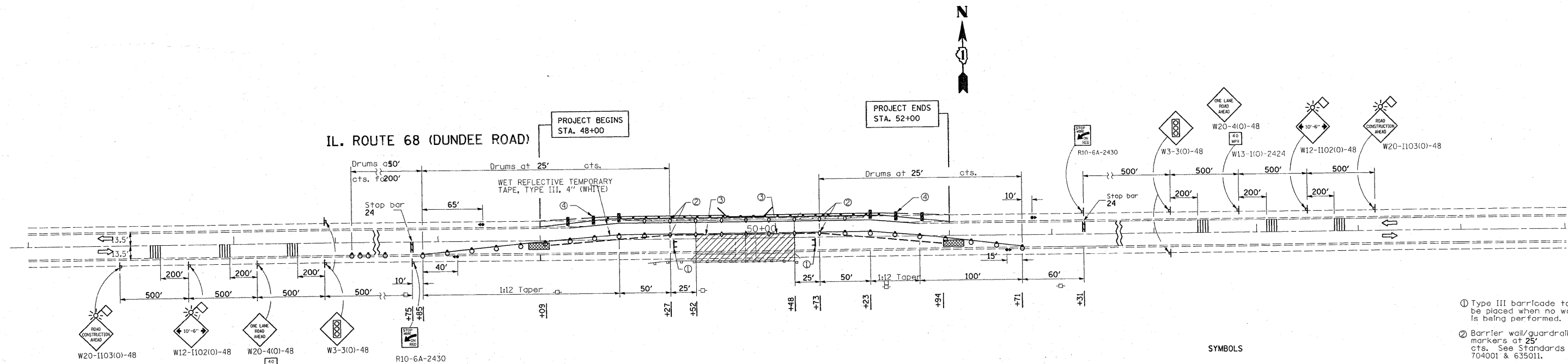

- SYMBOLS**
- Work area
 - Sign
 - Type III barricade
 - Traffic signal
 - Detector loops
 - Impact attenuator
 - Drum with steady burning light
 - Temporary concrete barrier
 - Temporary rumble strip (when specified)
 - Double vertical panel (see detail)
 - Crystal, bidirectional barrier wall/guardrail marker
- ① Type III barricade to be placed when no work is being performed.
 - ② Barrier wall/guardrail markers at 25' cts. See Standards 704001 & 635011.
 - ③ When temp. bridge rail is specified, it shall be connected to the temp. conc. barrier using a traffic barrier terminal Type II.
 - ④ These vertical panels at 25' cts. may be omitted when the guardrail, w/markers, extends to at least this point on the taper.

FILE NAME =	USER NAME = smthkl	DESIGNED -	REVISED -	STATE OF ILLINOIS DEPARTMENT OF TRANSPORTATION	TRAFFIC CONTROL AND PROTECTION - STAGE 1 AND 2 IL 68 OVER SPRING CREEK - S.N. 016-2811	F.A.P. RTE.	SECTION	COUNTY	TOTAL SHEETS	SHEET NO.	
ct:\pw_work\PWIDOT\SMITHKL\dms92925\design.aa.dgn	PLOT SCALE = 50,0000' / IN.	DRAWN -	REVISED -			343	631T	COOK	33	10	
PLOT DATE = 12/23/2008	DATE -	CHECKED -	REVISED -			CONTRACT NO. 62710					
		DATE -	REVISED -			SCALE:	SHEET NO. OF SHEETS	STA. TO STA.	FED. ROAD DIST. NO.	ILLINOIS FED. AID PROJECT	