

F.A.U. RTE.	SECTION	COUNTY	TOTAL SHEETS	SHEET NO.
08-00152-00-SW	COOK	9	7	
FED. ROAD DIST. NO.	ILLINOIS	FED. AID PROJECT		

CONTRACT NO: 63090

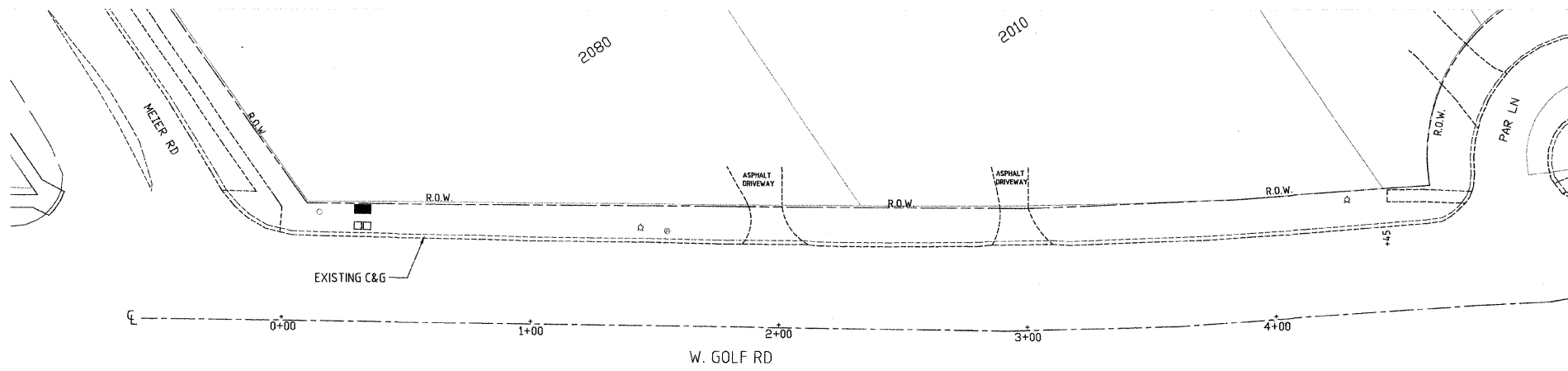

EXISTING GOLF RD SIDEWALK

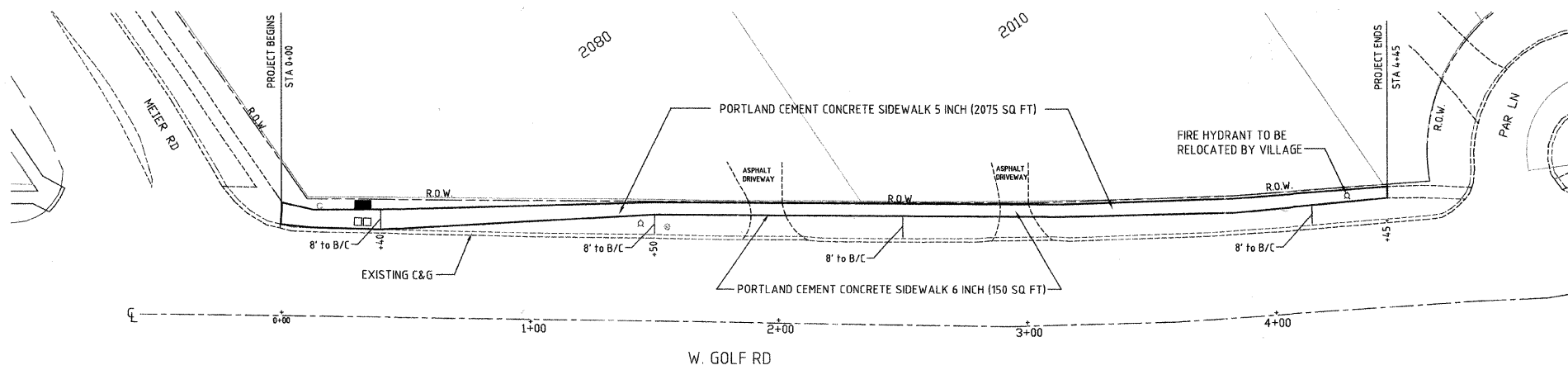

PROPOSED GOLF RD SIDEWALK

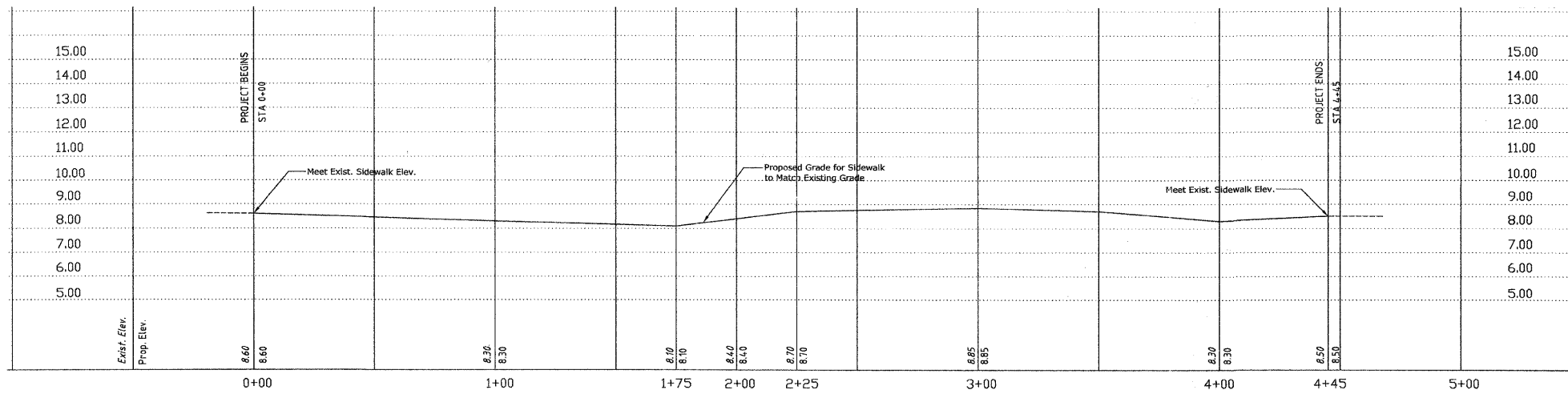

**Village of Mount Prospect**  
Public Works Department  
1700 W. Central Rd.

PLAN AND PROFILE  
GOLF RD SIDEWALK

STA 0+00 TO STA 4+45  
SCALE: VERTICAL: 1" = 3'  
HORIZONTAL: 1" = 30'