

F.A. RTE.	SECTION	COUNTY	TOTAL SHEETS	SHEET NO.
---	08-00067-00-RS	COOK	15	7
STA.	40+36.00	TO STA.	44+00.00	
FED. ROAD DIST. NO.	ILLINOIS	FED. AID PROJECT		

**CONTRACT NO. 63103**

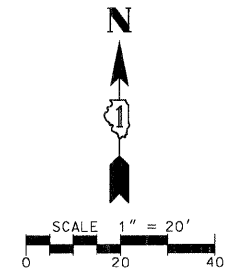

DATE	BY
SURVEYED	CHECKED
PLANNED	CHECKED
NOTE BOOK NO.	CADD FILE NAME

**CHRISTOPHER B. BURKE ENGINEERING LTD.**  
 9575 West Higgins Road, Suite 600  
 Rosemont, Illinois 60018  
 (847) 823-0500

DATE	BY
SURVEYED	CHECKED
PLANNED	CHECKED
NOTE BOOK NO.	STRUCTURE NOTATING CHRD

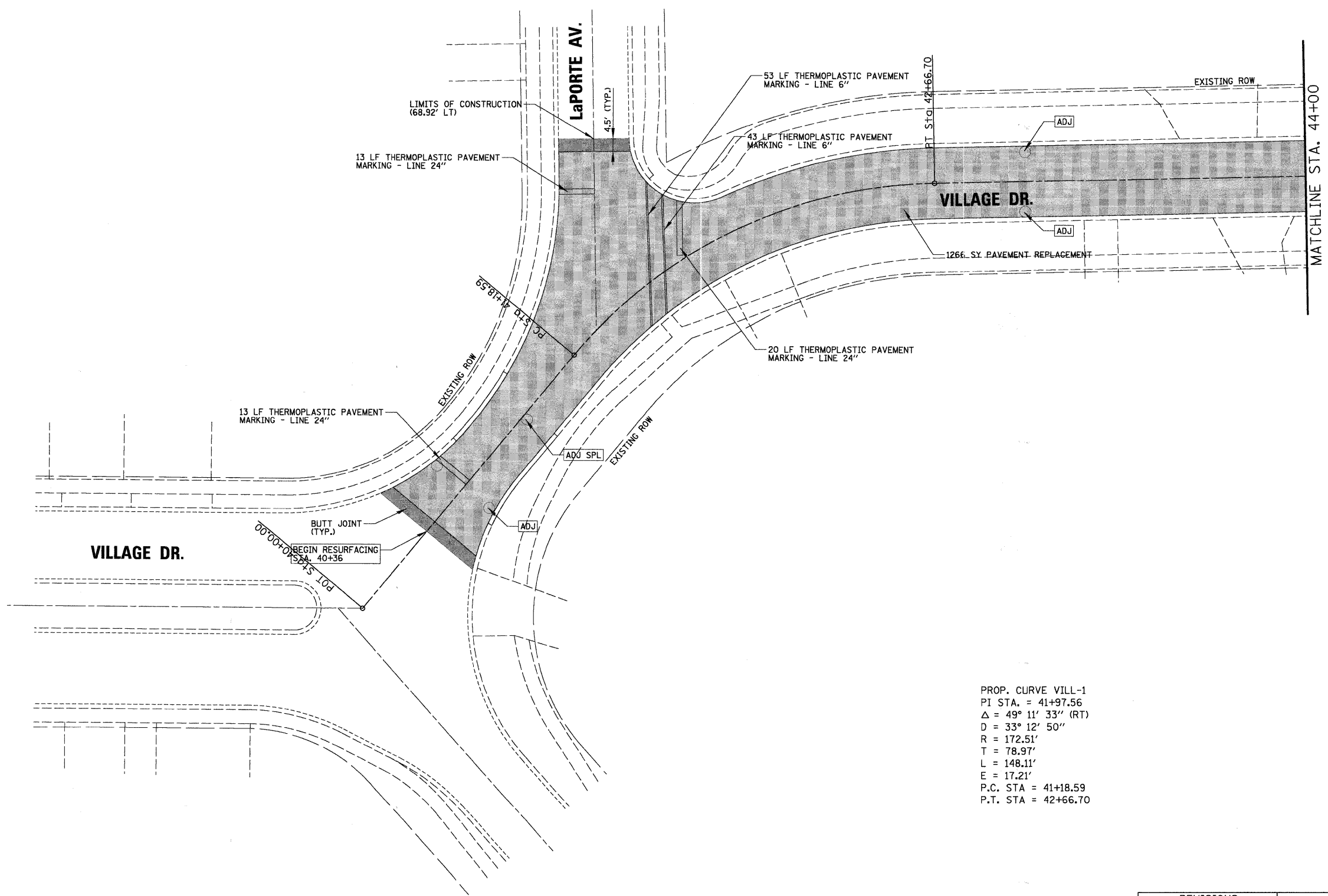

PROP. CURVE VILL-1  
 PI STA. = 41+97.56  
 $\Delta = 49^\circ 11' 33''$  (RT)  
 D = 33° 12' 50"  
 R = 172.51'  
 T = 78.97'  
 L = 148.11'  
 E = 17.21'  
 P.C. STA = 41+18.59  
 P.T. STA = 42+66.70

REVISIONS	
NAME	DATE

ILLINOIS DEPARTMENT OF TRANSPORTATION  
 PROPOSED PLAN  
 CITY OF NORTHLAKE  
 VILLAGE DRIVE  
 SCALE 1" = 20'  
 DATE 12/5/2008  
 DRAWN BY EDT  
 CHECKED BY MW