

- 10 FLUSH INLET BOX FOR MEDIAN,  
STANDARD 542546 (54244405)  
STA. 135+98/3.9' LT  
RIM- 685.61  
INV- 682.61
- 11 FLUSH INLET BOX FOR MEDIAN,  
STANDARD 542546 (54244405)  
STA.135+98/90.0' LT  
RIM- 684.92  
INV.- 681.92
- 11 REINFORCED CONCRETE  
END SECTIONS (MULTIPLE BARREL)  
STA. 135+28/209.2' RT  
CONCRETE STRUCTURES 3.4 CU YD  
(50300225)  
REINFORCEMENT BARS,  
EPOXY COATED 160 LBS (50800205)  
INV.- 658.14
- 12 PRECAST REINFORCED CONCRETE FLARED  
END SECTIONS 24" (30° SKEW) (54213669)  
STA. 136+59/215' LT  
INV.- 668.55
- 13 REINFORCED CONCRETE  
END SECTIONS 36" (30° SKEW)  
STA. 136+87/242.2' LT  
CONCRETE STRUCTURES 2.4 CU YD  
(50300225)  
REINFORCEMENT BARS,  
EPOXY COATED 130 LBS (50800205)  
INV.- 665.89
- 14 REINFORCED CONCRETE  
END SECTIONS 30" (40° SKEW)  
STA. 137+96/340' LT  
CONCRETE STRUCTURES 2.0 CU YD  
(50300225)  
REINFORCEMENT BARS,  
EPOXY COATED 130 LBS (50800205)  
INV.- 643.78
- 9 PIPE CULVERTS, CL. A,  
TY. 2 24" (542A1069)  
83' @ 0.84%  
TBF= 24 CY
- 18 PIPE CULVERTS, CL. A,  
TY. 2 24" (542A1069)  
135' @ 8.17%  
TBF= 58 CY
- 25 INSERTION CULVERT LINER 28"  
(54390200)  
147'

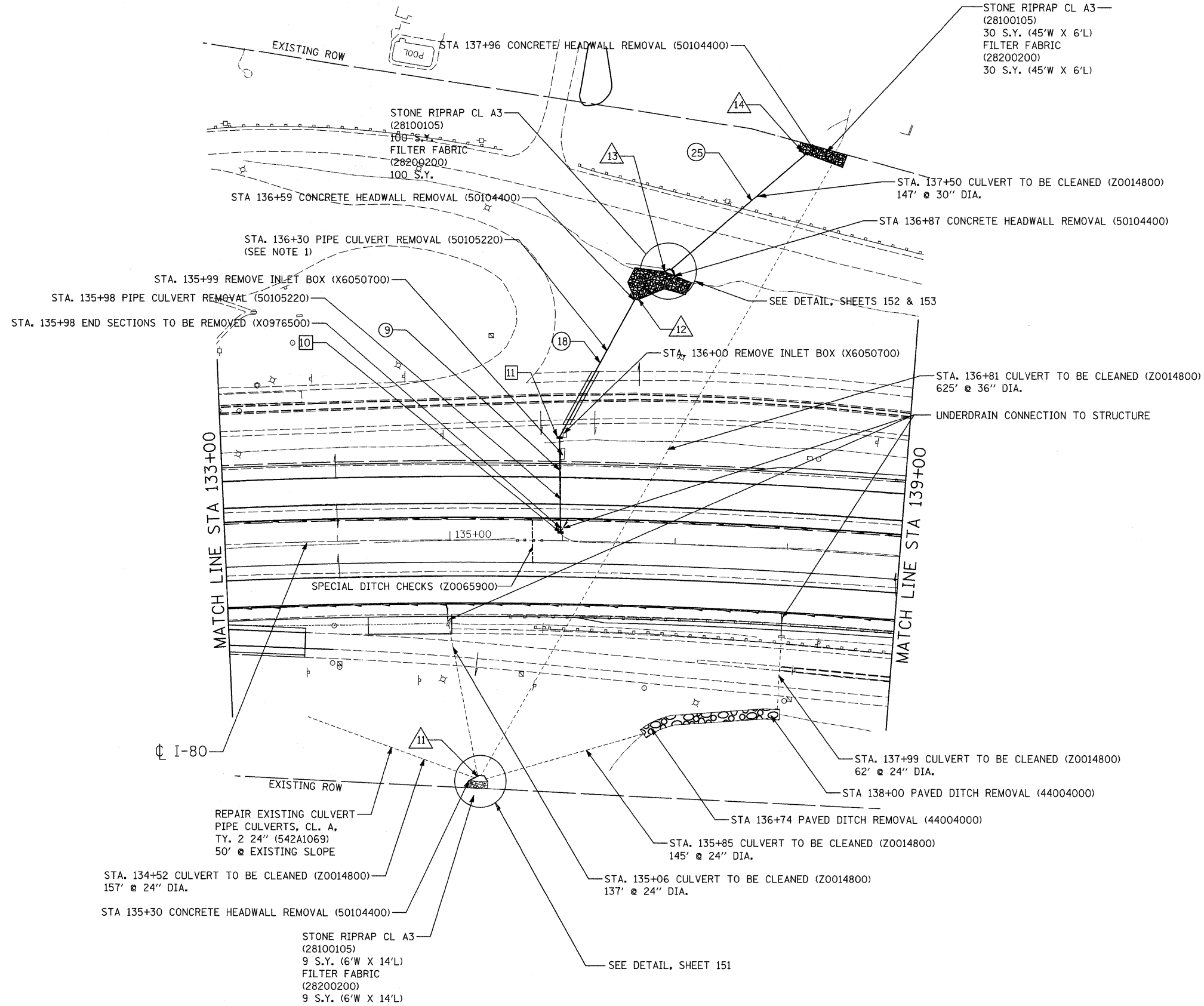

NOTE: REPAIR EXISTING CULVERT  
LOCATION AND EXTENT OF REPAIRS  
AT THE DISCRETION OF THE DISTRICT.

2 REVISED SHEET 2-23-09

FILE NAME = c:\p\work\p\drain\plan\mms34287\080403.dgn

<b>Ciorba Group, Inc.</b> CONSULTING ENGINEERS 5507 North Cumberland Avenue, Suite 402 Chicago, Illinois 60656 Tel. 773.775.4009 Fax 773.775.4014	USER NAME = grantpm	DESIGNED - AL	REVISED -	<b>STATE OF ILLINOIS</b> <b>DEPARTMENT OF TRANSPORTATION</b>	<b>I-80</b> <b>PROPOSED DRAINAGE PLAN</b> <b>STA. 133+00 TO STA. 139+00</b>	F.A.I. RTE. 80	SECTION (61-1R-1)	COUNTY ROCK ISLAND	TOTAL SHEETS 292	SHEET NO. 146
	PLOT SCALE = 50.0000' / IN.	DRAWN - EPS	REVISED -			SCALE: 1" = 50'	SHEET NO. OF SHEETS	STA. TO STA.	FED. ROAD DIST. NO.	ILLINOIS FED. AID PROJECT
	PLOT DATE = Wed Feb 11 14:57:57	CHECKED - DMM	REVISED -							
		DATE = Wed Feb 11 14:57:57	REVISED 09 -							