

- 10 FLUSH INLET BOX FOR MEDIAN,  
STANDARD 542546 (54244405)  
STA. 135+98/3.9' LT  
RIM- 685.61  
INV- 682.61
- 11 CB, TA, 4'-DIA.  
TIF, OL (60200105)  
STA.135+98/90.0' LT  
RIM- 684.92  
INV.- 681.92
- 11 REINFORCED CONCRETE  
END SECTIONS (MULTIPLE BARREL)  
STA. 135+28/209.2' RT  
CONCRETE STRUCTURES 3.4 CU YD  
(50300225)  
REINFORCEMENT BARS,  
EPOXY COATED 160 LBS (50800205)  
INV.- 658.14
- 12 REINFORCED CONCRETE  
END SECTIONS 24" (30° SKEW)  
STA. 136+59/215' LT  
CONCRETE STRUCTURES 1.8 CU YD  
(50300225)  
REINFORCEMENT BARS,  
EPOXY COATED 105 LBS (50800205)  
INV.- 668.55
- 13 REINFORCED CONCRETE  
END SECTIONS 36" (30° SKEW)  
STA. 136+87/242.2' LT  
CONCRETE STRUCTURES 2.4 CU YD  
(50300225)  
REINFORCEMENT BARS,  
EPOXY COATED 130 LBS (50800205)  
INV.- 665.89
- 14 REINFORCED CONCRETE  
END SECTIONS 36" (40° SKEW)  
STA. 137+96/350' LT  
CONCRETE STRUCTURES 3.0 CU YD  
(50300225)  
REINFORCEMENT BARS,  
EPOXY COATED 180 LBS (50800205)  
INV.- 643.78
- 9 PIPE CULVERTS, CL. A,  
TY. 2 24" (542A1069)  
82' @ 0.84%  
TBF= 24 CY
- 18 PIPE CULVERTS, CL. A,  
TY. 2 24" (542A1069)  
139' @ 9.65%  
TBF= 57 CY
- 25 INSERTION CULVERT LINER 32"  
(54390220)  
157'

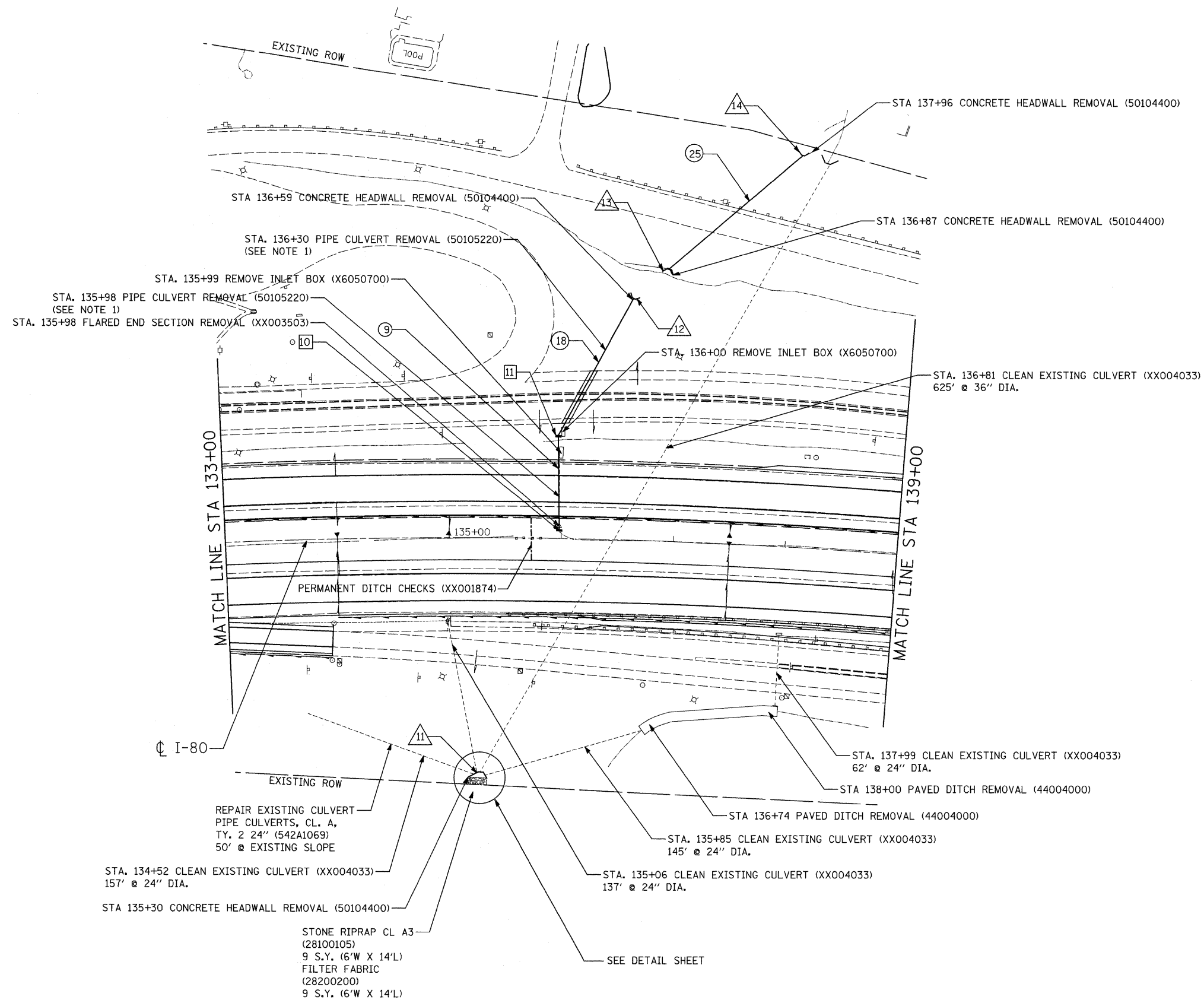

NOTE: REPAIR EXISTING CULVERT  
LOCATION AND EXTENT OF REPAIRS  
AT THE DISCRETION OF THE DISTRICT.

FILE NAME = c:\pwworkspace\projects\grant\p1\m1\133+00.dwg

	<b>Ciorba Group, Inc.</b> CONSULTING ENGINEERS 5507 North Cumberland Avenue, Suite 402 Chicago, Illinois 60656 Tel. 773.775.4009 Fax 773.775.4014	USER NAME = grantpm PLOT SCALE = 50.0000' / IN. PLOT DATE = Mon Dec 15 08:36:34	DESIGNED - AL DRAWN - EPS CHECKED - DMM DATE - Mon Dec 15 08:36:34	REVISED - REVISED - REVISED - REVISED -	<b>STATE OF ILLINOIS DEPARTMENT OF TRANSPORTATION</b>	<b>I-80 PROPOSED DRAINAGE PLAN STA. 133+00 TO STA. 139+00</b>	SCALE: 1" = 50' SHEET NO. OF SHEETS STA. TO STA.	F.A.I. RTE. 80 SECTION (81-1R-1) COUNTY ROCK ISLAND TOTAL SHEETS 292 SHEET NO. 146 CONTRACT NO. 64933	FED. ROAD DIST. NO. ILLINOIS FED. AID PROJECT
--	---	---	---	--	---	---	---	--	---