

**LEGEND**

	EXISTING ELECTRIC CABLE
	FIBER OPTIC
	LIGHTING
	PROPOSED 3-1C No. 6, 1" UNIT DUCT
	PROPOSED CONDUIT INTERMEDIATE METAL
	PROPOSED LIGHT/LIGHTPOLE FOUNDATION

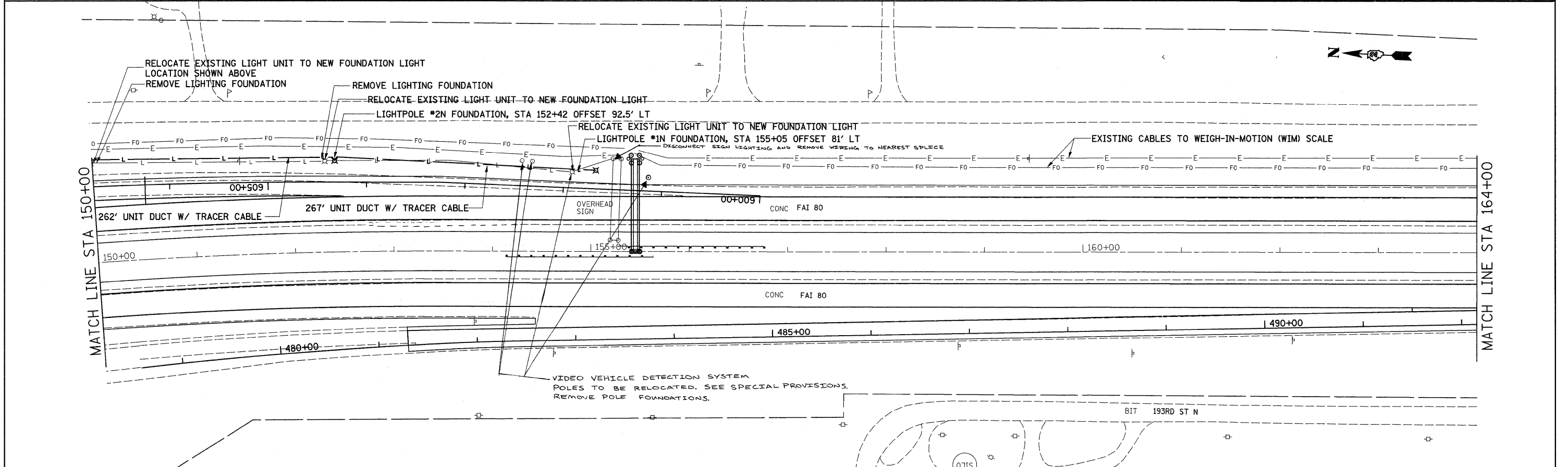

FILE NAME =	USER NAME = grantpm	DESIGNED -	REVISED -	<b>STATE OF ILLINOIS DEPARTMENT OF TRANSPORTATION</b>	<b>I-80 ELECTRICAL DETAILS</b>			F.A.I. RTE.	SECTION	COUNTY	TOTAL SHEETS	SHEET NO.
c:\pwork\pwork\grantpm\dms34287\d08403e1ec.dgn		DRAWN -	REVISED -					80	(81-1)R-1	ROCK ISLAND	292	163
PLOT SCALE = 50.0000' / IN.		CHECKED -	REVISED -					CONTRACT NO. 64933				
PLOT DATE = Mon Dec 15 08:32:25 2008		DATE -	REVISED -					SCALE:	SHEET NO.	OF SHEETS	STA.	TO STA.