

DATE	
BY	
REVISIONS	
PLAN	
NO.	
NOTE BOOK	
NO.	
ALIGNMENT CHECKED	
PLOTTED	
CADD FILE NAME	

DATE	
BY	
REVISIONS	
PROFILE	
NO.	
NOTE BOOK	
NO.	
GRADES CHECKED	
STRUCTURE NOTATIONS CHKD	

MATCHLINE STA. 2519+50

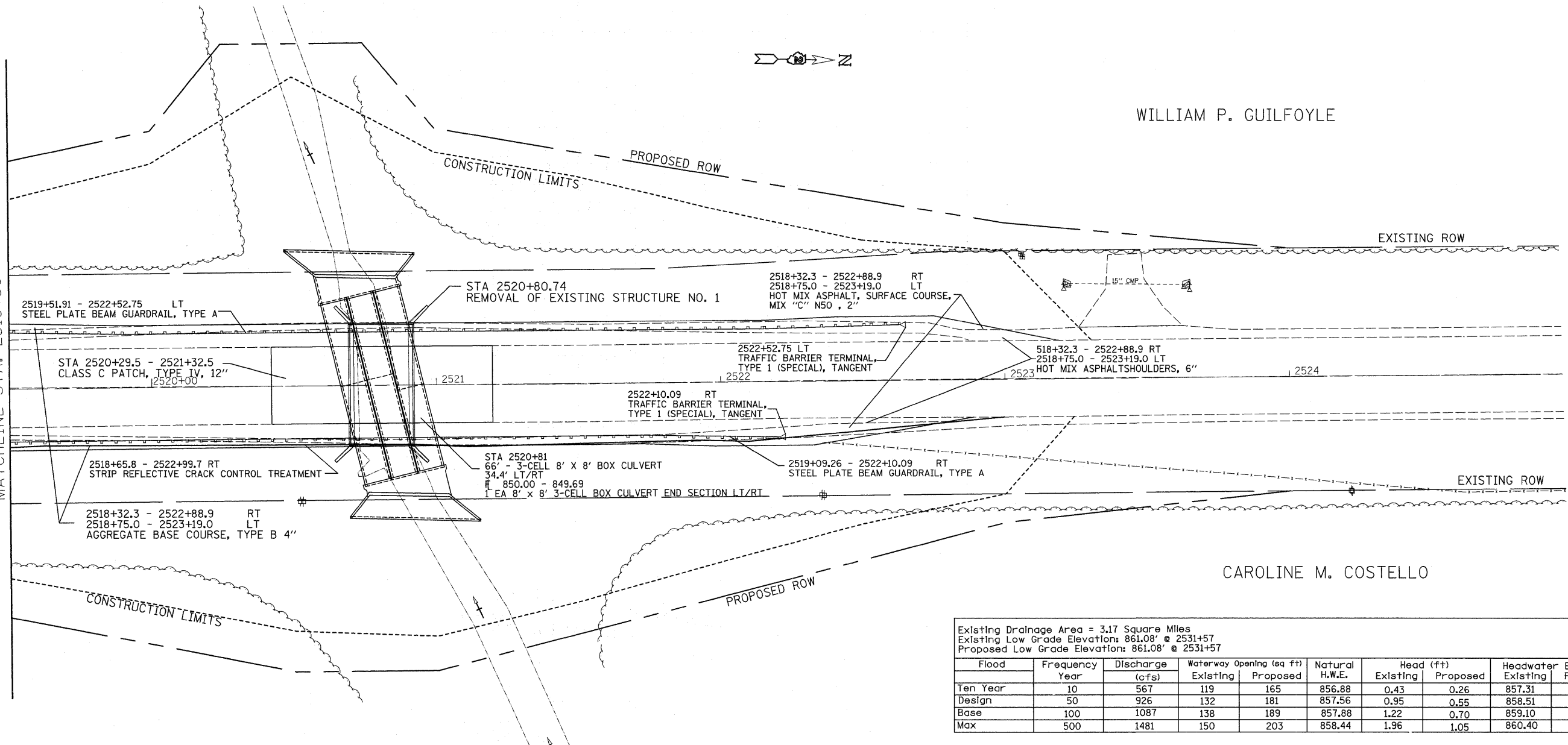

WILLIAM P. GUILFOYLE

CAROLINE M. COSTELLO

Existing Drainage Area = 3.17 Square Miles
 Existing Low Grade Elevation: 861.08' @ 2531+57
 Proposed Low Grade Elevation: 861.08' @ 2531+57

Flood Year	Discharge (cfs)	Waterway Opening (sq ft)		Natural H.W.E.	Head (ft)		Headwater Existing	Elev. (ft) Proposed
		Existing	Proposed		Existing	Proposed		
Ten Year	567	119	165	856.88	0.43	0.26	857.31	857.14
Design	926	132	181	857.56	0.95	0.55	858.51	858.11
Base	1087	138	189	857.88	1.22	0.70	859.10	858.58
Max	1481	150	203	858.44	1.96	1.05	860.40	859.49

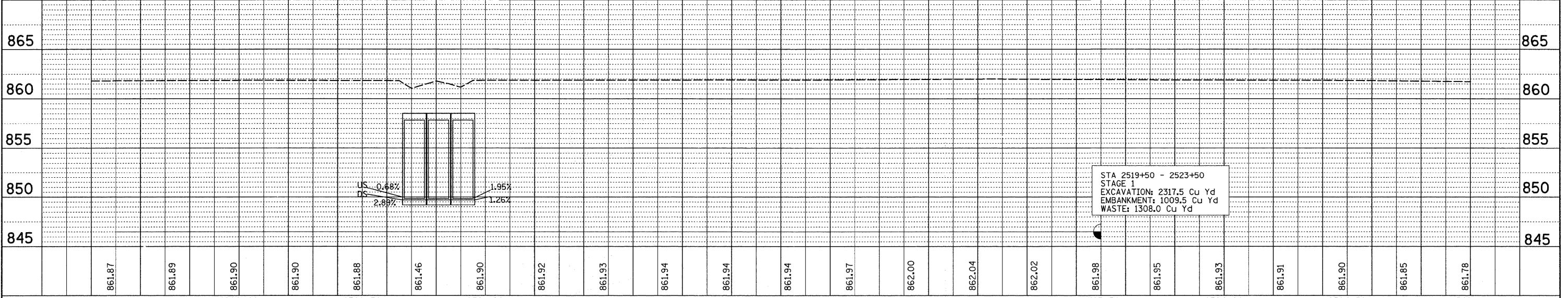

FILE NAME =	USER NAME = fordjd	DESIGNED -	REVISED -	STATE OF ILLINOIS DEPARTMENT OF TRANSPORTATION	REVISIONS	SCALE: SHEET NO. OF SHEETS STA. TO STA.	F.A.S. RTE. 1177	SECTION 111T	COUNTY LASALLE	TOTAL SHEETS 59	SHEET NO. 27
CONTRACT NO. 64A07	DATE = Feb 20 12:05:04 2009	DRAWN -	REVISED -								
		CHECKED -	REVISED -								
		DATE =	REVISED -								