

F.A.P. RTE.	SECTION	COUNTY	TOTAL SHEETS	SHEET NO.
*	**	LA SALLE	48	17
STA.		TO STA.		
FED. ROAD DIST. NO. ILLINOIS FED. AID PROJECT				
* FAP 68 & 68 ALT (IL 23 NB & SB)				
** (35, 51 & 48 CS, 12)TS				

CONTROLLER SEQUENCE

NAME OF INTERSECTION: LA SALLE STREET AND JEFFERSON STREET
 CONTROLLER SPECIFIED: FULL-ACTUATED CONTROLLER, STANDARD SEQUENCE 11, 8 PHASE, IN TYPE IV CABINET
 REFERRING TO STANDARD 857001, THE VEHICULAR AND PEDESTRIAN PHASES USED ARE DESIGNATED.

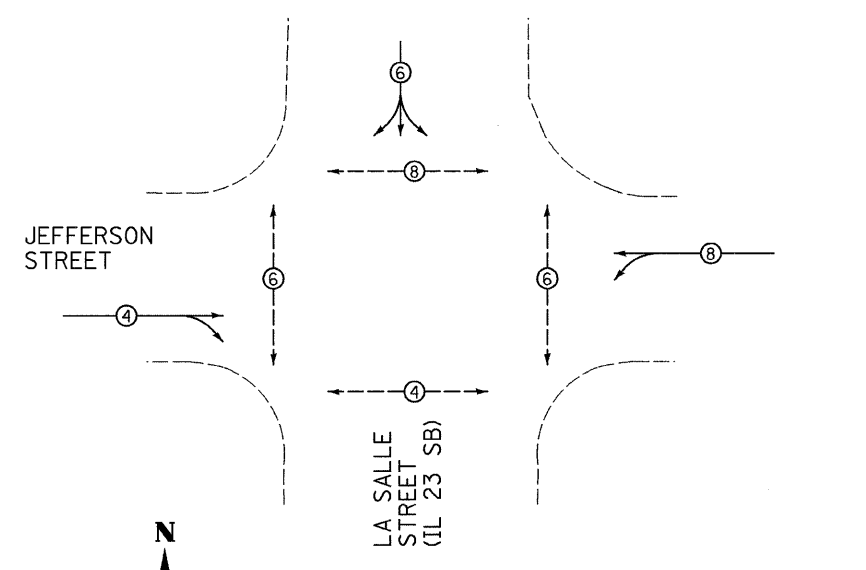

PROPOSED PLAN
NOT TO SCALE

LEGEND

- ← ○ → VEHICULAR MOVEMENT
- ← ○ → PEDESTRIAN MOVEMENT
- * NUMBER REFERS TO ASSOCIATED PHASE

TRAFFIC SIGNALS LEGEND

	DETNOTES NUMBER OF CONDUCTORS (NEW) ALL CABLE NO. 14 EXCEPT AS INDICATED
	PROPOSED SERVICE INSTALLATION, TYPE B
	PROPOSED CONTROLLER AND CABINET
	EMERGENCY VEHICLE LIGHT DETECTOR
	EMERGENCY VEHICLE CONFIRMATION BEACON
	SIGNAL SECTION 12"
	PROPOSED INTERCONNECT CABLE
	PROPOSED WALK/DONT WALK COUNTDOWN SECTION
	TRAFFIC SIGNAL BACKPLATE
	GROUND CABLE IN CONDUIT, NO. 6 SOLID COPPER (GREEN)
	GROUND ROD AT POST (P) OR MAST ARM (MA) OR CONTROLLER (C) OR SERVICE INSTALLATION (S) OR HANDHOLE (H)

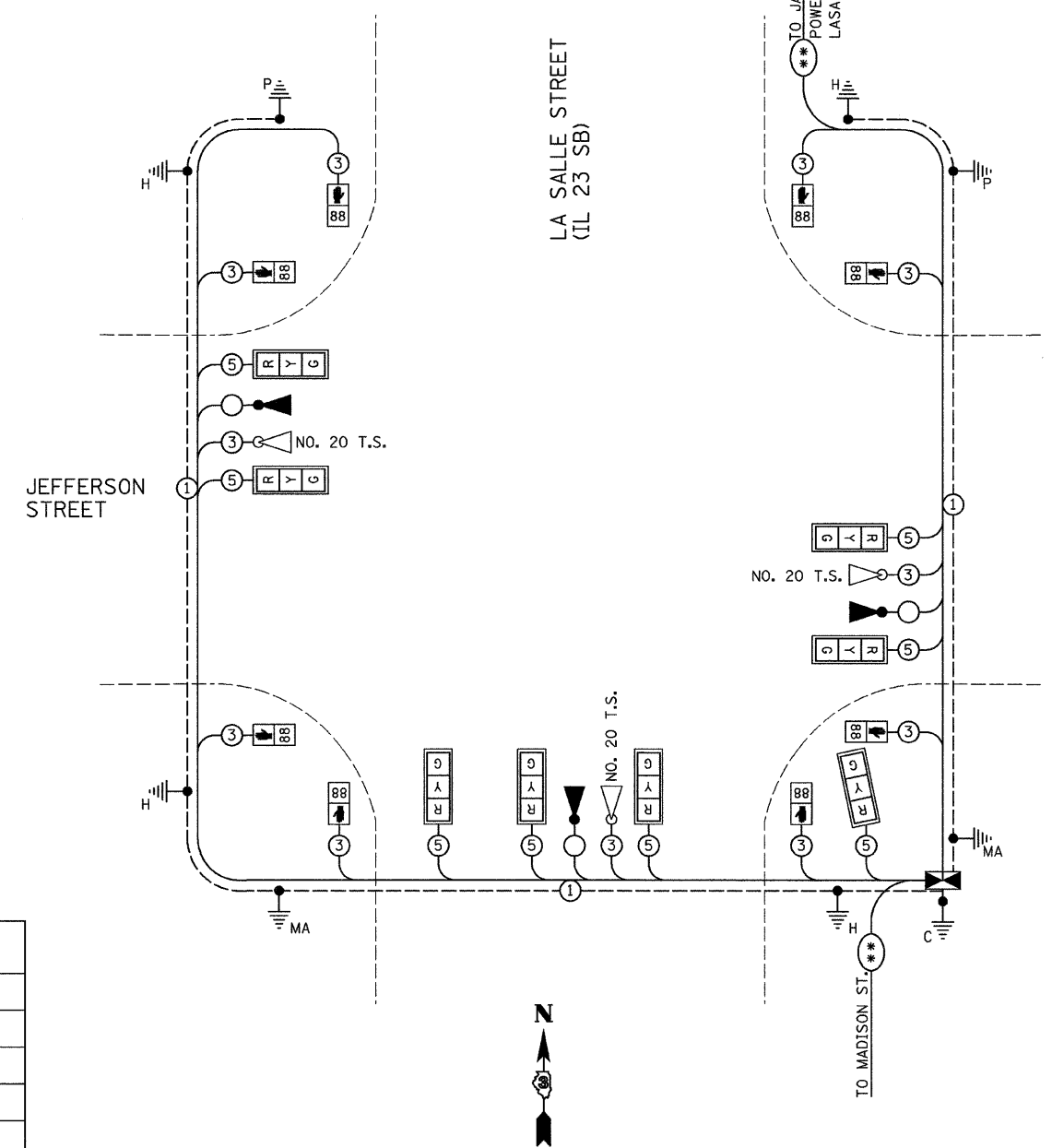

PROPOSED CABLE PLAN
NOT TO SCALE

REVISIONS	
NAME	DATE

ILLINOIS DEPARTMENT OF TRANSPORTATION
CABLE PLAN
 FAP 68 ALT (IL 23 SB)/LA SALLE ST
 AND JEFFERSON STREET
 SECTION 35.51 & 48 CS, 12)TS
 LA SALLE COUNTY

SCALE: VERT. DRAWN BY ARR
 HORIZ. CHECKED BY JLS
 DATE 11/08

PLOT DATE = 11/08
 FILE NAME = D:\66769\99-SHT-CABLE-LASA-JEFF.DGN
 PLOT SCALE = 1" = 20'
 USER NAME = ARR