

F.A.P. RTE.	SECTION	COUNTY	TOTAL SHEETS	SHEET NO.
*	**	LA SALLE	48	46
STA.		TO STA.		
FED. ROAD DIST. NO. _		ILLINOIS FED. AID PROJECT		
* FAP 68 & 68 ALT (IL 23 NB & SB)				
** (35, 51 & 48 CS, 1Z)TS				

CONSTRUCTION NOTES:

1. THE MASTER CONTROLLER SHALL BE LOCATED AT THE INTERSECTION OF LASALLE STREET AND LAFAYETTE STREET.
2. THE CONTRACTOR SHALL REMOVE THE EXISTING INTERCONNECT CABLE AND REPLACE WITH FIBER OPTIC CABLE AS SPECIFIED.
3. NEW AND EXISTING HANDHOLES SHALL BE USED AS SHOWN.
4. SEE SHEETS 47 AND 48 FOR REMAINING INTERCONNECT DETAILS AND QUANTITIES.

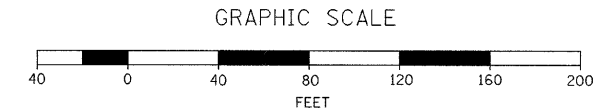

SCHEDULE OF QUANTITIES

ITEM NO.	DESCRIPTION	UNIT	TOTAL QUANTITY
81012600	CONDUIT IN TRENCH, 2" DIA., PVC	FOOT	438
81021330	CONDUIT PUSHED, 2" DIA., PVC	FOOT	894
81400700	HANDHOLE, PORTLAND CEMENT CONCRETE	EACH	1
81900200	TRENCH AND BACKFILL FOR ELECTRICAL WORK	FOOT	438
87100160	FIBER OPTIC CABLE IN CONDUIT 62.5/125 24F	FOOT	2210
87900200	DRILL EXISTING HANDHOLE	EACH	4
89502300	REMOVE ELECTRIC CABLE FROM CONDUIT	FOOT	1439
X0322925	ELECTRIC CABLE IN CONDUIT, TRACER, NO. 14 1C	FOOT	2210
XX006668	HANDHOLE TO BE ADJUSTED WITH NEW FRAME AND COVER	EACH	2

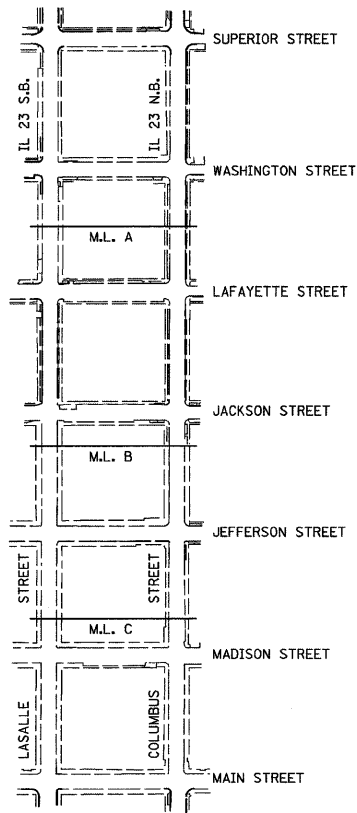

OVERALL PLAN

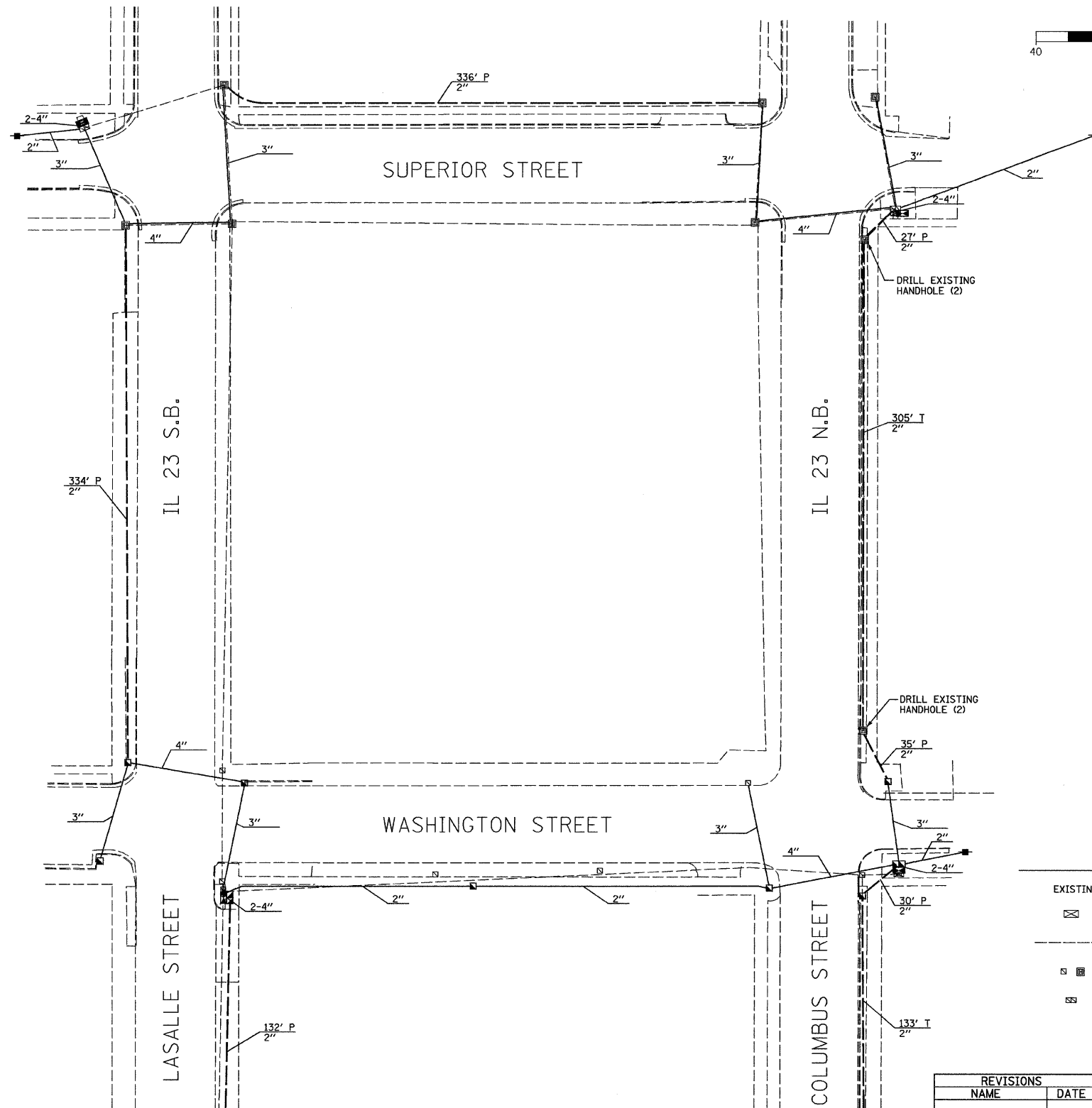

MATCH LINE A

NOTE:
SEE INTERSECTION PLAN SHEETS FOR CONDUIT LENGTHS AND DESCRIPTIONS NOT SHOWN.

TRAFFIC SIGNALS LEGEND

EXISTING	PROPOSED	
		CONTROLLER CABINET
		CONDUIT
		HANDHOLE
		DOUBLE HANDHOLE

REVISIONS	
NAME	DATE

ILLINOIS DEPARTMENT OF TRANSPORTATION
TRAFFIC SIGNAL
INTERCONNECT PLAN
FAP 68 & 68 ALT (IL 23 NB & SB)
SECTION (35, 51 & 48 CS, 1Z)TS
LA SALLE COUNTY

SCALE: VERT. 1" = 40'
HORIZ. 1" = 40'
DATE 11/08

DRAWN BY ARR
CHECKED BY JLS