

F.A.P. RTE.	SECTION	COUNTY	TOTAL SHEETS	SHEET NO.
*	**	LA SALLE	48	47
STA.		TO STA.		
FED. ROAD DIST. NO. _		ILLINOIS FED. AID PROJECT		
* FAP 68 & 68 ALT (IL 23 NB & SB) ** (35, 51 & 48 CS, 12)TS				

**CONSTRUCTION NOTES:**

1. THE MASTER CONTROLLER SHALL BE LOCATED AT THE INTERSECTION OF LASALLE STREET AND LAFAYETTE STREET.
2. THE CONTRACTOR SHALL REMOVE THE EXISTING INTERCONNECT CABLE AND REPLACE WITH FIBER OPTIC CABLE AS SPECIFIED.
3. NEW AND EXISTING HANDHOLES SHALL BE USED AS SHOWN.
4. SEE SHEETS 46 AND 48 FOR REMAINING INTERCONNECT DETAILS AND QUANTITIES.

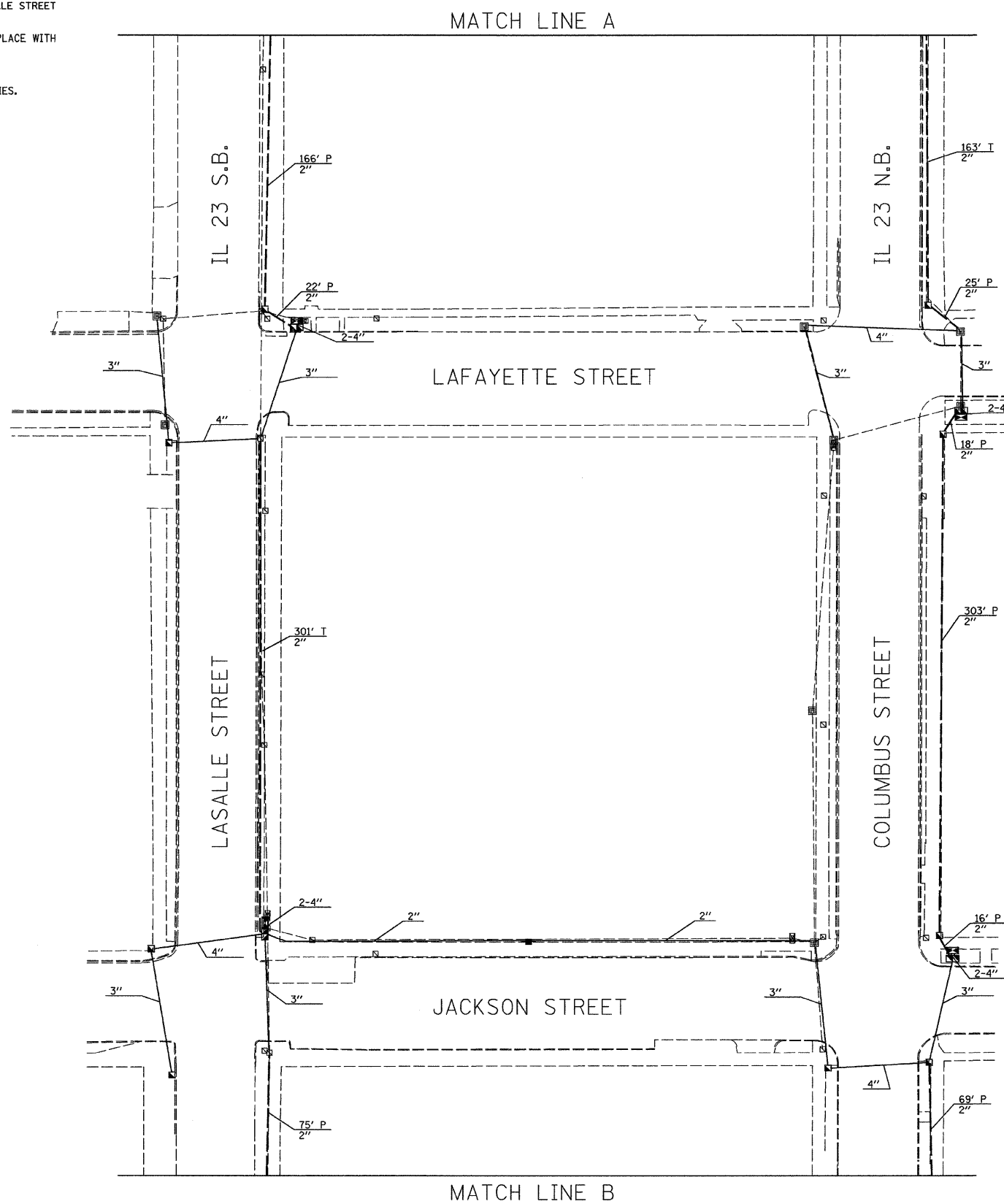
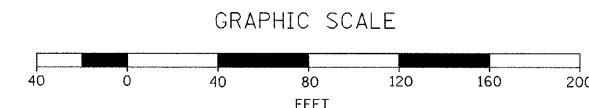

NOTE:  
SEE INTERSECTION PLAN SHEETS FOR CONDUIT LENGTHS  
AND DESCRIPTIONS NOT SHOWN.

**SCHEDULE OF QUANTITIES**

ITEM NO.	DESCRIPTION	UNIT	TOTAL QUANTITY
81012600	CONDUIT IN TRENCH, 2" DIA., PVC	FOOT	464
81021330	CONDUIT PUSHED, 2" DIA., PVC	FOOT	694
81400700	HANDHOLE, PORTLAND CEMENT CONCRETE	EACH	4
81900200	TRENCH AND BACKFILL FOR ELECTRICAL WORK	FOOT	464
87100160	FIBER OPTIC CABLE IN CONDUIT 62.5/125 24F	FOOT	1634
89502300	REMOVE ELECTRIC CABLE FROM CONDUIT	FOOT	1638.5
X0322925	ELECTRIC CABLE IN CONDUIT, TRACER, NO. 14 1C	FOOT	1634

**TRAFFIC SIGNALS LEGEND**

EXISTING	PROPOSED	
		CONTROLLER CABINET
		CONDUIT
		HANDHOLE
		DOUBLE HANDHOLE

REVISIONS	
NAME	DATE

ILLINOIS DEPARTMENT OF TRANSPORTATION  
 TRAFFIC SIGNAL  
 INTERCONNECT PLAN  
 FAP 68 & 68 ALT (IL 23 NB & SB)  
 SECTION (35, 51 & 48 CS, 12)TS  
 LA SALLE COUNTY

SCALE: VERT. 1" = 40'  
 HORIZ. 1" = 40'  
 DATE 11/08  
 DRAWN BY ARR  
 CHECKED BY JLS