

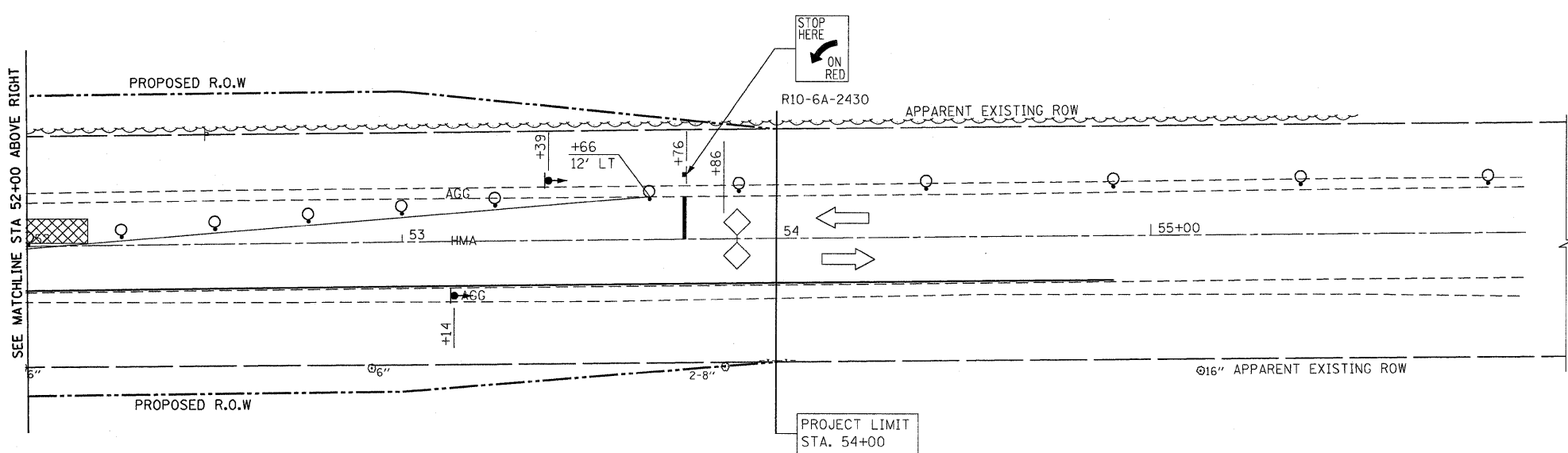

PLAN	SURVEYED	DATE
	PLOTTED	
	CHECKED	
	BY	
	NO.	
	FILE NAME	

PROFILE	SURVEYED	DATE
	PLOTTED	
	CHECKED	
	BY	
	NO.	
	STRUCTURE	
	NOTATION	

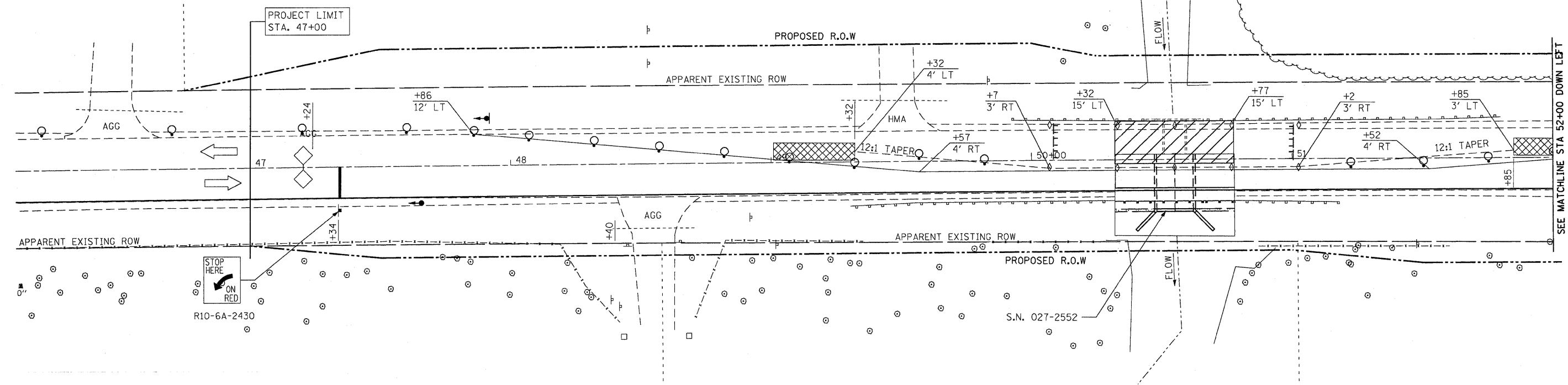

**LEGEND:**

- HOT-MIX ASPHALT SHOULDERS, 8"
- DRUM WITH STEADY BURN LIGHT
- TRAFFIC SIGNALS WITH BACKPLATE
- MICROWAVE DETECTOR
- SIGN
- TYPE III BARRICADE WITH FLASHING LIGHTS
- TYPE "C" BIDIRECTIONAL REFLECTOR
- DOUBLE VERTICAL PANEL (SEE DETAIL)
- TEMPORARY CONCRETE BARRIER
- IMPACT ATTENUATORS, TEMPORARY (NON-REDIRECTIVE) TEST LEVEL 3
- WORK AREA

**NOTES:**

1. SEE STANDARD 701321 FOR DETAILS.
2. SEE STRUCTURAL SHEETS FOR STAGING PLAN.
3. THE ENTRANCE AT STATION 49+49 TO BE RELOCATED PRIOR TO SWITCHING TO STAGE II TRAFFIC CONTROL.

2 REVISED SHEET 2/19/09

**STATE OF ILLINOIS  
DEPARTMENT OF TRANSPORTATION**

**STAGE II TRAFFIC CONTROL**

FILE NAME =	USER NAME = carpenterdj	DESIGNED DB	REVISED -	SCALE: 1"=20'	SHEET NO. 2 OF 2 SHEETS	STA. 46+10 TO STA. 54+90	F.A.P. RTE.	SECTION	COUNTY	TOTAL SHEETS	SHEET NO.
c:\pw_work\PW\IDOT\CARPENTERDJ\dms77953\027-2552-12MOT-stage2.dgn	DRAWN NS/RM	REVISED -	697				(17)I	FORD	29	12	
PLOT SCALE = 28.0000' / IN.	CHECKED AS	REVISED -	CONTRACT NO. 66874								
PLOT DATE = Feb 17, 2009 - 01:47:25 PM	DATE DECEMBER 2008	REVISED -	ILLINOIS FED. AID PROJECT								