

STATE OF ILLINOIS
DEPARTMENT OF TRANSPORTATION

ELEVATION TABLE

Location	Elev. A	Elev. B	Elev. C	Elev. D
W. Abut.	750.23	749.80	749.94	±748.56
E. Abut.	750.67	750.26	750.37	±748.99

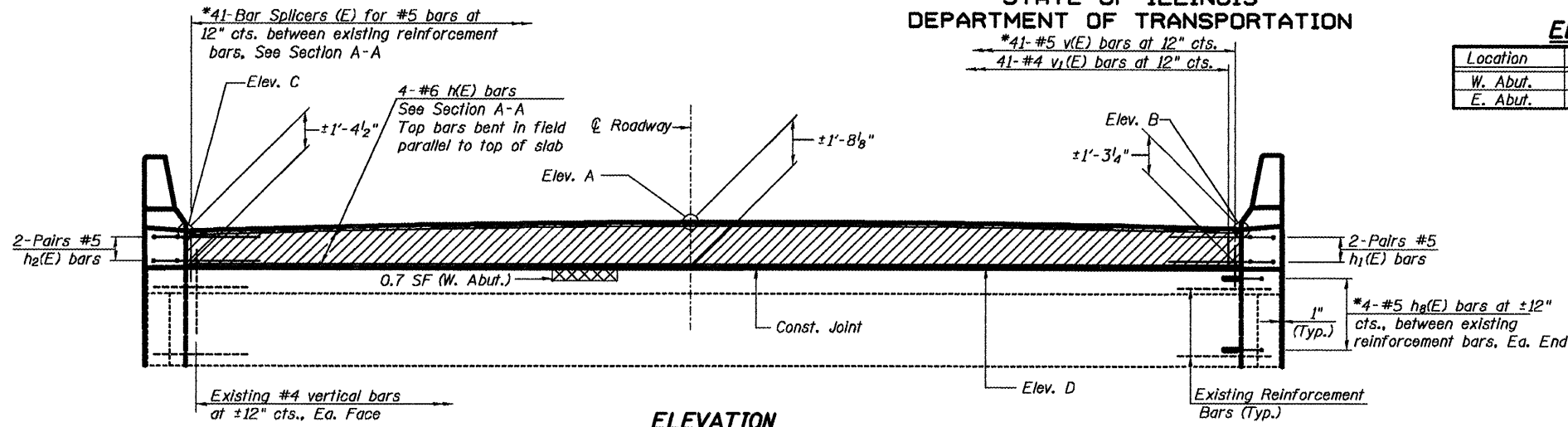

ELEVATION

E. Abut. (Looking East)
W. Abut. (Looking West)

*Epoxy Grout v(E) and h_g(E) bars and Bar Splicers min. 9" deep in field drilled holes in accordance with Section 584 of the Standard Specifications.

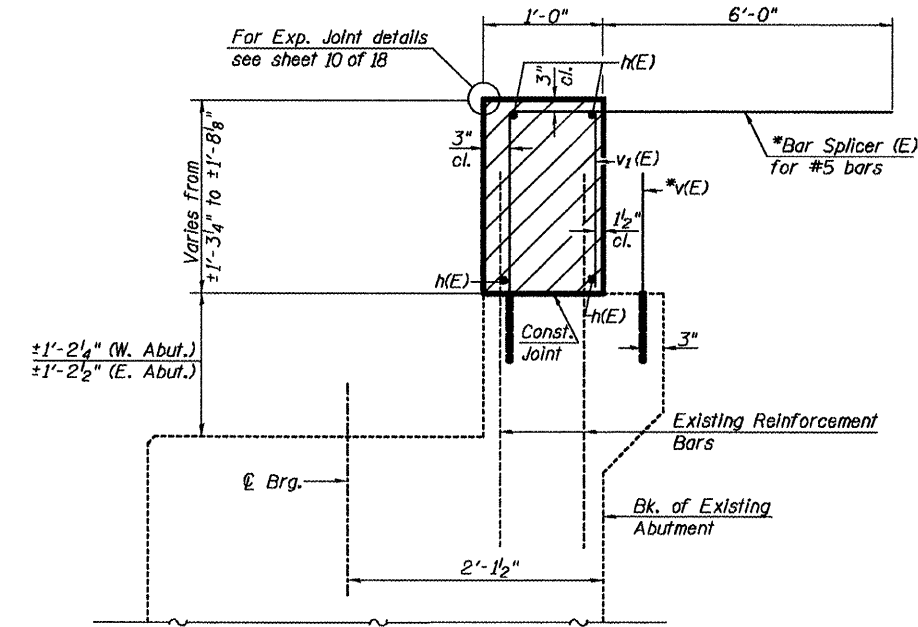

SECTION A-A

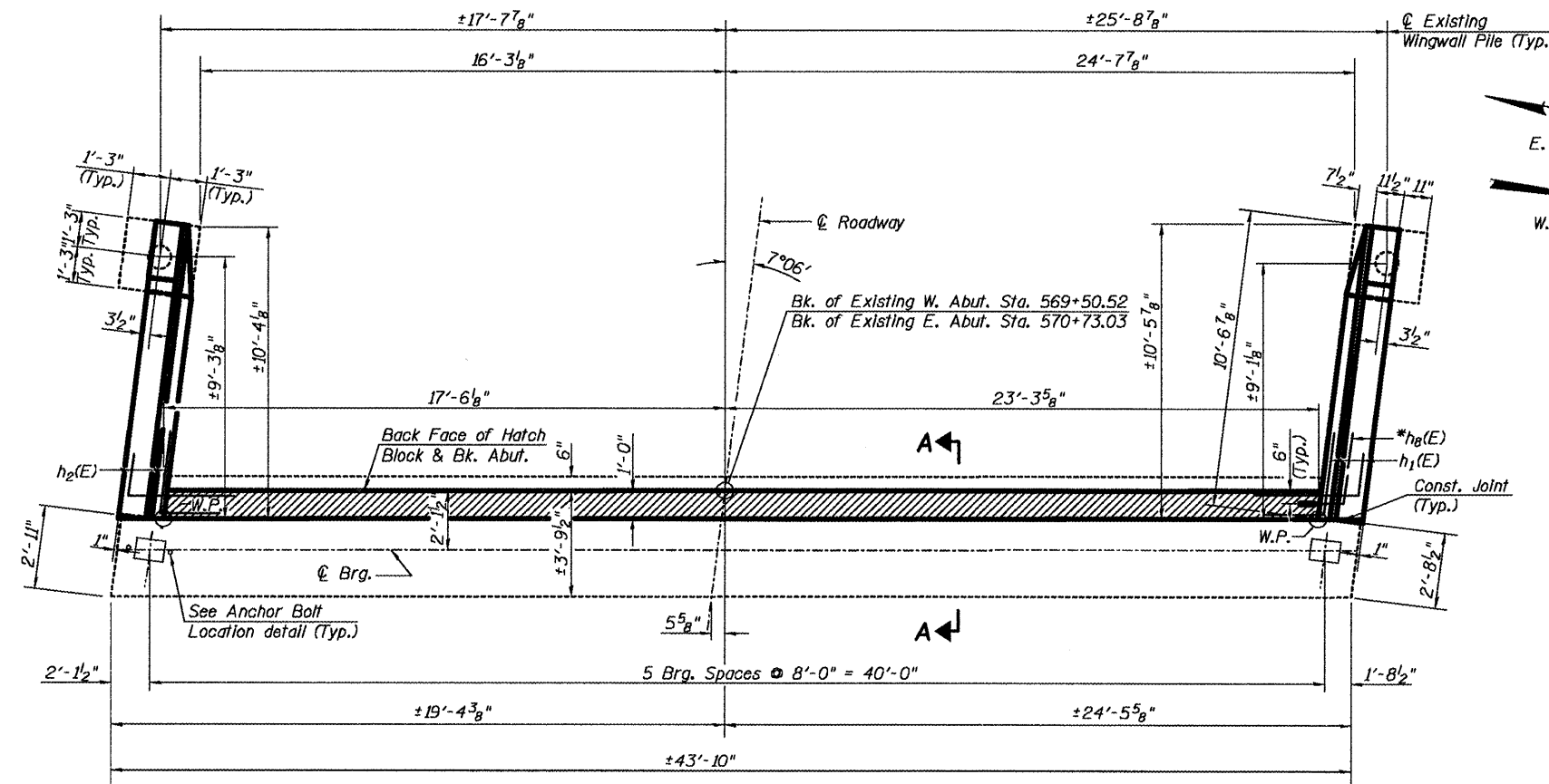

PLAN

Notes:
For clarity existing piles in abutment cap are not shown. Hatched area to be poured after superstructure false work has been removed. Quantity of Concrete is included with Concrete Superstructure on Sheet 9 of 18. Existing reinforcement shall be cleaned and incorporated into the new construction. Cost included with Concrete Removal. See Sheet 18 of 18 for Bar Splicer Details. Work this sheet with Sheet 16 of 18.

⊠ Indicates Structural Repair of Concrete (Depth Equal To or Less Than 5 in).

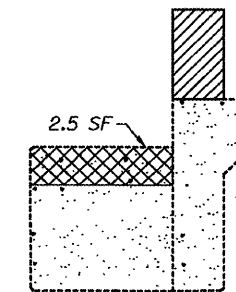
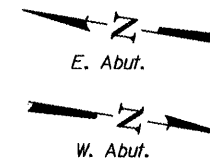

SIDE ELEVATION

West Abutment
(Looking South)

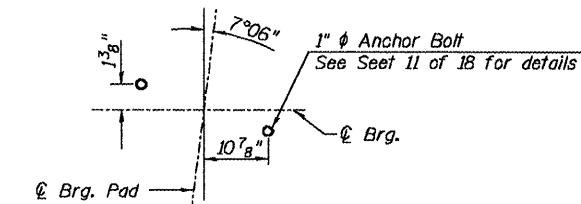

ANCHOR BOLT LOCATION

ABUTMENT MODIFICATIONS - 2
(WEST ABUTMENT - NORTH STRUCTURE)
(EAST ABUTMENT - SOUTH STRUCTURE)
I-74 OVER TOWNSHIP ROAD 205
F.A.I. RTE. 74 - SEC. 48-(27HB-5)I-1
KNOX COUNTY
STATION 570+11.72
STRUCTURE NO. 048-0011 (WB), 0012 (EB)

LIN ENGINEERING, LTD. Consulting Engineers Creston, Illinois	SHEET NO. 14	F.A.I. RTE.	SECTION	COUNTY	TOTAL SHEETS	SHEET NO.
	18 SHEETS	74	48-(27HB-5)I-1	KNOX	104	53
		FED. ROAD DIST. NO.		ILLINOIS FED. AID PROJECT		
		CONTRACT NO. 68062				