

STA. 132+09.40 - 135+50.00

STAGE III

1. Prior to Stage III Remove Temporary Access at Side Streets shown in Stage II and Construct Temporary Pavement for Stage III Traffic.
2. Traffic Control shall be per standard 701602 and as shown on the plans.
3. One lane of Traffic and bidirectional lane shall be maintained at all time as shown on the plans.
4. Remove Temporary Pavement from the South Side.
5. Construct South Side of IL 8 , install remaining Drainage Items as shown on the Plans.

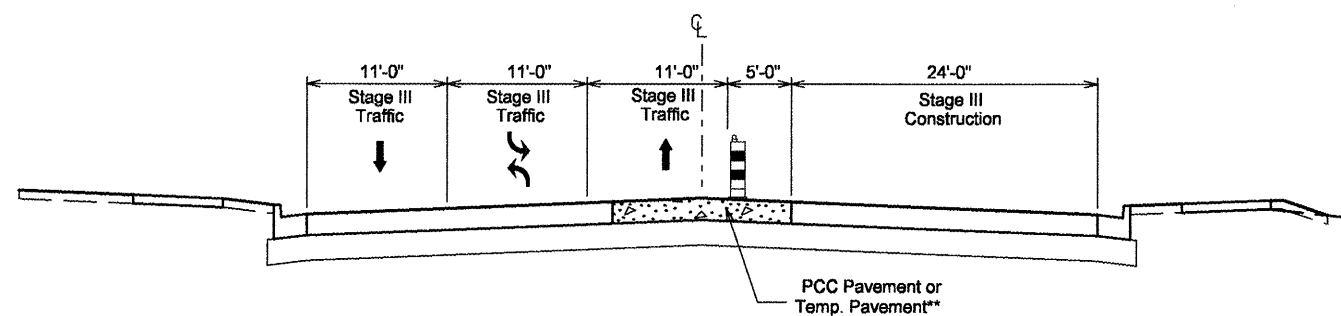

STA. 135+50.00 - 194+60.00

** See plans for Temp. Pavement Locations

STAGE IV

1. Traffic Control shall be per standard 701602 .
2. Remove Temporary Pavement from Median.
3. Construct Proposed Pedestrian Crosswalk and Remaining of the Bi-Directional Lane, Install Permanent Pavement Marking.
4. Complete all Work and Clean Up.

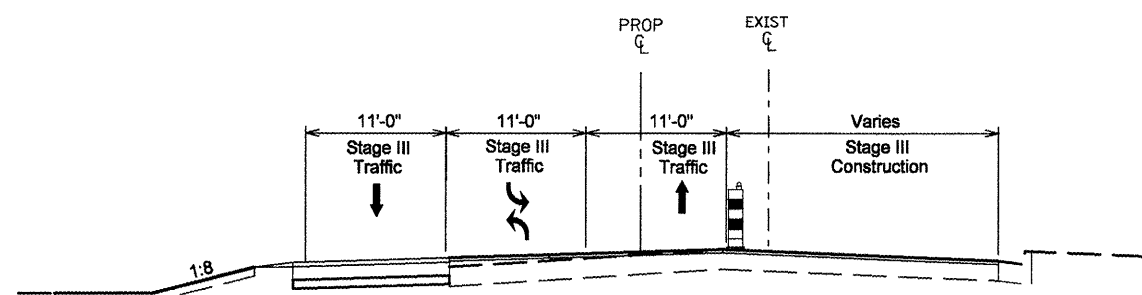

STA. 194+60.00 - 196+60.00

STATE OF ILLINOIS
DEPARTMENT OF TRANSPORTATION

STAGE III TYPICAL SECTION

FILE NAME = STAGETYP.DGN	USER NAME = crespole	DESIGNED -	REVISED -
		DRAWN -	REVISED -
	PLOT SCALE = 15.8685 / IN.	CHECKED -	REVISED -
	PLOT DATE = 12/11/2008	DATE -	REVISED -

SCALE:	SHEET NO.	OF	SHEETS	STA.	TO STA.
--------	-----------	----	--------	------	---------

F.A.P. RTE.	SECTION	COUNTY	TOTAL SHEETS	SHEET NO.
399	36 R-8	TAZEWELL	429	74
CONTRACT NO. 68258				
FED. ROAD DIST. NO. 4 ILLINOIS FED. AID PROJECT				