

NOTES:

1. Maintain temporary erosion control items from Stage I in place.
2. For drainage information, see drainage plans.
3. For permanent erosion control information see landscape plans.
4. For Temporary Widening and overlay information see staging typical sections and plans.

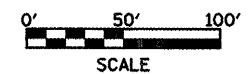
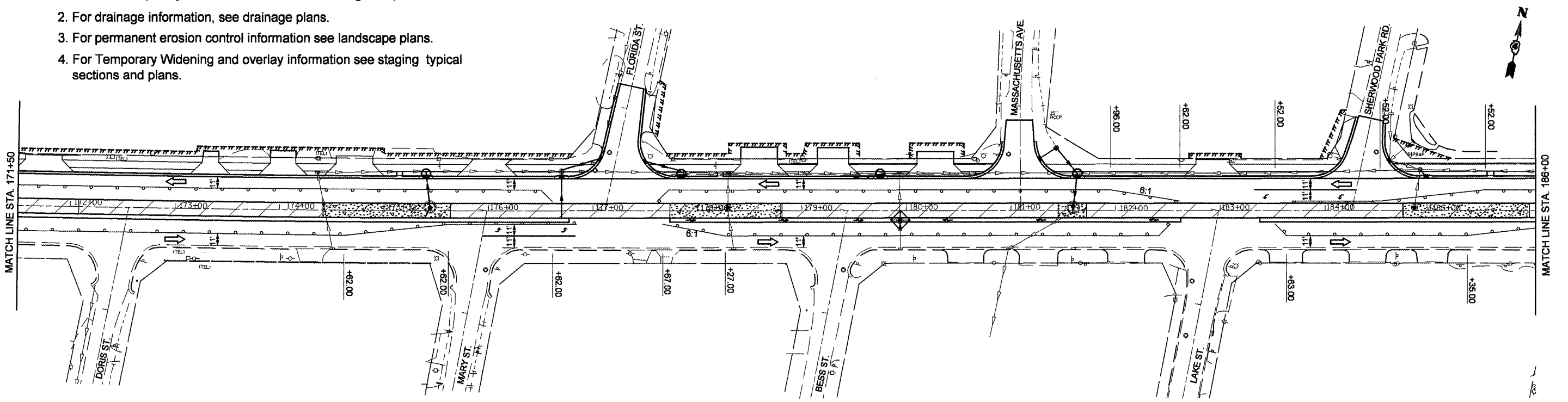

FILE NAME = Stage II erosion sht.dgn	USER NAME = crespole	DESIGNED -	REVISED -	STATE OF ILLINOIS DEPARTMENT OF TRANSPORTATION	IL RTE 8 - Stage 2 Erosion Control Plans			F.A.P. RTE. 399	SECTION 36 R-8	COUNTY TAZEWELL	TOTAL SHEETS 429	SHEET NO. 94
	PLOT SCALE = 100.0000' / IN.	DRAWN -	REVISED -		SCALE:	SHEET NO.	OF	SHEETS	STA.	TO STA.	CONTRACT NO. 68258	
	PLOT DATE = 12/23/2008	CHECKED -	REVISED -								FED. ROAD DIST. NO. 4 ILLINOIS FED. AID PROJECT	
		DATE -	REVISED -									