

DATE	
BY	
REVISIONS	
PLANNED	
DESIGNED	
CHECKED	
NOTED	
NO.	
FILE NAME	

DATE	
BY	
REVISIONS	
PLANNED	
DESIGNED	
CHECKED	
NOTED	
NO.	
FILE NAME	

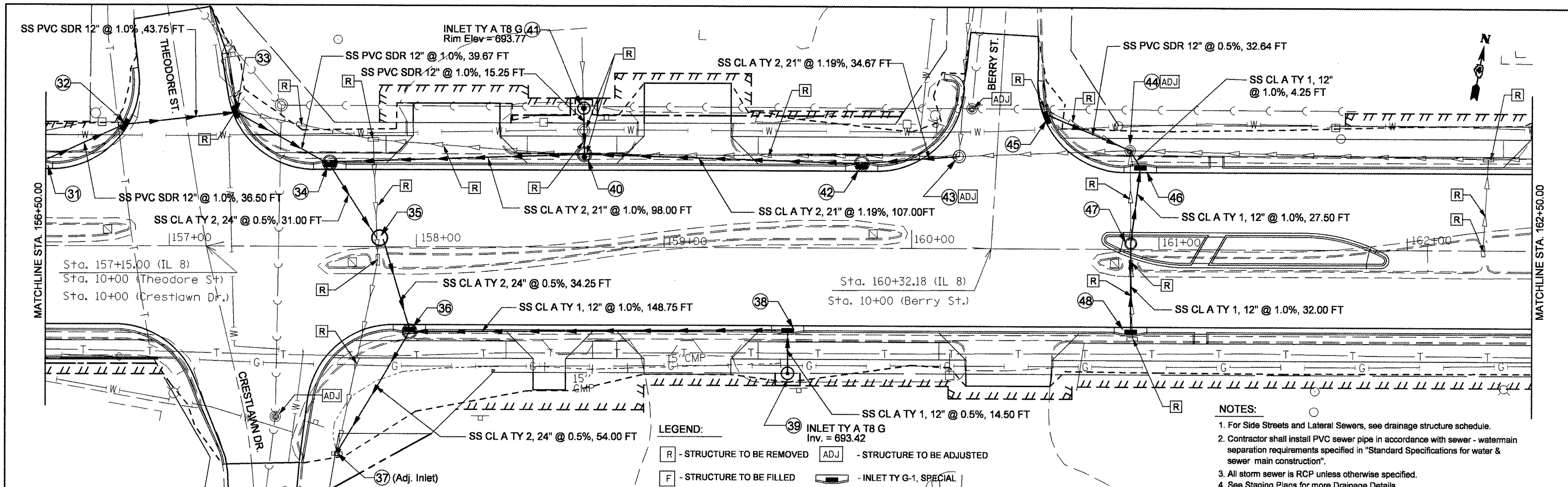

LEGEND:

(R) - STRUCTURE TO BE REMOVED (ADJ) - STRUCTURE TO BE ADJUSTED

(F) - STRUCTURE TO BE FILLED (INLET TY G-1, SPECIAL)

- NOTES:**
1. For Side Streets and Lateral Sewers, see drainage structure schedule.
 2. Contractor shall install PVC sewer pipe in accordance with sewer - watermain separation requirements specified in "Standard Specifications for water & sewer main construction".
 3. All storm sewer is RCP unless otherwise specified.
 4. See Staging Plans for more Drainage Details.

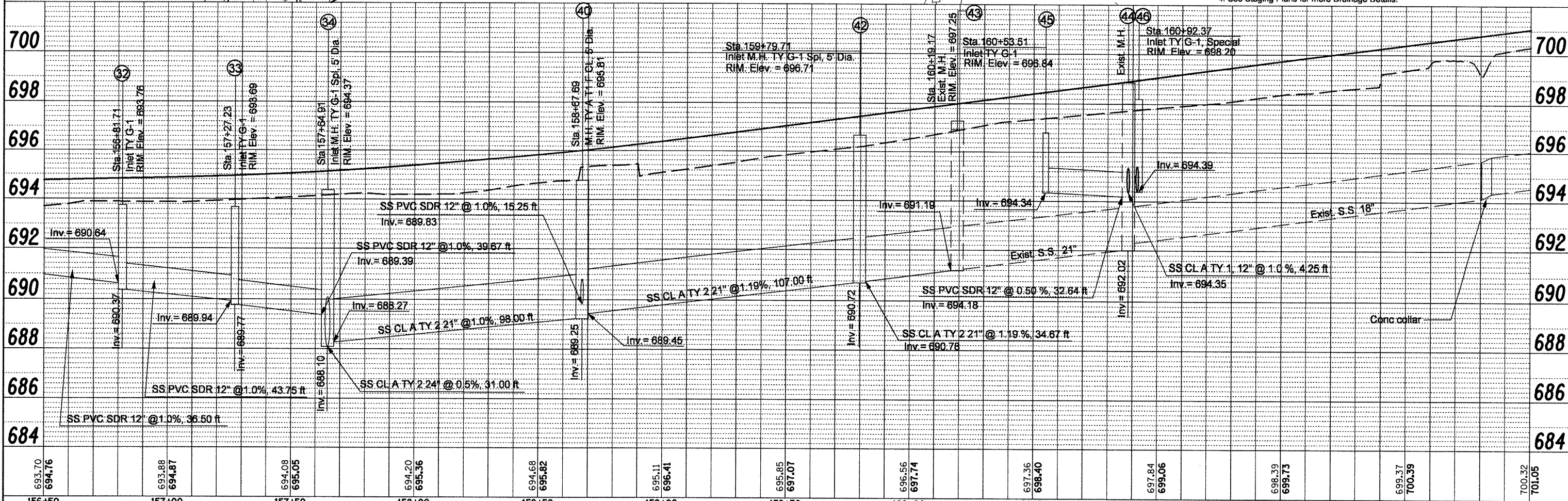

693.70 694.76	693.88 694.87	694.08 695.05	694.20 695.36	694.68 695.82	695.11 696.41	695.85 697.07	696.56 697.74	697.36 698.40	697.84 699.06	698.39 699.73	699.37 700.39	700.32 701.05
156+50	157+00	157+50	158+00	158+50	159+00	159+50	160+00	160+50	161+00	161+50	162+00	162+50

FILE NAME =
copy of drainage plan lt.dgn

USER NAME = swisherhd
DESIGNED -
DRAWN -
PLOT SCALE = 40,0000' / IN.
CHECKED -
PLOT DATE = 12/11/2008
DATE -

REVISED -
REVISED -
REVISED -
REVISED -

**STATE OF ILLINOIS
DEPARTMENT OF TRANSPORTATION**

IL RTE 8 - DRAINAGE PLANS LT SIDE

SCALE: SHEET NO. OF SHEETS STA. TO STA.

F.A.P. RTE.	SECTION	COUNTY	TOTAL SHEETS NO.	SHEET NO.
399	36 R-8	TAZEWELL	429	104
FED. ROAD DIST. NO. 4 ILLINOIS FED. AID PROJECT			CONTRACT NO. 68258	