

F.A.I. RTE.	SECTION	COUNTY	TOTAL SHEETS	SHEET NO.
55	•	MCLEAN	TO	17
STA. 37+000		TO STA. 37+700		
FED. ROAD DIST. NO.		ILLINOIS FED. AID PROJECT		

• (57-4HBR-5&VBR-11&57-2HB-1)
CONTRACT NO. 70661

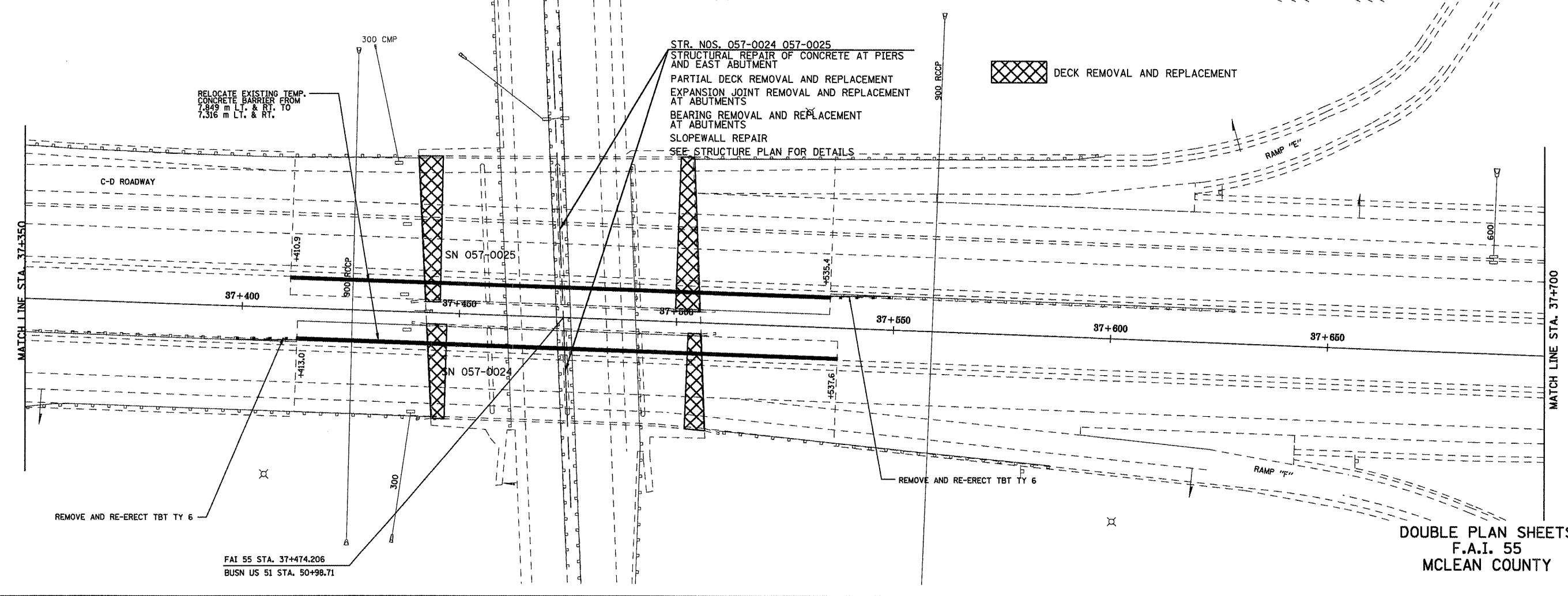
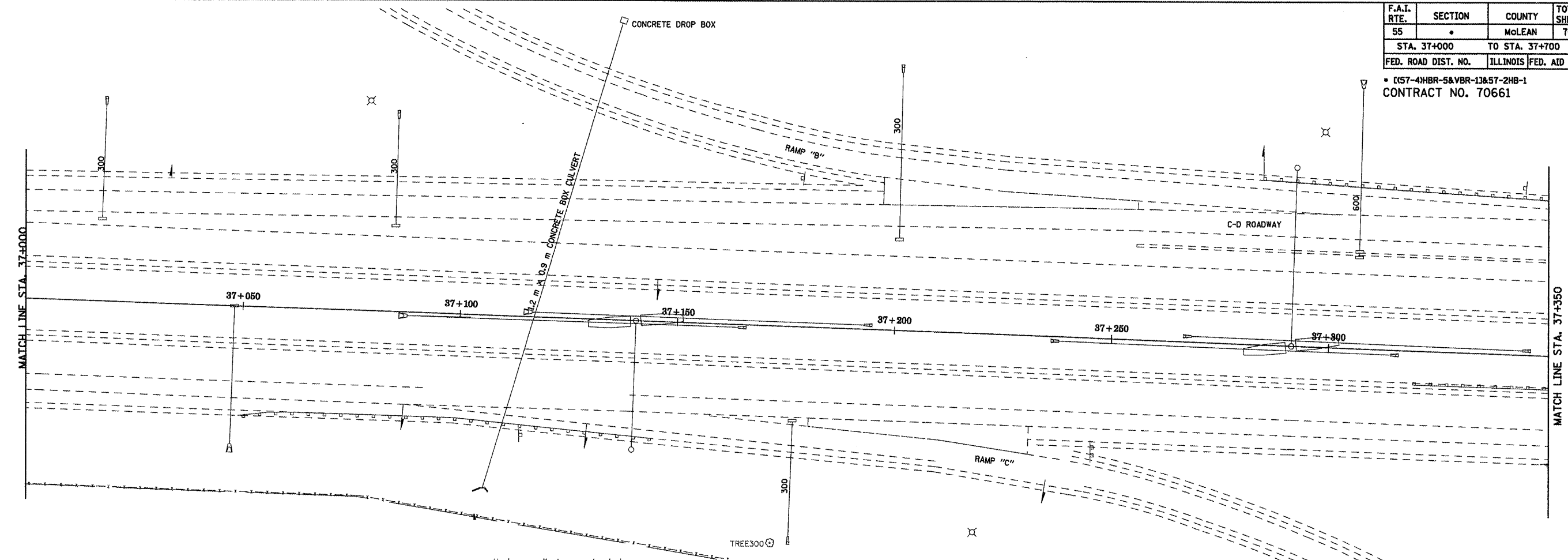

RELOCATE EXISTING TEMP. CONCRETE BARRIER FROM 7.349 m L. & R. TO 7.316 m L. & R.

STR. NOS. 057-0024 057-0025
STRUCTURAL REPAIR OF CONCRETE AT PIERS AND EAST ABUTMENT
PARTIAL DECK REMOVAL AND REPLACEMENT
EXPANSION JOINT REMOVAL AND REPLACEMENT AT ABUTMENTS
BEARING REMOVAL AND REPLACEMENT AT ABUTMENTS
SLOPEWALL REPAIR
SEE STRUCTURE PLAN FOR DETAILS

DECK REMOVAL AND REPLACEMENT

REMOVE AND RE-ERECT TBT TY 6

REMOVE AND RE-ERECT TBT TY 6

FAI 55 STA. 37+474.206
BUSN US 51 STA. 50+98.71

DOUBLE PLAN SHEETS
F.A.I. 55
MCLEAN COUNTY