

F.A.I. RTE.	SECTION	COUNTY	TOTAL SHEETS	SHEET NO.
55	*	MCLEAN	70	19
STA. 38+400		TO STA. 39+100		
FED. ROAD DIST. NO.		ILLINOIS	FED. AID PROJECT	

CENTERLINE CURVE DATA  
 $\Delta = 03^{\circ}00'45''$   
 $R = 6985.787m$   
 $T = 183.684m$   
 $L = 367.283m$   
P.C. STA. 38+479.440  
P.I. STA. 38+663.124  
P.T. STA. 38+846.723

• [(57-4)HBR-5&VBR-13&57-2HB-1  
CONTRACT NO. 70661

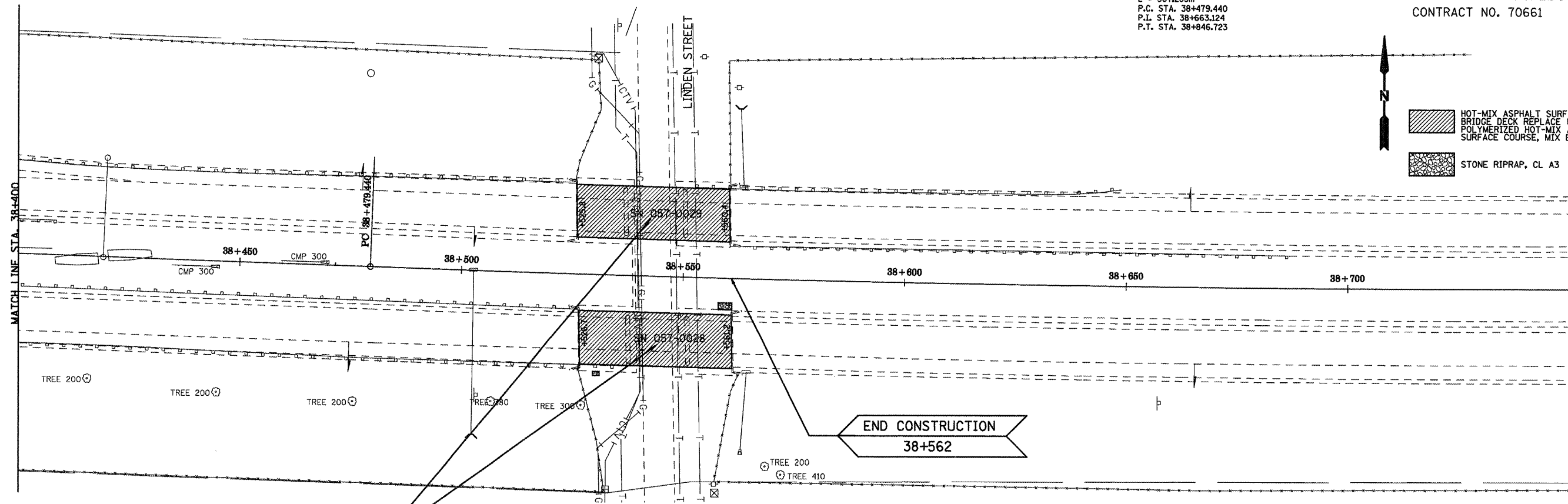

STR. NOS. 057-0028 & 057-0029  
REMOVE AND REPLACE HMA OVERLAY AND WATERPROOFING MEMBRANE  
DECK PATCHING  
REMOVE AND REPLACE ABUTMENT JOINTS  
SLOPEWALL PATCHING (STR. 057-0029 WEST SLOPEWALL)  
PLUG DECK DRAINS NEAR ABUTMENTS AND PIERS  
SEE STRUCTURE PLAN FOR DETAILS