

**FAS 1597 (IL 96) POT STA 2190+07.13**  
 N 1,178,644.98 E 1,963,812.57

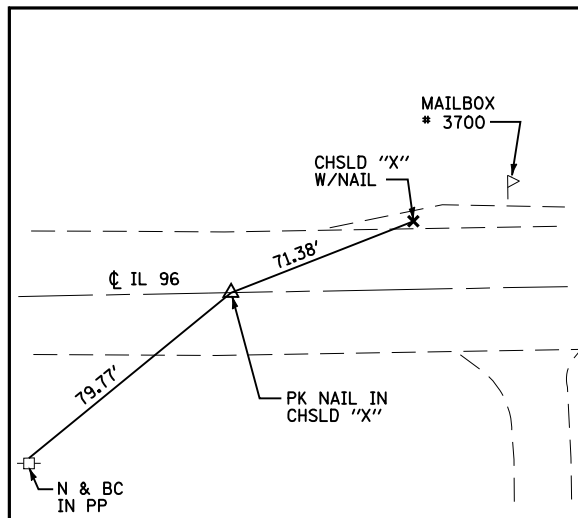

**FAS 1597 (IL 96) PC STA 2201+22.42**  
 N 1,178,651.47 E 1,962,697.30

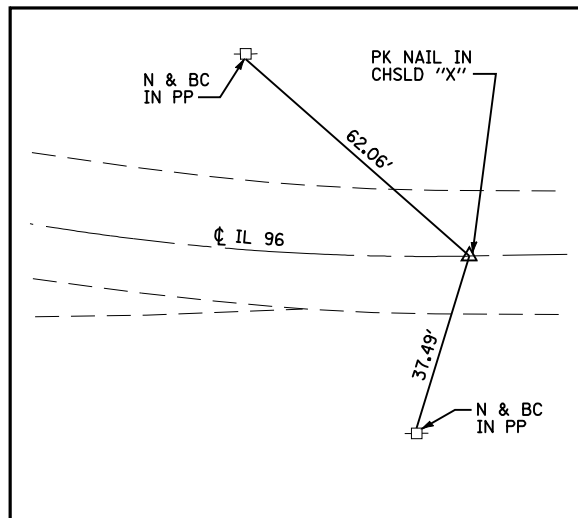

**FAS 1597 (IL 96) PI STA 2201+81.59**  
 N 1,178,651.81 E 1,962,638.13

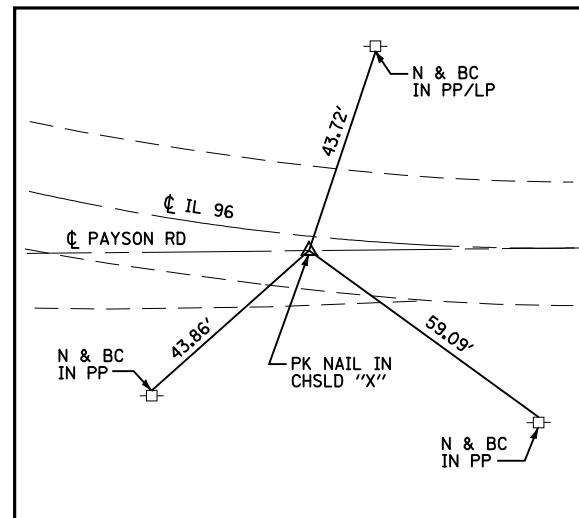

**FAS 1597 (IL 96) PT STA 2202+40.76**  
 N 1,178,652.62 E 1,962,578.97

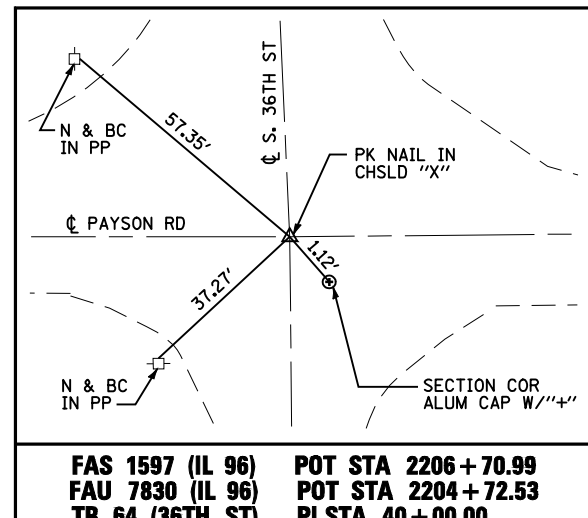

**FAS 1597 (IL 96) POT STA 2206+70.99**  
**FAU 7830 (IL 96) POT STA 2204+72.53**  
**TR 64 (36TH ST) PI STA 40+00.00**  
**FAU 7817 (CH 34/PAYSON RD) PI STA 20+00.00**  
 N 1,178,658.52 E 1,962,148.78

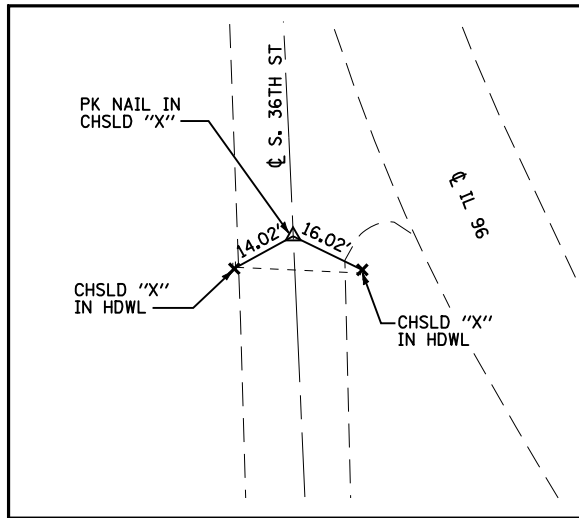

**FAU 7830 (IL 96) PC STA 2207+63.62**  
 N 1,178,949.54 E 1,962,142.61

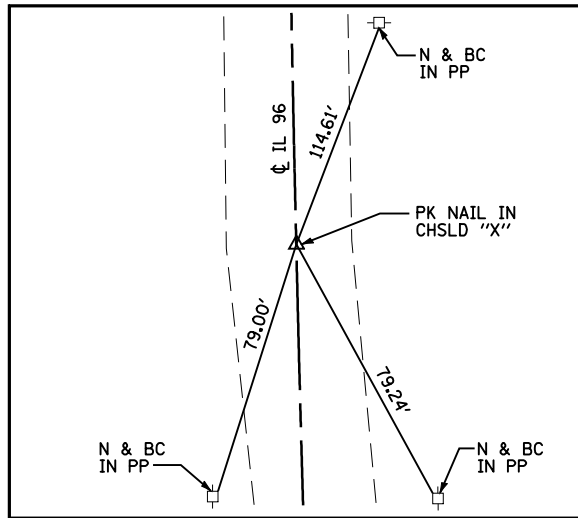

**FAU 7830 (IL 96) PI STA 2209+80.22**  
 N 1,179,166.10 E 1,962,138.02

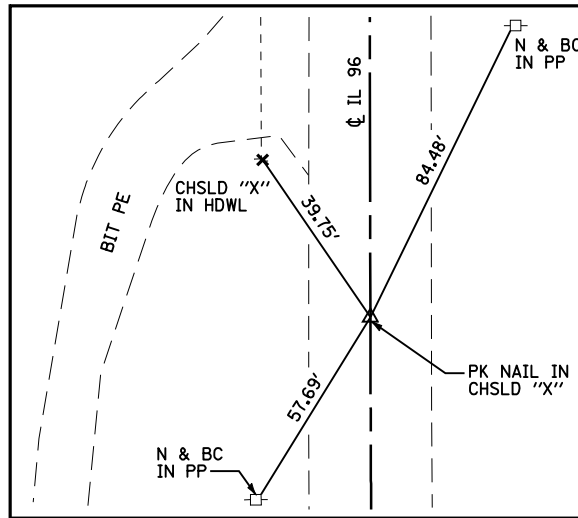

**FAU 7830 (IL 96) PT STA 2211+96.76**  
 N 1,179,382.66 E 1,962,142.81

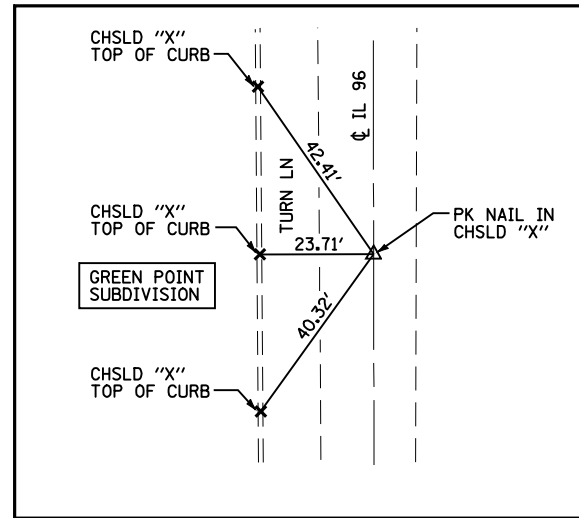

**FAU 7830 (IL 96) POT STA 2228+50.56**  
 N 1,181,036.04 E 1,962,179.40

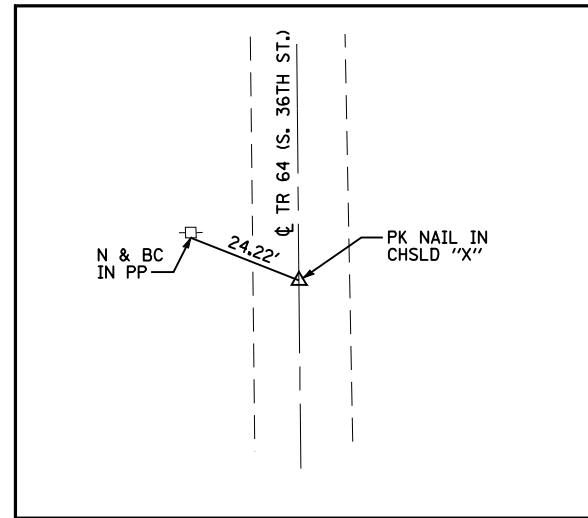

**TR 64 (36TH STREET) POT STA 29+15.19**  
 N 1,177,573.82 E 1,962,133.15

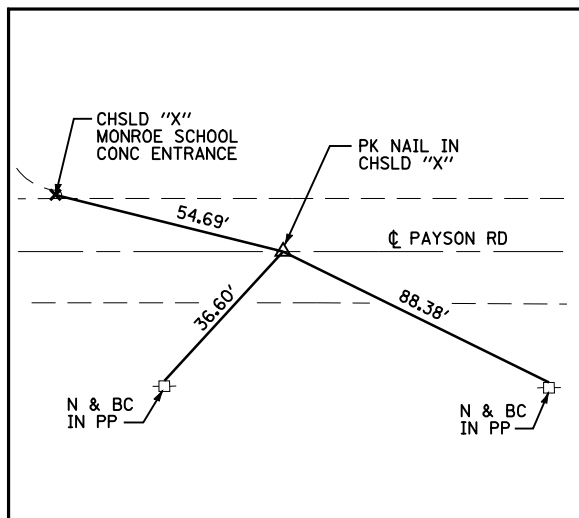

**FAU 7817 (CH 34/PAYSON RD) POT STA 8+85.10**  
 N 1,178,685.07 E 1,961,034.19

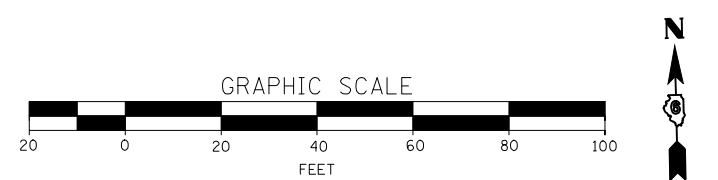

FILE NAME =	USER NAME = laughlinr1	DESIGNED -	REVISED -
et:\pwork\work\PWIDOT\LAUGHLINRL\02114681\02114681.dgn		DRAWN -	REVISED -
	PLOT SCALE = 40.0000' / IN.	CHECKED -	REVISED -
	PLOT DATE = Dec-12-2008 02:51:07PM	DATE -	REVISED -

**STATE OF ILLINOIS  
 DEPARTMENT OF TRANSPORTATION**

**HORIZONTAL CONTROL TIES**

SCALE: 1"=20' SHEET NO. 1 OF 1 SHEETS STA. TO STA.

F.A. RTE.	SECTION	COUNTY	TOTAL SHEETS	SHEET NO.
• - FAS 1597 & FAU 7830	(11)N	ADAMS	117	26
FED. ROAD DIST. NO.	ILLINOIS FED. AID PROJECT	CONTRACT NO. 72817		