

DATE	
BY	
FINAL SURVEY	SURVEYED
NOTE BOOK	PLOTTED
NO.	TEMPLATE
	AREAS CHECKED

DATE	
BY	
ORIGINAL SURVEY	SURVEYED
NOTE BOOK	PLOTTED
NO.	TEMPLATE
	AREAS CHECKED

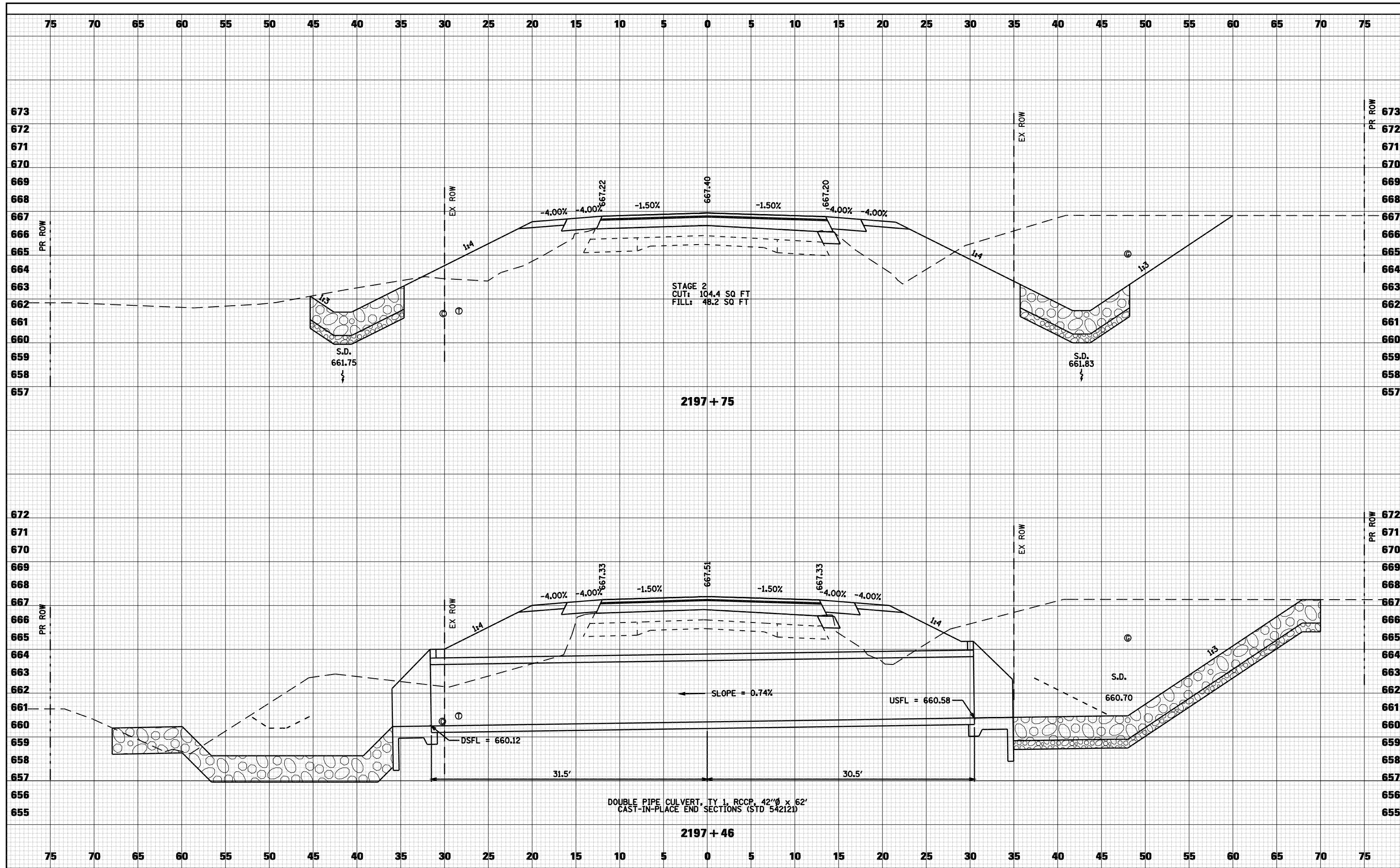

FILE NAME =	USER NAME = laughlinr1	DESIGNED -	REVISED -
c:\pwork\PWIDOT\LAUGHLINR\0114681\075XSP01\IL96.dgn		CHECKED -	REVISED -
		DRAWN -	REVISED -
		CHECKED -	REVISED -

**STATE OF ILLINOIS
DEPARTMENT OF TRANSPORTATION**

CROSS SECTIONS - FAS 1597 (IL 96)

SCALE: 1"=5' SHEET NO. 5 OF 16 SHEETS STA. 2197+46 TO STA. 2197+75

F.A. RTE.	SECTION	COUNTY	TOTAL SHEETS	SHEET NO.
	(11)N	ADAMS	117	79
• - FAS 1597 & FAU 7830			CONTRACT NO. 72817	
FED. ROAD DIST. NO.	ILLINOIS FED. AID PROJECT			