

DATE	
BY	
FINAL SURVEY	
PLOTTED TEMPLATE	
NOTE BOOK	
AREAS CHECKED	
NO.	

DATE	
BY	
ORIGINAL SURVEY	
PLOTTED TEMPLATE	
NOTE BOOK	
AREAS CHECKED	
NO.	

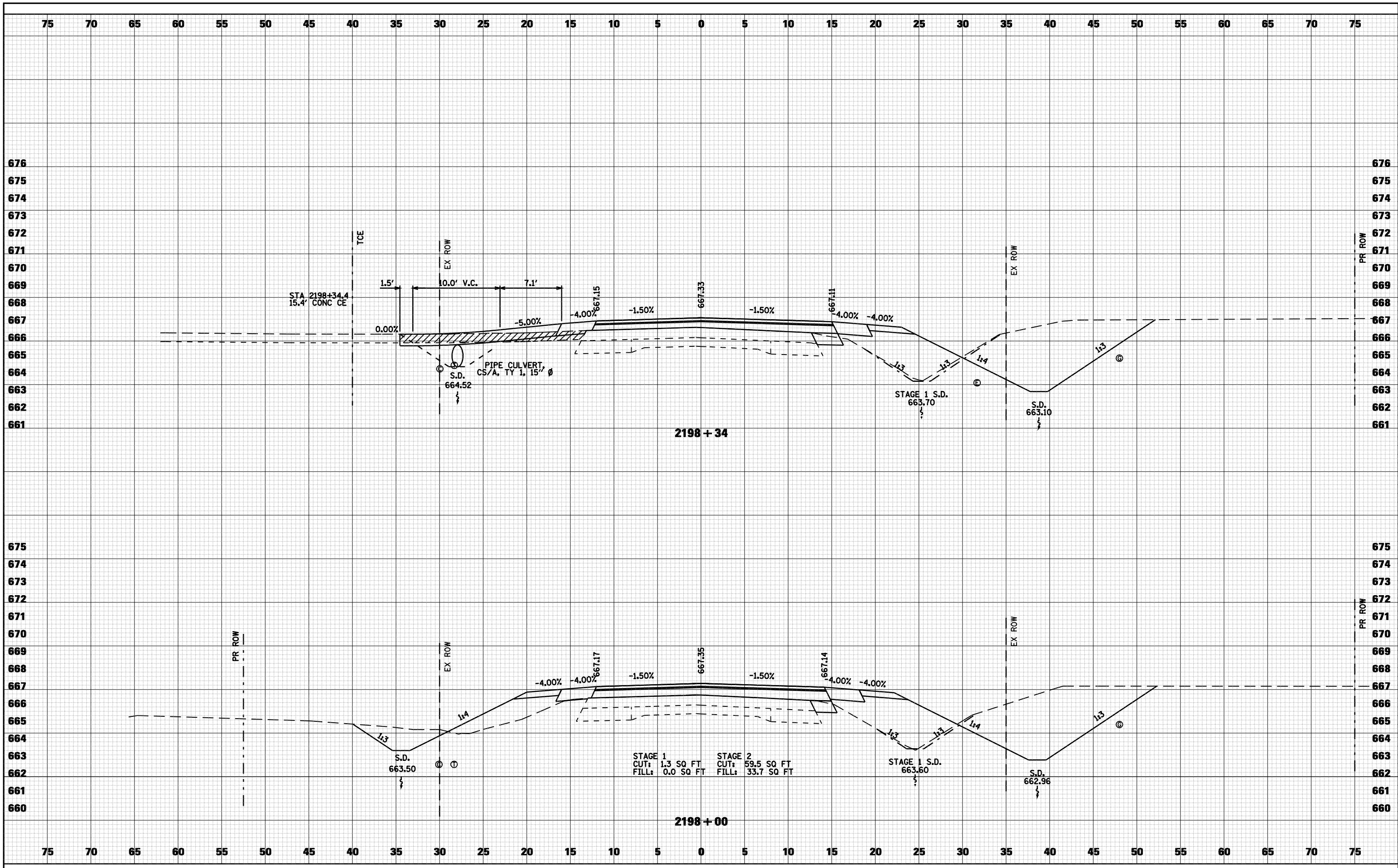

FILE NAME =	USER NAME = laughlinr1	DESIGNED -	REVISED -	<b>STATE OF ILLINOIS DEPARTMENT OF TRANSPORTATION</b>	<b>CROSS SECTIONS - FAS 1597 (IL 96)</b>		F.A. RTE.	SECTION	COUNTY	TOTAL SHEETS	SHEET NO.
ct:\pwork\PWIDOT\LAUGHLINR1\075XSP001\IL96.dgn	PLOT SCALE = 10.0000 "/td> <td>CHECKED -</td> <td>REVISED -</td> <td>• (11)N</td> <td>ADAMS</td> <td>117</td> <td>80</td>	CHECKED -	REVISED -				• (11)N	ADAMS	117	80	
PLOT DATE = Dec-12-2008 03:00:01PM	CHECKED -	REVISED -	• - FAS 1597 & FAU 7830				CONTRACT NO. 72817				
							FED. ROAD DIST. NO.	ILLINOIS FED. AID PROJECT			