

ROUTE NO.	SECTION	COUNTY	DISTRICT	SHEET	SHEET NO. 14
F.A.I. 55	68-4B-1	MONTGOMERY	145	54	23 SHEETS
FED. ROAD DIST. NO. 7	ILLINOIS	FED. AID PROJECT			

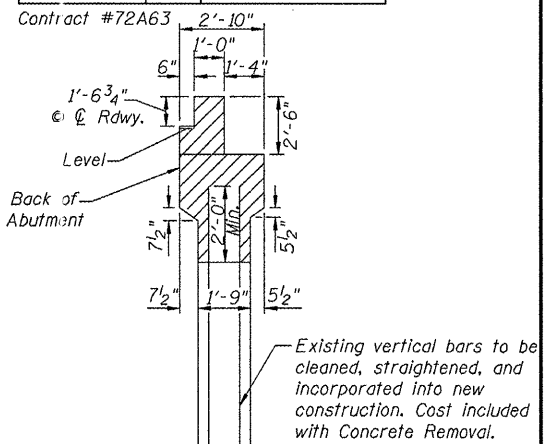

SECTION THRU ABUTMENT
(Horiz. Dim. at right L's)

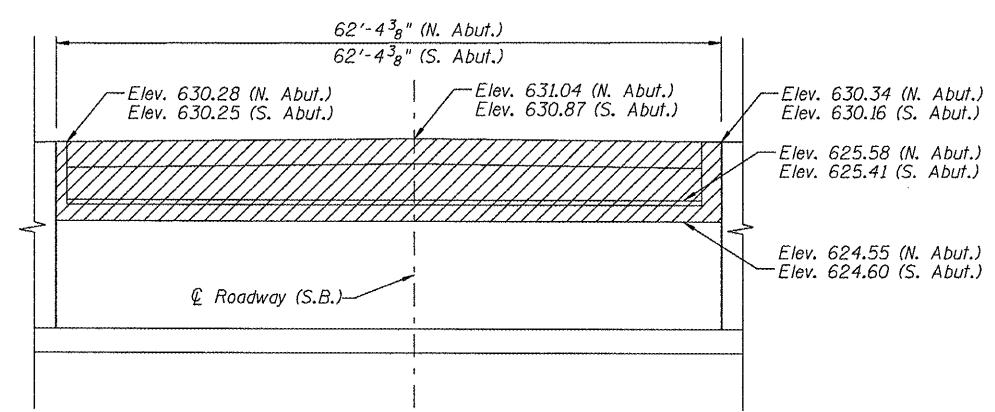

ELEVATION OF ABUTMENT (S.B. LANES)
(North Abument - Looking North, shown)
(South Abument - Looking South, similar/mirrored)

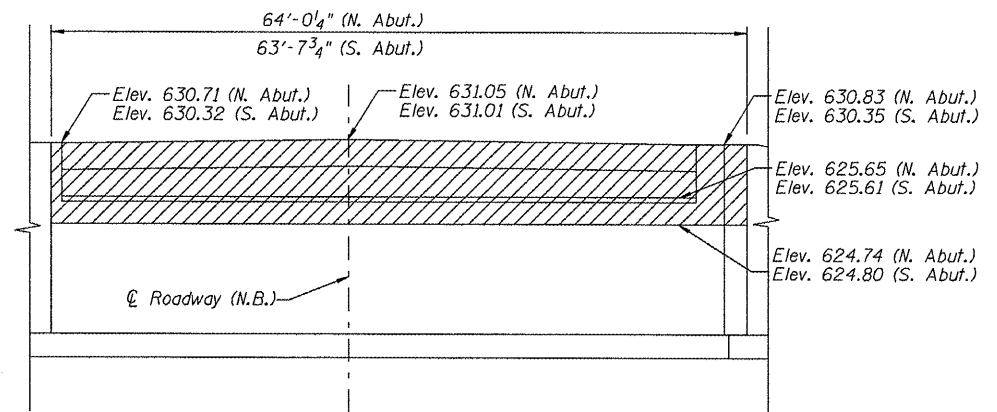

ELEVATION OF ABUTMENT (N.B. LANES)
(North Abument - Looking North, shown)
(South Abument - Looking South, similar/mirrored)

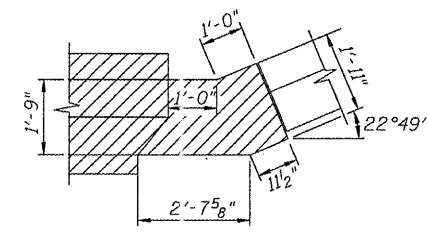

DETAIL A

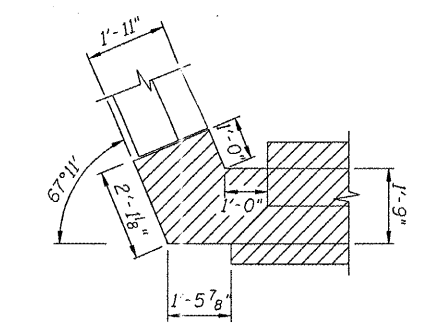

DETAIL B

LEGEND
Concrete Removal

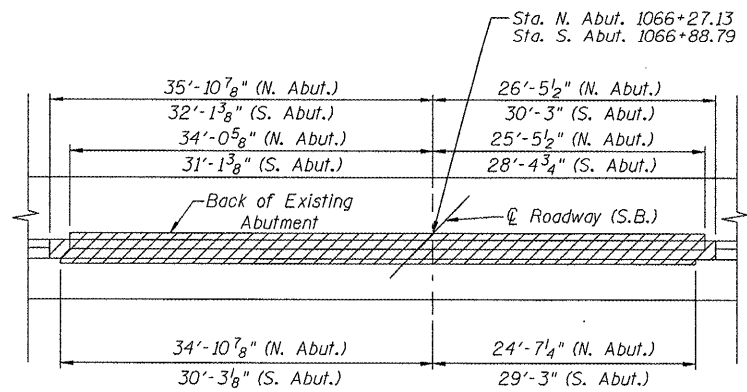

PLAN VIEW (S.B. LANES)
(North Abument, shown)
(South Abument, similar/mirrored)

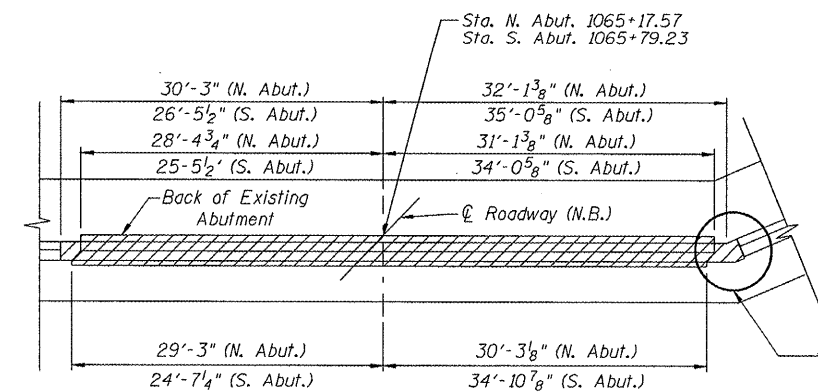

PLAN VIEW (N.B. LANES)
(North Abument, shown)
(South Abument, similar/mirrored)

BILL OF MATERIAL

Item	Unit	Total
Concrete Removal	Cu. Yd.	115
Asbestos Bearing Pad Removal	Each	56

ILLINOIS DEPARTMENT OF TRANSPORTATION
CONCRETE REMOVAL DETAILS
I 55 OVER MACOUPIN CREEK
F.A.I. ROUTE 55 - SEC. 68-4B-1
MONTGOMERY COUNTY
STATION 1066+03.18
STRUCTURE NO. 068-0038 N.B.
STRUCTURE NO. 068-0039 S.B.
DATE: 04-08
REVISED:
DRAWN BY: MLO
CHECKED BY: PBB

Rev. 2-17-09