

**MEDIAN W/SIGNAL DETAIL - 4TH ST.
STA. 99+30.00**

MEDIAN LEGEND

- M01 99+21.20, 1.87' LT MATCH EXIST.
- M02 99+21.19, 4.90' LT MATCH EXIST.
- M03 99+27.19, 4.91' LT PR TBC
- M04 99+31.67, 4.92' LT 1.5' RAD. PR TBC
- M05 99+31.68, 1.89' LT 1.5' RAD. PR TBC
- M06 99+27.20, 1.88' LT PR TBC

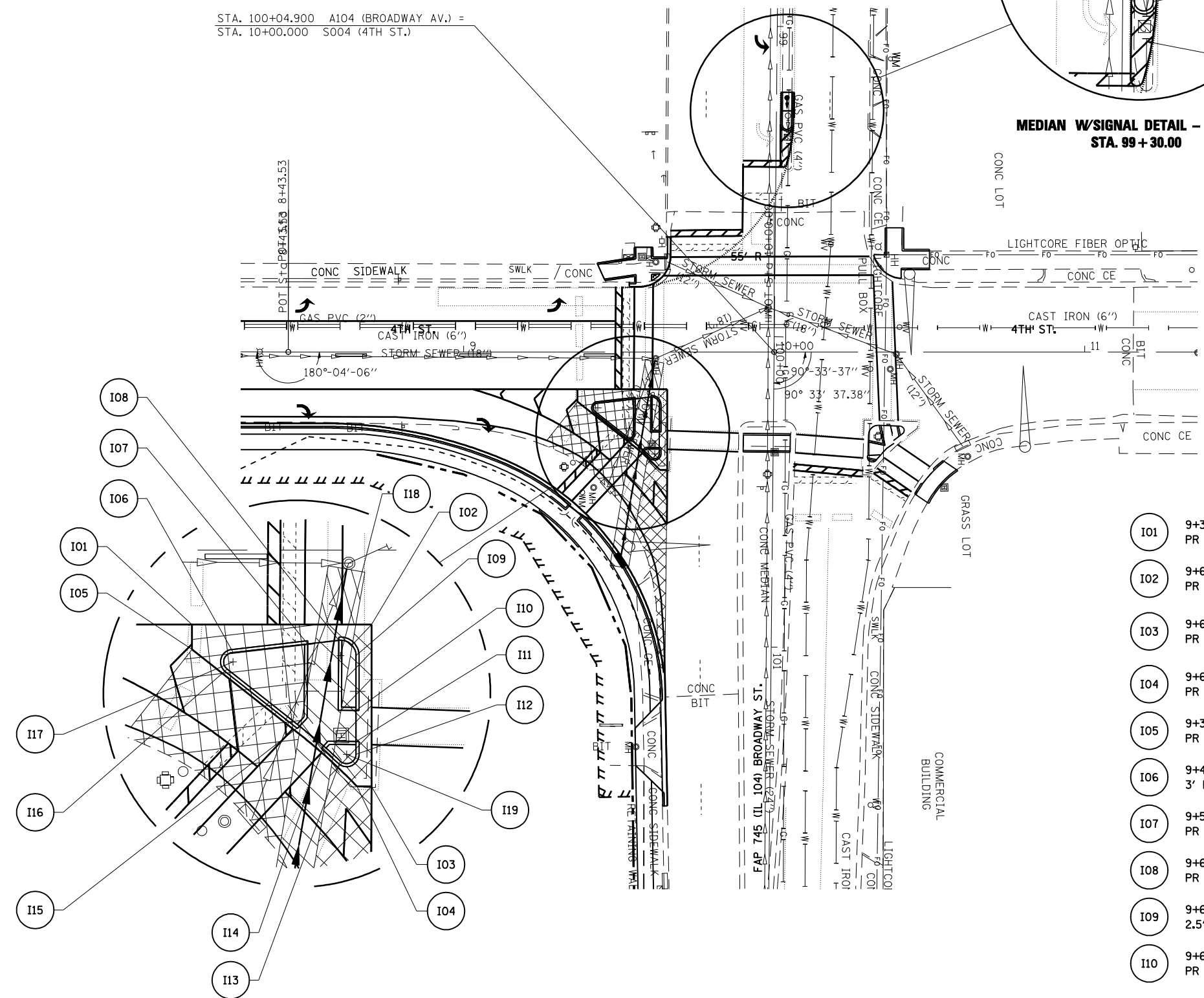

ISLAND LEGEND

- I01 9+36.64, 12.00' RT PR EOP
- I02 9+65.55, 12.00' RT PR EOP
- I03 9+65.52, 38.06' RT PR EOP
- I04 9+63.19, 38.06' RT PR EOP
- I05 9+36.64, 16.00' RT PR EOP
- I06 9+43.28, 16.50' RT 3' RAD. PR TBC
- I07 9+55.26, 15.11' RT PR TBC & CROSSWALK FACE
- I08 9+60.26, 14.54' RT PR TBC & CROSSWALK FACE
- I09 9+63.04, 17.00' RT 2.5' RAD. PR TBC
- I10 9+63.04, 25.81' RT PR TBC & CROSSWALK FACE
- I11 9+63.03, 30.82' RT PR TBC & CROSSWALK FACE
- I12 9+63.03, 32.89' RT 1.5' RAD. PR TBC
- I13 9+60.50, 33.98' RT 1.5' RAD. PR TBC
- I14 9+57.82, 31.56' RT PR TBC & CROSSWALK FACE
- I15 9+53.95, 28.37' RT PR TBC & CROSSWALK FACE
- I16 9+42.29, 19.18' RT 3' RAD. PR TBC
- I17 9+43.22, 18.00' RT 1.5' RAD TBC
- I18 9+60.54, 17.00' RT 1.5' RAD TBC
- I19 9+61.53, 32.89' RT 1.5' RAD TBC

ISLAND DETAIL - BROADWAY & 4TH ST.

FILE NAME =	USER NAME = laughlinr1	DESIGNED -	REVISED -	STATE OF ILLINOIS DEPARTMENT OF TRANSPORTATION	INTERSECTION DETAIL - 4TH ST.			F.A.P. RTE.	SECTION	COUNTY	TOTAL SHEETS	SHEET NO.
et:\pwork\pwork\DOT\LAUGHLINR1\dms24089\652407\sh-t-intersec-4th.dgn		DRAWN -	REVISED -		745	.	ADAMS	37	22			
		CHECKED -	REVISED -		CONTRACT NO. 72A96							
		DATE -	REVISED -		SCALE:	SHEET NO.	OF SHEETS	STA.	TO STA.	FED. ROAD DIST. NO.	ILLINOIS FED. AID PROJECT	
									* D-6 INTERSECTION IMPROVEMENT			