

FOR INDEX OF SHEETS AND HIGHWAY
STANDARDS, SEE SHEET 2.

STATE OF ILLINOIS
DEPARTMENT OF TRANSPORTATION
DIVISION OF HIGHWAYS

CONTRACT: 72C47
SHEET 1 OF 8

**PLANS FOR PROPOSED
D.E. MISCELLANEOUS
FAI ROUTE 55 (I-55)
SECTION (84-2-1,84-2-2)D-6 PATCHING-1
SANGAMON COUNTY
C96-026-09 / D96-026-09**

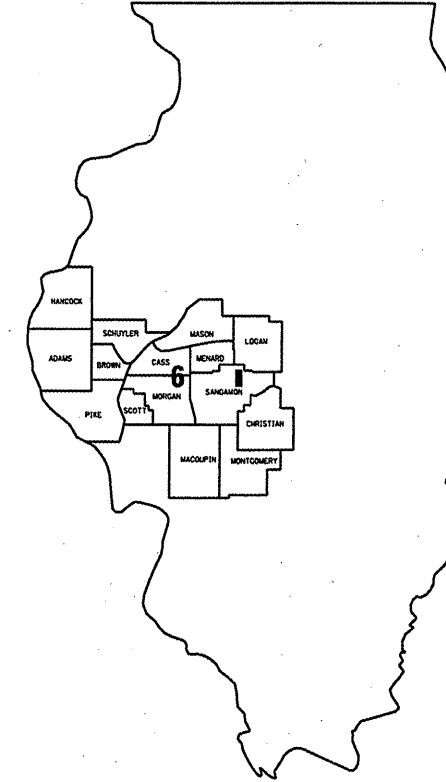

LOCATION OF SECTION INDICATED THUS: ■

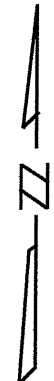
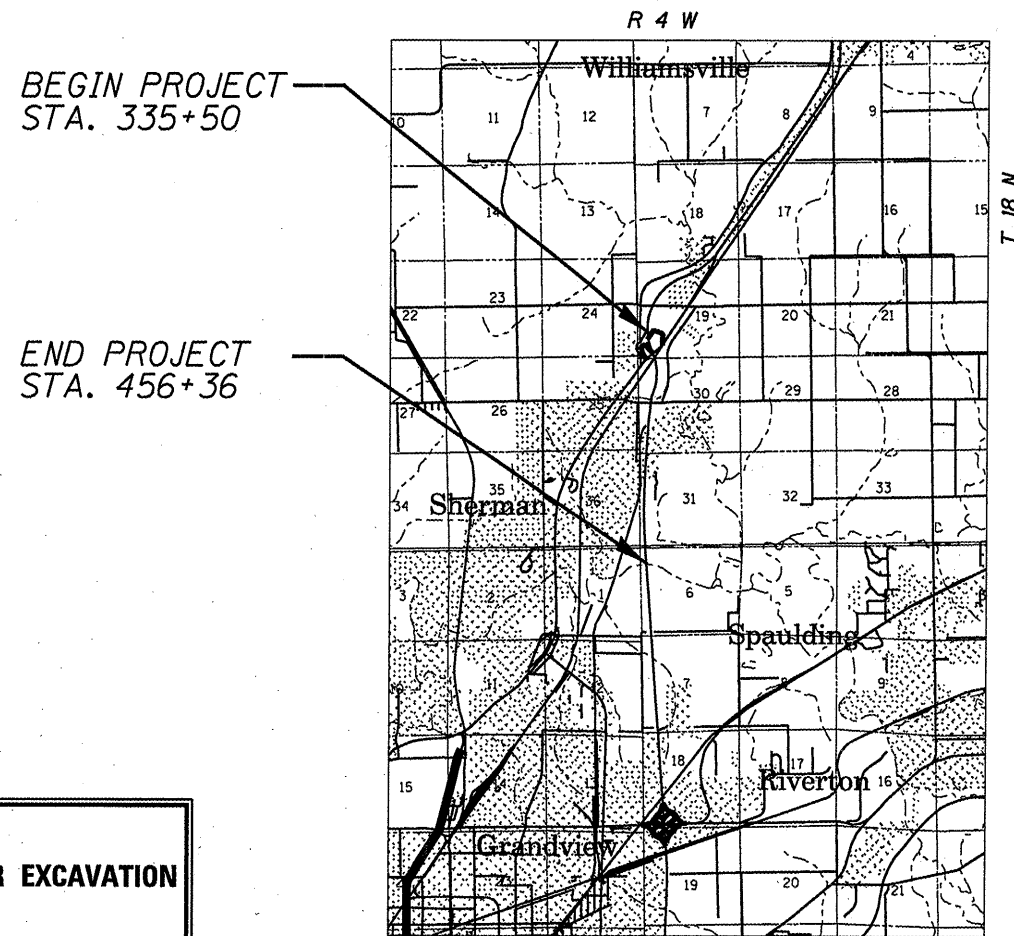

J. U. L. I. E.
JOINT UTILITY LOCATION INFORMATION FOR EXCAVATION
1-800-892-0123

PLANS & CONTRACT TECHNICIAN: TIMOTHY SHARP
PHONE: (217) 782-7743

NET LTH OF SEC 12,086.00 FT = 2.289 MILE

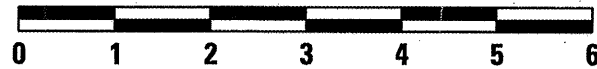

SCALE: 1" = 2 MILES

STATE OF ILLINOIS
DEPARTMENT OF TRANSPORTATION
DIVISION OF HIGHWAYS

SUBMITTED JANUARY 22 20 09

Reg. Z Dickel
DEPUTY DIRECTOR OF HIGHWAYS, REGION FOUR ENGINEER

January 30 20 09
Charles J. Ingersoll
ENGINEER OF DESIGN AND ENVIRONMENT

January 30 20 09
Christine M. Reed
DIRECTOR, DIVISION OF HIGHWAYS

CONTRACT NO. 72C47



PRINTED BY AUTHORITY OF THE STATE OF ILLINOIS

INDEX

- 1 COVER
- 2 INDEX/STANDARDS/SIGNATURES
- 3-4 QUANTITIES
- 5 TYPICAL SECTIONS
- 6 BRIDGE APPROACH PLAN
- 7 BRIDGE APPROACH DETAILS
- 8 SCHEDULES

STANDARDS

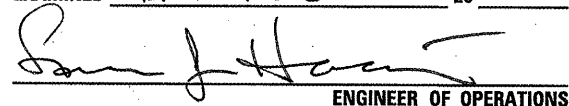
- 701101-02
- 701106-02
- 701400-03
- 701401-05
- 701411-05
- 701446-01
- 701901-01

STATE OF ILLINOIS DEPARTMENT OF TRANSPORTATION DIVISION OF HIGHWAYS DISTRICT 6	
EXAMINED <u>12/23/08</u> 20	 ENGINEER OF OPERATIONS
EXAMINED <u>Jan 20</u> 2009	 ENGINEER OF PROGRAM IMPLEMENTATION
EXAMINED <u>Jan 20</u> 2009	 ENGINEER OF PROGRAM DEVELOPMENT

INDEX/STANDARDS/SIGNATURES
FAI 55 (I-55)
SECT. (84-2-1,84-2-2)D-6 PATCHING-1
SANGAMON COUNTY

S U M M A R Y O F Q U A N T I T I E S

CODE NO.	ITEM	UNIT	100% STATE
			I000
			TOTAL QTY
40600200	BITUMINOUS MATERIALS (PRIME COAT)	TON	3.5
40603575	POLYMERIZED HOT-MIX ASPHALT SURFACE COURSE, MIX "E", N105	TON	756
44000155	HOT-MIX ASPHALT SURFACE REMOVAL, 1 1/2"	SQ YD	8.996
67100100	MOBILIZATION	L SUM	1
70100420	TRAFFIC CONTROL AND PROTECTION, STANDARD 701411	EACH	4
70100800	TRAFFIC CONTROL AND PROTECTION, STANDARD 701401	L SUM	1
70100815	TRAFFIC CONTROL AND PROTECTION, STANDARD 701446	L SUM	1
70106800	CHANGEABLE MESSAGE SIGN	CAL MO	1.0
70300100	SHORT-TERM PAVEMENT MARKING	FOOT	276
70301000	WORK ZONE PAVEMENT MARKING REMOVAL	SQ FT	92

QUANTITIES
FAI 55 (I-55)
SECT. (84-2-1.84-2-2)D-6 PATCHING-1
SANGAMON COUNTY

S U M M A R Y O F Q U A N T I T I E S

CODE NO.	ITEM	UNIT	100% STATE
			I000
			TOTAL QTY
78100100	RAISED REFLECTIVE PAVEMENT MARKER	EACH	4
78300200	RAISED REFLECTIVE PAVEMENT MARKER REMOVAL	EACH	4
X0320887	POLYMER CONCRETE	CU FT	13
X0322932	SILICONE JOINT SEALER, 1.5"	FOOT	42
X0326223	FOAM, EXPANDING POLYURETHANE, HIGH-DENSITY	POUND	2.500
X7800620	URETHANE PAVEMENT MARKING - LINE 5"	FOOT	6.647

QUANTITIES
FAI 55 (I-55)
SECT. (84-2-1.84-2-2)D-6 PATCHING-1
SANGAMON COUNTY

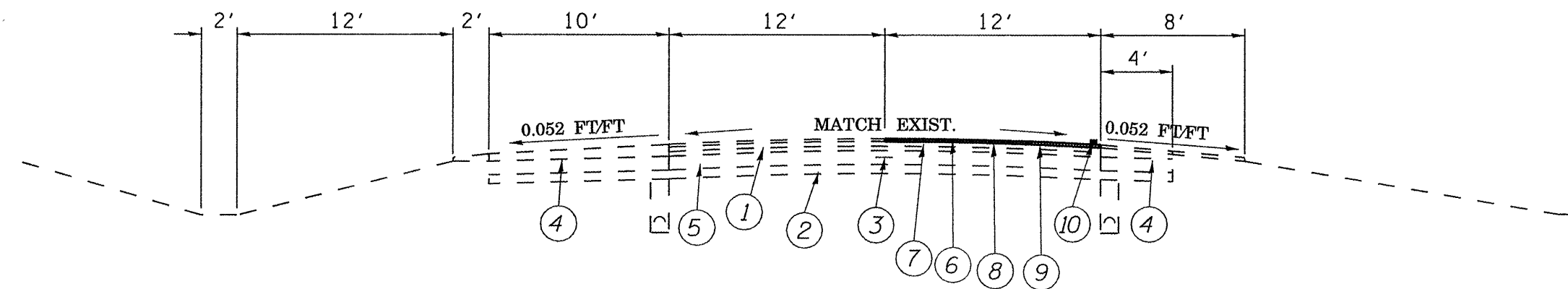

N.B. LANE

STA. 348+38 TO 377+80 D.L.

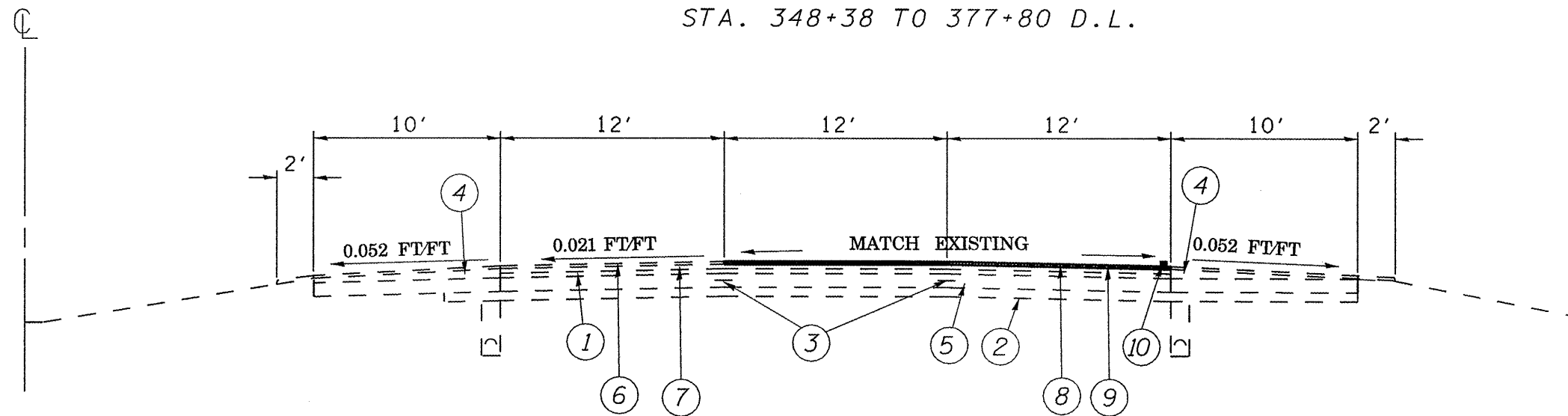

S.B. LANE

STA. 335+50 TO 345+72 D.L.

STA. 349+32 TO 350+32 C.L.

STA. 349+32 TO 365+00 D.L.

STA. 371+80 TO 378+05 D.L.

STA. 451+36 TO 456+36 D.L.

NOTE: S.B. LANE WIDTH VARIES 36' TO 24'
STA. 425+00 TO 432+70

LEGEND

- 1 - EXIST. 1 3/4" H.M.A. SURFACE
- 2 - EXIST. SUB-BASE GRANULAR MATERIAL 6"
- 3 - EXIST. LONGITUDINAL METAL JOINT
- 4 - EXIST. H.M.A SHOULDER
- 5 - EXIST. S.R.P.C.C. PAVEMENT 10"
- 6 - EXIST. H.M.A. SURFACE 1 1/2"
- 7 - EXIST. H.M.A. BINDER 1 3/4"
- 8 - PROP. HOT-MIX ASPHALT SURFACE REMOVAL 1 1/2"
- 9 - PROP. POLYMERIZED HOT-MIX ASPHALT SURFACE COURSE, MIX E, N105
- 10 - PROP. URETHANE PAVEMENT MARKING - LINE 5"

TYPICALS
FAI 55 (I-55)
SECT. (84-2-1.84-2-2)D-6 PATCHING-1
SANGAMON COUNTY

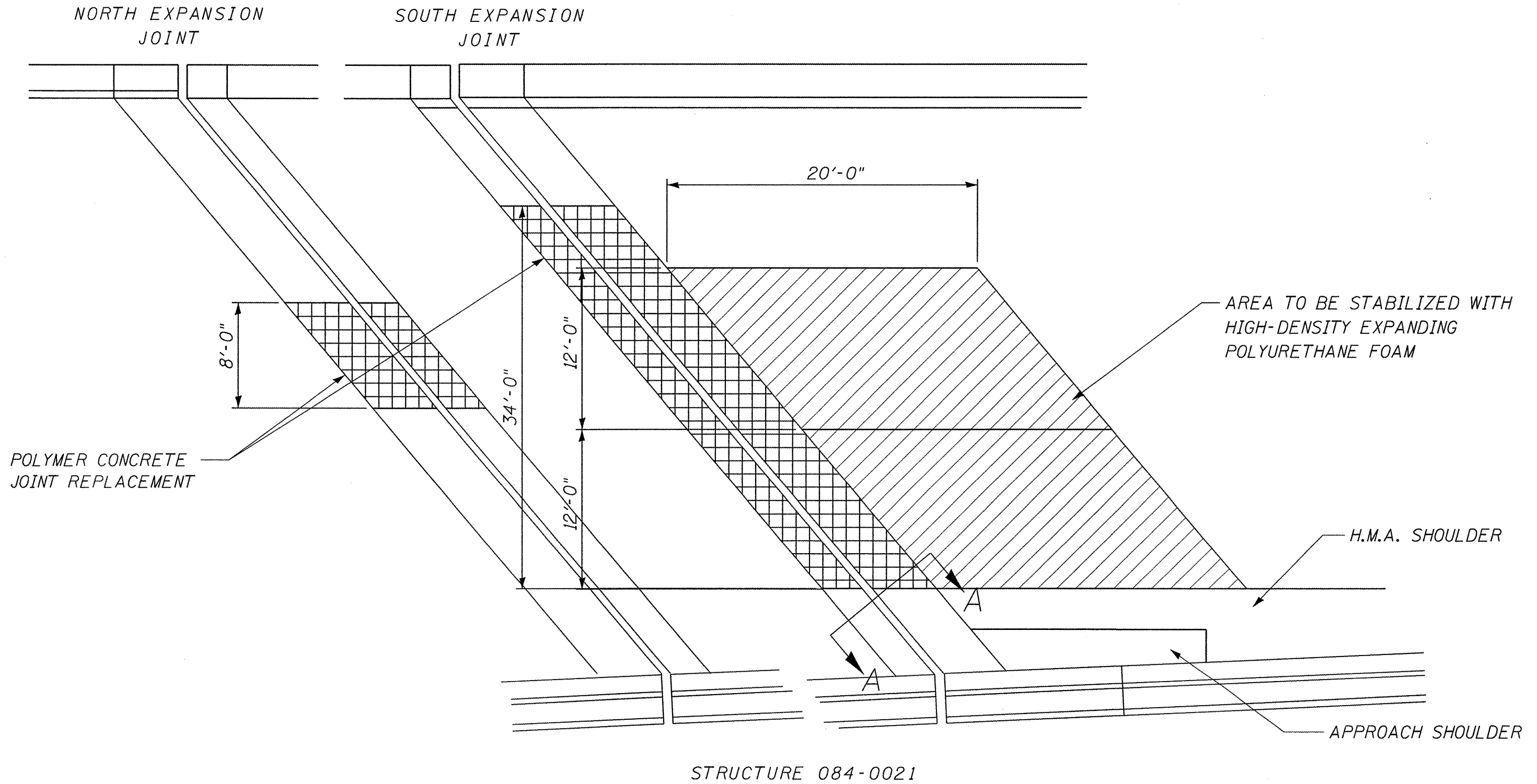

STRUCTURE 084-0021

BRIDGE APPROACH PLAN
FAI 55 (I-55)
SECT. (84-2-1,84-2-2)D-6 PATCHING-1
SANGAMON COUNTY

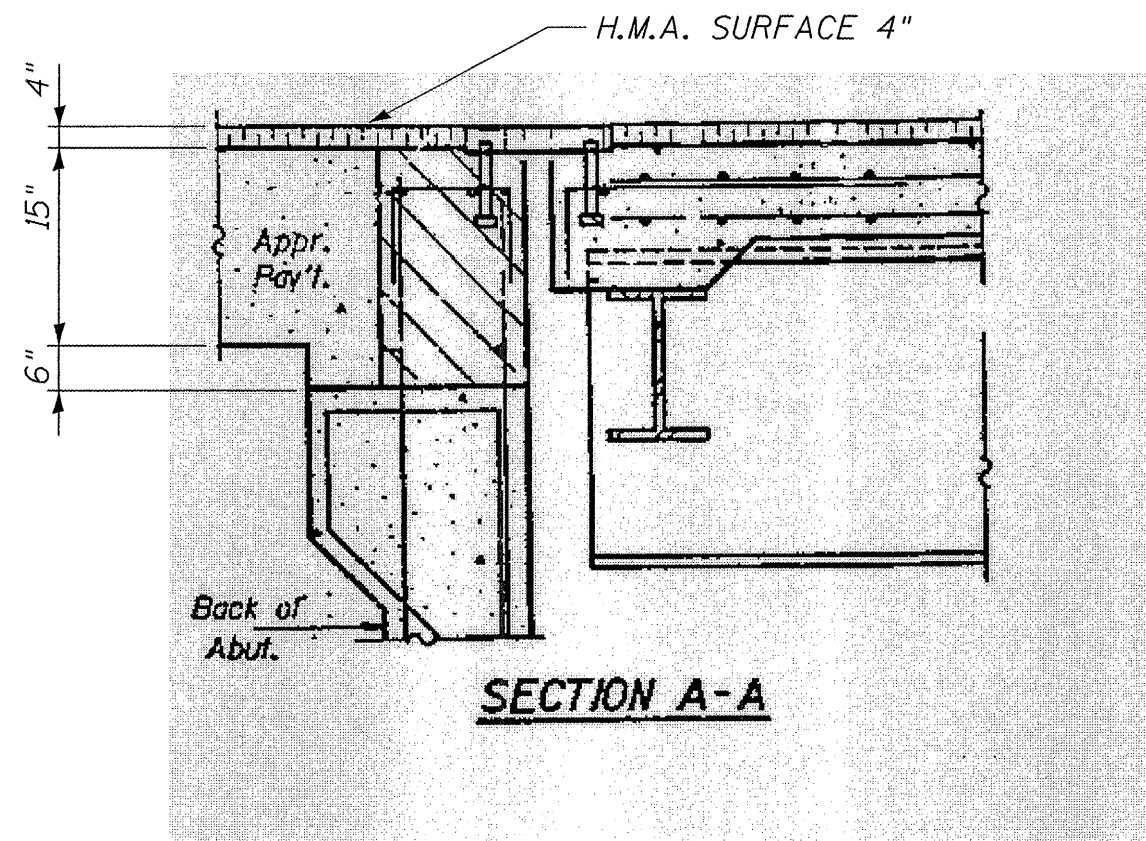

NOTES:

ALL WORK INVOLVED IN SAWING AND REMOVING BITUMINOUS SURFACE AND THE EXISTING NEOPRENE JOINT MATERIAL SHALL BE INCLUDED IN THE CONTRACTOR'S BID PRICE FOR POLYMER CONCRETE.

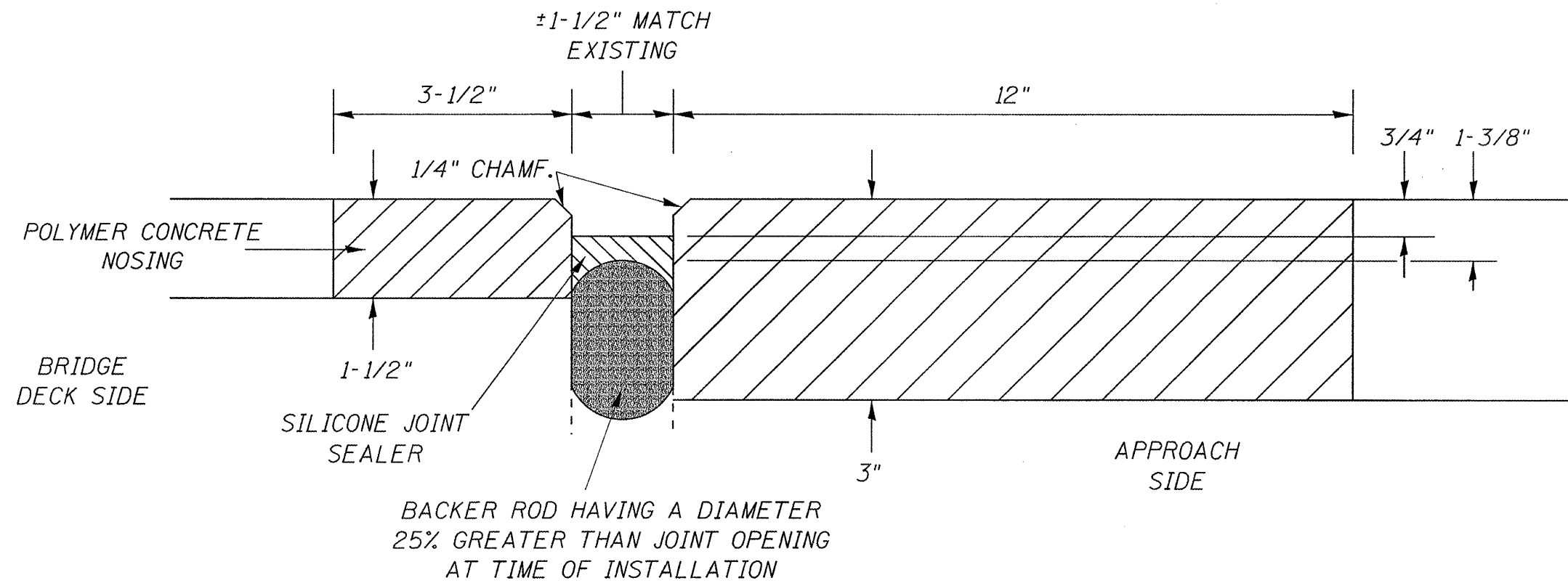

PROPOSED JOINT X-SEC

BRIDGE APPROACH DETAILS
FAI 55 (I-55)
SECT. (84-2-1,84-2-2)D-6 PATCHING-1
SANGAMON COUNTY

PAVEMENT MARKING SCHEDULE		
STATION	TYPE	URETHANE PAV'T
		MARK. - LINE 5" WHITE
S.B. RT. 335+50 TO 345+72	EDGE LINE	1,012 FT
S.B. C.L. 349+32 TO 350+32	SKIP DASH	30 FT
S.B. RT. 349+32 TO 365+00	EDGE LINE	1,568 FT
S.B. RT. 371+80 TO 378+05	EDGE LINE	625 FT
S.B. RT. 451+36 TO 456+36	EDGE LINE	500 FT
N.B. RT. 348+38 TO 377+80	EDGE LINE	2,942 FT
TOTALS		6,677 FT

MIXTURE REQUIREMENTS	
THE FOLLOWING MIXTURE REQUIREMENTS ARE APPLICABLE FOR THIS PROJECT	
MIXTURE USE(S):	POLY. H.M.A. S.C., MIX E, N105
AC/PG	SBS PG 70-22
DESIGN AIR VOIDS:	4.0% @ N DESIGN = 105
MIXTURE COMP:	IL 9.5 OR 12.5
FRICITION AGG:	MIX "E"

FOAM, EXPANDING POLYURETHANE, HIGH-DENSITY	
STA. 349+32 S.B.D.L.	2,500 LBS

POLYMER CONCRETE JOINT REPLACEMENT	
STA. 345+72 S.B.C.L.	2.3 CU FT
STA. 349+32 S.B.D.L. & S.B.C.L.	10.7 CU FT

NOTES:

1. STATIONS ARE APPROXIMATE.

SCHEDULES
FAI 55 (I-55)
(84-2-1, 84-2-2)D-6 PATCHING-1
SANGAMON COUNTY