

STATE OF ILLINOIS
DEPARTMENT OF TRANSPORTATION
DIVISION OF HIGHWAYS

PROPOSED HIGHWAY PLANS

FAS ROUTE 1536 (IL 48)
SECTION 125BR
PROJECT: RS-1536(106)
BRIDGE REPLACEMENT
MACON COUNTY
C-97-038-06

F.A.S. RTE.	SECTION	COUNTY	TOTAL SHEETS	SHEET NO.
1536	125BR	MACON	45	1
FED. ROAD DIST. NO.	ILLINOIS	CONTRACT NO. 74145		

*45+3=48

FOR INDEX OF SHEETS, SEE SHEET NO. 2

ADT = 850 (2007)

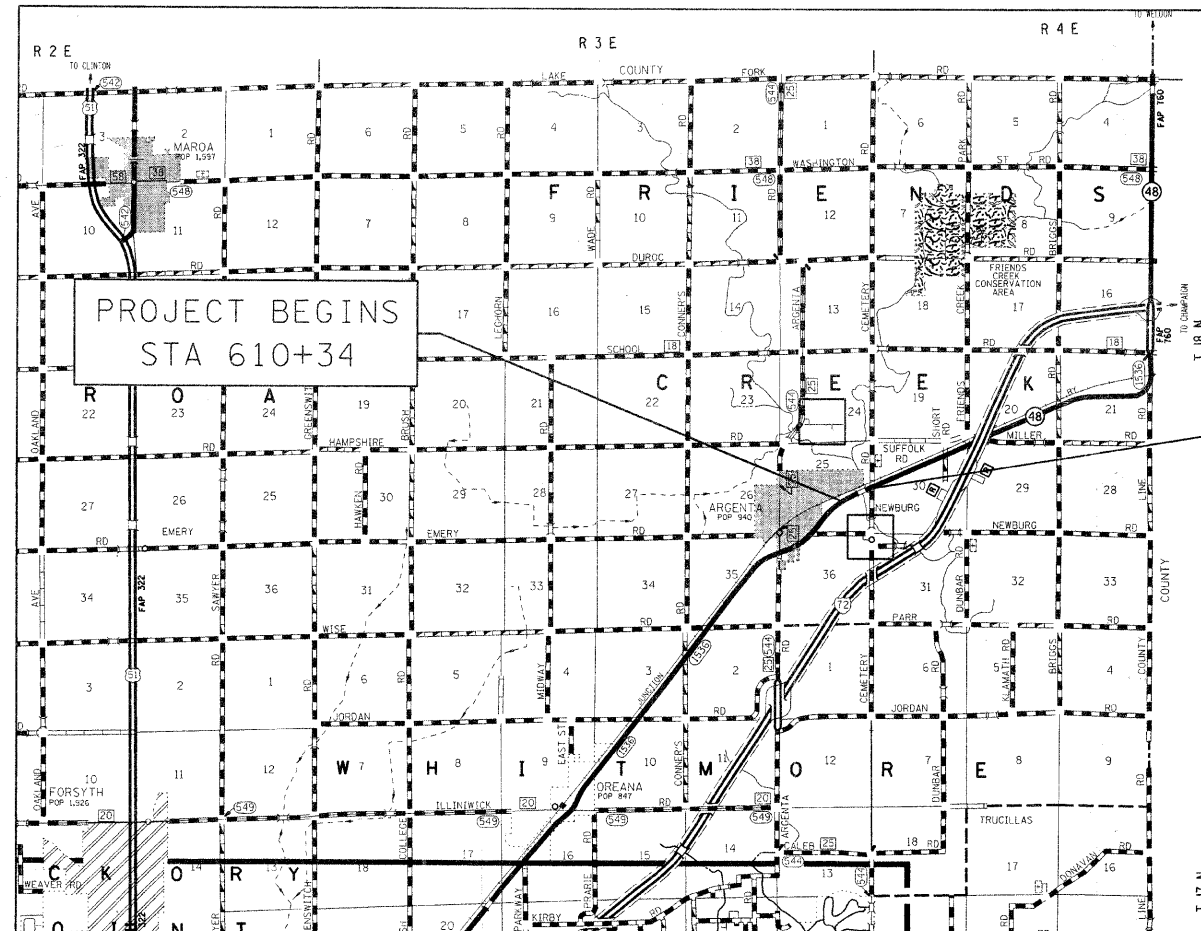
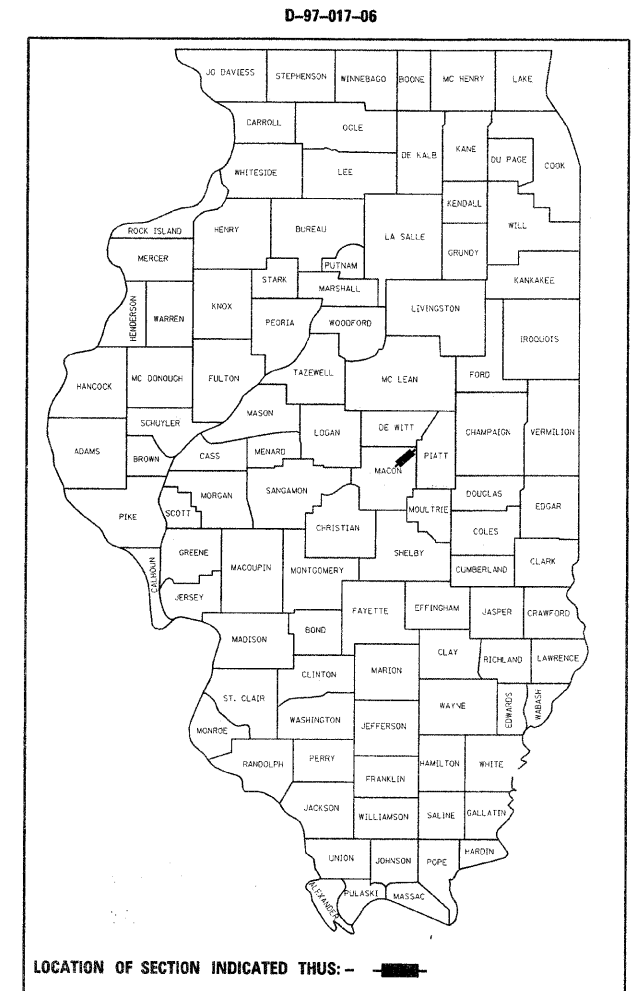

PROJECT ENDS
STA 622+77

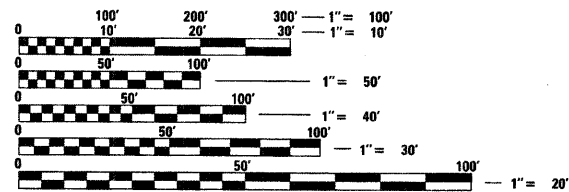

FULL SIZE PLANS HAVE BEEN PREPARED USING STANDARD ENGINEERING SCALES. REDUCED SIZED PLANS WILL NOT CONFORM TO STANDARD SCALES. IN MAKING MEASUREMENTS ON REDUCED PLANS, THE ABOVE SCALES MAY BE USED.

J.U.L.I.E.
JOINT UTILITY LOCATION INFORMATION FOR EXCAVATION
1-800-892-0123
OR 811

PROJECT ENGINEER: MARK DAUGHERTY
PROJECT MANAGER: BRIAN LEWIS

CONTRACT NO. 74145

GROSS LENGTH = 1243 FT (.24 MILES)
NET LENGTH = 1243 FT (.24 MILES)

STATE OF ILLINOIS
DEPARTMENT OF TRANSPORTATION
DIVISION OF HIGHWAYS

SUBMITTED October 14 2008

Regan - O'Neil
DEPUTY DIRECTOR OF HIGHWAYS, REGION ENGINEER

December 5, 20 08
Eric E. Haral
INTERENGINEER OF DESIGN AND ENVIRONMENT

December 5, 20 08
Christine M. Reed
DIRECTOR OF HIGHWAYS, CHIEF ENGINEER

**PRINTED BY THE AUTHORITY
OF THE STATE OF ILLINOIS**