

F.A.P. RTE.	SECTION	COUNTY	TOTAL SHEETS	SHEET NO.
*	**	***	19	18
STA. _____		TO STA. _____		
FED. ROAD DIST. NO. - ILLINOIS FED. AID PROJECT				

PAVEMENT MARKING DETAIL
 FAP 322 (US 51)
 STA. 365+98 TO STA. 378+65

- FAP 322 (US 51)
- D9 PAVEMENT PRESERVATION FY09-2
- UNION COUNTY

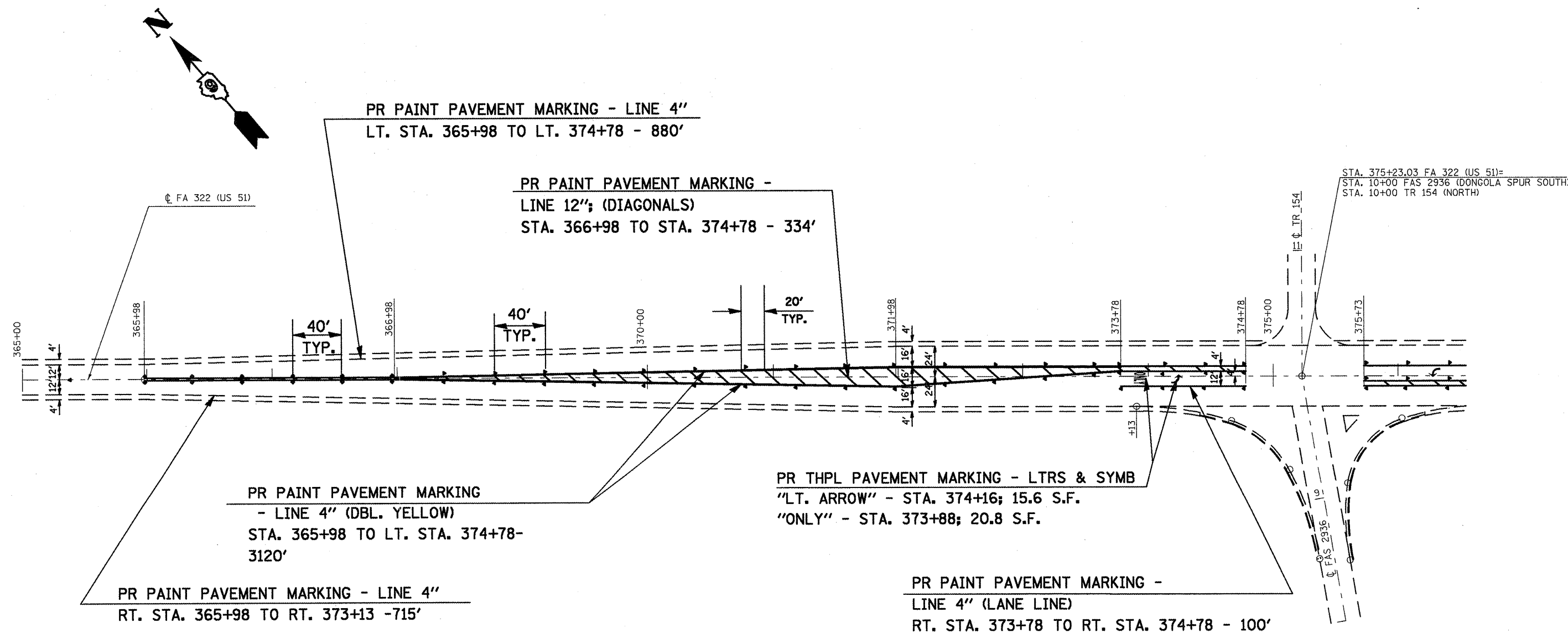

NOTES:
 FOR RAISED REFLECTIVE PAVEMENT MARKERS,
 SEE SCHEDULE ON SHEET 14.
 FOR PAVEMENT MARKING BEFORE STATION 365+98,
 SEE SCHEDULE ON SHT. 12.

PLOT DATE = 11/17/2008
 FILE NAME = c:\pavement\us51\us51\us51.dwg
 USER NAME = jrc