

F.A. RTE.	SECTION	COUNTY	TOTAL SHEETS	SHEET NO.
5154	04-00343-00-BR	WINNEBAGO	92	14
STA. _____		TO STA. _____		
FED. ROAD DIST. NO. _____ ILLINOIS FED. AID PROJECT				

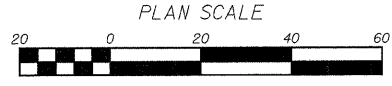

EX. STRUCTURE (S.N. 101-0027)  
 BUILT IN 1943 AS A THREE SPAN, STEEL BEAM AND RC DECK BRIDGE. THE STRUCTURE IS 170' B-B ABUTMENT, AND 28' F-F CURB, WITH CONCRETE STUB ABUTMENTS

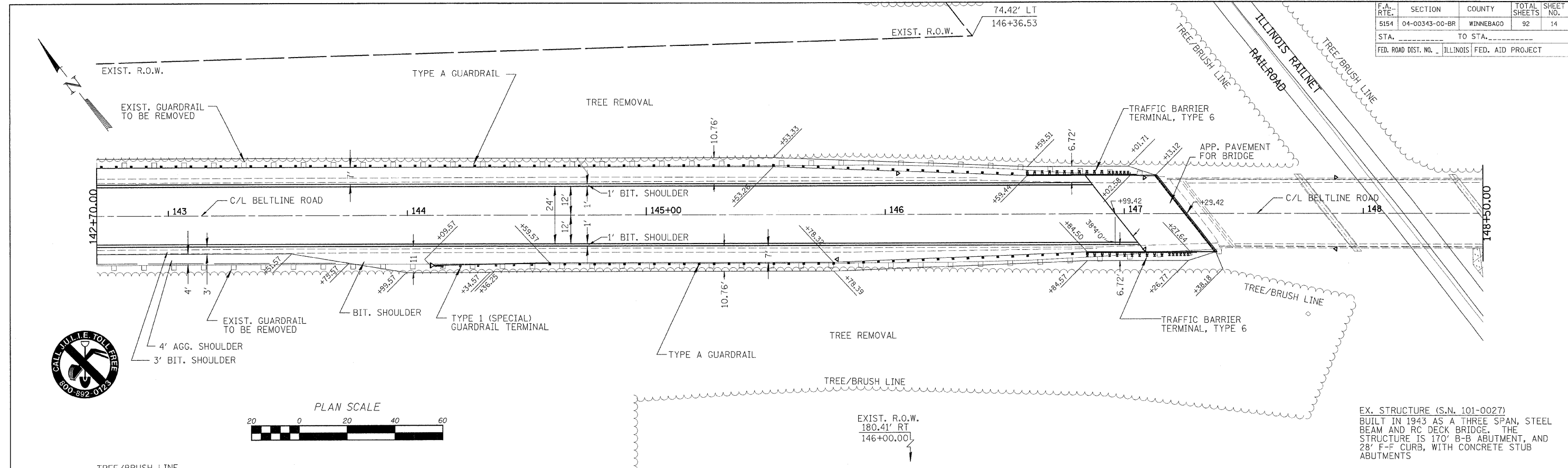