

F.A. RTE.	SECTION	COUNTY	TOTAL SHEETS	SHEET NO.
5154	04-00343-00-BR	WINNEBAGO	92	15
STA.	TO STA.		FED. ROAD DIST. NO.	
148+00.00	153+80.00		ILLINOIS FED. AID PROJECT	
50' R EXIST. R.O.W.				

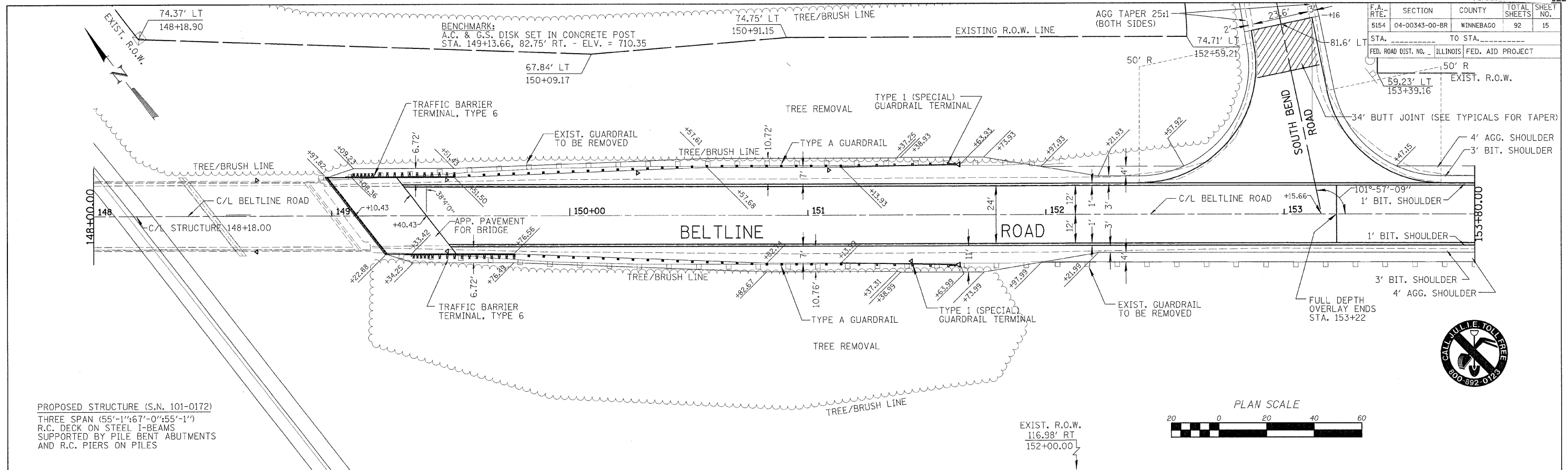

PROPOSED STRUCTURE (S.N. 101-0172)
 THREE SPAN (55'-1" : 67'-0" : 55'-1")
 R.C. DECK ON STEEL I-BEAMS
 SUPPORTED BY PILE BENT ABUTMENTS
 AND R.C. PIERS ON PILES

