

EXISTING CURVE
 PI STA. = 57+55.34
 $\Delta = 27^\circ 24' 10''$ (LT)
 $D = 5^\circ 00' 00''$
 $R = 1,145.92'$
 $T = 279.37'$
 $L = 548.06'$
 $E = 33.56'$
 $e = 4.00\%$
 $T.R. = 74.45'$
 $S.E. RUN = 746.00'$
 $P.C. STA = 54+75.97$
 $P.T. STA = 60+24.02$
 $F.S. STA = 53+66.45 - 61+12.45$

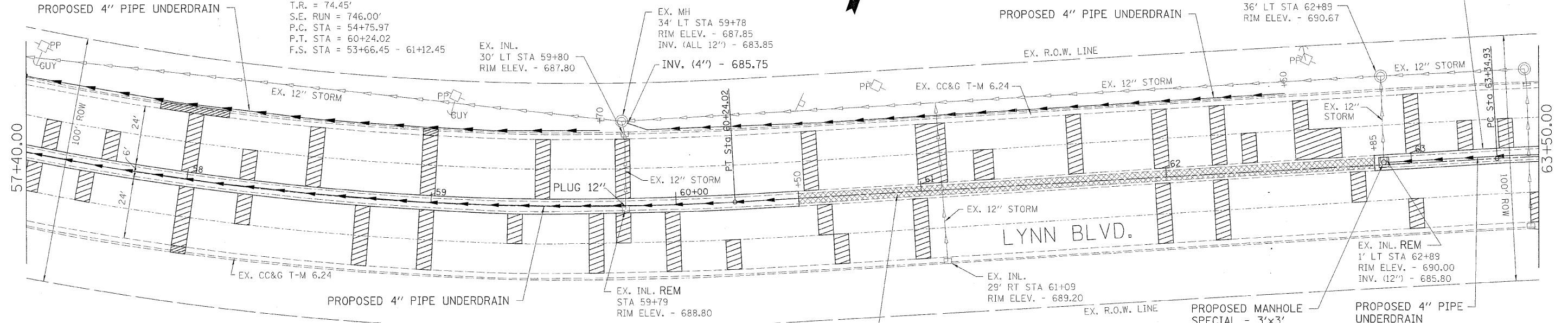

LEGEND

- CLASS B PATCHES - 10" (SEE STANDARD 442101)
- P.C.C. SURFACE REMOVAL (PARTIAL DEPTH)
- CONCRETE CURB & GUTTER REMOVAL AND REPLACEMENT

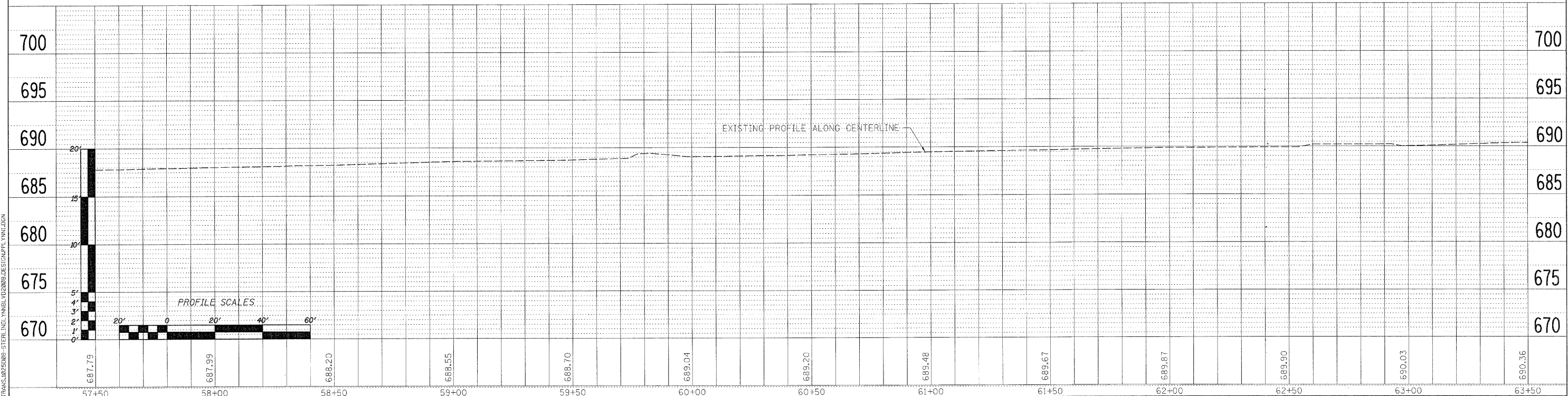
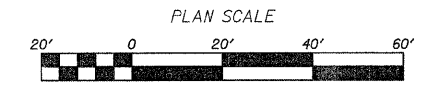

FILE NAME = S:\TRANS\UP25208-STERL\IND\YINBLVD\02089.DWG DESIGNER: PL YIN.LDDA

WILLET, HOFMANN & ASSOCIATES, INC.
 CONSULTING ENGINEERS
 600 East Second Street, Dixon, IL 61021
 Phone 815.284.3381 Fax 815.284.3385
 Design Firm # 184-00918
 www.willettthofmann.com

DESIGNED -	REVISED -
DRAWN -	REVISED -
CHECKED -	REVISED -
DATE -	REVISED -

CITY OF STERLING, ILLINOIS
LYNN BLVD. - 16TH AVE. TO FREEPORT RD.

LYNN BLVD PLAN & PROFILE
 SCALE: _____ SHEET NO. ____ OF ____ SHEETS STA. _____ TO STA. _____

F.A. RTE.	SECTION	COUNTY	TOTAL SHEETS	SHEET NO.
	06-00141-00-RS	WHITESIDE	16	7
FED. ROAD DIST. NO. _____ ILLINOIS FED. AID PROJECT			CONTRACT NO. _____	