

6/30/2008 1:59:44 PM

P:\00009001\Chicago CAD\Sheet\513_PP_PINEandCENTER.dgn

F.P. RTE.	SECTION	COUNTY	TOTAL SHEETS	SHEET NO.
• 00-00043-00-BR		FORD	51	13

FED. ROAD DIST. NO. 3	ILLINOIS	CONTRACT NO. 87198
-----------------------	----------	--------------------

• HOLMES ST.
PINE ST.
CENTER ST.

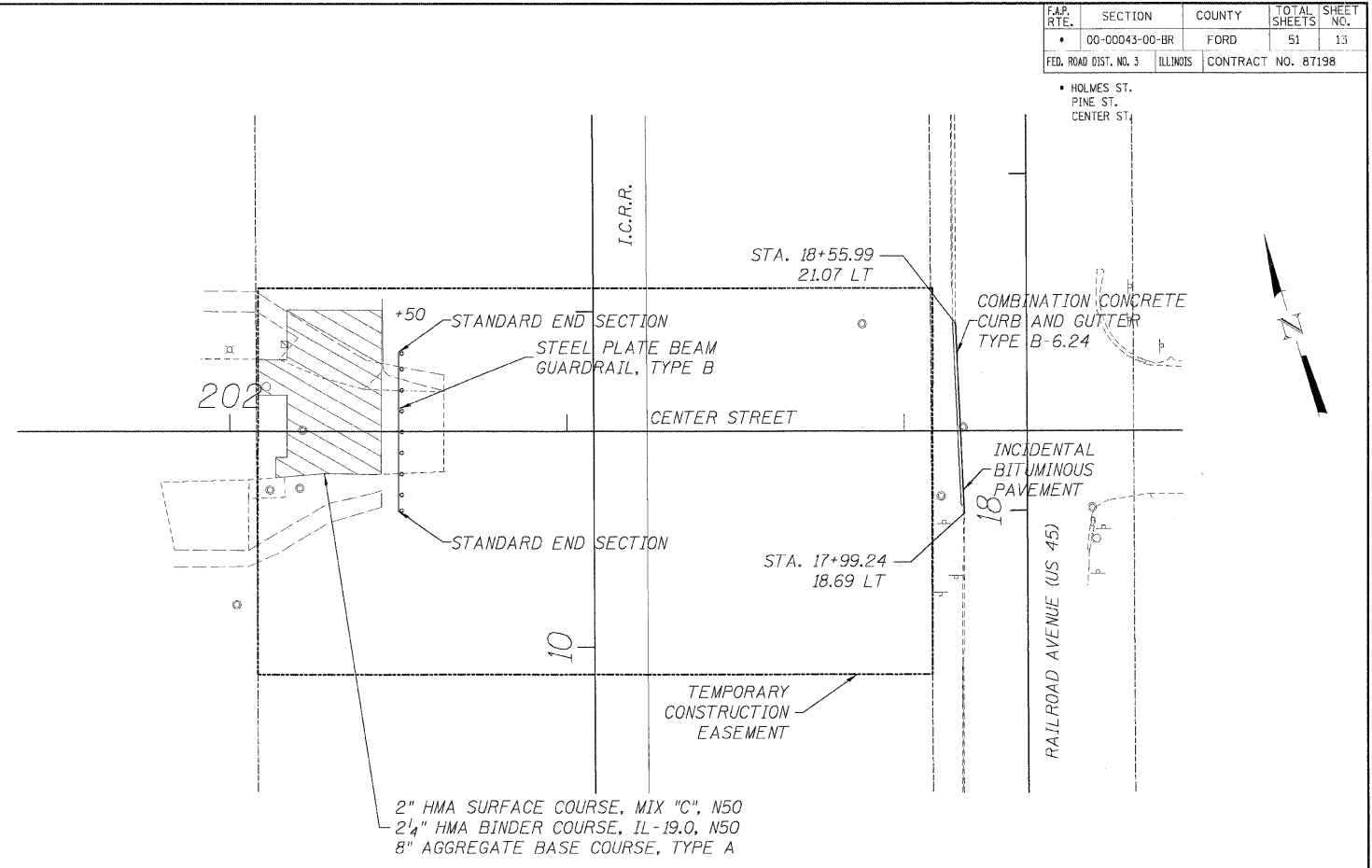
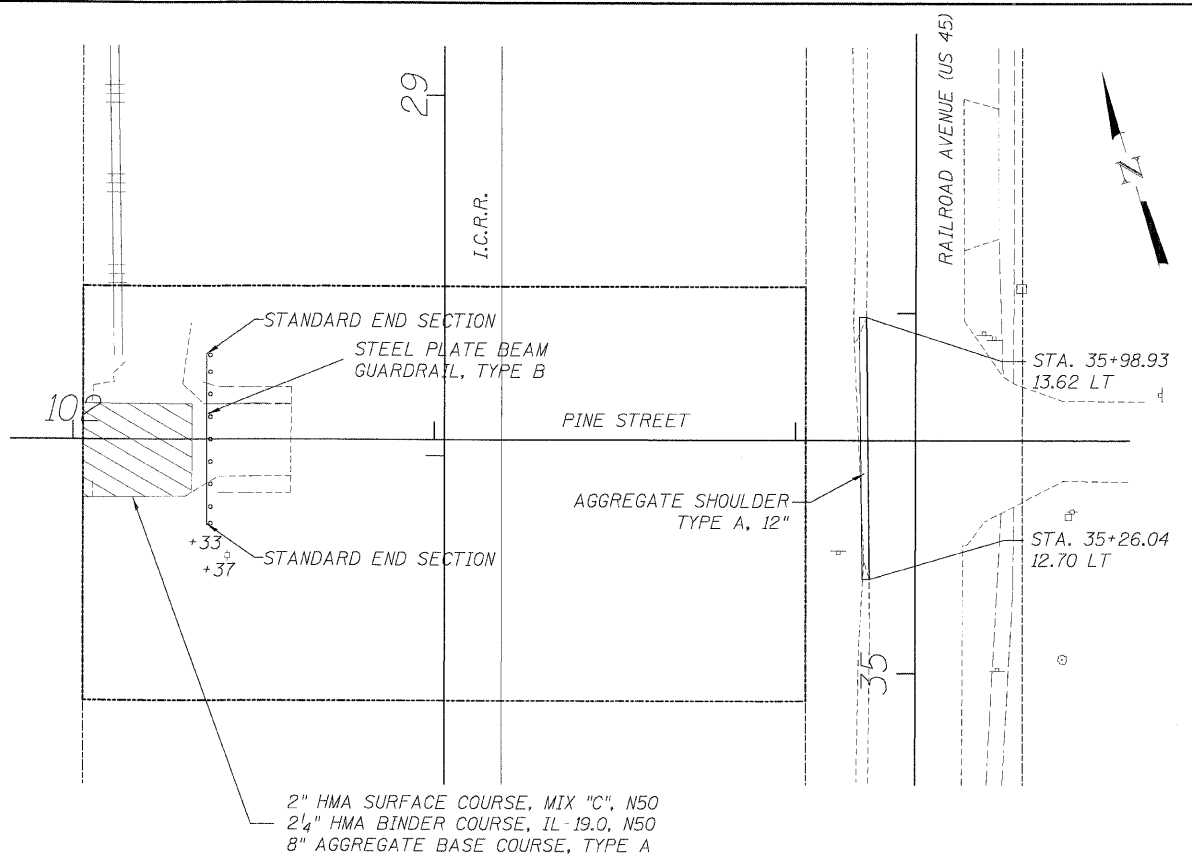

ROADWAY PLAN
PINE STREET AND CENTER STREET
HOLMES STREET OVER
ILLINOIS CENTRAL RAILROAD
CITY OF PAXTON, FORD COUNTY

DESIGN BY KLA	DRAWING NO. C-13	Job# C-93-016-01
DRAWN BY DWO	DATE 7/1/08	SCALE 1/4" = 1'-0"
CHECKED BY JAH		



DATE	REVISIONS