

1552624 PW
6/30/2008

F.A.P. RTE.	SECTION	COUNTY	TOTAL SHEETS	SHEET NO.
• 00-00043-00-BR		FORD	51	20
FED. ROAD DIST. NO. 3		ILLINOIS	CONTRACT NO. 87198	

• HOLMES ST.
• PINE ST.
• CENTER ST.

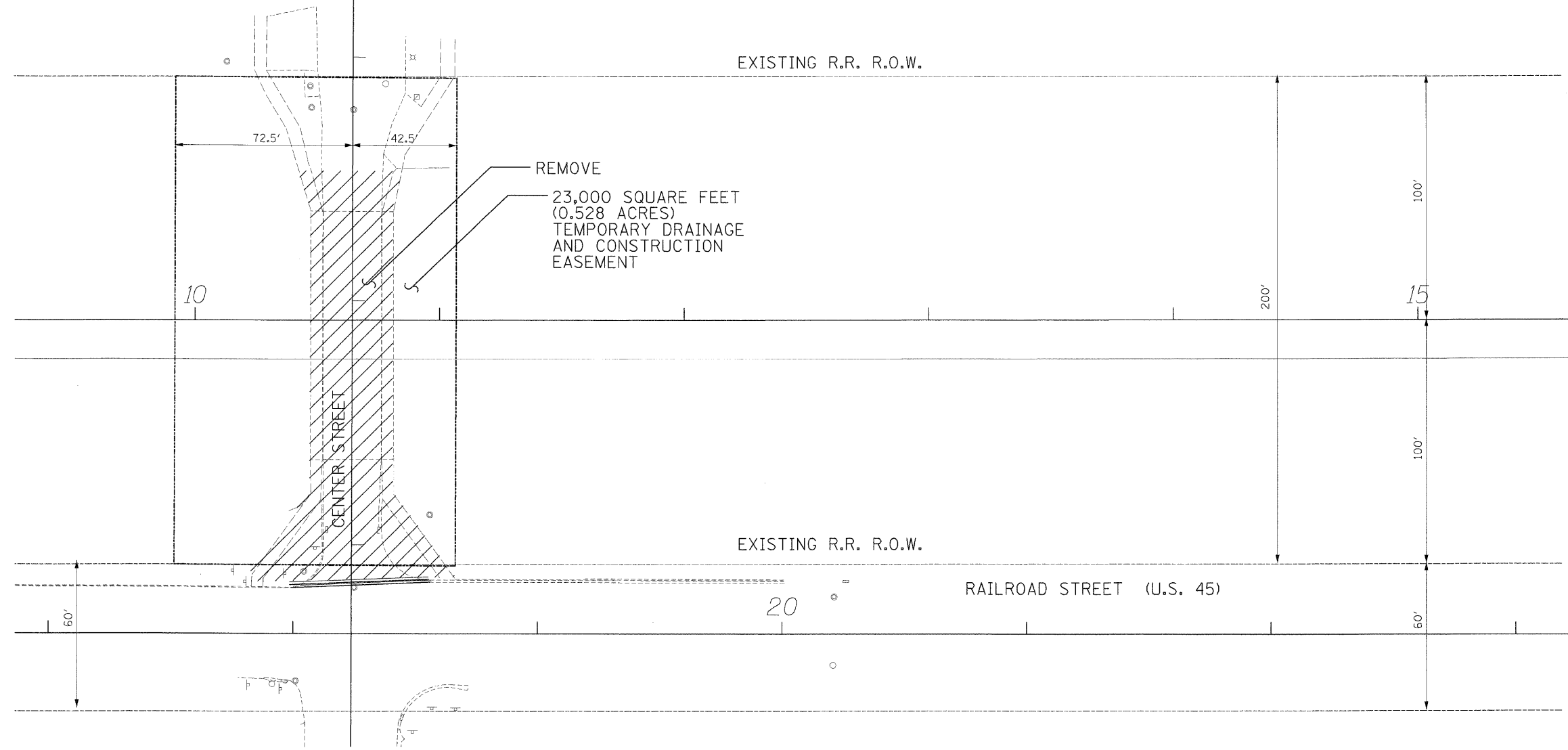

P:\0\0019001\Chicago_CADD\Streets\20_ROW_CS.dgn

RIGHT-OF-WAY AND EASEMENT OVERVIEW HOLMES STREET OVER ILLINOIS CENTRAL RAILROAD CITY OF PAXTON, FORD COUNTY		
DESIGN BY <u>KLA</u> DRAWN BY <u>KEB</u> CHECKED BY <u>JAH</u>	DRAWING NO. C-20	Job# <u>C-93-016-01</u> DATE <u>7/1/08</u> SCALE <u>1"=25'</u>
		DATE _____ REVISIONS _____