

* 00.1245-641115-4(1)008R				
F.A.P. RTE.	SECTION	COUNTY	TOTAL SHEETS	SHEET NO.
64	*	PEORIA	186	122
STA.		TO STA.		
FED. ROAD DISTRICT NO.		ILLINOIS FED. AID PROJECT		
CONTRACT 88803				

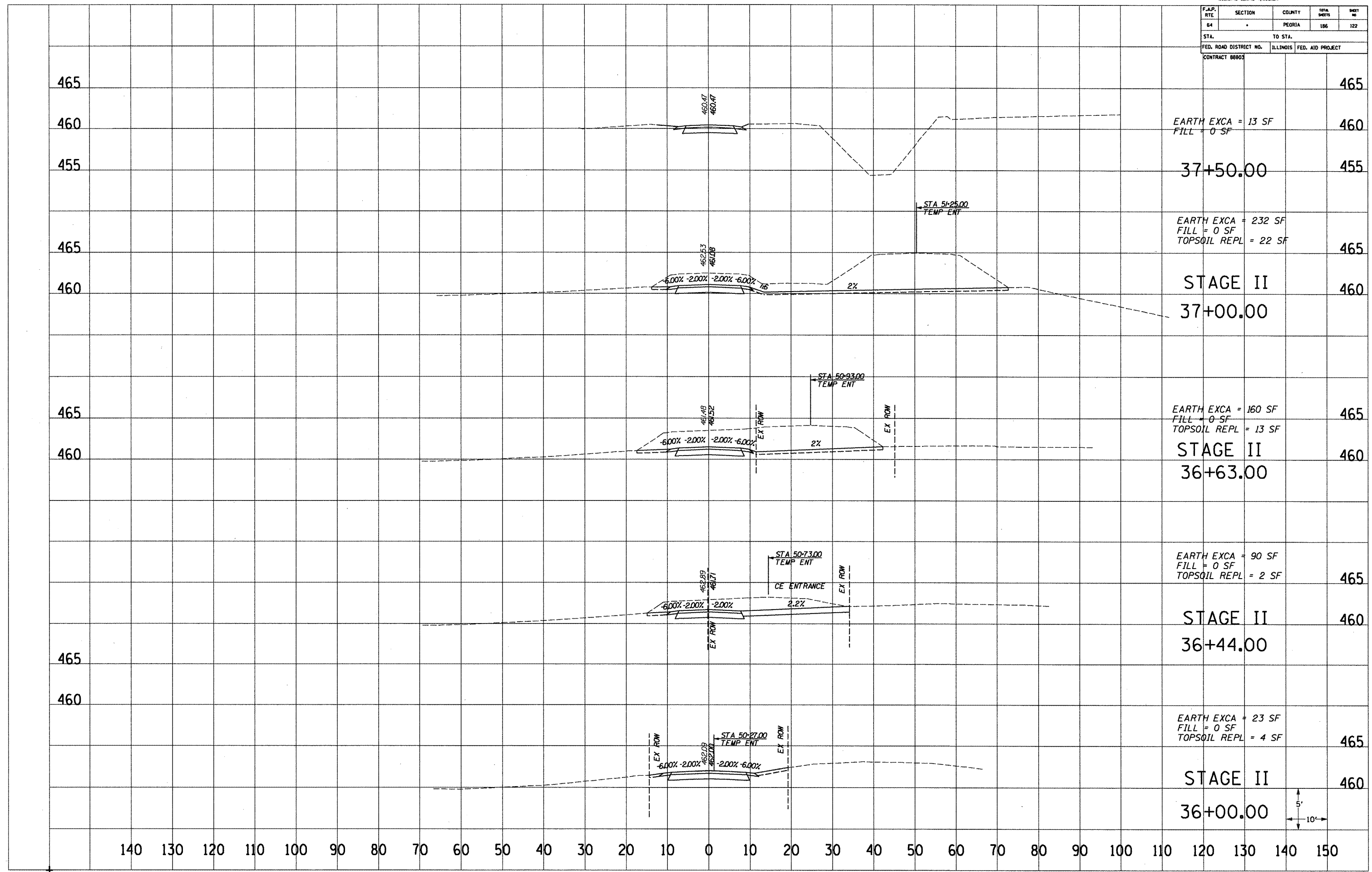

EARTH EXCA = 13 SF  
FILL = 0 SF

37+50.00

EARTH EXCA = 232 SF  
FILL = 0 SF  
TOPSOIL REPL = 22 SF

STAGE II

37+00.00

EARTH EXCA = 160 SF  
FILL = 0 SF  
TOPSOIL REPL = 13 SF

STAGE II

36+63.00

EARTH EXCA = 90 SF  
FILL = 0 SF  
TOPSOIL REPL = 2 SF

STAGE II

36+44.00

EARTH EXCA = 23 SF  
FILL = 0 SF  
TOPSOIL REPL = 4 SF

STAGE II

36+00.00

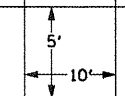

140 130 120 110 100 90 80 70 60 50 40 30 20 10 0 10 20 30 40 50 60 70 80 90 100 110 120 130 140 150